

**1,200 SF RETAIL SPACE AVAILABLE
BUILDING 9, SUITE 930**

11711 NE 99TH STREET, SUITE 930, VANCOUVER, WA 98682

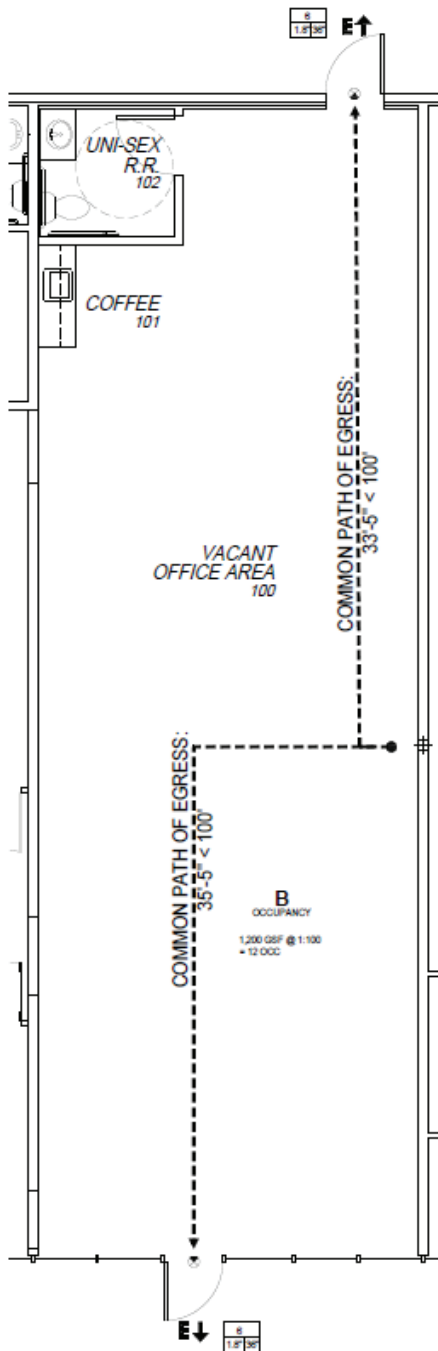

**SUITE 930
HIGHLIGHTS & FEATURES**

- 1,200 SF Retail Space
- Coffee Bar
- 120/208 Volt, 3-Phase Power
- Sprinklered Building
- Restaurants and Retail Amenities nearby: Los Jalapenos, Columbia Credit Union, Papa John's Pizza, Chevron, Seize the Bagel & Many More

paddencp.com

Available: Now



OWNED & MANAGED BY:



**Columbia
Commercial**
Commercial Leasing | Sales | Property Management



WESTCORE

NOW AVAILABLE! BUILDING 9, SUITE 930

11711 NE 99th Street, Suite 930, Vancouver, WA 98682

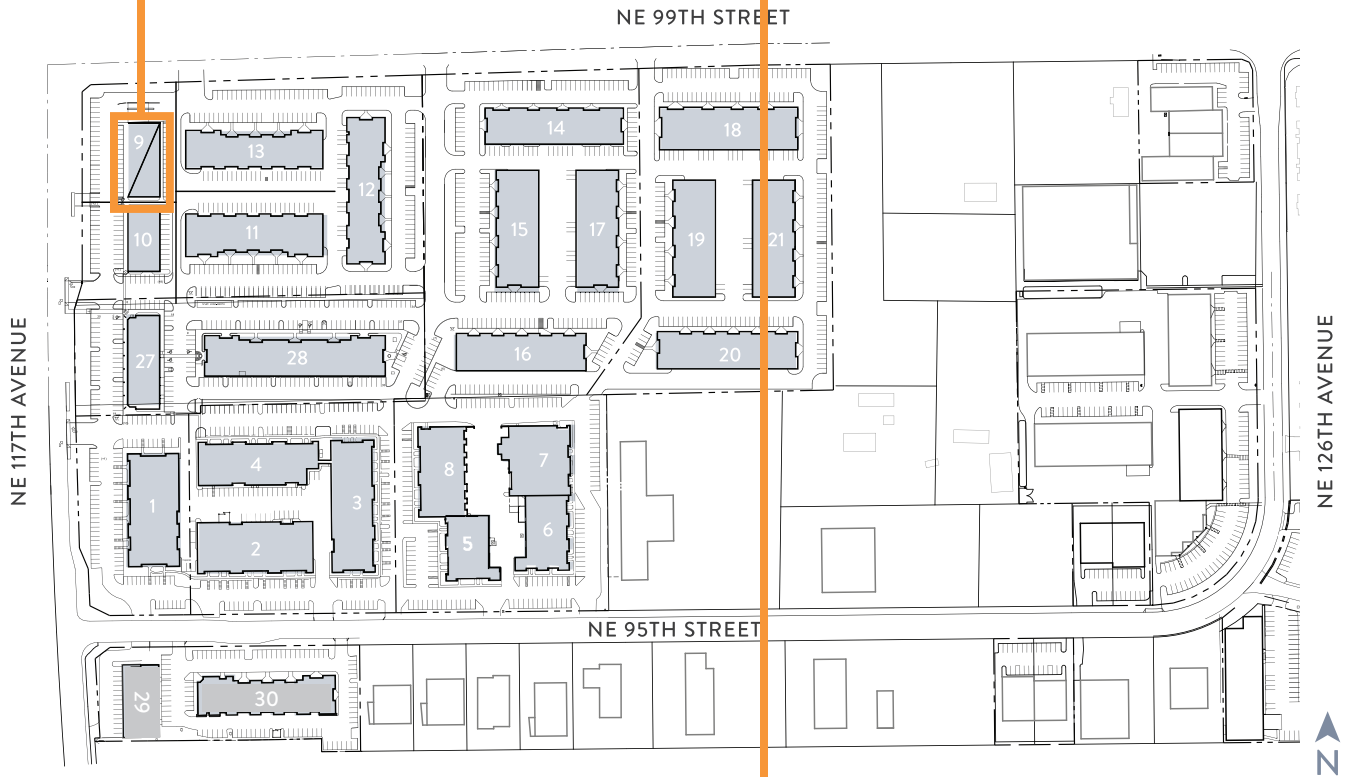

LEASING CONTACTS

Coleman Brown, CCIM, Principal Broker
Columbia Commercial, LLC
Coleman@CCPprop.com
360.952.4758

paddencp.com

