

REVISIONS	

DA

DONAHUE ARCHITECTURE INC

1099 SW 17th Street, Ste. 201-165
Ocala, FL 34477
T 352.867.5148
E. barry@donahue-arch.com
LICENSE #A22000933
CERT. OF AUTH. # 32147

SITE/CIVIL PLANS

SITE PLAN

A Site Plan for
Sunshine Garden ALF
311 NE 4th Avenue
Crystal River, Florida 34429
Citrus County, S21, T18S, R17E

DATE	16-Apr-20
JOB	D_19103A
DRAWN BY	B. GINN
	4
C100	5
	Schematic

PARKING CALCULATIONS:

1 SPACE FOR EACH 2 BEDS
28 BEDS x 1 SPACE / 2 BEDS => 14 SPACES REQUIRED

SPACES PROVIDED
16 REGULAR SPACES
2 HC SPACES
18 TOTAL SPACES > 12 SPACES REQUIRED => OK!

SITE COVERAGES				
AREA DESCRIPTION	EXISTING AREA (SF)	EXISTING AREA COVERAGE (%)	PROPOSED AREA (SF)	PROPOSED AREA COVERAGE (%)
BLDG.	10,400	30.49	11,734	34.40
CONC./PVMT	10,405	30.51	9,456	27.73
TOTAL IMPERVIOUS	20,805	61.00	21,190	62.13
OPEN SPACE	23,701	69.49	12,916	37.87
TOTALS	34,106	100	34,106	100.00

STORMWATER CALCULATIONS:

TREATMENT VOLUME CALCULATIONS
BASIN B AREA = 12,483 SF
1" OVER BASIN AREA
1" x (1FT/12") x 12,483 SF => 1,040 CF REQ'D TREATMENT VOLUME
PROVIDED TREATMENT VOL. => 1,040 CF

FLOODPLAIN COMPENSATION CALCULATIONS:

SEE SHEET 5 FOR CROSS-SECTIONS
TOTAL FILL VOLUME = 390.1 CF

STAGE AREA DATA:

STAGE	AREA	INC. VOL.	CUM. VOL.
6.0	1,639	-	-
7.0	2,170	1,905	1,905

WEIR ELEV. = 6.81'
VOL. AT WEIR = 1,543 CF > TV + FLOOD PLAIN FILLING (1,040 CF + 390.1 CF = 1,430.01 CF)

SITE PLAN LEGEND

- PROPOSED BUILDINGS
- PROPOSED PAVEMENT
- PROPOSED CONCRETE
- PROPOSED CURB
- PROPOSED SIGNAGE
- PROPOSED SETBACK/EASEMENT
- HANDICAP SYMBOL
- UNINTERRUPTED PARKING SPACES

BARRY GINN, PE
STATE OF FLORIDA
PROFESSIONAL ENGINEER
LICENSE NO. - 54595

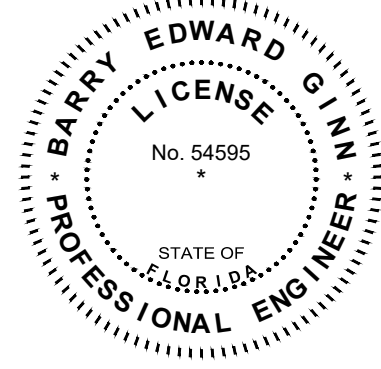

THIS ITEM HAS BEEN DIGITALLY SIGNED AND SEALED BY BARRY GINN, PE ON THE DATE INDICATED HERE. PRINTED COPIES OF THIS DOCUMENT ARE NOT CONSIDERED SIGNED AND SEALED AND THE SIGNATURE MUST BE VERIFIED ON ANY ELECTRONIC COPIES.

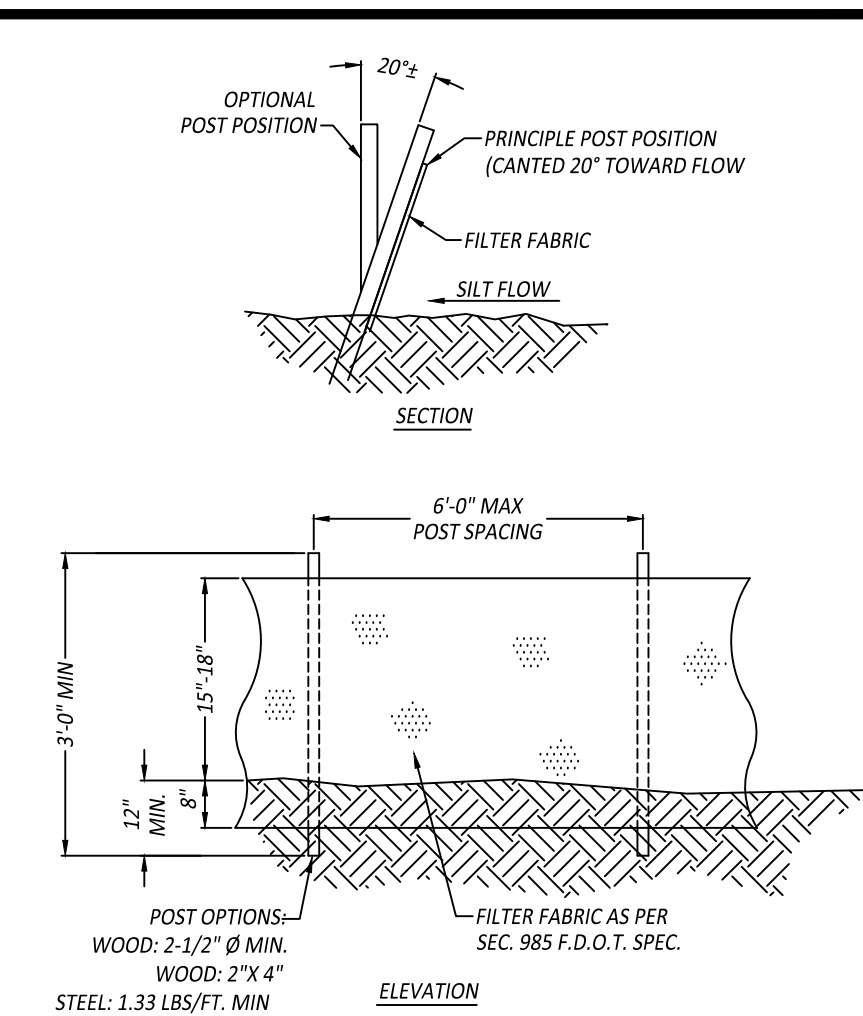
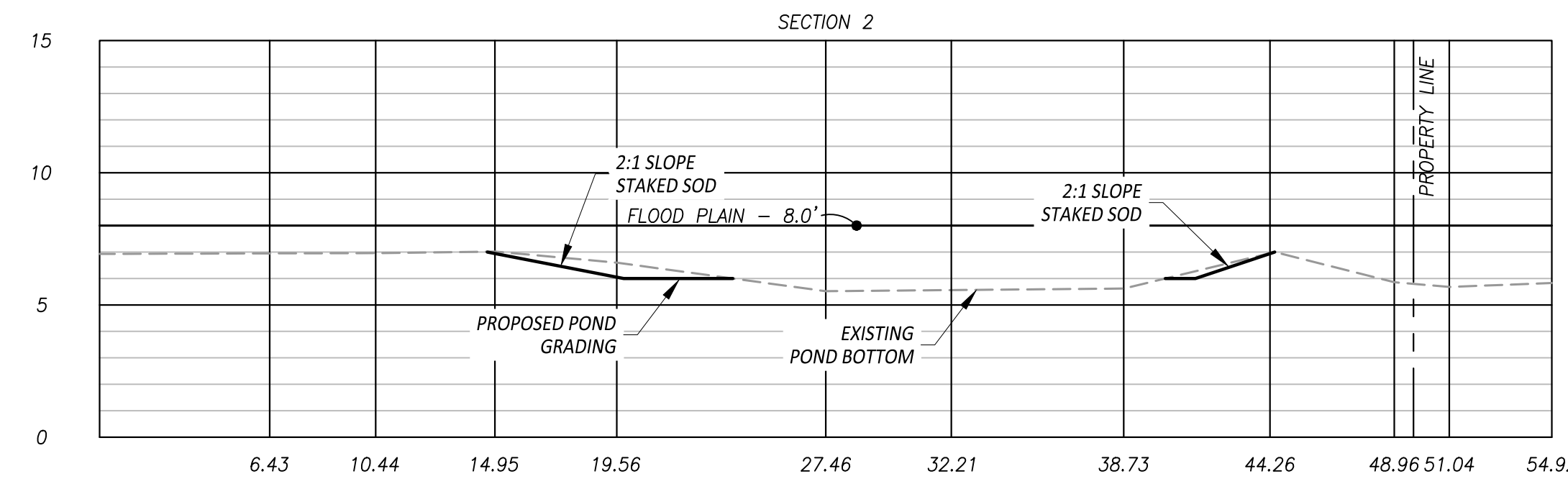
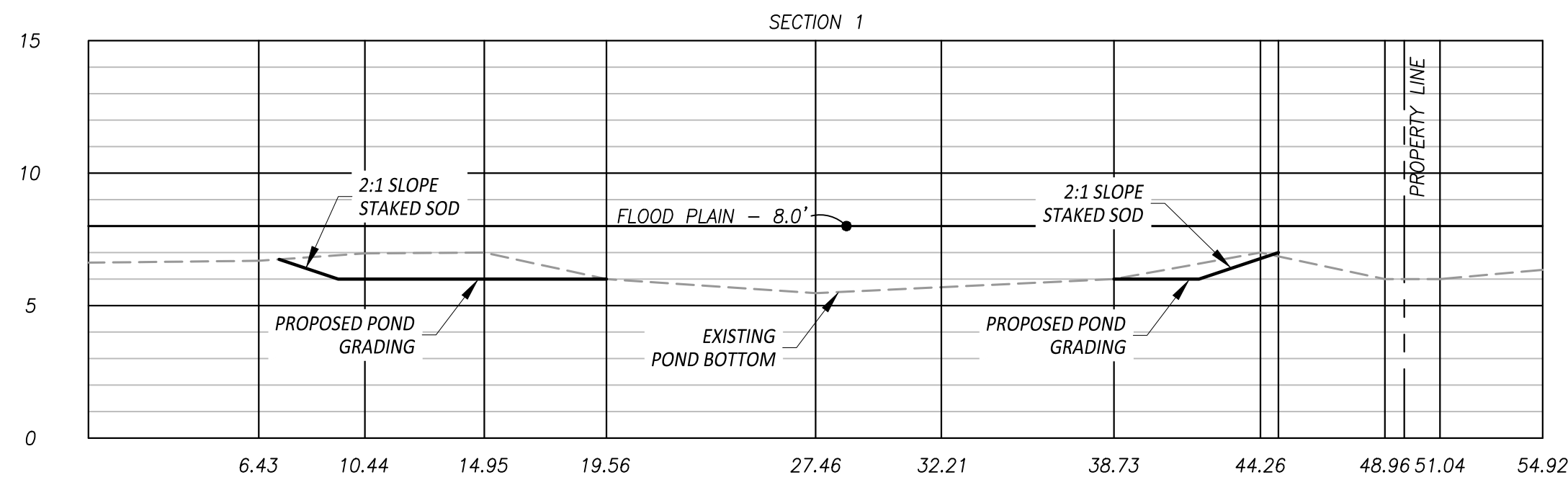

TYPE III SILT FENCE DETAIL
NTS

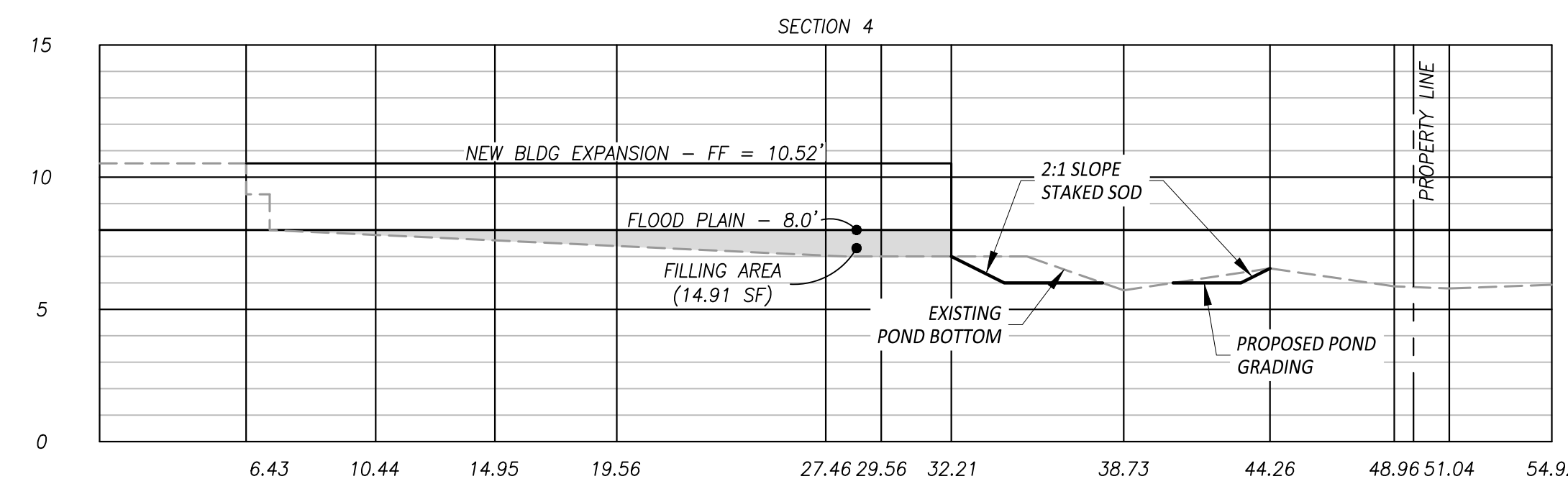
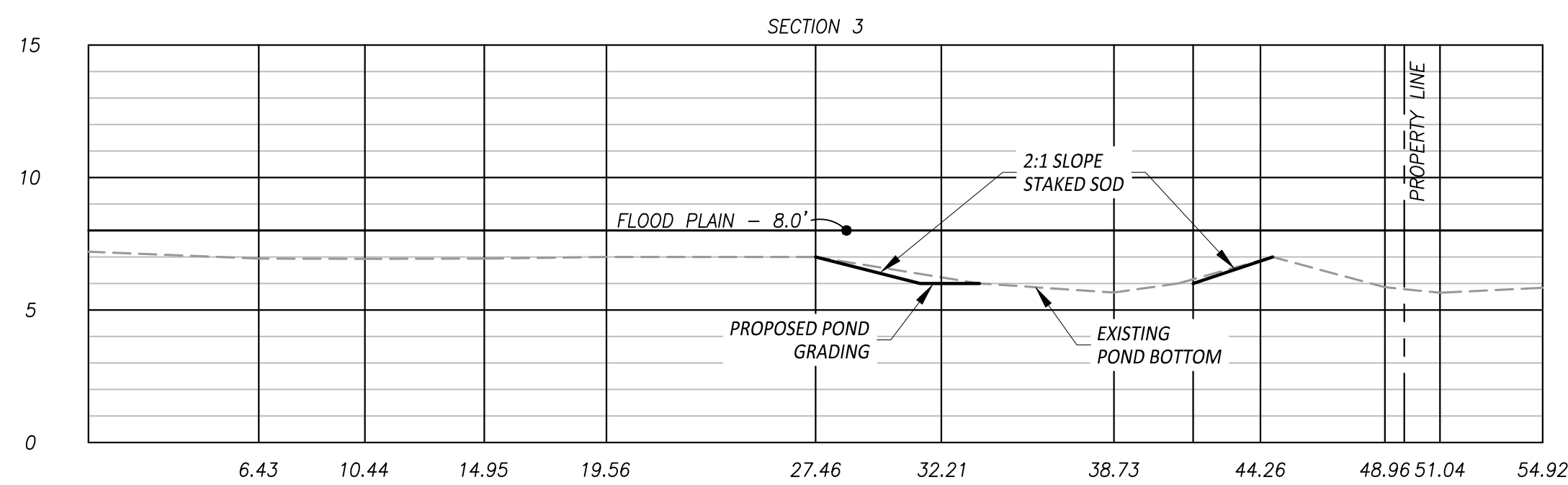

FILLING VOLUME = FILLING AREA x DIST. TO EXISTING WALL
FILL VOLUME = 14.91 SF x 6.99 FT = 104.22 CF

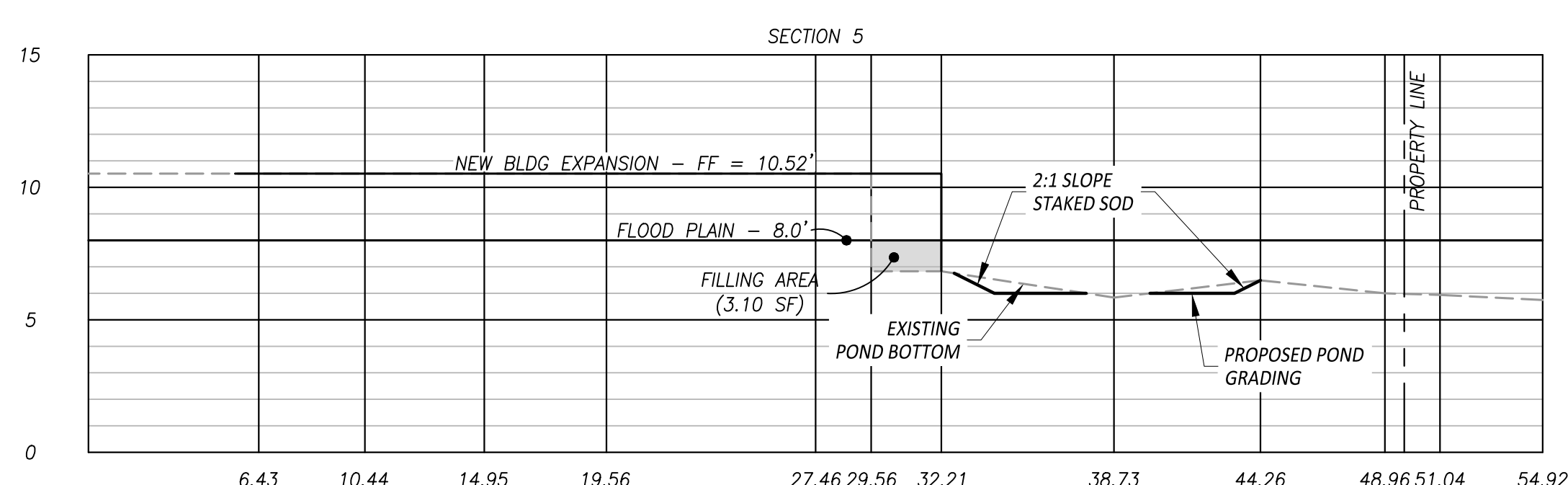

FILLING VOLUME = FILLING AREA x BLDG LENGTH
FILL VOLUME = 3.10 SF x 55.6 FT = 172.36 CF

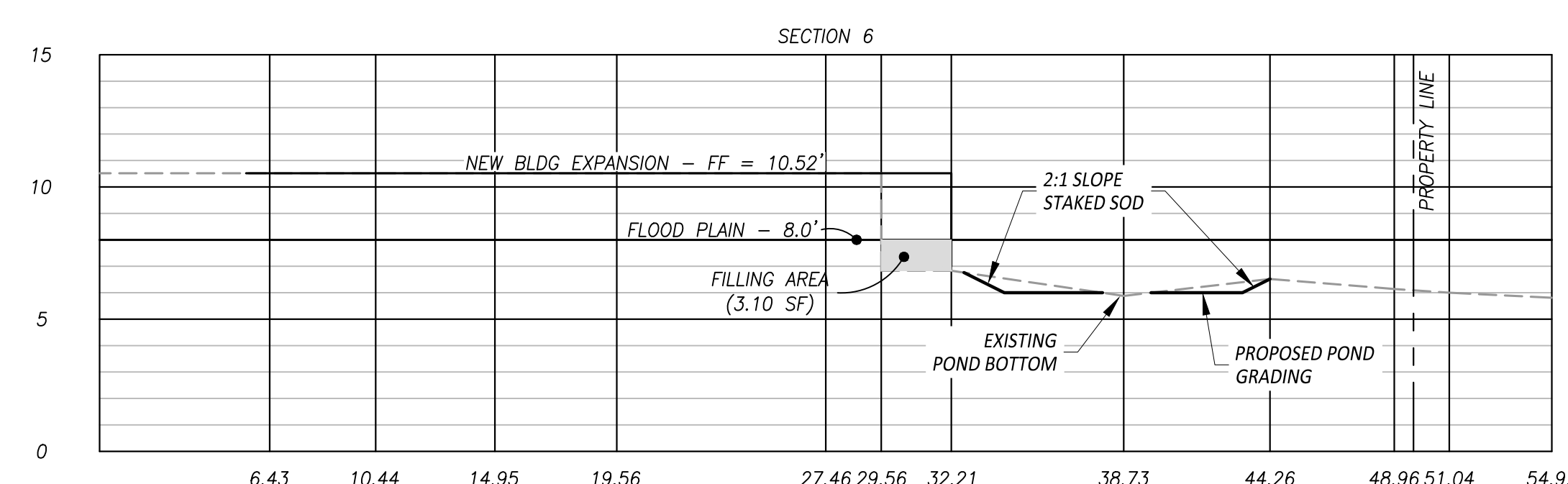

INCLUDED IN SECTION 5 CALCULATION

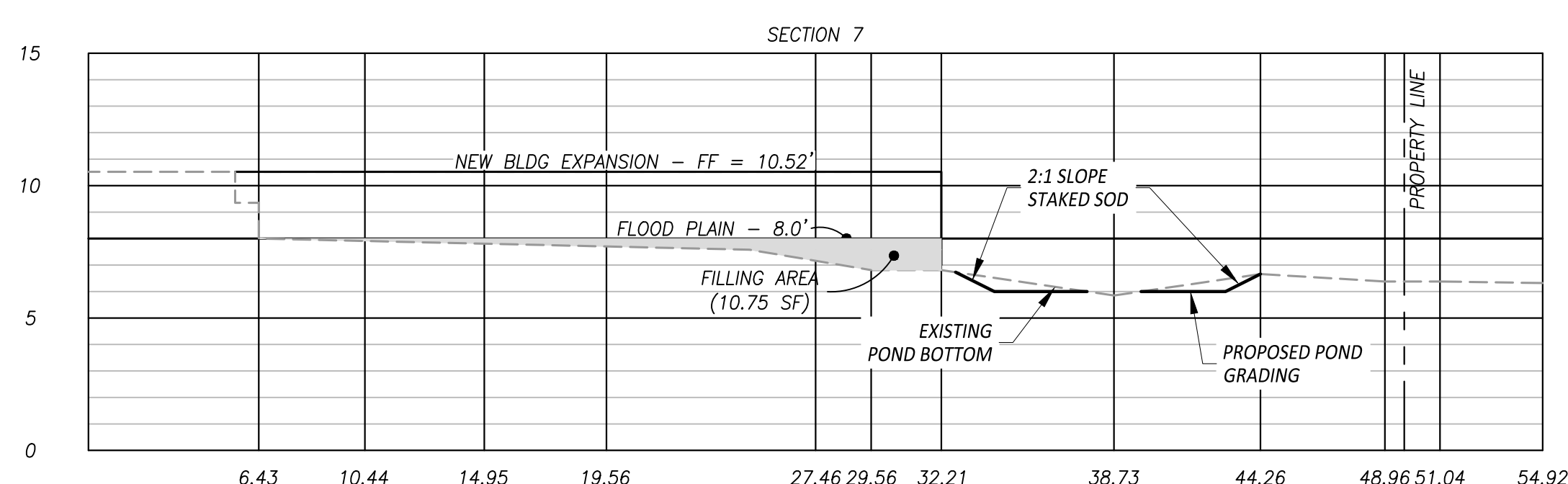

FILLING VOLUME = FILLING AREA x DIST. TO EXISTING WALL
FILL VOLUME = 10.75 SF x 10.56 FT = 103.52 CF

TOTAL FLOOD PLAIN FILLING
SECTION 4 - 104.22 CF
SECTION 5 - 172.36 CF
SECTION 7 - 103.52 CF
TOTAL FILLING - 390.01 CF

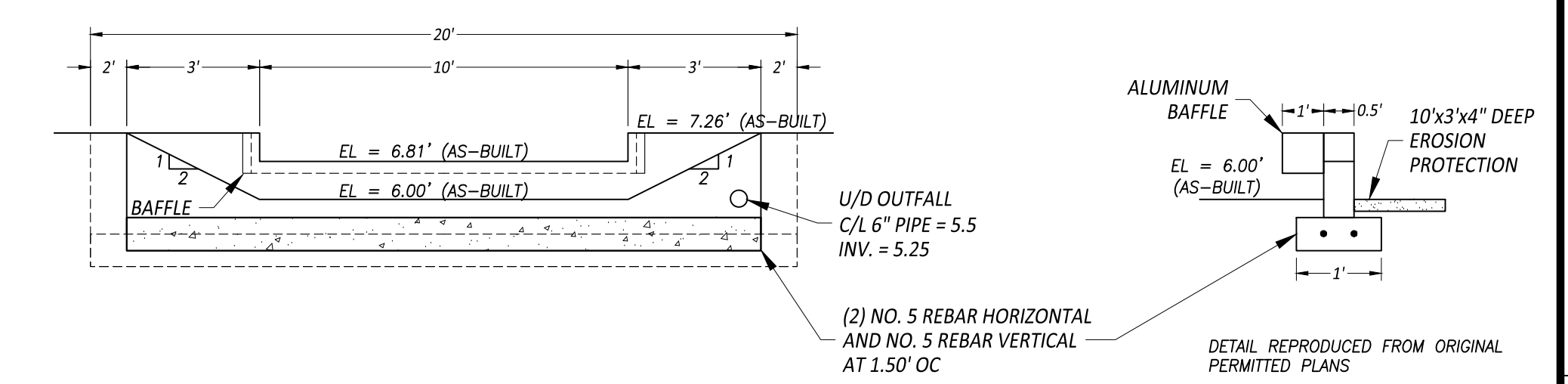

CONTROL STRUCTURE FOR POND B
NTS

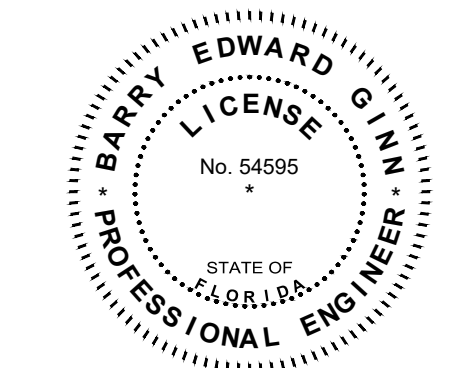

BARRY GINN, PE
STATE OF FLORIDA
PROFESSIONAL ENGINEER
LICENSE NO. - 54595

THIS ITEM HAS BEEN DIGITALLY SIGNED AND SEALED BY BARRY GINN, PE ON THE DATE INDICATED HERE. PRINTED COPIES OF THIS DOCUMENT ARE NOT CONSIDERED SIGNED AND SEALED AND THE SIGNATURE MUST BE VERIFIED ON ANY ELECTRONIC COPIES.

REVISIONS	

DA

DONAHUE ARCHITECTURE INC
1099 SW 17th Street, Ste. 201-165
Ocala, FL 34477
T 352.867.5148
E. barry@donahue-arch.com
LICENSE #A22000933
CERT. OF AUTH. # 32147

SITE/CIVIL PLANS

CROSS-SECTIONS AND DETAILS

A Site Plan for
Sunshine Garden ALF
311 NE 4th Avenue
Crystal River, Florida 34429
Citrus County, S21, T18S, R17E

DATE	16-Apr-20
JOB	D_19103A
DRAWN BY	B. GINN
C101	5
Schematic	5