

# Ocean Breeze Plaza

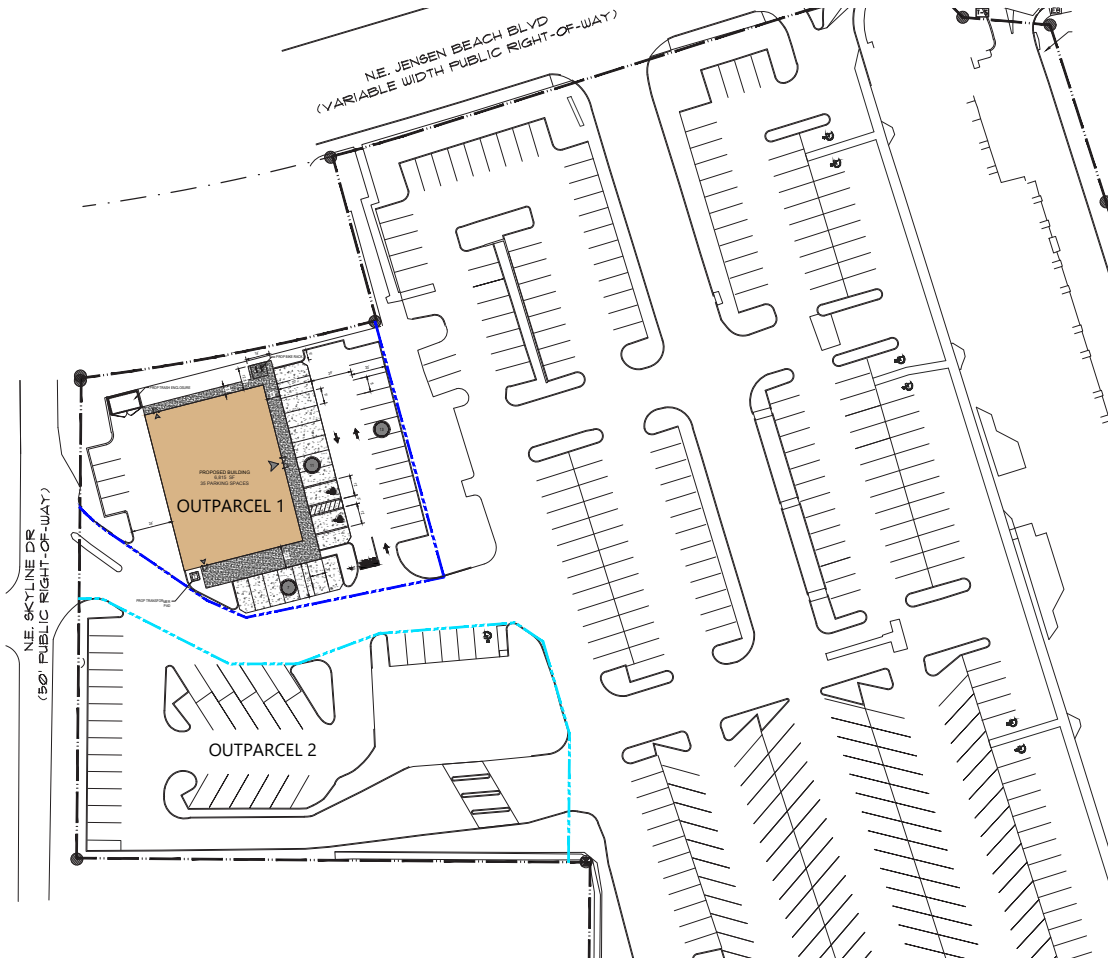

## OUTPARCEL OPPORTUNITY



1780 NE Jensen Beach Boulevard  
Ocean Breeze, FL 34957

LAT. 27.242635 | LONG. -80.227248

### PROPERTY INFORMATION

Murray Landing is a strong 96,192-square-foot retail center, benefiting from heavy foot traffic, a diverse tenant mix, and access to a close community.

**.87 & .91  
Acres**  
Availability

**Publix, Goodwill,  
Goodfella's Pizza**  
Major Tenants

**Jamie Pearson**  
770.355.0954  
jpearson@phillipseison.com  
Leasing Contact



## OUTPARCEL OPPORTUNITY



Space	Tenant	SQ. FT.
1780	Publix	45,600
1800	Current EV	7,950
1802	RISE Center IRC	12,852
1808	Goodwill	2,400
1810	Hometown Cleaners	800
1812	New York Haven Salon	800
1814	AVAILABLE	800
1816	Cali Nails	800
1818	Tobacco & Vape	800
1820	Mailbox Plus of Jensen Beach	800
1824	Ocean Breeze Liquor	2,600
1830	Ocean Breeze Beer Co	3,550
1840	Cinco De Mayo Mexican Cuisine	4,000
1846	New England Coffee House	930
1848B	The Scoop	1,950
1852	Jensen Beach Smiles	1,560
1854	The Wash Club	2,400
1858	Goodfella's Pizza	1,200
1862	Tropical Nektar Juice Company	1,600
1868	Crabby's Oyster Bar	2,800
<b>Total SQ. FT.</b>		<b>96,192</b>

■ Available 
  Occupied 
  Coming Available 
  Non-Owned 
  Site Boundary

# Ocean Breeze Plaza



**Jamie Pearson**  
**770.355.0954**  
[jpearson@phillipsseison.com](mailto:jpearson@phillipsseison.com)

**Leasing Contact**

