



# 8 West 126th Street

## Space availability summary

WeWork @ 8 West 126th Street  
New York, NY

**wework**

3rd Floor 31,358 RSF

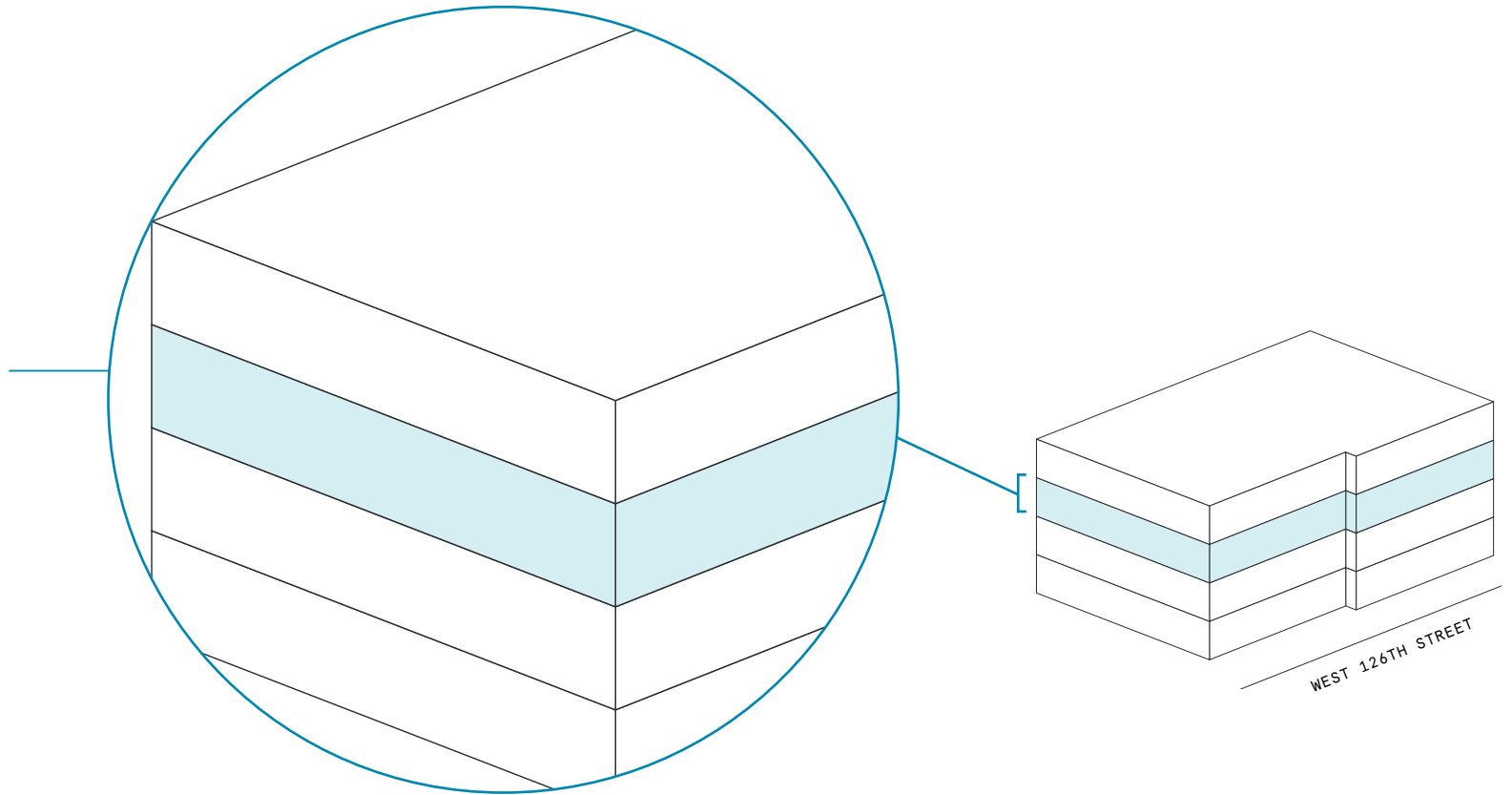

---

31,358 RSF

TOTAL WEWORK RSF

---

## 8 West 126th Street

At a glance

---

---

Workspaces designed for productivity and creativity with flexible size & term

---

4

TOTAL BUILDING FLOORS

---

Dedicated, private suites available from 72 to 3,070 RSF

---

Move-in ready suites — furnished & wired

---

101,408

TOTAL BUILDING SQ FT

All dimensions are approximate and subject to variances. It is your obligation to independently verify the particulars of the property. WeWork reserves the right to make changes.



Duochrome walls and yellow pendant lighting add visual interest to this shared workspace.



Large-scale paneled skylights flood the space with natural light.

## A modern workspace in the heart of historical Harlem

---

8 West 126th Street is located one block away from Harlem's burgeoning commercial hub. Built in 2016, this LEED Gold and Energy Star certified building features authentic industrial details and plenty of natural light. WeWork's two floors in 8 West 126th Street feature a mix of inviting lounges, sleek private offices, and mural-clad meeting rooms.



Pops of green and periwinkle complement this lounge's herringbone flooring, warm-toned furnishings, and brass accents



A custom mural in this meeting space pays homage to Harlem's rich cultural and creative histories.

# Bold, creative, and historically inspired

8 West 126th Street features a vibrant, modern design approach that embraces Harlem's rich cultural and creative legacy. Abundant natural light, warm wood finishes, and vintage furniture combine with bold custom artworks in this inviting, artistic workspace.

- Custom murals in meeting rooms pay homage to Harlem icons, including creatives of the Harlem Renaissance, the Harlem Globetrotters, and jazz legends like Louis Armstrong, Dizzy Gillespie, and Duke Ellington
- Herringbone flooring and neutral-toned seating in leather and locally sourced upholstery provide a warm backdrop for furnishings and artworks in bold colors and patterns
- Elevated wooden bleachers with nook seating evoke the feel of a stage or basketball court and provide space for connection



Nature-inspired wallcoverings and cool-toned seating feature in this serene mother's room.



Bright red and blue tones in meeting rooms stand out against the common areas' largely neutral palette.



Polished woodwork is a prominent feature of the space, seen here in seating nooks with bright geometric accents.



Wallpaper designed in-house brings character to intimate nooks and spaces.



The Community Desk staff are ready and willing to greet guests and assist members with their requests.

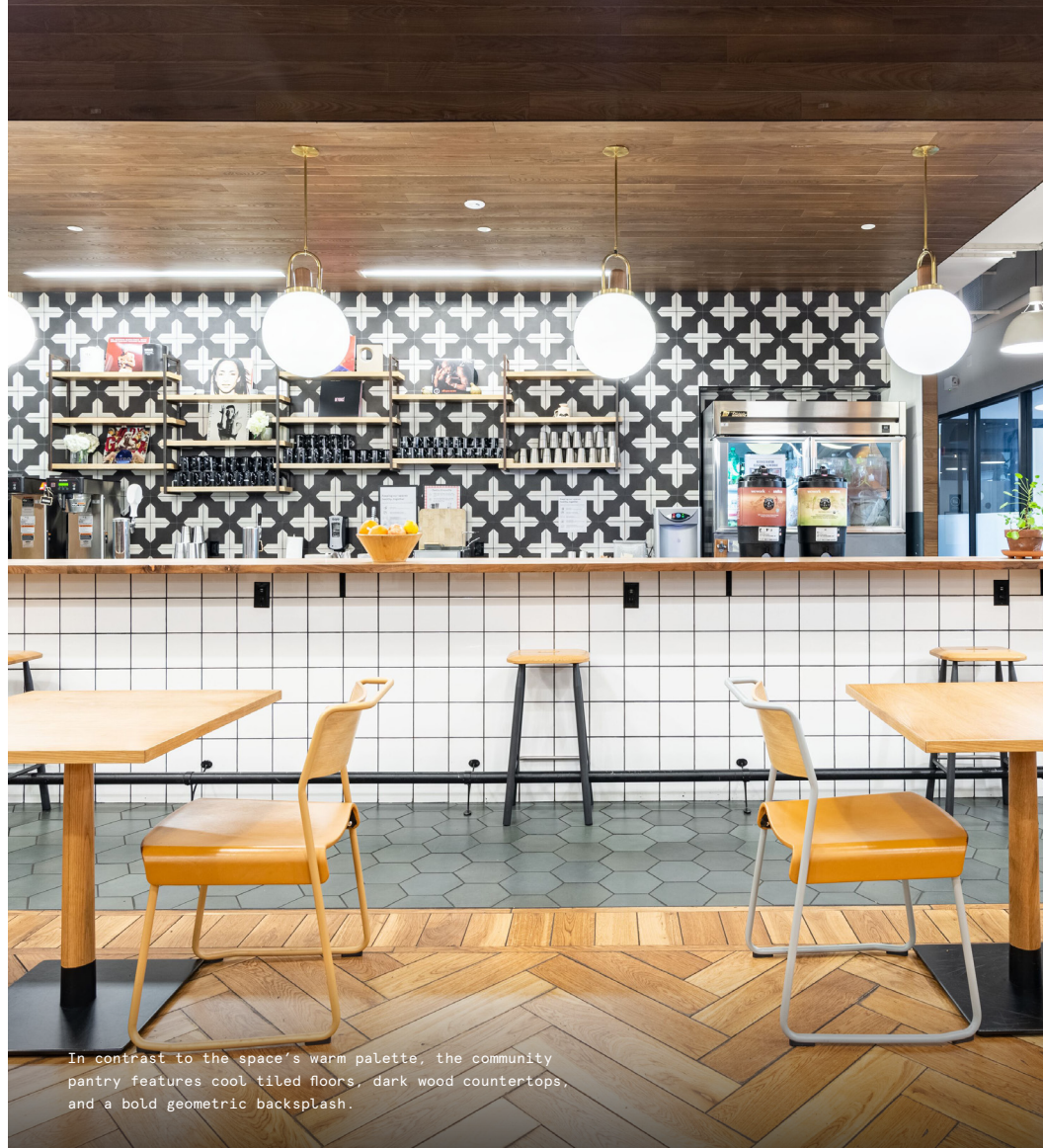

In contrast to the space's warm palette, the community pantry features cool tiled floors, dark wood countertops, and a bold geometric backsplash.

## On-site amenities

---

- Electronic keycard access
- Business-class printers
- Professional events and programming
- Stocked pantry
- US mail drop
- On-site staff
- Meeting rooms
- Mother's room
- Phone booths
- Event space
- Bicycle storage
- Supplemental HVAC and electric

# Building specifications

---



## Hours of operation

---

Monday – Friday: 9am–6pm



## Security

---

24/7 CCTV monitoring



## HVAC

---

Monday – Friday: 9am–6pm



## Building history

---

Built in 2016



## Elevators

---

2 passenger elevators  
with a capacity of 2,500 lbs



## Fire strategy

---

Fully-sprinklered floors



## Building size

---

4 stories  
101,408 SF



## Certifications

---

LEED Gold certified  
Energy Star certified  
WELL Health–Safety rated

# The best of Harlem just steps away

With its rich cultural history and fast-growing start-up community, Harlem is uniquely positioned as both a creative and commercial hub. 8 West 126th Street puts members in the center of it all—just down the block, this quiet street gives way to the shops, restaurants, and bars of bustling 125th Street. Marcus Garvey Park is just two blocks away, while the Apollo Theater, Jacob's Soul Food, and the Graffiti Hall of Fame offer plenty to see, do, and eat nearby.

## Distance to WeWork

2,3 Train	 Walk	5 min
Metro-North Railroad (Harlem–125th Street Station)	 Walk	7 min
4,5,6 Train	 Walk	9 min

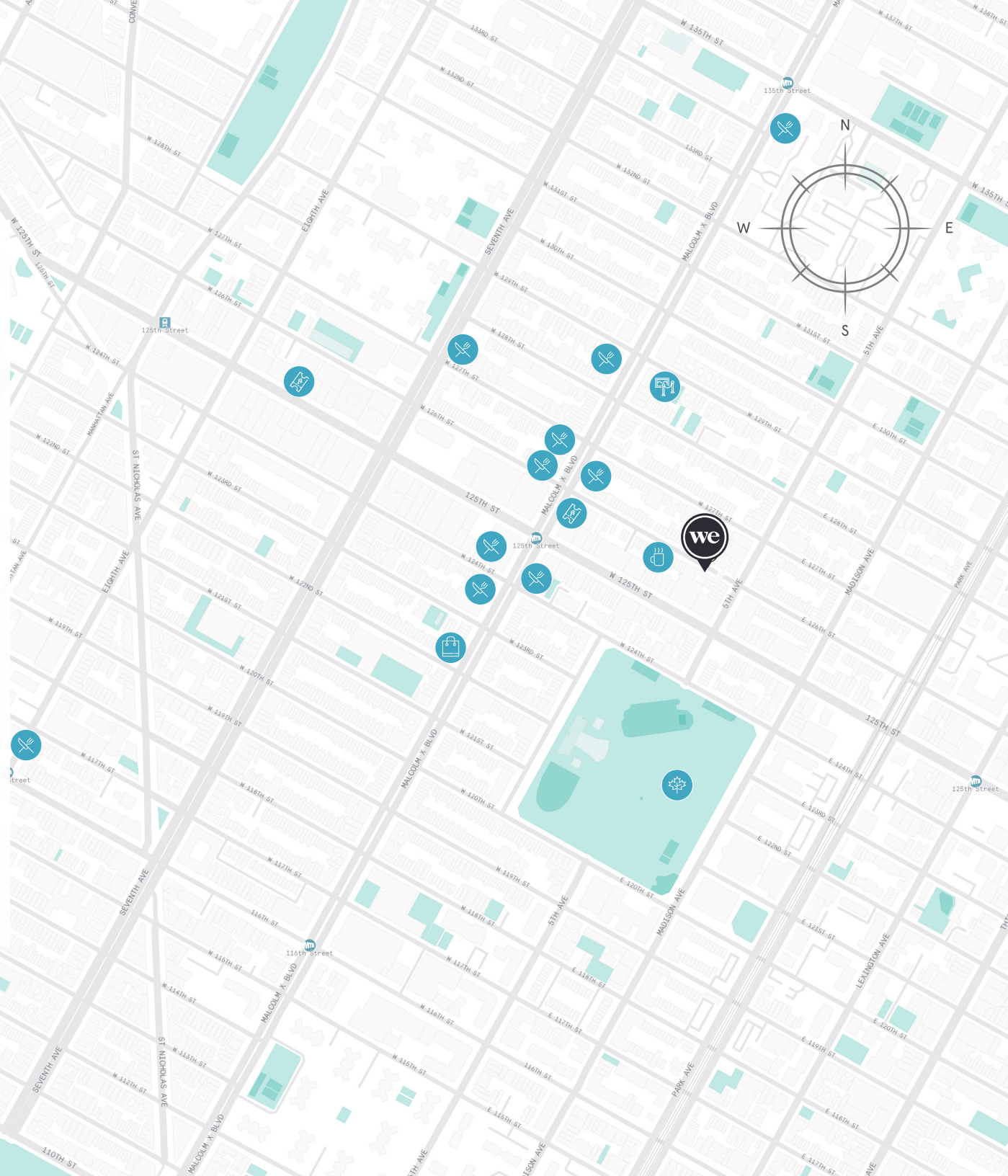

# 3rd Floor

31,358 RSF





9

MEETING ROOM(S)

10

SHARED WORKSPACE(S)

## LEGEND

-  MEETING ROOM
-  SHARED WORKSPACE
-  DEDICATED SPACE

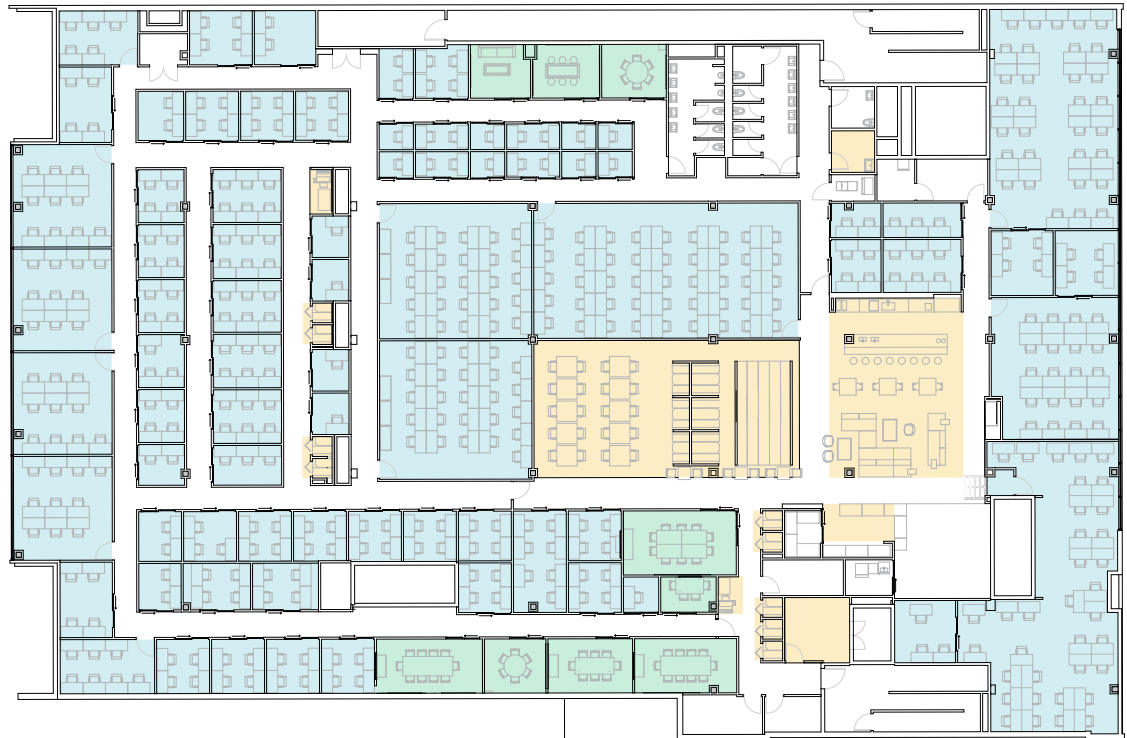

WEST 126TH STREET

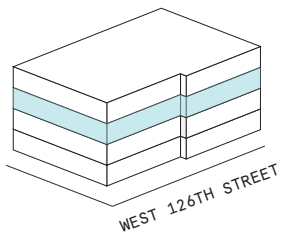

# 3rd Floor

31,358 RSF

3,070 RSF Suite 03A100



1  
PRIVATE OFFICE(S)

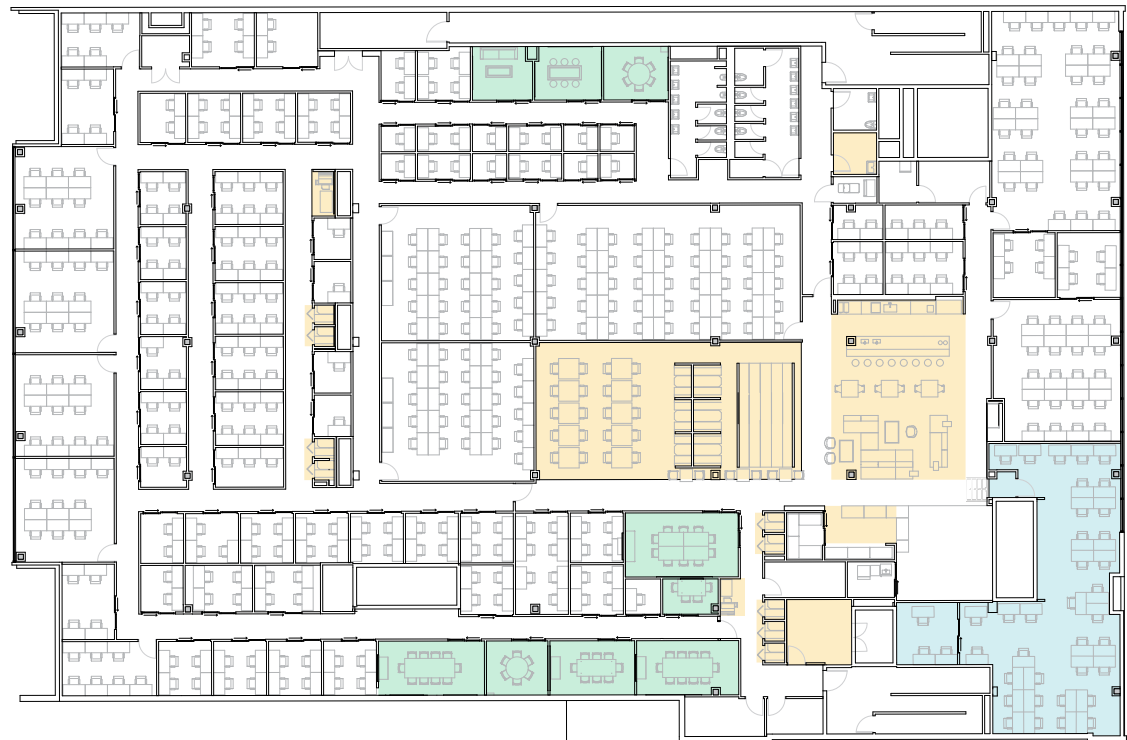

WEST 126TH STREET

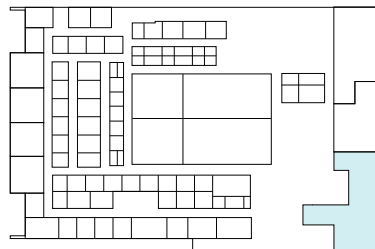

WEST 126TH STREET

# Suite 03A100

## 3rd Floor

1

PRIVATE OFFICE(S)

3,070 RSF

RENTABLE AREA

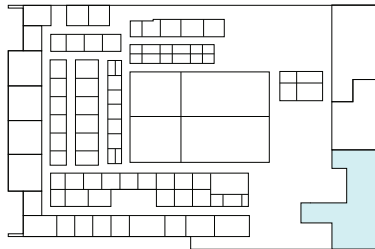

WEST 126TH STREET

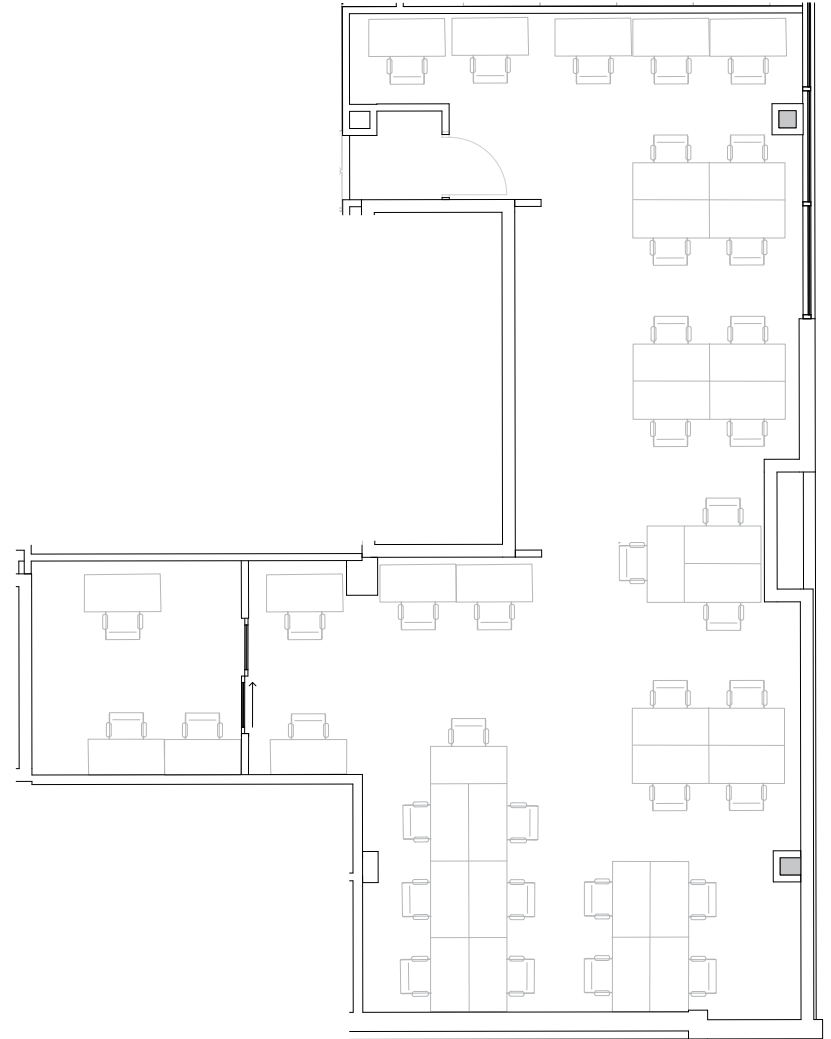

# 3rd Floor

31,358 RSF

1,814 RSF Suite 03A101



1  
PRIVATE OFFICE(S)



WEST 126TH STREET

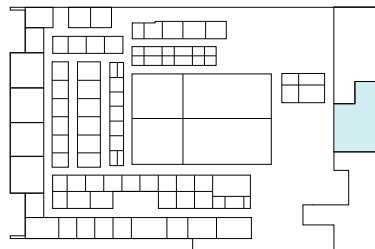

WEST 126TH STREET

# Suite 03A101

## 3rd Floor

1

PRIVATE OFFICE(S)

1,814 RSF

RENTABLE AREA

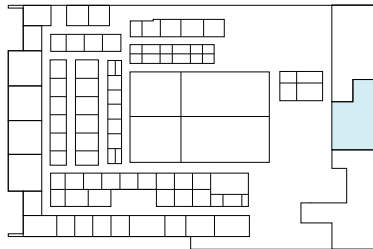

WEST 126TH STREET

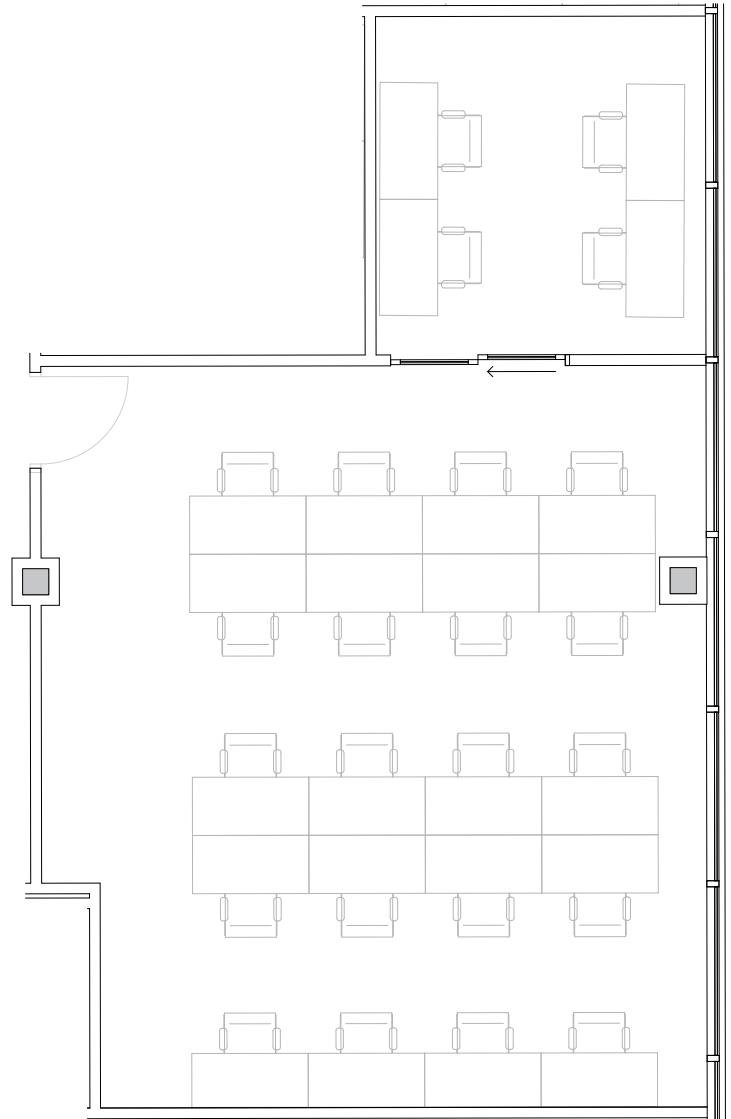

# 3rd Floor

31,358 RSF

2,673 RSF Suite 03A103



1  
PRIVATE OFFICE(S)

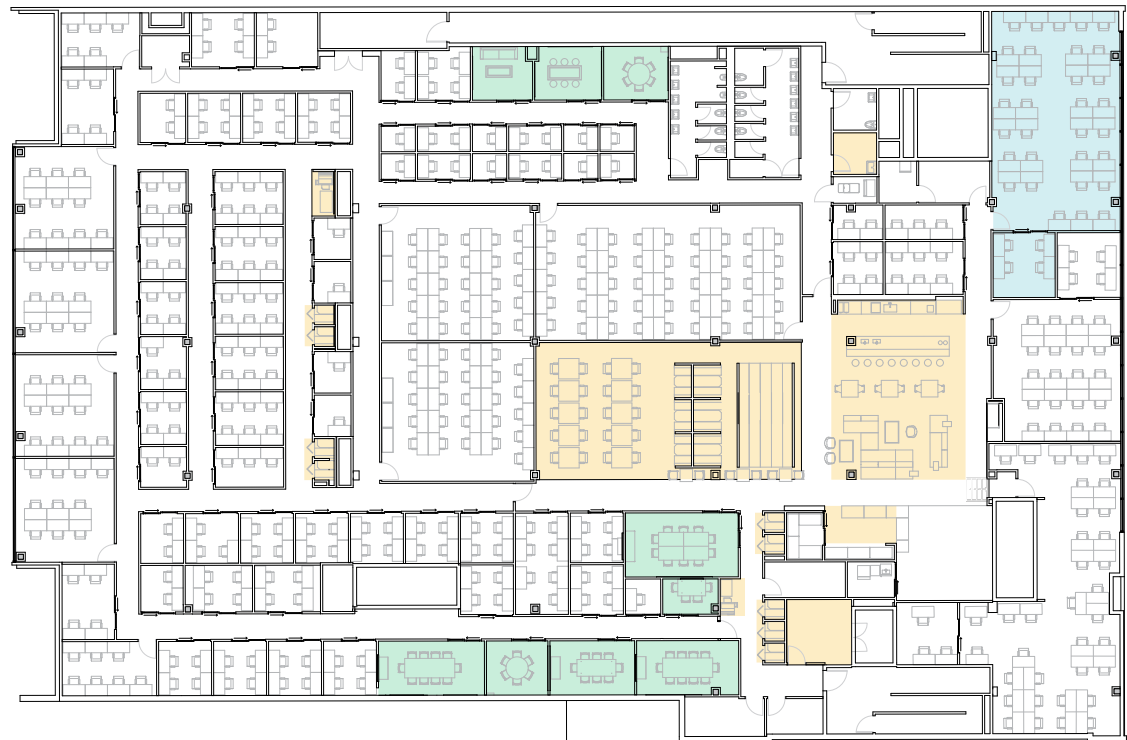

WEST 126TH STREET

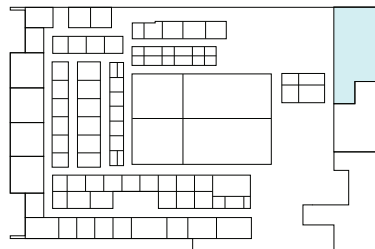

WEST 126TH STREET

# Suite 03A103

## 3rd Floor

1

PRIVATE OFFICE(S)

2,673 RSF

RENTABLE AREA

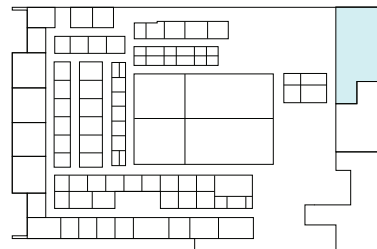

WEST 126TH STREET

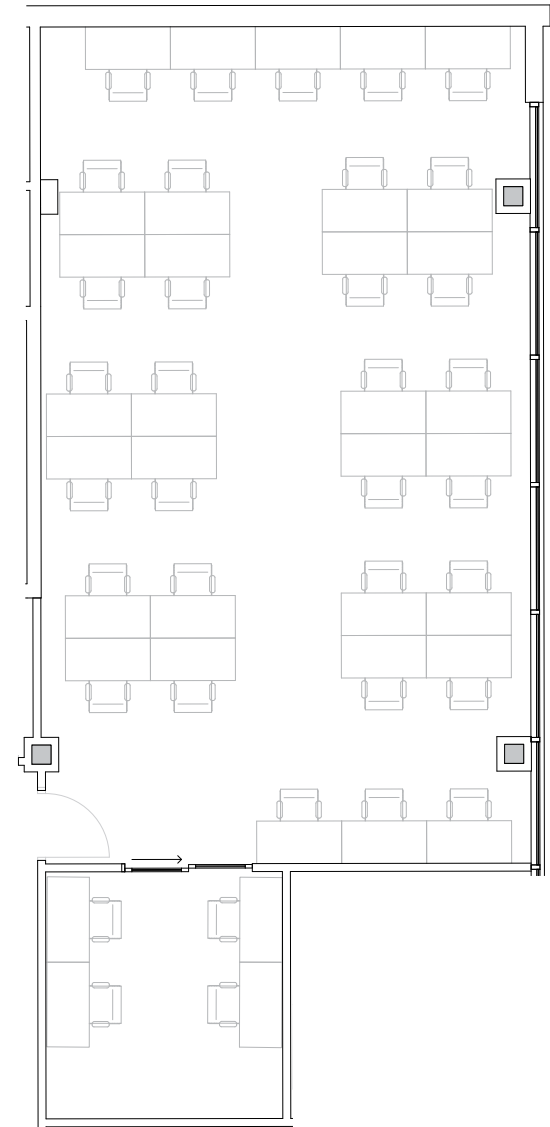

# 3rd Floor

31,358 RSF

1,744 RSF Suite 03D122

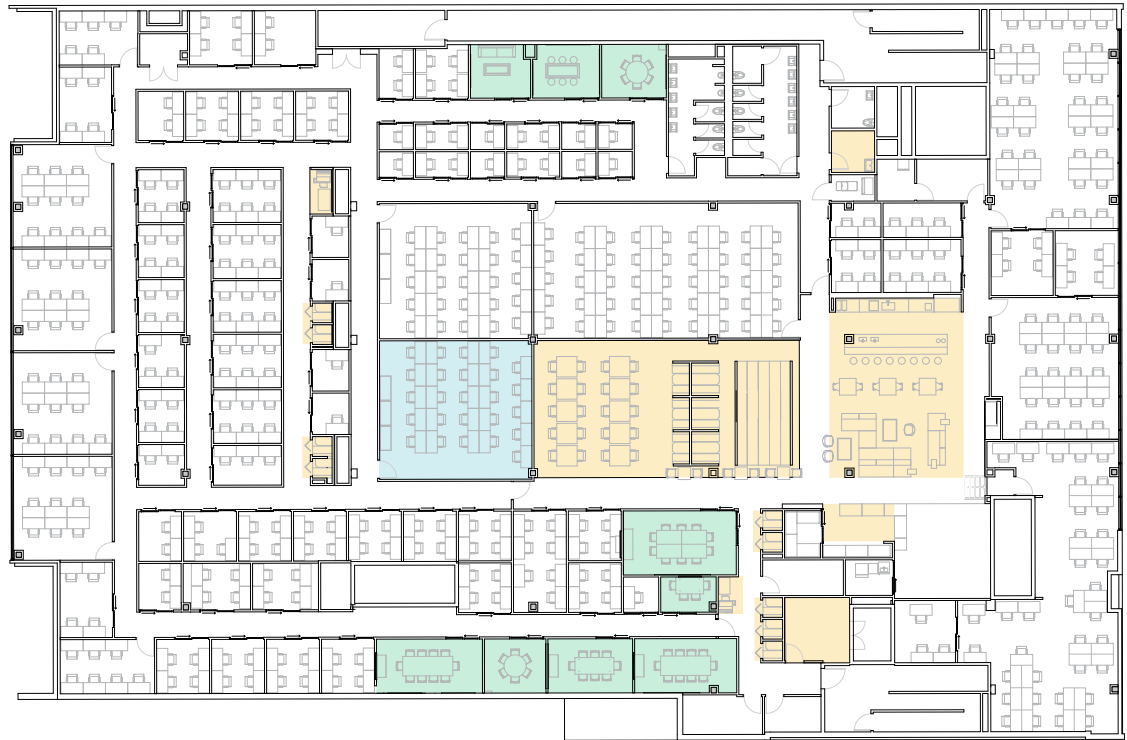

WEST 126TH STREET

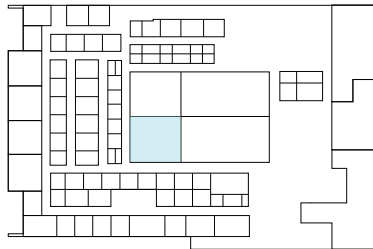

WEST 126TH STREET

# Suite 03D122

3rd Floor

1,744 RSF  
RENTABLE AREA

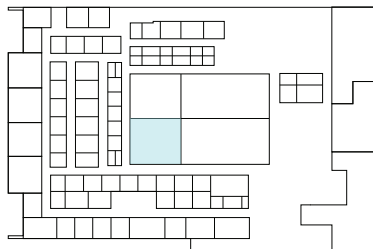
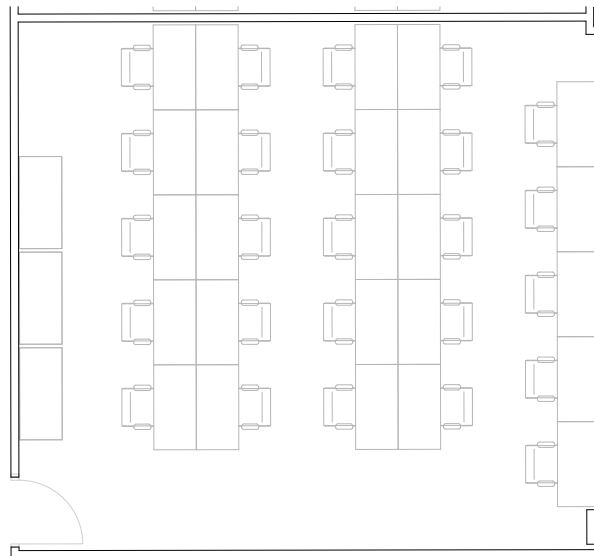

WEST 126TH STREET

# Contact

---

For leasing inquiries please reach out to our team.



## Harry Kucharczyk

PORTFOLIO DIRECTOR  
HARRY.KUCHARCZYK@WEWORK.COM  
516.507.0334

## Johnny Messina

SENIOR LEASING DIRECTOR  
JMESSINA@WEWORK.COM

## Charlie Solomon

LEASING MANAGER  
CHARLIE.SOLOMON@WEWORK.COM

© 2022 WeWork. The WeWork trademark and related logos are the property of WeWork Companies LLC. Any reference to third-party names are for reference and informational purposes only and should not be considered an endorsement or association of WeWork or vice versa. Photographs contained herein may be representative examples of various WeWork locations and do not necessarily depict the WeWork location referenced. While reasonable efforts have been made to check the accuracy of the information contained here, WeWork, its officers, employees, directors, and representatives, make no warranty, express or implied, regarding the accuracy of the information and disclaim any liability arising from the use of the information contained herein. All dimensions are approximate and subject to variances. It is your obligation to independently verify the particulars of the property. WeWork reserves the right to make changes.