

OWNER/USER OR INVESTMENT SALE

NEWMARK

MOUNTAIN WEST

ANDY MOFFITT

amoffitt@newmarkmw.com

direct 801.456.8811

[View Profile](#)

JEFFERY SORENSON

jsorensen@newmarkmw.com

direct 636.219.5642

[View Profile](#)

RYAN GUGGENHEIM

rguggenheim@newmarkmw.com

direct 216.644.3909

[View Profile](#)

1180 NORTH 134 WEST



PROPERTY DETAILS

1180 North 134 West, Tooele, Utah 84074

- Ideal for an Owner-User Seeking Space for Their Own Business While Benefiting From In-Place Rental Income.
- Situated Next to a Top Walmart in Tooele.
- Total of 16,644 of Versatile Spaces that Can be Used for Retail, Office, and/or Medical.
- Established Tenants include Wise Choice Realty, Holt's Pharmacy, and D'Lux Tanning Salon.
- Center Sits Off of Busy Main Street in Tooele County Surrounded by Major Retailers Including NAPA Auto Parts, Cafe Rio, Panda Express, and Deseret Industries.
- Tooele Sits Roughly 35 Minutes from Downtown Salt Lake City. It is Utah's Fastest Growing County with a 16% Increase in Population since 2020
- Tooele's Average Household Income Sits at \$90,000 with an Average Household Size of Three Individuals.

SURROUNDING TENANTS



INVESTMENT SUMMARY

SALE PRICE	\$4,400,000 (\$258/SF)
BUILDING SIZE	16,644 SF Buyer to Verify
SITE SIZE	0.52 Acres
PARCEL NUMBER	14-016-0-0003
YEAR BUILT	2001
ZONING	Commercial (NEC)

**FULL SERVICE
COMMERCIAL REAL ESTATE**

312 East South Temple

Salt Lake City, Utah 84111

Office 801.456.8800

www.newmarkmw.com



NEWMARK

MOUNTAIN WEST

ANDY MOFFITT

amoffitt@newmarkmw.com

direct 801.456.8811

[View Profile](#)

JEFFERY SORENSON

jsorensen@newmarkmw.com

direct 636.219.5642

[View Profile](#)

RYAN GUGGENHEIM

rguggenheim@newmarkmw.com

direct 216.644.3909

[View Profile](#)

SUITE	TOTAL SF	OCCUPIED SF	AVAILABLE SF
2-5	5,194		5,194
6	1,870	1,870	
7	1,540		1,540
8-9	2,756	2,756	
10	1,150		1,150
11-12	2,756	2,756	
13	1,378	1,378	
Total	16,644	8,760	7,884

TENANT	OCCUPIED SF	RENT/MONTH	RENT/SF
D'Lux Tan	2,756	\$6,568.48	\$28.60
Wise Choice Realty	1,378	\$1,699.50	\$14.80
Holt's Pharmacy	2,756	\$6,315.83	\$27.50
Graceful Growth Clinic	1,8970	\$3,272.50	\$21.00

FULL SERVICE COMMERCIAL REAL ESTATE

312 East South Temple

Salt Lake City, Utah 84111

Office 801.456.8800

www.newmarkmw.com



STREET SIDE

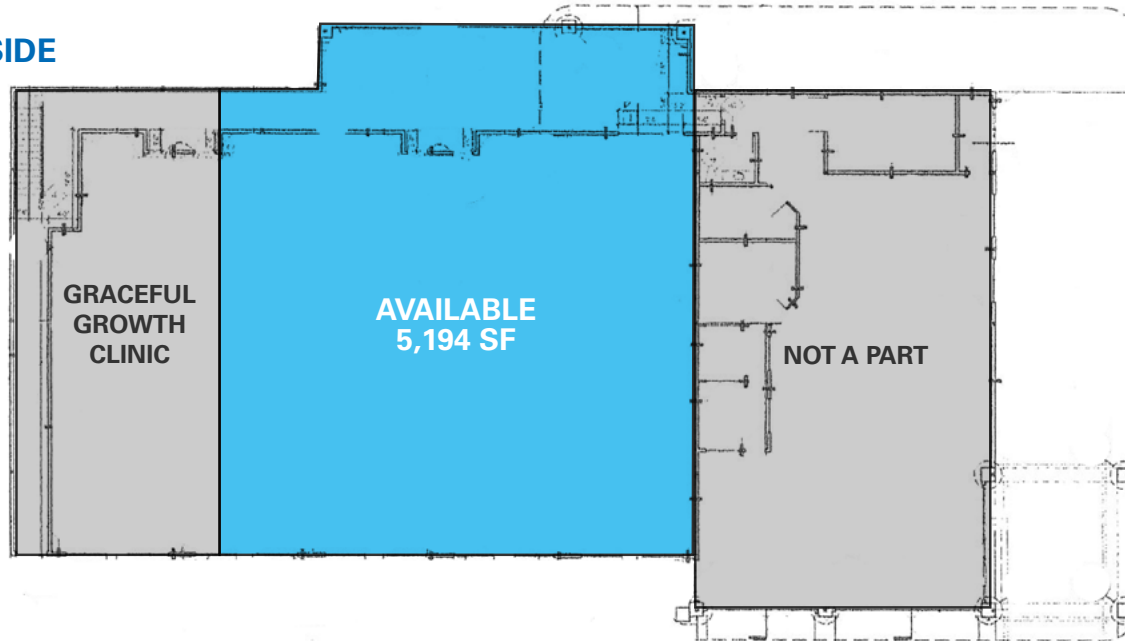

WALMART SIDE

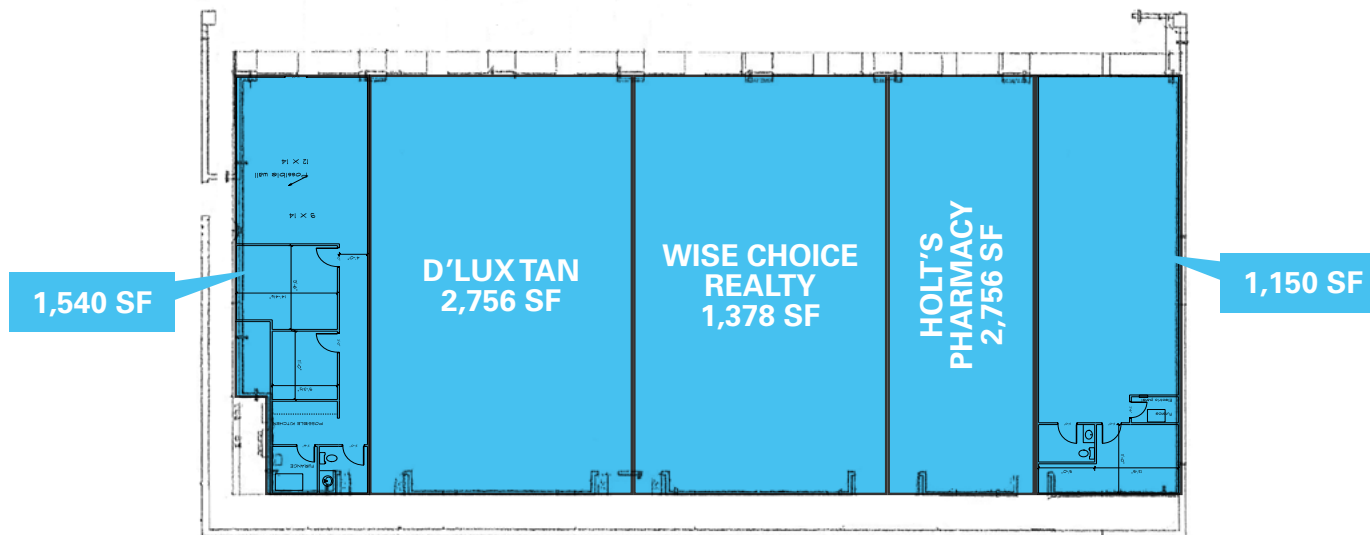

ANDY MOFFITT
 amoffitt@newmarkmw.com
 direct 801.456.8811
[View Profile](#)

JEFFERY SORENSON
 jsorensen@newmarkmw.com
 direct 636.219.5642
[View Profile](#)

RYAN GUGGENHEIM
 rguggenheim@newmarkmw.com
 direct 216.644.3909
[View Profile](#)

**FULL SERVICE
 COMMERCIAL REAL ESTATE**
 312 East South Temple
 Salt Lake City, Utah 84111
 Office 801.456.8800
www.newmarkmw.com

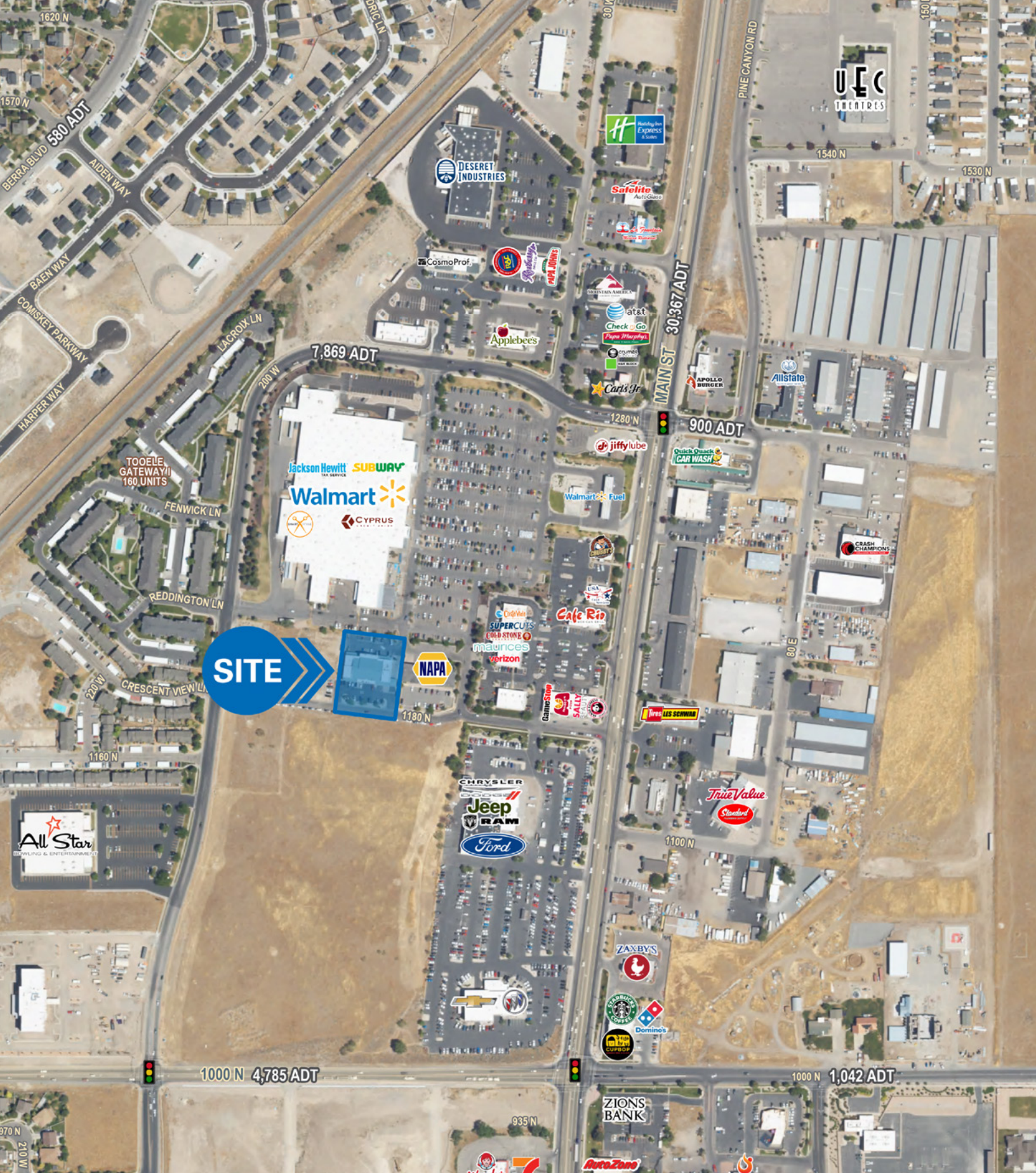

ANDY MOFFITT
 amoffitt@newmarkmw.com
 direct 801.456.8811
[View Profile](#)

JEFFERY SORENSON
 jsorensen@newmarkmw.com
 direct 636.219.5642
[View Profile](#)

RYAN GUGGENHEIM
 rguggenheim@newmarkmw.com
 direct 216.644.3909
[View Profile](#)

**FULL SERVICE
 COMMERCIAL REAL ESTATE**
 312 East South Temple
 Salt Lake City, Utah 84111
 Office 801.456.8800
www.newmarkmw.com