

1,200 SF | INDUSTRIAL | CANOGA PARK

1,200
SQUARE FEET

\$1.65/mo
APPROX RENT/SF

\$1,980/mo
BASE RENT

(818) 717-0200
www.tsko-re.com

PROPERTY ADDRESS

**21410 CHASE ST, UNIT 5
CANOGA PARK, CA 91311**

COMMERCIAL TYPE: **Multi-Tenant Industrial**

LEASE TYPE: **Gross** AVAILABLE: **11/1/2025**

DESCRIPTION

Unit Size (approximate): 1,200 square feet Industrial Space WAREHOUSE | Two Offices

Restroom: One (sink & toilet)
Power: 100-Amps Single Phase Parking: (3) Spaces
Overhead Door: Ground Level about 12'x10'
Evaporative Cooler & Space Heater in Warehouse
Warehouse Clearance is 12'

Tenant pays for its own electricity, gas (heating), telephone, internet. Water & Trash reimbursed through CAMs
Please no woodworkers, welders, marijuana or automotive use

* Subject to Credit and Financial Review.
* Monthly Estimated CAM Fee: \$144.00 (\$.12 PSF)
* Term: 1 to 3 Years
* Security Deposit Amount will be determined upon review of credit report, bank statements and/or Business Financial Statements

AMENITIES

- 12' x 10' Overhead Door
- Secured Parking

RENTAL TERMS

Monthly Base Rent	\$1,980.00
Security Deposit	Based on Financials
Estimated CAM FEE	\$144.00 per month (\$.12)

Total Estimated Monthly Cost is \$2,124.00

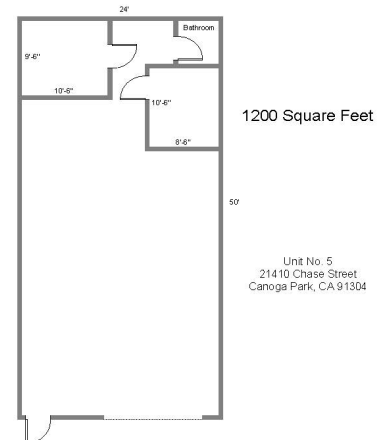

Prepared By...
THE SIMPSON COMPANY
REAL ESTATE MANAGEMENT AND BROKERAGE
9410 Topanga Canyon Blvd., Suite 105
Chatsworth, CA 91311
(T) 818.717.0200 • (F) 818.717.0257
Website: www.tsko-realestate.com
DRE License # 01264732
*These drawings are provided as an illustration of the available space.
All dimensions are approximate. Prospect is advised to verify physical dimensions.*



AVAILABLE
INDUSTRIAL WAREHOUSE
818-717-0200
JEREMY WACKER

THE SIMPSON COMPANY
REAL ESTATE MANAGEMENT AND BROKERAGE
SPECIALIZING IN MULTI-TENANT INDUSTRIAL PROPERTIES
tscorealestate.com

FOR LEASING INFORMATION
JEREMY WACKER 818-717-0200 x17

JWacker@tsco-re.com

DRE License 01986677

THE SIMPSON COMPANY
REAL ESTATE MANAGEMENT AND BROKERAGE
CORP DRE LICENSE 01264732