

3845 Shopton Road

Charlotte, NC

Key Facts

Property type Industrial space

Building size 102,400 SF

Space available 6,444 SF



Contact Us

Learn more about this property or schedule a tour by reaching out to our local investment and leasing officer.

Thomas Nielsen

+1 (251) 230-0250

thomas.nielsen@eqtpartners.com

3845 Shopton Road

Charlotte, NC

BUILDING SPECIFICATIONS

Total Building Space: 102,400 SF
Building Space Available: 6,444 SF
Office Space: ± 1,164 SF
2.7 / 1,000 parking ratio
Warehouse Lighting: LED with motion sensors
Drive-In Doors: 1 (9' x 10')
Dock-High Doors: 1 (9' x 10') with pit-leveler and dock seal
Clear Height: 18'
Move-In Ready



Contact Us

Learn more about this property or schedule a tour by reaching out to our local investment and leasing officer.

Thomas Nielsen

+1 (251) 230-0250

thomas.nielsen@eqtpartners.com

3845 Shopton Road

Charlotte, NC

SITE PLAN

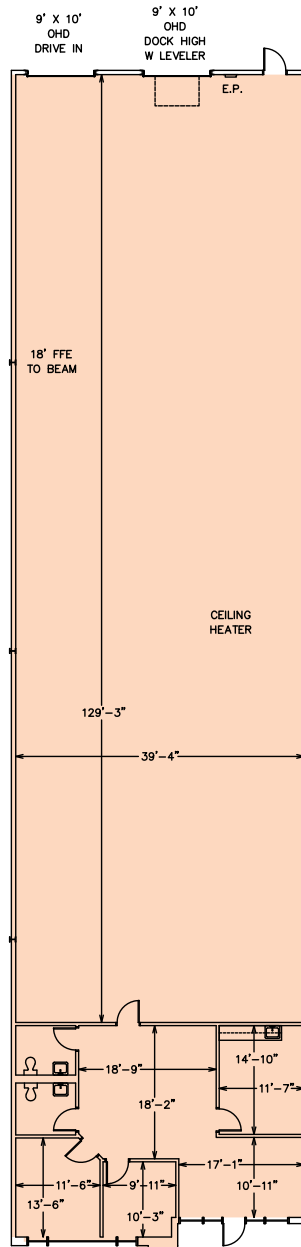

3845 SHOPTON RD
SUITE 450
6,444 TOTAL RSF
1,164 SF OFFICE

Contact Us

Learn more about this property or schedule a tour by reaching out to our local investment and leasing officer.

Thomas Nielsen

+1 (251) 230-0250

thomas.nielsen@eqtpartners.com

3845 Shopton Road

Charlotte, NC

LOCATION



Contact Us

Learn more about this property or schedule a tour by reaching out to our local investment and leasing officer.

Thomas Nielsen

+1 (251) 230-0250

thomas.nielsen@eqtpartners.com