

**±2,004 SF INDUSTRIAL  
SPACE AVAILABLE FOR  
SUBLEASE**

14055 KIRKHAM WAY  
POWAY, CA 92064

**CARTER SHANNON**

Associate

Lic.# 02244724

858.458.3303

[cshannon@voitco.com](mailto:cshannon@voitco.com)

**GREG MARX, SIOR**

Senior Vice President

Lic.# 01940696

858.458.3302

[gmarx@voitco.com](mailto:gmarx@voitco.com)

***Voit***

REAL ESTATE SERVICES



## PROPERTY FEATURES

<b>BUILDING SIZE</b>	±13,346 Square Feet
<b>AVAILABLE SIZE</b>	±2,004 Square Feet
<b>LOT SIZE</b>	±6.83 Acres
<b>CLEAR HEIGHT</b>	18
<b>PARKING RATIO</b>	2.4/1,000 SF
<b>YEAR BUILT</b>	2004
<b>POWER (SUITE F)</b>	200a/120 - 208v 3p (Subtenant to verify)
<b>ZONING</b>	LI Zoning



**±2,004 SQUARE FEET**

SUITE 104

**\$1.00 NNN (NNN'S = ±\$0.45/SF)**

FIRST MONTH SUBLEASE PROMO

**DECEMBER 31, 2028**

LEASE EXPIRATION

# FLOOR PLAN

SUITE 104  
±2,004 SF

LEASE RATE

FIRST MONTH SUBLEASE PROMO  
\$1.00 NNN (NNN'S= ±\$0.45/SF)

SUITE LAYOUT  
20% OFFICE/ 80% WAREHOUSE

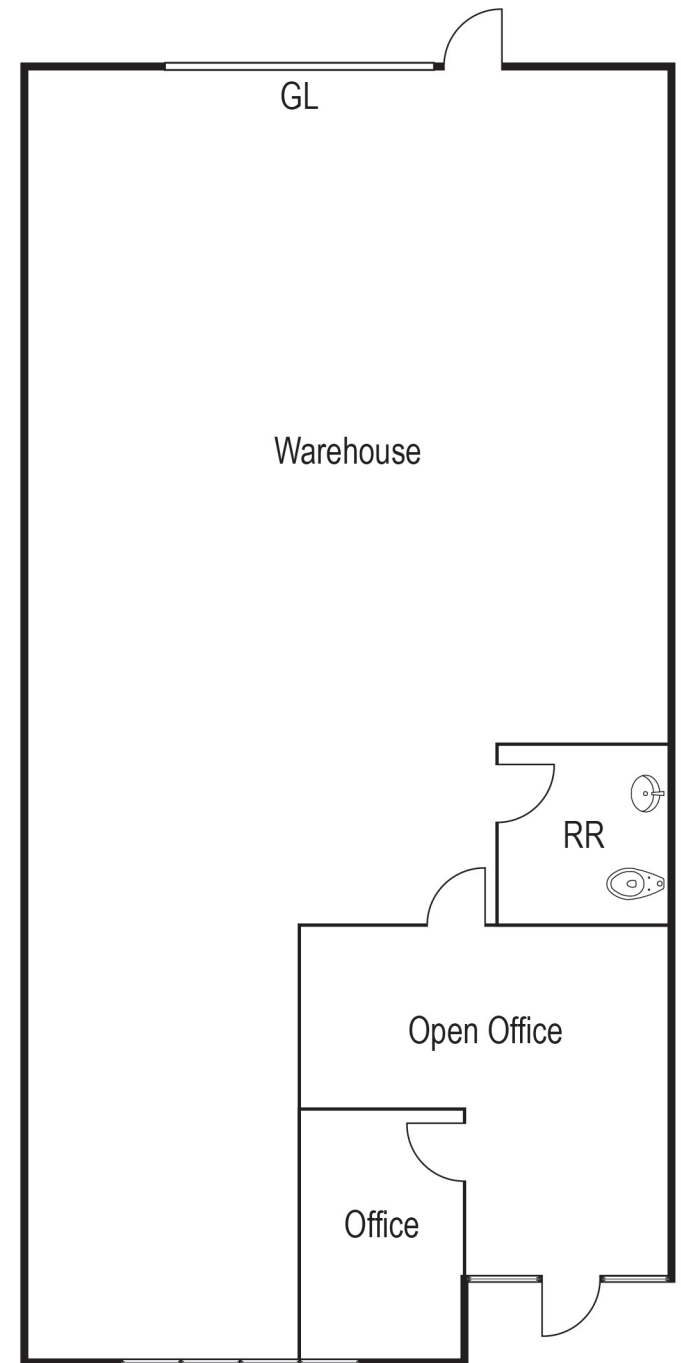







**CARTER SHANNON**

Associate  
Lic.# 02244724  
858.458.3303  
cshannon@voitco.com

**GREG MARX, SIOR**

Senior Vice President  
Lic.# 01940696  
858.458.3302  
gmarx@voitco.com



4180 La Jolla Village Drive, Suite 100, La Jolla, CA 92037 | 858.453.0505 | Lic.#01991785 | [www.voitco.com](http://www.voitco.com)

Licensed as Real Estate Salespersons by the DRE. The information contained herein has been obtained from sources we deem reliable. While we have no reason to doubt its accuracy, we do not guarantee it. ©2026 Voit Real Estate Services, Inc. All Rights Reserved.