

FOR LEASE: +/- 30,000 SF FIRST GENERATION WAREHOUSE/ DISTRIBUTION SPACE

PENDER COMMERCE PARK | 353 ACME WAY

WILMINGTON, NC | NEW HANOVER COUNTY





SUMMARY

30,000 SF of first generation warehouse/distribution space for lease in Pender Commerce Park. The space will be delivered in shell condition in late 2024. The unit is 250'W x 120' D, with 34' eave height (30' clear) and full fire suppression. The office buildout is TBD, and can be customized to the tenant's needs. Lease rate is estimated to be \$9.95/SF NN (estimated at \$1.50/SF), depending on tenant's interior buildout needs. The space will be offered with two (2) dock high doors and ample vehicle parking. Additional dock positions could be constructed.

ADDRESS	Pender Commerce Park 353 Acme Way Wilmington, NC 28405 New Hanover County
AVAILABLE SF	± 22,500—30,000
LEASE RATE	\$9.95 PSF NNN

PHOTOS



RENDERINGS



PENDER COMMERCE PARK | 353 ACME WAY | WILMINGTON

LOADING DOCKS



SITE PLAN

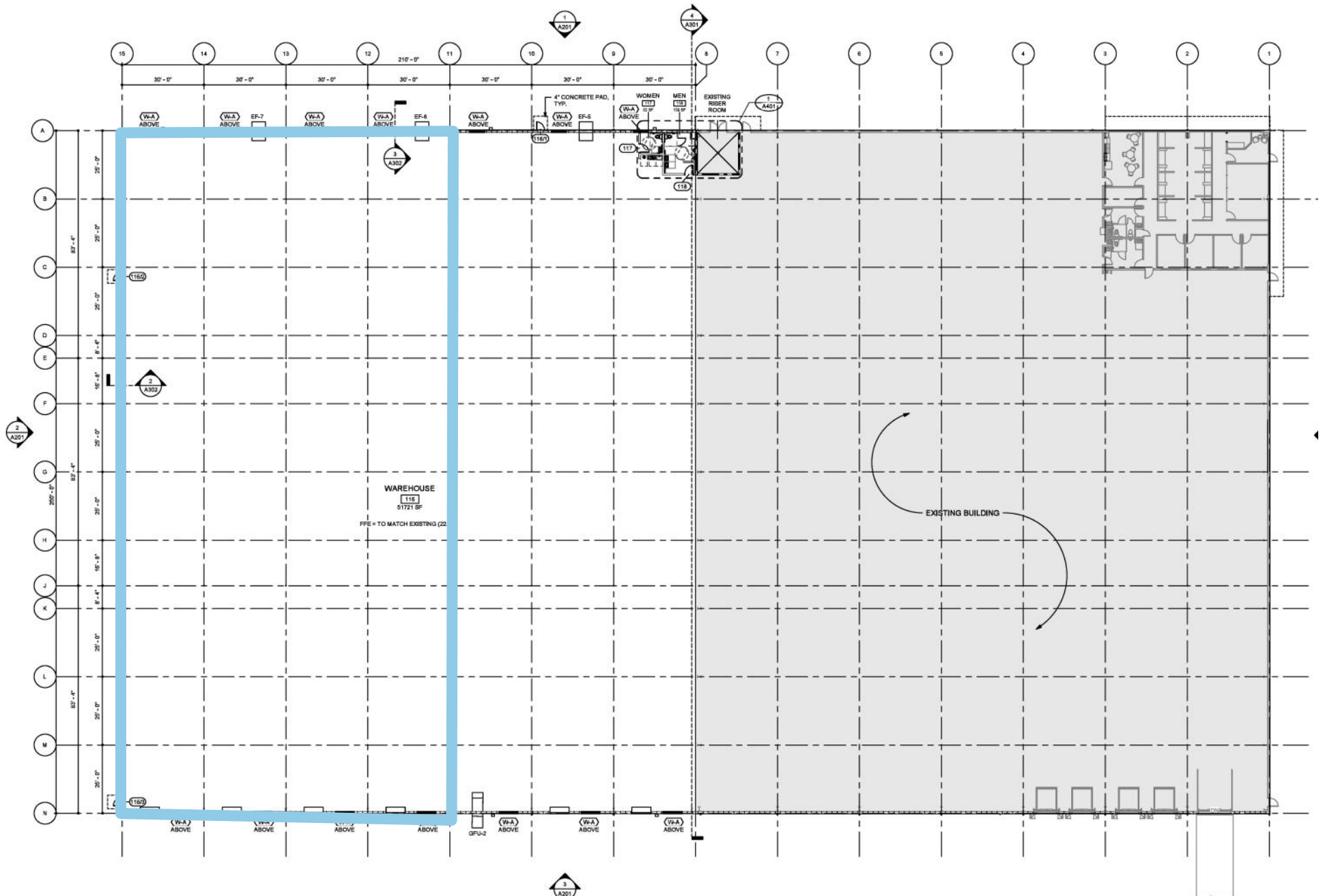

AERIAL MAP



Coastal Beverage Company

Pender County Water Plant

Maersk Warehousing and Distribution Services

SUBJECT
Polyhose Inc. Building Expansion

FedEx Freight

Empire Distributors

SCP Distributors

LOCATION MAP

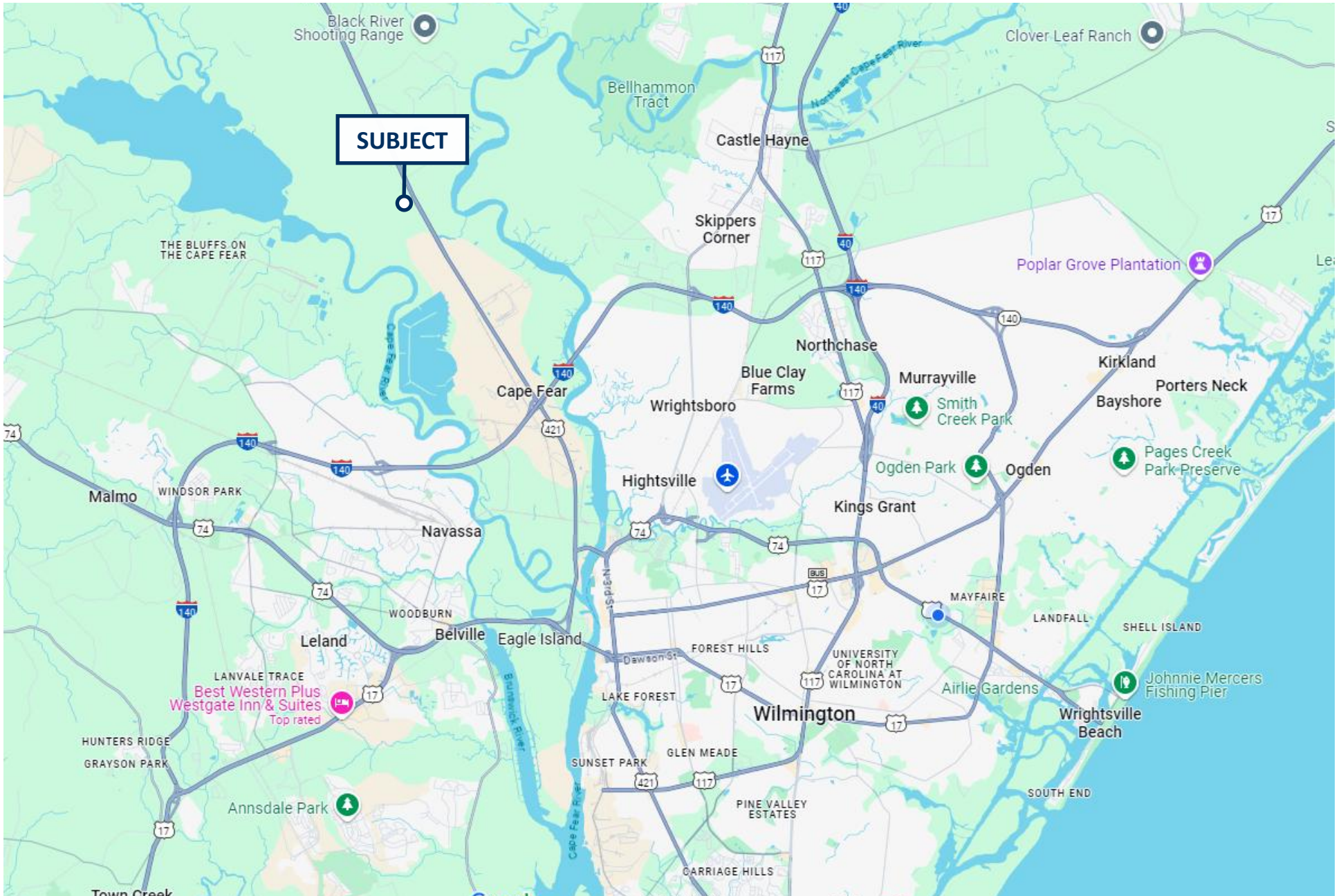



Cape Fear Commercial

WILL LEONARD, SIOR

Senior Vice President

910.344.1015 direct

910.233.5351

wleonard@capefearcommercial.com



102 Autumn Hall Drive | Suite 210 | Wilmington, NC 28403

capefearcommercial.com

© 2023 Cape Fear Commercial, LLC. All rights reserved. The information contained in the following Marketing Brochure is proprietary and strictly confidential. It is intended to be reviewed only by the party receiving it from Cape Fear Commercial and should not be made available to any other person or entity without the written consent of Cape Fear Commercial. This Marketing Brochure has been prepared to provide summary, unverified information to prospective purchasers, and to establish only a preliminary level of interest in the Subject property. The information contained herein is not a substitute for a thorough due diligence investigation. Cape Fear Commercial has not made any investigation, and makes no warranty or representation, with respect to the income or expenses for the Subject property, the future projected financial performance of the property, the size and square footage of the property and improvements, the presence or absence of contaminate substances, PCB's or asbestos, the compliance with State and Federal regulations, the physical condition of the improvements thereon, or the financial condition or the business prospects of any tenant's plans or intentions to continue its occupancy of the Subject property. The information contained in this Marketing Brochure has been obtained from sources we believe to be reliable; however, Cape Fear Commercial has not verified, and will not verify, any of the information contained herein, nor has Cape Fear Commercial conducted any investigation regarding these matters and makes no warranty or representation whatsoever regarding the accuracy or completeness of the Information provided. All potential buyers must take appropriate measures to verify all of the information set forth herein.