



SITE

23 W COURT STREET
Cincinnati, OH 45202

Haleigh Jones

haleigh@onsiteretailgroup.com
513.268.4453

OnSite
Retail Group

The information herein is produced using data from private and government sources deemed to be reliable and is provided without representation or warranty. Logos are for identification purposes only and may be trademarks of their respective companies. © 2025 OnSite Retail Group, LLC All Rights Reserved.



23 W COURT STREET
Cincinnati, OH 45202

Haleigh Jones
 haleigh@onsiteretailgroup.com
 513.268.4453

OnSite
 Retail Group

The information herein is produced using data from private and government sources deemed to be reliable and is provided without representation or warranty. Logos are for identification purposes only and may be trademarks of their respective companies. © 2025 OnSite Retail Group, LLC All Rights Reserved.



HAMILTON COUNTY COURT HOUSE

cincinnati public library

COURT STREET KITCHEN

Mid-City RESTAURANT

Alo

GREAT FOOD HAWKERS ALLEY FOR VINE

QUEEN CITY EXCHANGE

Vine St

Available 4,420 SF (Divisible)

W Court St



Public Parking

Haleigh Jones
haleigh@onsiteretailgroup.com
513.268.4453

23 W COURT STREET
Cincinnati, OH 45202



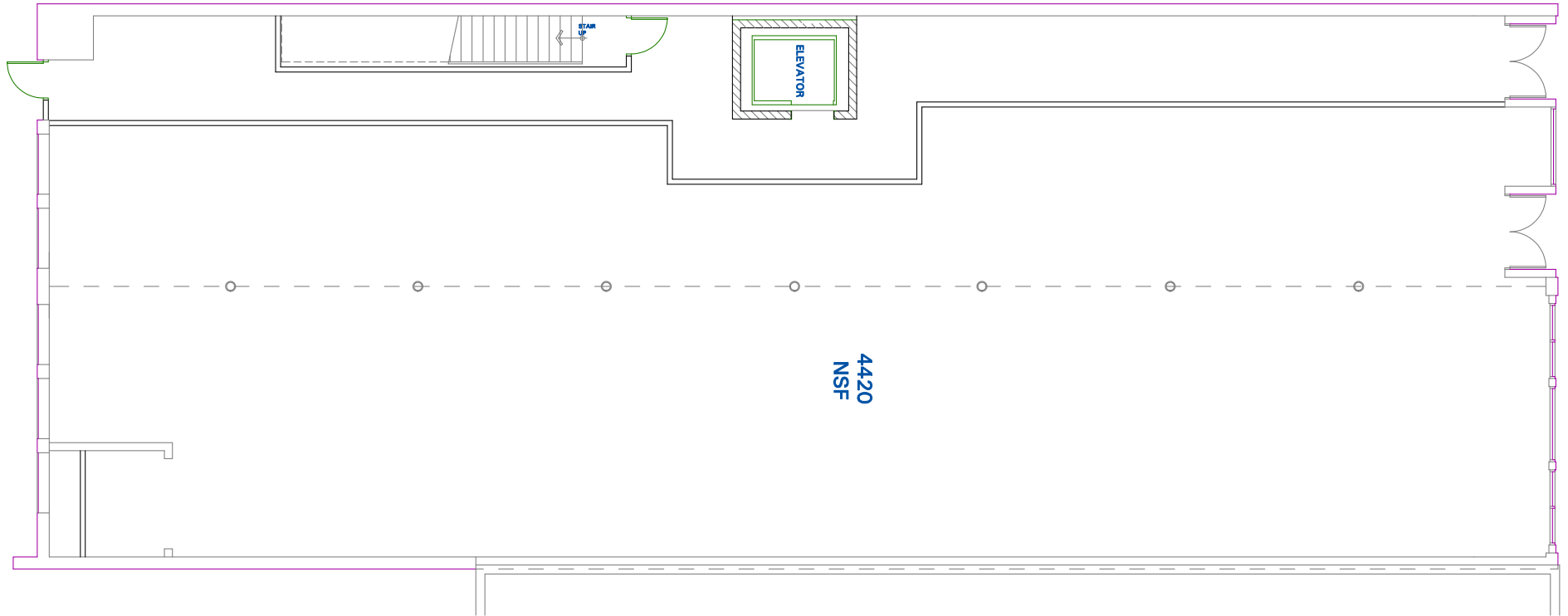

FIRST FLOOR PLAN

SCALE: 1/8" = 1'-0"

Haleigh Jones

haleigh@onsiteretailgroup.com

513.268.4453

23 W COURT STREET
Cincinnati, OH 45202





AI RENDERING



AI RENDERING

Haleigh Jones

haleigh@onsiteretailgroup.com
513.268.4453

23 W COURT STREET
Cincinnati, OH 45202



Summary Profile

2010-2020 Census, 2025 Estimates with 2030 Projections
 Calculated using Weighted Block Centroid from Block Groups



Lat/Lon: 39.1059/-84.5151

23 W Court St Cincinnati, OH 45202	1 mi radius	3 mi radius	5 mi radius
Population			
2025 Estimated Population	26,716	159,998	334,299
2030 Projected Population	30,301	167,878	339,614
2020 Census Population	20,121	139,151	309,726
2010 Census Population	20,056	138,163	305,595
Projected Annual Growth 2025 to 2030	2.7%	1.0%	0.3%
Historical Annual Growth 2010 to 2025	2.2%	1.1%	0.6%
2025 Median Age	32.3	32.4	33.8
Households			
2025 Estimated Households	14,816	74,251	149,583
2030 Projected Households	17,209	79,738	154,612
2020 Census Households	10,778	62,984	136,291
2010 Census Households	9,482	60,160	131,390
Projected Annual Growth 2025 to 2030	3.2%	1.5%	0.7%
Historical Annual Growth 2010 to 2025	3.8%	1.6%	0.9%
Race and Ethnicity			
2025 Estimated White	53.1%	65.8%	64.8%
2025 Estimated Black or African American	38.9%	24.7%	26.0%
2025 Estimated Asian or Pacific Islander	3.1%	3.1%	2.4%
2025 Estimated American Indian or Native Alaskan	0.1%	0.2%	0.2%
2025 Estimated Other Races	4.9%	6.3%	6.5%
2025 Estimated Hispanic	3.9%	5.2%	5.4%
Income			
2025 Estimated Average Household Income	\$118,706	\$89,195	\$97,037
2025 Estimated Median Household Income	\$78,167	\$61,240	\$68,261
2025 Estimated Per Capita Income	\$66,242	\$41,933	\$43,784
Education (Age 25+)			
2025 Estimated Elementary (Grade Level 0 to 8)	2.0%	3.3%	3.1%
2025 Estimated Some High School (Grade Level 9 to 11)	6.1%	6.7%	6.3%
2025 Estimated High School Graduate	16.1%	23.5%	24.8%
2025 Estimated Some College	14.4%	15.8%	16.2%
2025 Estimated Associates Degree Only	5.0%	6.7%	7.5%
2025 Estimated Bachelors Degree Only	33.1%	25.3%	23.7%
2025 Estimated Graduate Degree	23.3%	18.6%	18.5%
Business			
2025 Estimated Total Businesses	3,586	8,977	14,424
2025 Estimated Total Employees	58,082	129,718	181,241
2025 Estimated Employee Population per Business	16.2	14.5	12.6
2025 Estimated Residential Population per Business	7.5	17.8	23.2