



**±10,000-36,818 SF Office/Warehouse/Shop Facility**

**PROJECT FEATURES**

- Total Size: ±10,000-36,818 SF Total
- Office: ±6,384 SF Total (3-Floors)
  - 1st Level: ±2,128 SF
  - 2nd Level: ±2,128 SF
  - 3rd Level: ±2,128 SF
- Warehouse: ±30,434 SF
- Land: ±2.327 Acres
- Clear Height: 16'-30'
- Three (3) Grade Level Doors
- Gated Truck Court / Laydown Yard
- Stabilized Outside Storage Area
- Located in Harris County
- Metal Construction
- Located at the SW Corner of 3rd Street and Katy Fort Bend Road in the West Houston Market
- Call for Pricing

Located in the Far West Houston/Katy Area w/ Excellent Visibility from I-10 with Great Access to I-10, Grand Parkway, Beltway 8 and Houston's Major Thoroughfares

**5007 E. 3rd St. - Katy, TX 77493**

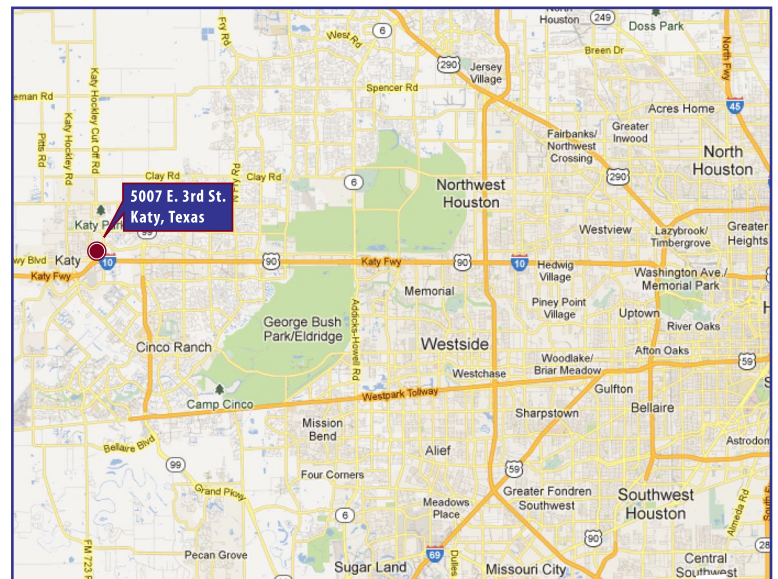

**Mary Jo Giammalva - Sr. VP**  
Phone: 713.784.7774 • Mobile: 713.805.4728  
maryjogb@jlm-commercial.com

**Lane F. Guinn - President**  
Phone: 713.784.7770 • Mobile: 832.865.3044  
lguinn@jlm-commercial.com  
www.jlm-commercial.com



**Floor Plan**

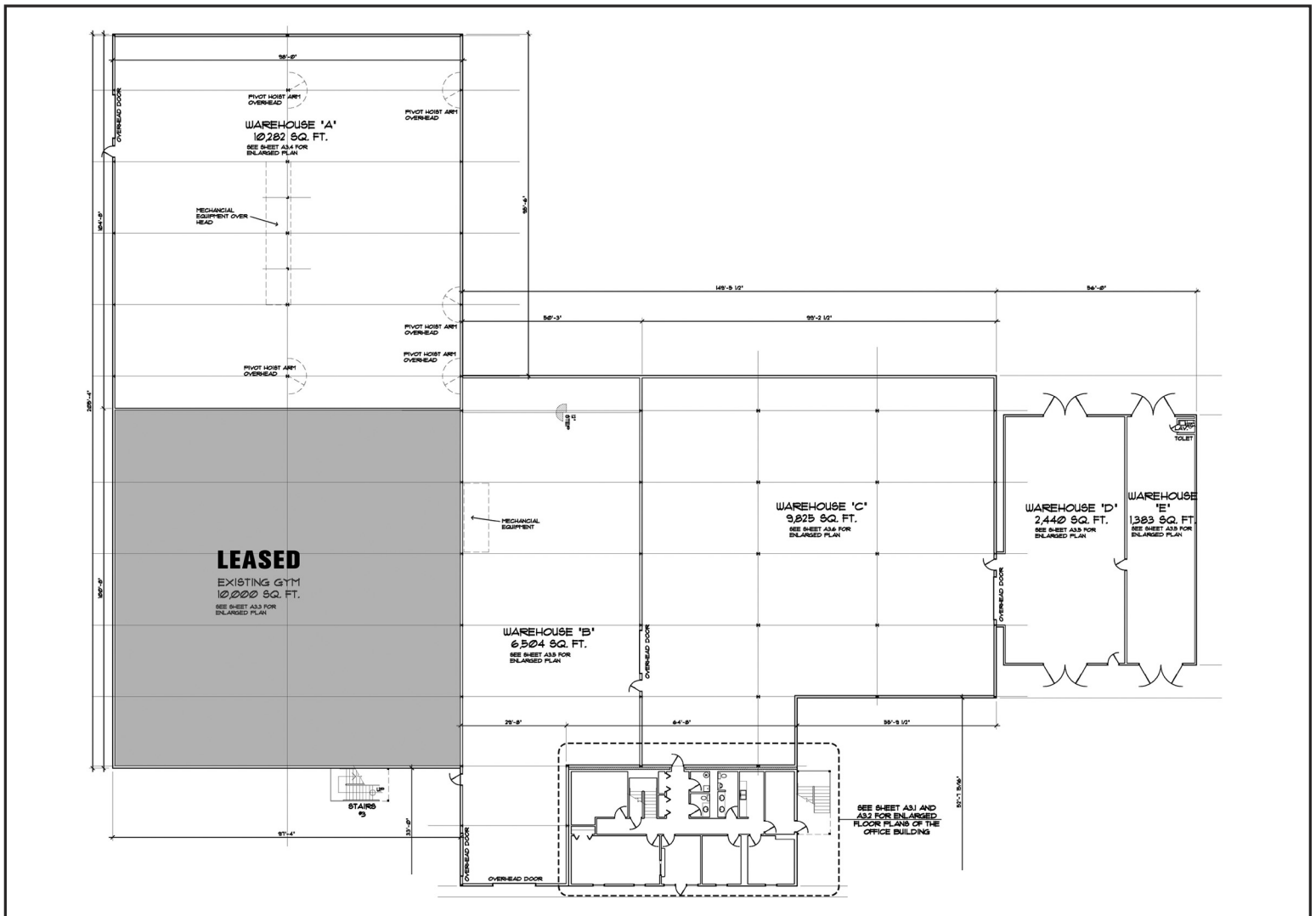

Mary Jo Giammalva  
 Phone: 713.784.7774  
 Mobile: 713.805.4728  
 maryjogb@jlm-commercial.com

Lane F. Guinn  
 Phone: 713.784.7770  
 Mobile: 832.865.3044  
 lguinn@jlm-commercial.com