

Glynn County, GA

Summary

Parcel Number 0305534
Tax District CENTRAL GLYNN (District 03)
Alias
Location Address 6120 NEW JESUP HWY
 BRUNSWICK, GA 31523
Millage Rate 24.074
Legal Description 1.64 AC PYLES MARSH
Subdivision PYLES MARSH
Documents PD 35, Pg 167
Class Code R3 - Residential Lots
(Note: This is for tax purposes only. Not to be used for zoning.)
Neighborhood Pyles Marsh (Code: 3050)
Zoning FA
Map# Block-Lot 0093-10 002-096
Property Class SFR
Homestead Exemption No
GIS Mapped acres 1.64
Elementary School Sterling
Middle School Jane Macon
High School Brunswick High School
Commissioner District DISTRICT 3 - WAYNE NEAL, Phone (912) 554-7404 wneal@glynncounty-ga.gov

View Map

Owner

QUINLIVAN RYAN
 & DANIELLE QUINLIVAN
 6120 NEW JESUP HWY
 BRUNSWICK, GA 31523

Value Information

Assessed Year	2025	
Land Value	+	\$32,000.00
Improvement Value	+	\$211,000.00
Total Value	=	\$243,000.00
Assessed Land Value	+	\$12,800.00
Assessed Improvement Value	+	\$84,400.00
Assessed Total Value	+	\$97,200.00

Improvement Information

Building Use	SINGLE FAMILY DWELLING, PLATTED LOT	Stories	1
Style	Ranch	Roof Cover	METAL
Heated Sq Ft	1725	Flooring Type	HARDWOOD
Interior Walls	Drywall	Heating Type	COOL / HEATED AIR
Exterior Walls	BRICK	Rooms/Bedrooms/Bathrooms	6 / 3 / 2
Year Built	1978	Number of Fireplaces	1

Additions

Card 1

Line	Lower	First	Second	Third	Area
0		MGF - MAIN GRD FLR			1725
1		OFP - OPEN FRAME PORCH			15
2		AGB - GARAGE-BRICK			576
3		AUR - UTILITY ROOM			60
4		APO - Patio Open			100
5		OFP - OPEN FRAME PORCH			130

Sale/Transfer Information

Date	Deed Book and Page	Price	Deed Type	Grantor
7/13/2022	4723-394	\$220,000.00		MCCALL URIAH LUKE
10/28/2021	4601-71	\$0.00		MCCALL URIAH
3/10/2021	4408-370	\$170,000.00		SMITH ROBERT E
11/19/2008	2513-494	\$0.00		SMITH ROBERT E

2025 Notice of Assessment

[2025 Notice of Assessment \(PDF\)](#)

View/Pay Tax Bills

[View/Pay Tax Bills](#)

Photos

To print an image, click to view then right-click and open in new tab.



Sketches

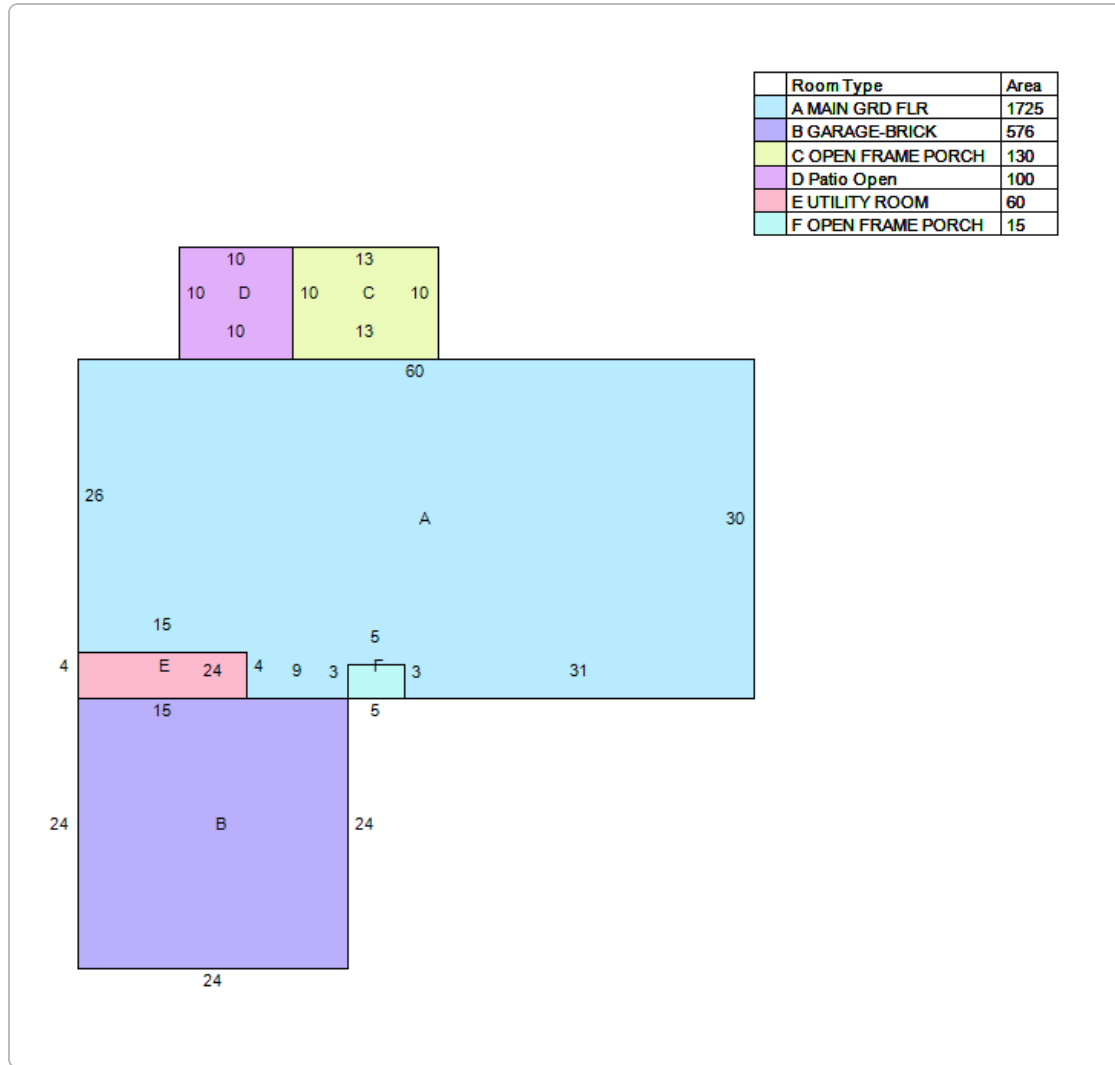

Legend

- AA-LN - Attached Addition Landing
- AA-PC - Attached Addition Patio Closed
- AA-PO - Attached Addition Patio Open
- AA-UR - Attached Addition Utility Room
- AA-WD - Attached Addition Wood Deck
- AA-WD2 - Attached Addition Wood Deck 2nd Story
- AA-WD3 - Attached Addition Wood Deck 3rd Story
- AA-WD4 - Attached Addition Wood Deck 4th Story
- AG-F - Attached Garage Frame
- AG-B - Attached Garage Brick
- CA-C - Commercial Addition Canopy
- CA-F - Commercial Addition Frame
- CA-M - Commercial Addition Masonry
- CA-S - Commercial Addition Steel
- CD - Canopy & Dock
- CRPT - Carport
- DA-F Dwelling Addition Frame
- DA-F2 - Dwelling Addition 2nd story
- DA-F3 - Dwelling Addition 3rd Story
- DA-M - Dwelling Addition Masonry
- DOCK - Dock
- EFP - Enclosed Frame Porch
- EMP - Enclosed Masonry Porch
- MGFA - Main Ground Floor Addition
- MGFA2 - Main Ground Floor Addition 2nd Story
- MHGFA - Manufactured Home Ground Floor Addition
- OFP - Open Frame Porch
- OFP2 - Open Frame Porch 2nd Story
- OFP3 - Open Frame Porch 3rd Story
- OFP4 - Open Frame Porch 4th Story
- OFPS - Open Frame Porch Screened
- OMP - Open Masonry Porch
- OMP2 - Open Masonry Porch 2nd Story

Recent Sales In Area

Sale date range:

From:

04/29/26

To:

04/29/26

Search Sales by Neighborhood

Search Sales by Subdivision

Distance:

1500

Units:

Feet



Search Sales by Distance

No data available for the following modules: Summary (MH), Mobile Homes-lasW, Prebill Mobile Homes, Accessory Information, Planned Development.

Glynn County makes every effort to produce the most accurate information possible. No warranties, expressed or implied, are provided for the data herein, its use or interpretation. The assessment information is from the last certified taxroll. All data is subject to change before the next certified taxroll.

[User Privacy Policy](#) | [GDPR Privacy Notice](#)
[Last Data Upload: 4/29/2026, 6:02:40 AM](#)

[Contact Us](#)

