

9919 E Main Street

Mesa, Arizona 85207

FOR SALE
Mixed Used Development

REMAX
COMMERCIAL

RE/MAX, LLC is an Equal Opportunity Employer and supports the Fair Housing Act and equal opportunity housing. Each Office Independently Owned and Operated. 23_394



ROBERTA VOSS
Associate Broker
RE/MAX Fine Properties
602.697.0730 (cell)
623.362.3000 (office)
robertavoss@remax.net
www.thevossteam.com
License# BR528165000 AZ

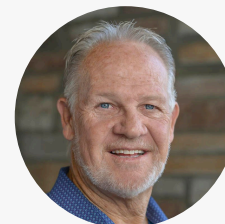

RICK BIERS
Associate
RE/MAX Fine Properties
602.550.4753 (cell)
623.362.3000 (office)
rickbiers@remax.net
www.thevossteam.com
License# SA686247000 AZ



MAIN STREET (APACHE TRAIL)

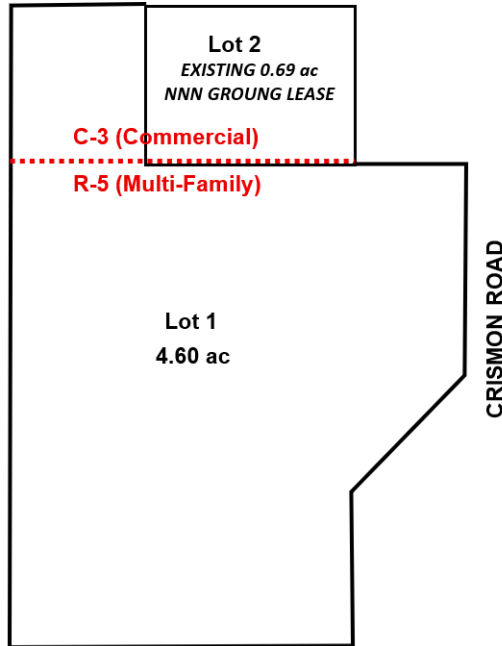

\$ 4,450,000 | 5.29 acres

Multi-family | Commercial | NNN

Prime development opportunity in a rapidly growing Mesa corridor. This unincorporated parcel is strategically located along the south side of Main Street and west of Crismon Road (corner excluded), offering excellent visibility and access. Parcel holds the most intensive commercial zoning in the County, supporting a wide range of retail, office, and service uses.

Utilities including electric and telecommunications are readily available. The site is generally level and mostly cleared, minimizing initial site work. Minor existing improvements along Crismon Road will require removal prior to development.

The property may be acquired in whole or in part, offering flexibility for a variety of development strategies. Ideal for a mixed-use project in an area experiencing strong demand for both multi-family and commercial development.

Property Highlights:

- **Offering:** Lot 1 may be purchase for \$2,550,000 and Lot 2 may be purchased separately for \$1,900,000; together, both lots are offered at \$4,450,000.
- **Mixed-use:** Both C3 and R5 zoning across two parcels
- **Multi-family portion (Lot 1):** The property is primarily zoned R-5, allowing for high-density multi-family development with potential for 40+ units per acre.
- **General commercial frontage (Lot 1):** Frontage along Main Street is zoned C-3 (General Commercial)
- **NNN ground lease (Lot 2) :** Approximately 30,000 SF along Main Street is currently under a llong-term ground lease, with corporate guaranteed rental income of \$138,000 annually.
- **2-mile population count:** 56,342
- **Combined traffic count:** 24,093

REMAX

COMMERCIAL®



ROBERTA VOSS
Associate Broker
RE/MAX Fine Properties
602.697.0730 (cell)
623.362.3000 (office)
robertavoss@remax.net
www.thevossteam.com
License# BR528165000 AZ



RICK BIERS
Associate
RE/MAX Fine Properties
602.550.4753 (cell)
623.362.3000 (office)
rickbiers@remax.net
www.thevossteam.com
License# SA686247000 AZ