

CENTURY PLAZA

3614-3640 Rochester Road / Troy, MI



MID-AMERICA[®]
Real Estate-Michigan, Inc.

FOR LEASE



RETAIL OPPORTUNITY

CENTURY PLAZA



Address

3614 - 3640 Rochester Road
Troy, MI 48083

Availability

1,260 SF

Features

Last space remaining in this high-profile neighborhood center located on the east side of Rochester Road, just north of Big Beaver Road. Century Plaza offers exceptional visibility in one of Troy's most active retail corridors, with over 50,000 vehicles passing daily. The area features strong demographics, with over 88,000 residents within a 3-mile radius and an average household income of around \$130,000. The property includes a multi-panel monument sign on Rochester Road, multiple points of ingress and egress, improved road infrastructure following the recent Rochester Road widening project, and newly updated storefronts featuring stone, brick, and glass.

Co-Tenants



Demographics (2025)

	1 MILES	3 MILES	5 MILES
POPULATION	10,291	88,394	249,373
HOUSEHOLDS	3,673	35,614	104,239
AVG HOUSEHOLD INCOME	\$169,513	\$130,337	\$130,448
DAYTIME POPULATION	11,841	130,718	312,856

CENTURY PLAZA

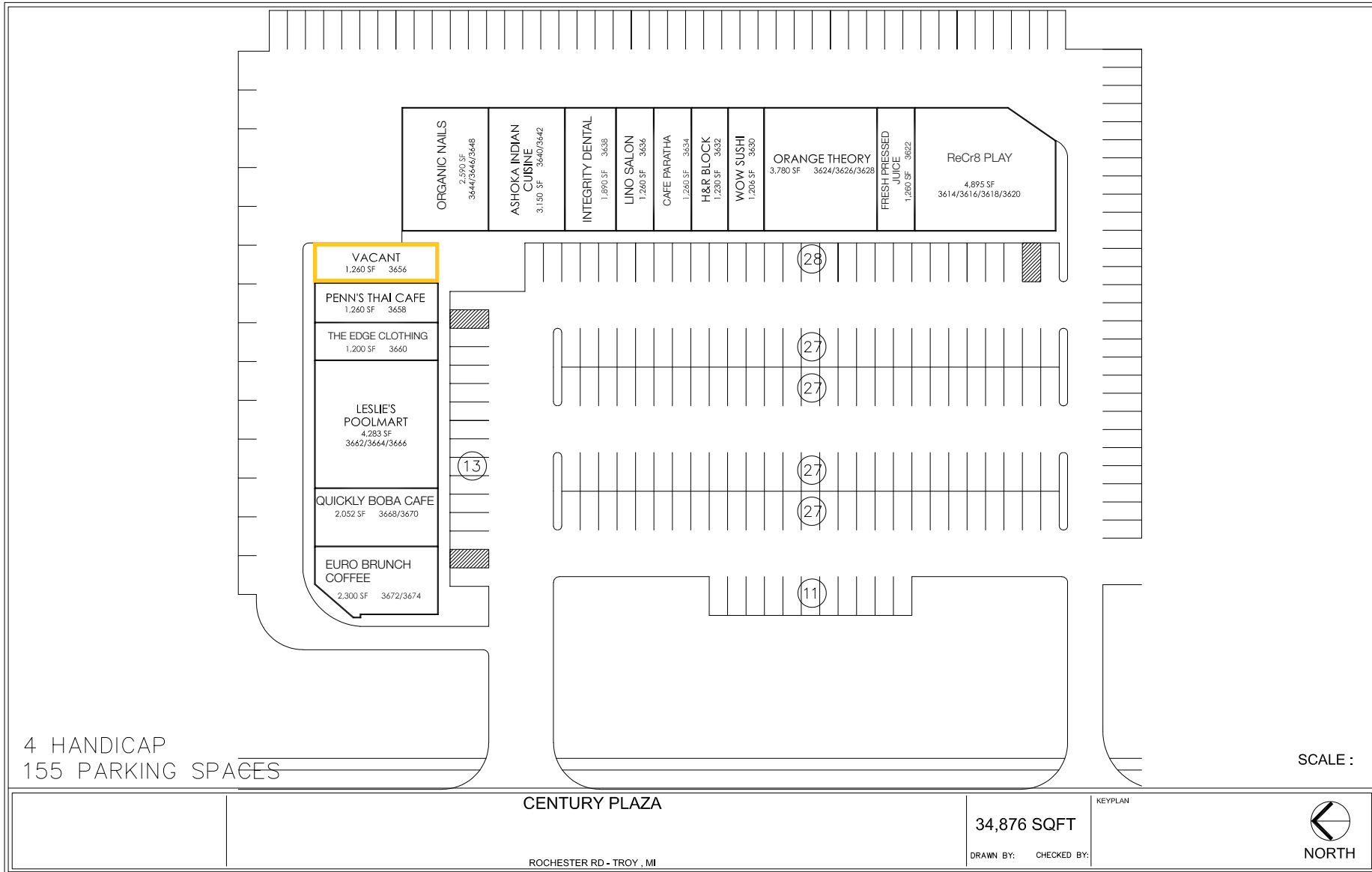

CENTURY PLAZA



DRONE PICTURES

CENTURY PLAZA

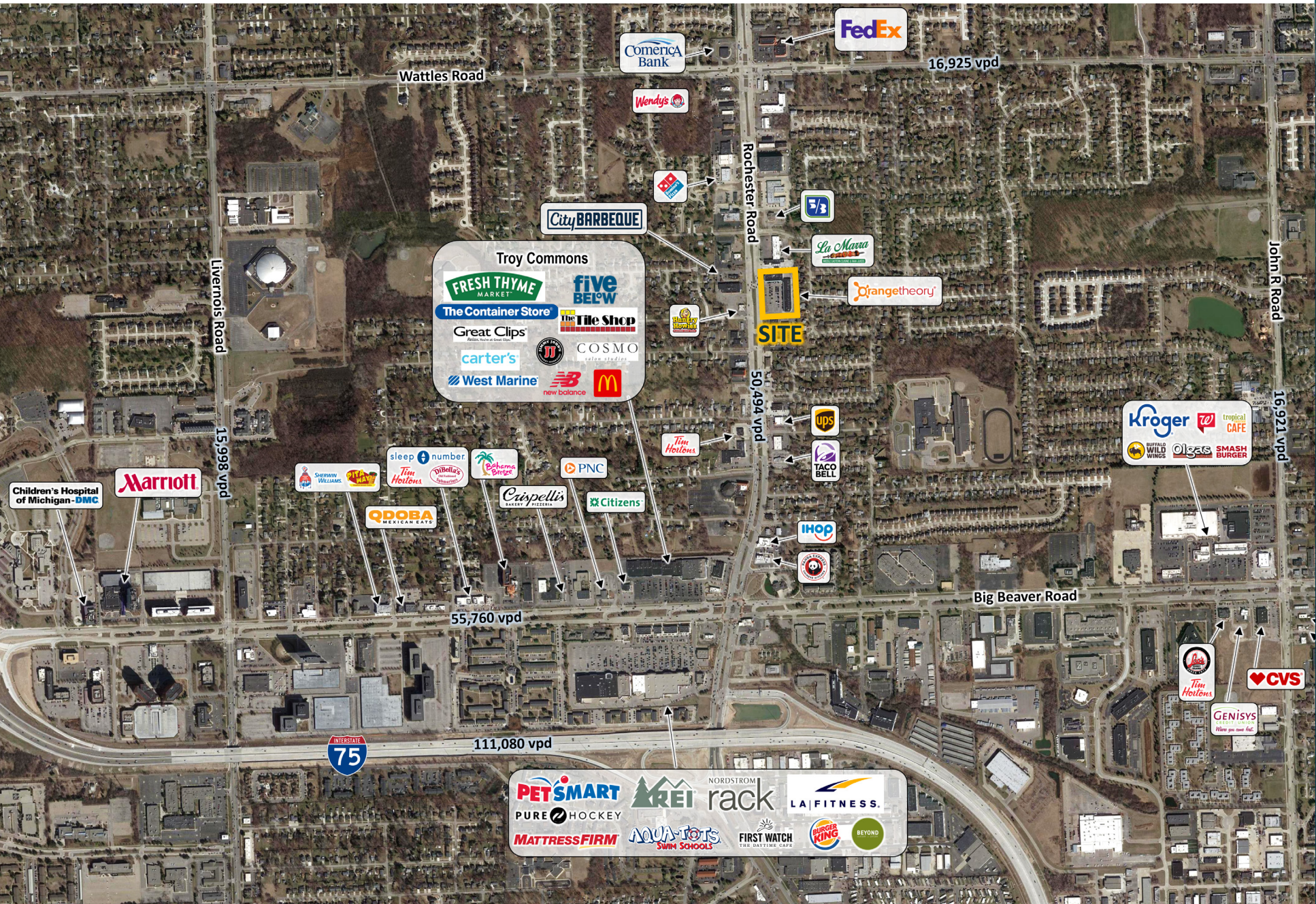

CENTURY PLAZA

George
Sheena

Mid-America Real Estate -
Michigan, Inc.

T: 248.855.6800

GSheena@MidAmericaGrp.com

Jared
Gell

Mid-America Real Estate -
Michigan, Inc.

T: 248.855.6800

JGell@MidAmericaGrp.com



38500 Woodward Ave, Suite 100
Bloomfield Hills, Michigan 48304
248.855.6800

MidAmericaGrp.com



CONTACT