



**MARTIN
COMMERCIAL
GROUP**

Commercial Real Estate Services



AVAILABLE FOR LEASE

**12,079 SQ. FT. INDUSTRIAL BUILDING
TRUCK WELL & FIRE SPRINKLERS**



1062 N. KRAEMER PLACE ~ ANAHEIM

Features:

- Reception & Three (3) Private Offices
- Central HVAC
- Fire Sprinklers
- 150A 3Phase 120/208V (Verify)
- 17-20' Warehouse Clearance
- One (1) 12'x14' GL Loading Door
- Truck Well With Three (3) 12'x18' Dock High Doors
- Easy Access to the 91, 55 & 57 Freeways
- Professionally Managed

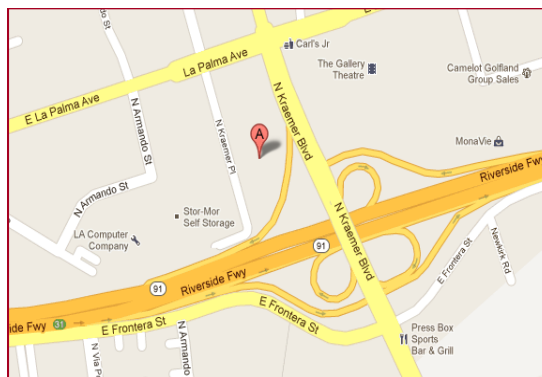

**For More Information
Please Contact:**

ERIN LAGOMARSINO

elagomarsino@mcgre.com
DRE # 00992436

SAM GREEK

sgreek@mcgre.com
DRE # 01240614

714.241.1141

1495 E. Warner Avenue
Santa Ana, CA 92705

*Since 1953...
Orange County ~ Inland Empire*

The information contained herein has been obtained from sources we deem reliable. While we have no reason to doubt its accuracy, we do not guarantee it.



MARTIN
COMMERCIAL
GROUP

Commercial Real Estate Services



For More Information
Please Contact:

SAM GREEK

sgreek@mcgre.com
DRE # 01240614

ERIN LAGOMARSINO

elagomarsino@mcgre.com
DRE # 00992436

714.241.1141

1495 E. Warner Avenue
Santa Ana, CA 92705

*Since 1953...
Orange County ~ Inland Empire*

1062 N. Kraemer Place, Anaheim, CA 12,079 Sq. Ft.

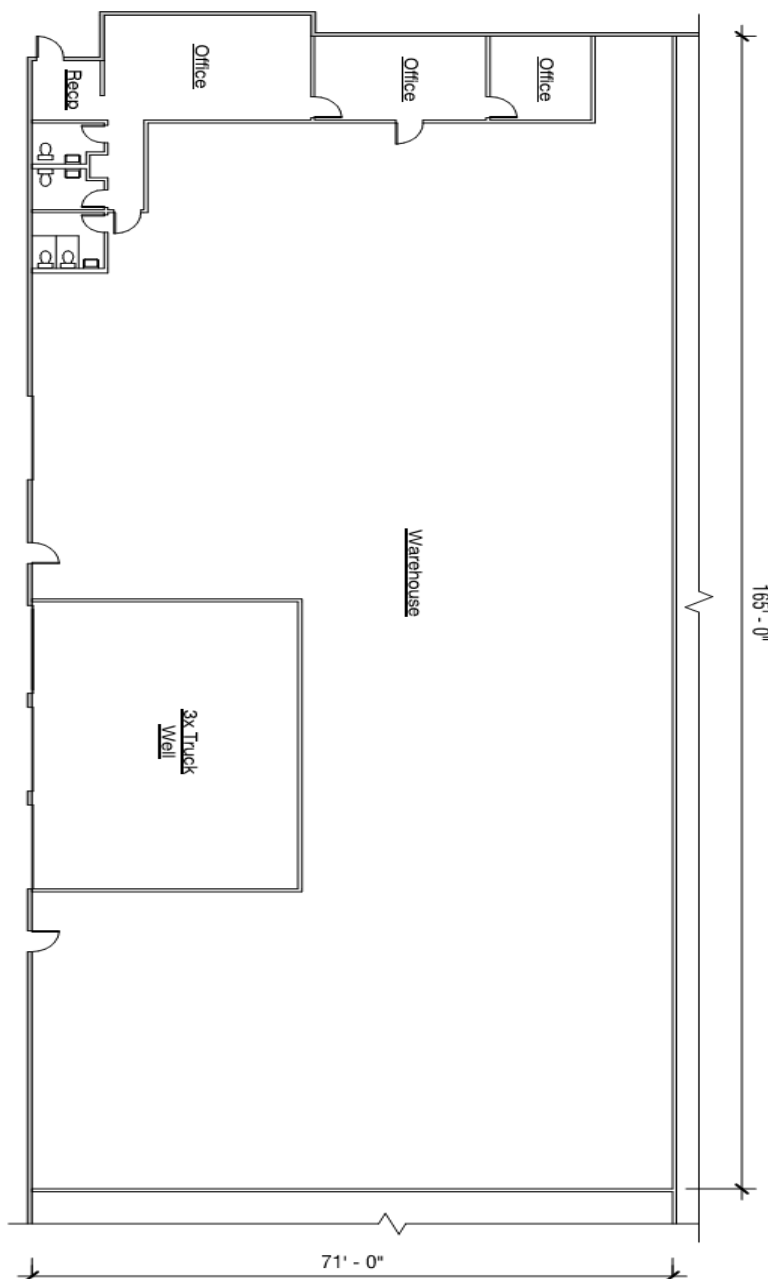

WWW.MCGRE.COM