

BNV-5000

**NOTES:**

1. THIS PLAN IS A PRELIMINARY PLAN AND IS NOT TO BE USED FOR CONSTRUCTION PURPOSES.
2. THE PROPERTY IS SUBJECT TO A EASEMENT FOR THE STATE OF NEW YORK.
3. THE PROPERTY IS SUBJECT TO A EASEMENT FOR THE STATE OF NEW YORK.
4. THE PROPERTY IS SUBJECT TO A EASEMENT FOR THE STATE OF NEW YORK.
5. THE PROPERTY IS SUBJECT TO A EASEMENT FOR THE STATE OF NEW YORK.

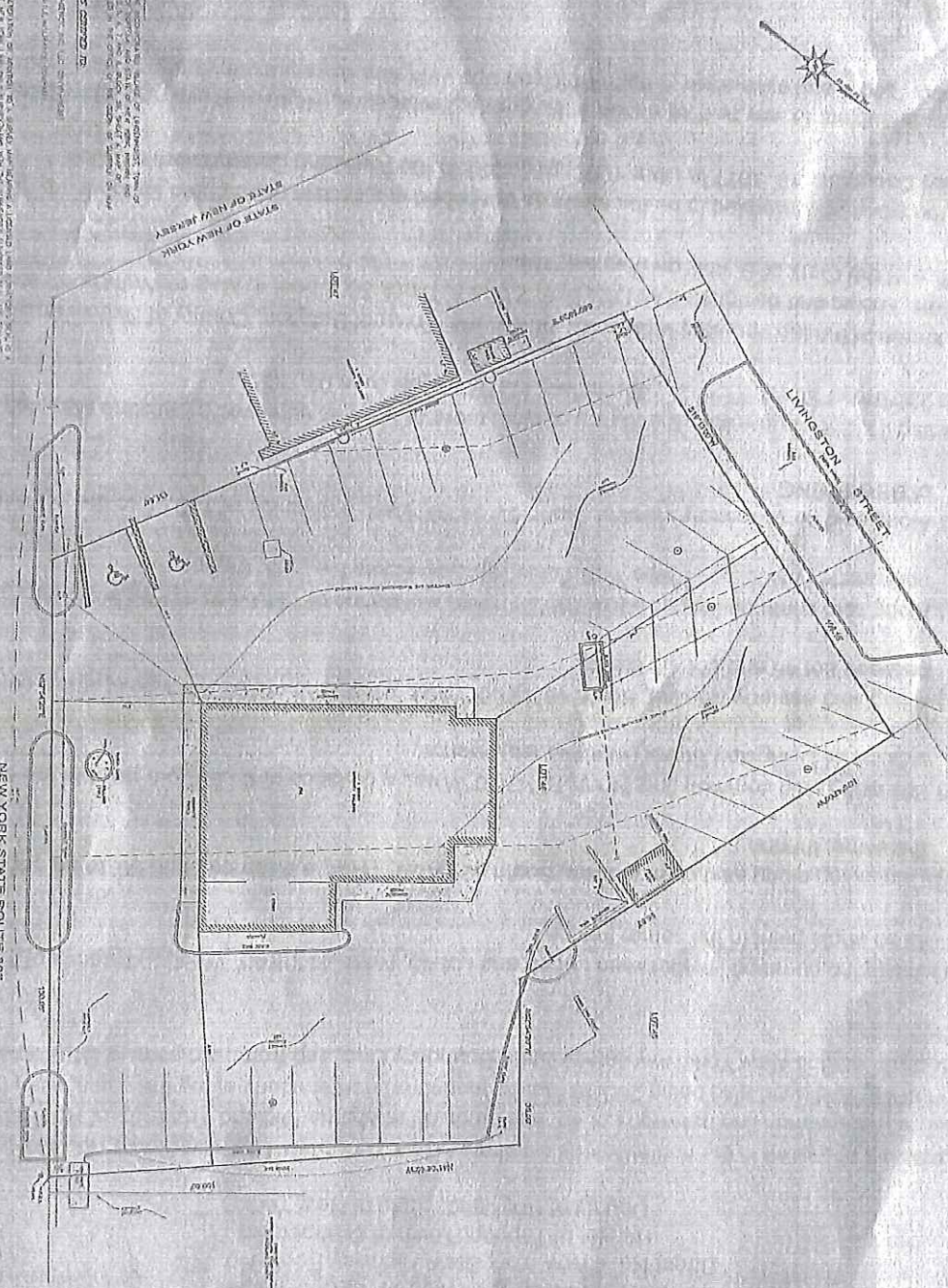

NEW YORK STATE ROUTE 203

<b>SCALE:</b>	1" = 100'
<b>DATE:</b>	1/1/2020
<b>PROJECT:</b>	ALSTATE ASPRING LAYOUT
<b>CLIENT:</b>	ALSTATE ASPRING
<b>DESIGNER:</b>	ALSTATE ASPRING
<b>CHECKER:</b>	ALSTATE ASPRING
<b>APPROVER:</b>	ALSTATE ASPRING

# 4 Route 303, Tappan, NY 10983-2813, Rockland/NY County

Withdrawn 09/24/2020

Flood Zone Code: AE  
 Flood Zone Date: 03/03/2014  
 Flood Code Description: Zone Ae-An Area Inundated By 100-Year Flooding

Flood Zone Panel: 36087C0189G  
 Special Flood Hazard Area (SFHA): In

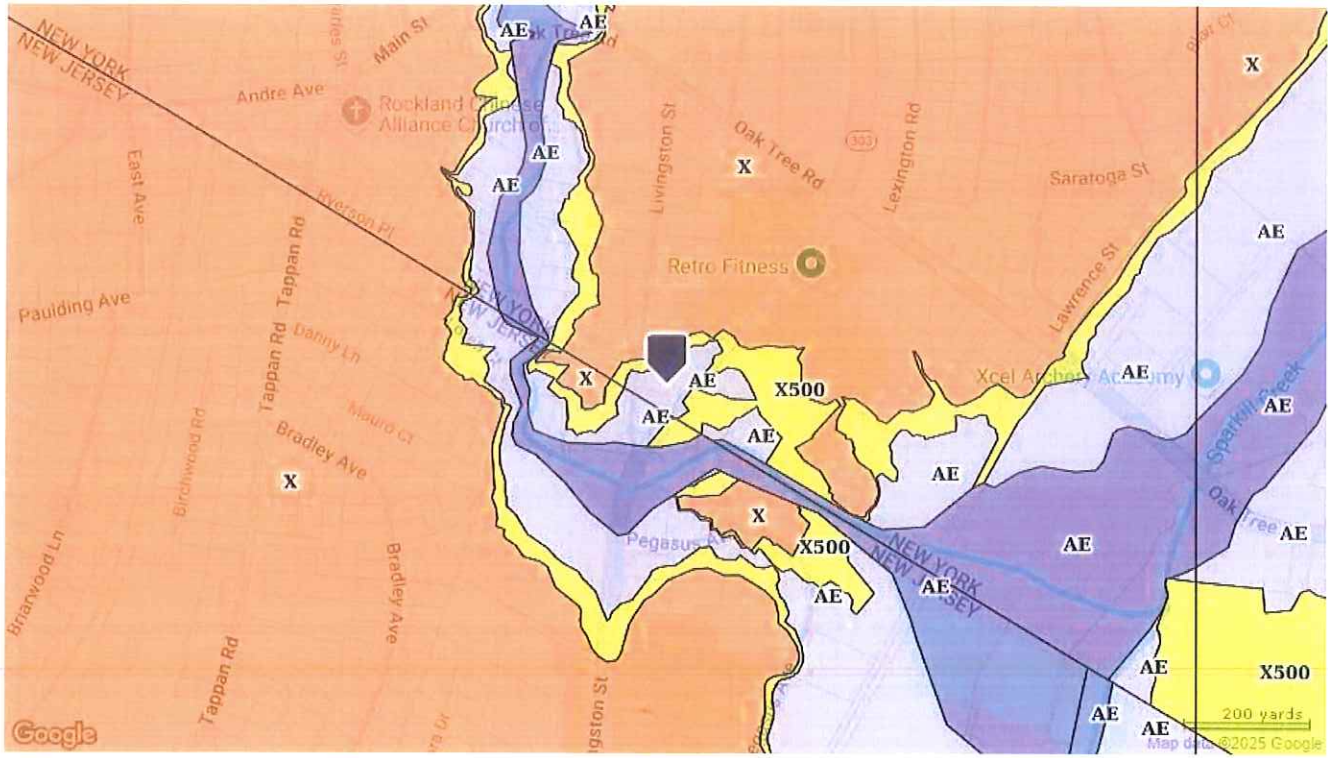

- Coastal 100-Year Floodway
- Coastal 100-year Floodplain
- 100-year Floodway
- 100-year Floodplain
- 500-year Floodplain incl. levee protected area
- Out of Special Flood Hazard Area
- Undetermined

This map/report was produced using multiple sources. It is provided for informational purposes only. This map/report should not be relied upon by any third parties. It is not intended to satisfy any regulatory guidelines and should not be used for this or any other purpose.