

RETAIL FOR LEASE



PRINCEVILLE
Center

THE INSPIRATION

Princeville Center is located on the scenic North Shore of the Garden Island of Kauai, comprised of a vibrant mix of visitor accommodations, as well as residential neighborhoods. Situated at the gateway of Hanalei, Princeville Center is 70,521 square feet of retail, dining, and service related businesses and the only full-service grocery-anchored center serving the areas of Hanalei to Kalihiwai.



THE PROPERTY

SECOND FLOORS

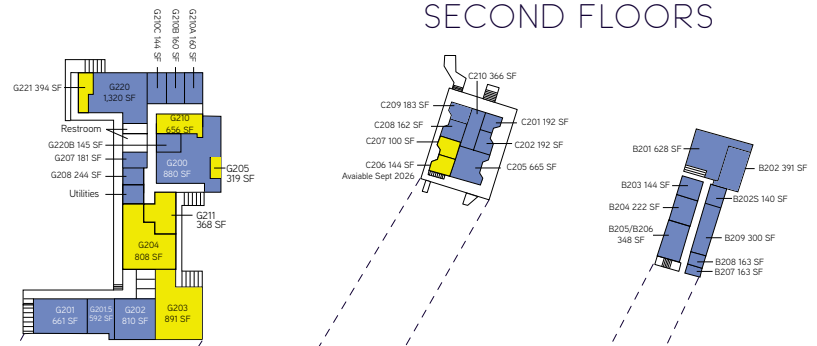

GROUND FLOOR

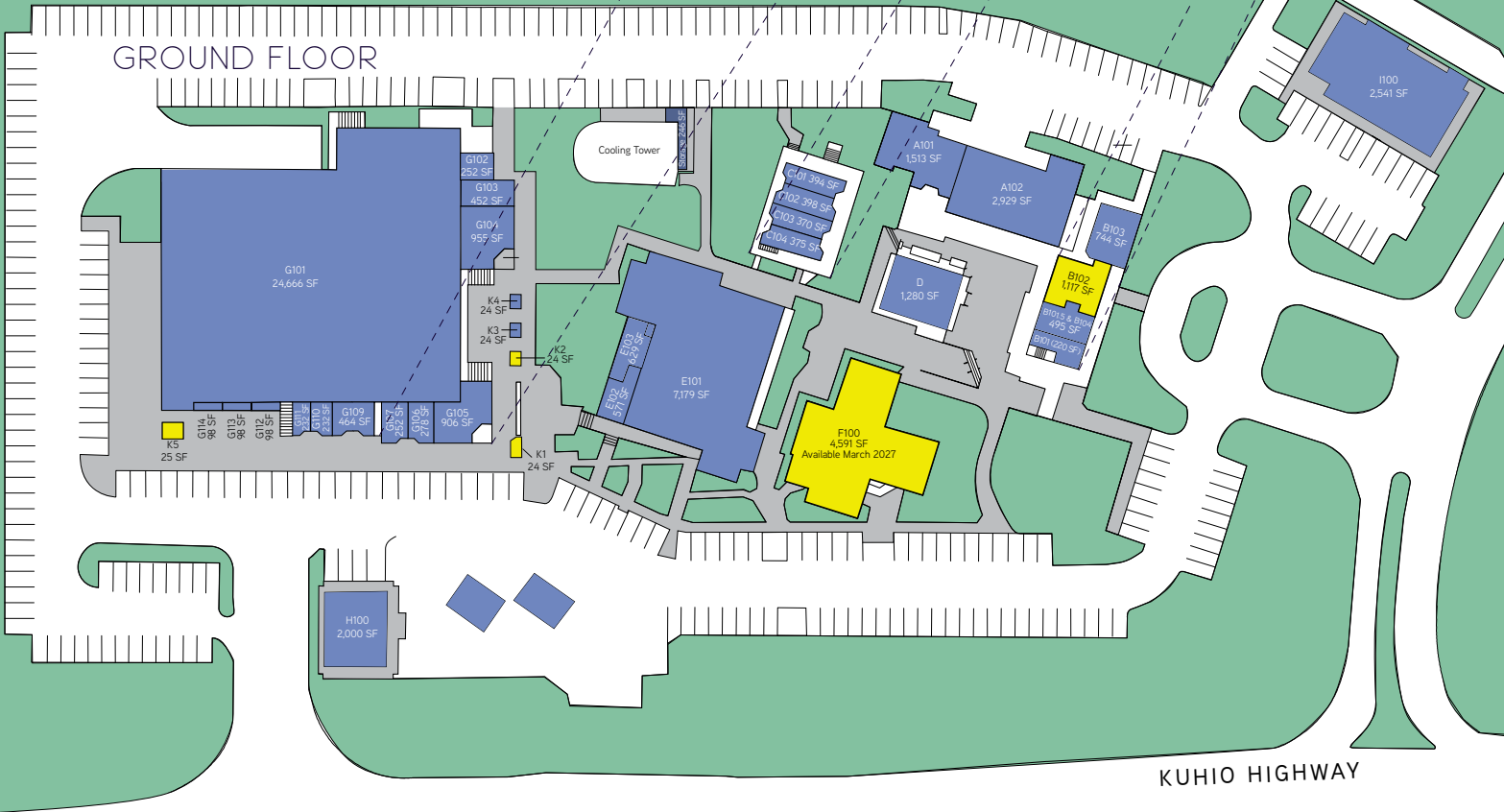

Area Princeville

Address 5-4280 Kuhio Highway
Princeville, HI 96722

TMK 4-5-4-24-20

Zoning C-G

Term 3 - 5 Years

Building Size 70,521 SF

Base Rent Upon Request

Percentage Rent 8-12%

CAM \$2.23 PSF/Mo (estimated)

Space Available

B102 (1,117 SF)	G204 (808 SF)	K1 (24 SF)
C206 (144 SF)	G205 (319 SF)	K2 (24 SF)
C207 (100 SF)	G211 (368 SF)	K5 (25 SF)
F100 (4,591 SF)	G210 (656 SF)	
G203 (891 SF)	G221 (394 SF)	



KAUAI VISITOR STATISTICS NOV 2019 YTD

Air Arrivals	1,250,500
Total Visitor Days	9,158,200
Total Expenditures (\$mil.)	\$1,725.1
Average Length of Stay	7.3
PPPD Spending	\$188.4

LOCAL STATISTICS (2019)	1-MILE	3-MILE	5-MILE
Household Net Worth	\$1.04M	\$955K	\$923K
Household Retail Expenditures	\$24.94M	\$38.54M	\$67.28M
Home Values \$1M or More	20.3%	24.8%	18.4%



Emalia Pietsch (S)

Senior Vice President
 Lic# RS-70893
 808 523 9710
 emalia.pietsch@colliers.com

This document/email has been prepared by Colliers for advertising and general information only. Colliers makes no guarantees, representations or warranties of any kind, expressed or implied, regarding the information including, but not limited to, warranties of content, accuracy and reliability. Any interested party should undertake their own inquiries as to the accuracy of the information. Colliers excludes unequivocally all inferred or implied terms, conditions and warranties arising out of this document and excludes all liability for loss and damages arising there from. This publication is the copyrighted property of Colliers and /or its licensor(s). © 2026. All rights reserved. This communication is not intended to cause or induce breach of an existing listing agreement.