

Likewise



For Sale



**PROFESSIONAL CONDO IN
VIBRANT RIVER ARTS DISTRICT**

408 Depot Street, #150, Asheville, NC 28801

Likewise
COMMERCIAL REAL ESTATE

Carla Barnard LISTING BROKER

828.575.0272 | carla@likewisecommercial.com | likewisecommercial.com

408 Depot Street, #150, Asheville, NC 28801



OFFERING SUMMARY

SALE PRICE **\$765,000**

CONDO SIZE **± 2,329 SF**

ZONING **UP**



PROPERTY FEATURES

- Warm shell professional condo
- Previously configured as a medical office
- Flexible layout for medical, wellness, or professional office use
- Ready for buyer customization and build-out
- Located in River Arts District of Asheville
- Blocks from downtown Asheville, Mission Hospital, and hip West Asheville
- Surrounded by restaurants, galleries, and other creative businesses
- Easy access to I-240 and I-26
- Shared parking in lot across Depot Street
- MLS# 4316706

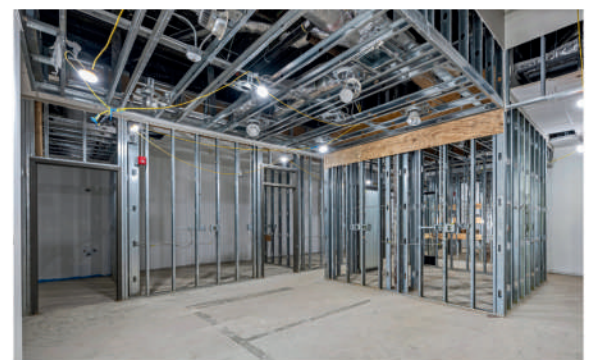

Likewise
COMMERCIAL REAL ESTATE

Carla Barnard LISTING BROKER

828.575.0272 | carla@likewisecommercial.com | likewisecommercial.com

We obtained the information above from sources we believe to be reliable. However, we have not verified its accuracy and make no guarantee, warranty or representation about it. It is submitted subject to the possibility of errors, omissions, change of price, rental or other conditions, prior sale, lease or financing, or withdrawal without notice. We include projections, opinions, assumptions or estimates for example only, and they may not represent current or future performance of the property. You and your tax and legal advisors should conduct your own investigation of the property and transaction.



UNIT 150:
± 2,329 SF

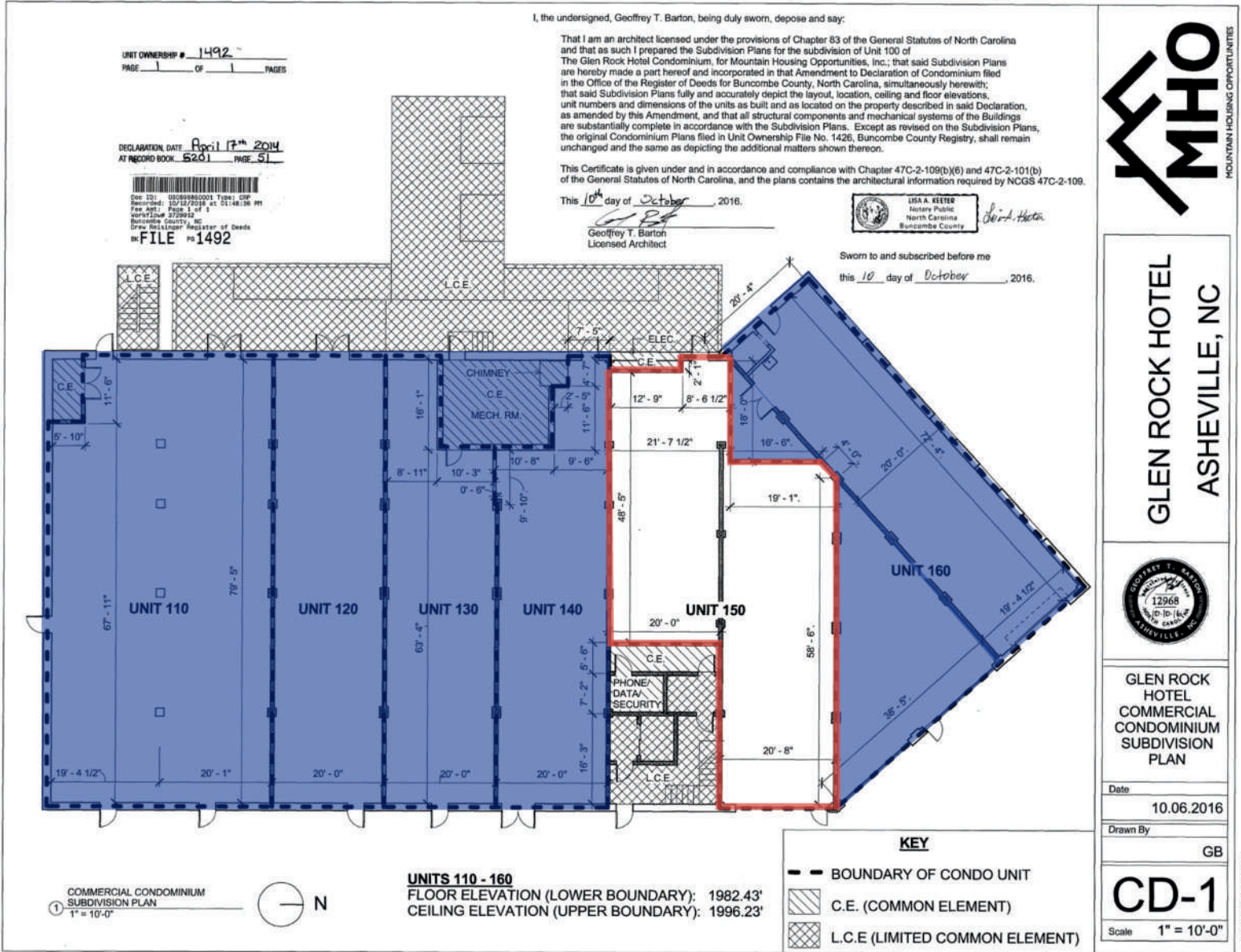

**GLEN ROCK HOTEL
ASHEVILLE, NC**



**GLEN ROCK HOTEL
COMMERCIAL CONDOMINIUM
SUBDIVISION PLAN**

Date: 10.06.2016
Drawn By: GB
Scale: 1" = 10'-0"





RIVER ARTS DISTRICT ARTISTS



*BUSINESS LOCATIONS NOT EXACT

Traffic Count Map

408 Depot St. #150, Asheville, NC 28801
 408 Depot St, Asheville, North Carolina, 28801
 Rings: 1, 3, 5 mile radii

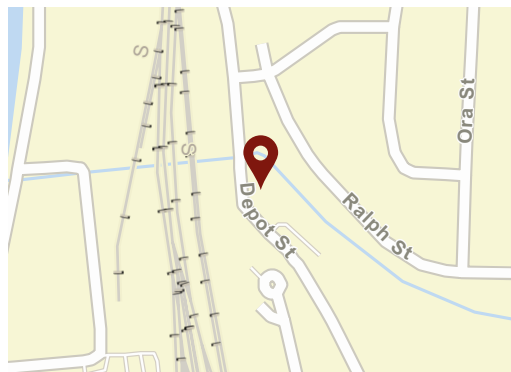
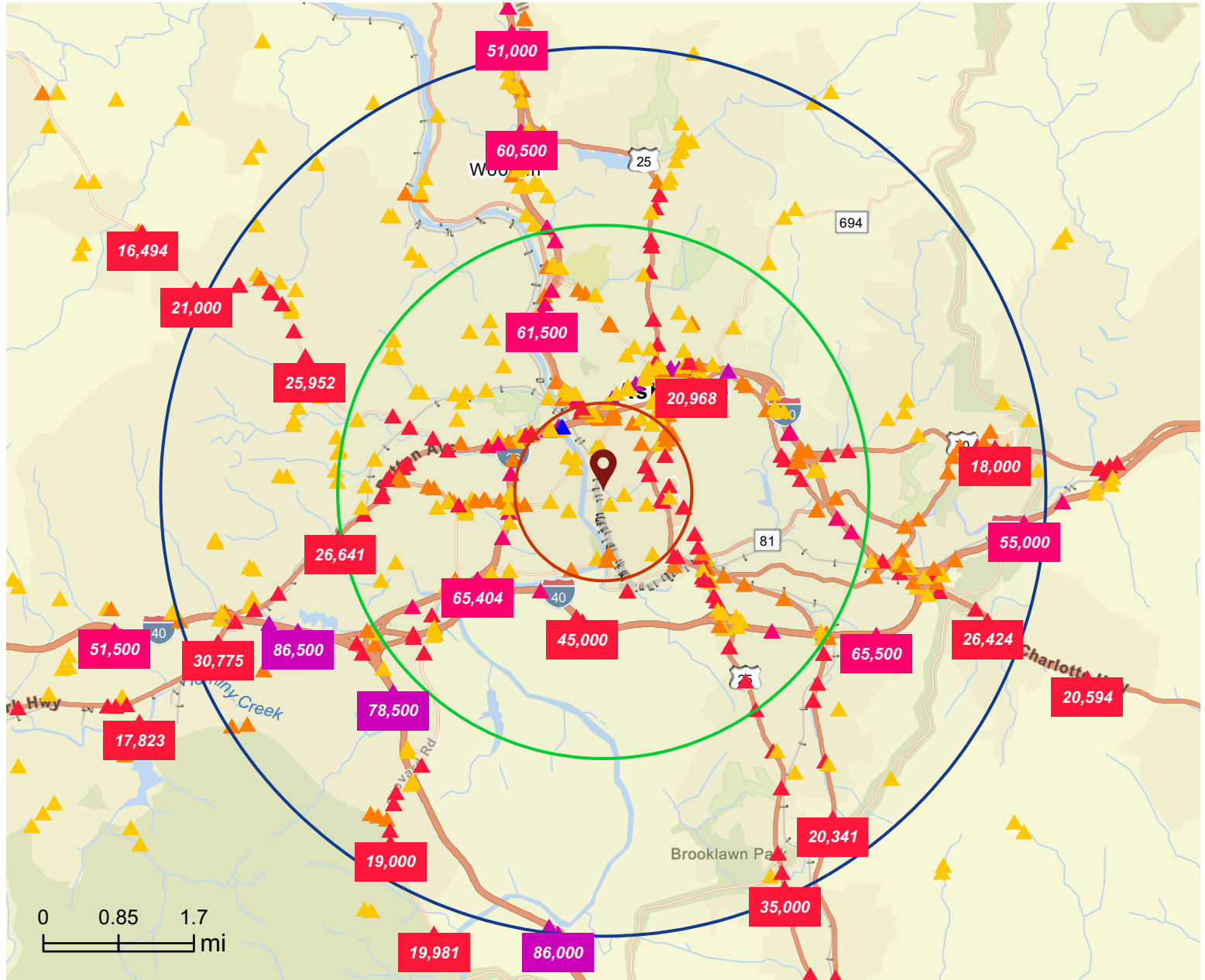

Average Daily Traffic Volume

- ▲ Up to 8,000 vehicles per day
- ▲ 8,001 - 15,000
- ▲ 15,001 - 50,000
- ▲ 50,001 - 70,000
- ▲ 70,001 - 100,000
- ▲ More than 100,000 per day



Source: Traffic Counts (2025)

Traffic Count Map - Close Up

408 Depot St. #150, Asheville, NC 28801
 408 Depot St, Asheville, North Carolina, 28801
 Rings: 1, 3, 5 mile radii

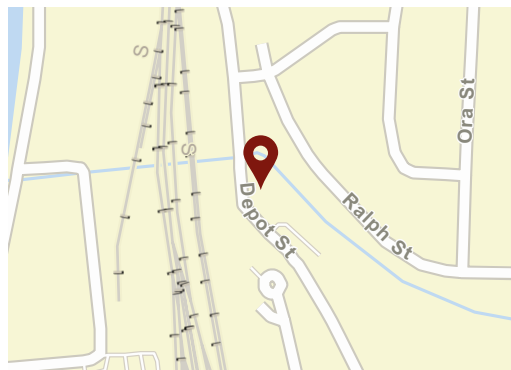
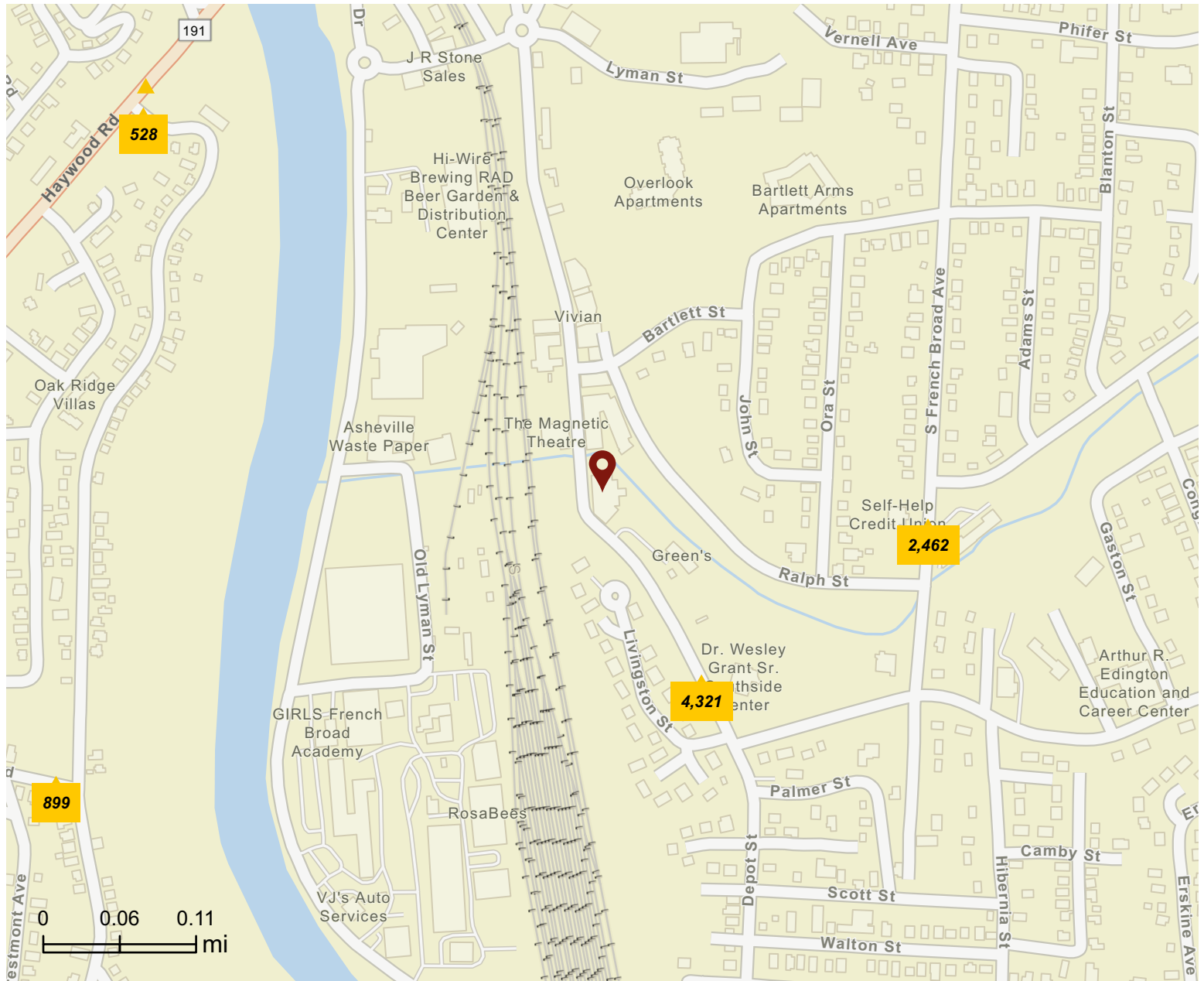

Average Daily Traffic Volume

- ▲ Up to 8,000 vehicles per day
- ▲ 8,001 - 15,000
- ▲ 15,001 - 50,000
- ▲ 50,001 - 70,000
- ▲ 70,001 - 100,000
- ▲ More than 100,000 per day

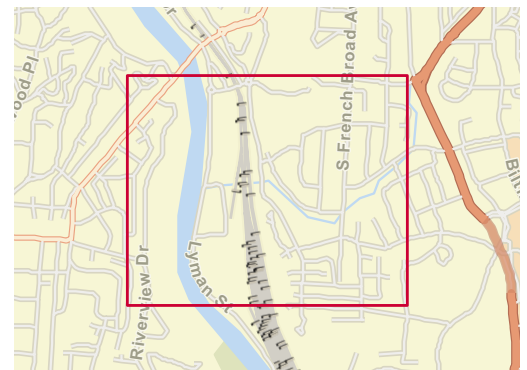

408 Depot St. #150, Asheville, NC 28801

Ring: 5 mile radius

City Greens (K6)

Dominant Tapestry Segment

KEY FACTS

108,843
Total Population

\$447,059
Median Home Value

7,681
Businesses

150,001
Daytime Population

40.6
Median Age



0.7%
2025-2030
Pop Growth Rate

\$46,516
Per Capita Income

2.1
Avg Household Size

\$69,584
Median Household Income

KEY SPENDING FACTS

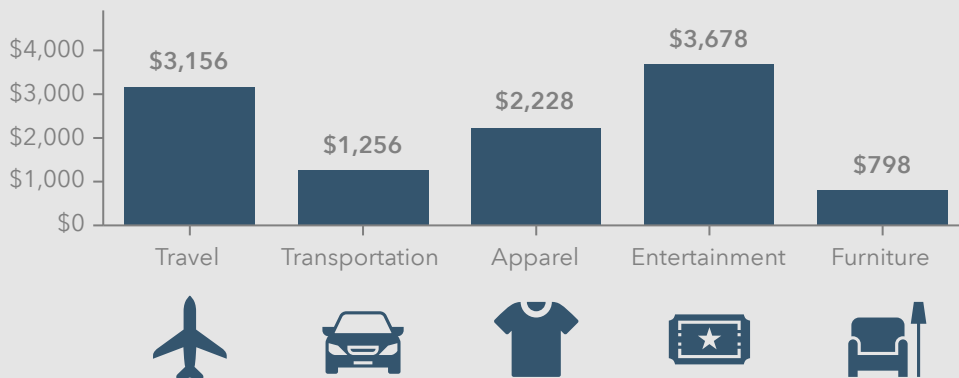

Source: This infographic contains data provided by Esri (2025, 2030), Esri-Data Axle (2025), Esri-U.S. BLS (2025).

© 2025 Esri

Spending facts are average annual dollars per household

Business Summary Report (NAICS)

408 Depot St. #150, Asheville, NC 28801
 408 Depot St, Asheville, North Carolina, 28801
 Rings: 1, 3, 5 mile radii



| Data for all businesses in area | 1 mile | 3 miles | 5 miles |
|-------------------------------------|--------|---------|---------|
| Total Businesses | 930 | 5,314 | 7,681 |
| Total Employees | 11,670 | 62,388 | 89,742 |
| Total Population | 8,632 | 54,747 | 108,843 |
| Employee/Population Ratio (per 100) | 135.2 | 114.0 | 82.5 |

| by NAICS Codes | Businesses | | Employees | | Businesses | | Employees | | Businesses | | Employees | |
|---|------------|------|-----------|------|------------|------|-----------|------|------------|------|-----------|------|
| | Number | % | Number | % | Number | % | Number | % | Number | % | Number | % |
| Agriculture, Forestry, Fishing & Hunting (11) | 5 | 0.5% | 32 | 0.3% | 22 | 0.4% | 73 | 0.1% | 32 | 0.4% | 94 | 0.1% |
| Mining (21) | 0 | 0.0% | 0 | 0.0% | 1 | 0.0% | 21 | 0.0% | 5 | 0.1% | 39 | 0.0% |
| Utilities (22) | 1 | 0.1% | 44 | 0.4% | 2 | 0.0% | 53 | 0.1% | 6 | 0.1% | 222 | 0.3% |
| Construction (23) | 42 | 4.5% | 256 | 2.2% | 195 | 3.7% | 1,963 | 3.1% | 368 | 4.8% | 3,666 | 4.1% |
| Building Construction | 15 | 1.6% | 102 | 0.9% | 86 | 1.6% | 860 | 1.4% | 155 | 2.0% | 1,551 | 1.7% |
| Heavy/Civil Eng Construction | 1 | 0.1% | 4 | 0.0% | 13 | 0.2% | 74 | 0.1% | 31 | 0.4% | 354 | 0.4% |
| Specialty Trade Contractor | 25 | 2.7% | 150 | 1.3% | 96 | 1.8% | 1,029 | 1.6% | 182 | 2.4% | 1,760 | 2.0% |
| Manufacturing (31-33) | 29 | 3.1% | 412 | 3.5% | 149 | 2.8% | 1,885 | 3.0% | 227 | 3.0% | 3,456 | 3.9% |
| Wholesale Trade (42) | 18 | 1.9% | 201 | 1.7% | 102 | 1.9% | 1,010 | 1.6% | 166 | 2.2% | 1,849 | 2.1% |
| Durable Goods | 12 | 1.3% | 163 | 1.4% | 70 | 1.3% | 640 | 1.0% | 112 | 1.5% | 1,025 | 1.1% |
| Nondurable Goods | 5 | 0.5% | 36 | 0.3% | 31 | 0.6% | 365 | 0.6% | 48 | 0.6% | 802 | 0.9% |
| Trade Broker | 1 | 0.1% | 3 | 0.0% | 2 | 0.0% | 5 | 0.0% | 6 | 0.1% | 22 | 0.0% |



[Source](#) This infographic contains data provided by Esri-Data Axle (2025), Esri (2025). Data note: Not all NAICS subcategories for a 2 digit major category are being shown.

Business Summary Report (NAICS)

408 Depot St. #150, Asheville, NC 28801
 408 Depot St, Asheville, North Carolina, 28801
 Rings: 1, 3, 5 mile radii



| by NAICS Codes | 1 mile | | | | 3 miles | | | | 5 miles | | | |
|---|------------|-------|-----------|-------|------------|-------|-----------|-------|------------|-------|-----------|-------|
| | Businesses | | Employees | | Businesses | | Employees | | Businesses | | Employees | |
| | Number | % | Number | % | Number | % | Number | % | Number | % | Number | % |
| Retail Trade (44-45) | 67 | 7.2% | 575 | 4.9% | 626 | 11.8% | 6,607 | 10.6% | 987 | 12.8% | 11,226 | 12.5% |
| Motor Vehicle & Parts Dealers | 6 | 0.7% | 20 | 0.2% | 41 | 0.8% | 380 | 0.6% | 82 | 1.1% | 1,023 | 1.1% |
| Furniture & Home Furnishing Stores | 3 | 0.3% | 55 | 0.5% | 35 | 0.7% | 347 | 0.6% | 62 | 0.8% | 524 | 0.6% |
| Electronics & Appliance Stores | 2 | 0.2% | 4 | 0.0% | 17 | 0.3% | 115 | 0.2% | 23 | 0.3% | 141 | 0.2% |
| Building & Garden Equipment | 7 | 0.8% | 212 | 1.8% | 31 | 0.6% | 635 | 1.0% | 52 | 0.7% | 1,054 | 1.2% |
| Food & Beverage Stores | 12 | 1.3% | 147 | 1.3% | 95 | 1.8% | 1,267 | 2.0% | 145 | 1.9% | 2,383 | 2.7% |
| Health & Personal Care Stores | 5 | 0.5% | 24 | 0.2% | 60 | 1.1% | 386 | 0.6% | 93 | 1.2% | 849 | 0.9% |
| Gasoline Stations | 2 | 0.2% | 6 | 0.1% | 19 | 0.4% | 84 | 0.1% | 35 | 0.5% | 150 | 0.2% |
| Clothing, Shoe and Jewellery Stores | 6 | 0.7% | 25 | 0.2% | 117 | 2.2% | 1,090 | 1.8% | 156 | 2.0% | 1,357 | 1.5% |
| Sporting Goods, Hobby & Music Stores | 24 | 2.6% | 80 | 0.7% | 165 | 3.1% | 951 | 1.5% | 232 | 3.0% | 1,314 | 1.5% |
| General Merchandise Stores | 1 | 0.1% | 3 | 0.0% | 48 | 0.9% | 1,353 | 2.2% | 106 | 1.4% | 2,431 | 2.7% |
| Transportation & Warehousing (48-49) | 9 | 1.0% | 104 | 0.9% | 56 | 1.1% | 655 | 1.1% | 101 | 1.3% | 1,017 | 1.1% |
| Truck Transportation | 0 | 0.0% | 6 | 0.1% | 17 | 0.3% | 142 | 0.2% | 31 | 0.4% | 308 | 0.3% |
| Information (51) | 16 | 1.7% | 151 | 1.3% | 112 | 2.1% | 1,299 | 2.1% | 159 | 2.1% | 1,867 | 2.1% |
| Finance & Insurance (52) | 31 | 3.3% | 175 | 1.5% | 233 | 4.4% | 1,482 | 2.4% | 339 | 4.4% | 2,145 | 2.4% |
| Central Bank/Credit & Related Activities | 10 | 1.1% | 83 | 0.7% | 77 | 1.4% | 715 | 1.1% | 118 | 1.5% | 1,068 | 1.2% |
| Securities & Commodity Contracts | 16 | 1.7% | 61 | 0.5% | 99 | 1.9% | 468 | 0.8% | 125 | 1.6% | 561 | 0.6% |
| Funds, Trusts & Other Financial | 5 | 0.5% | 30 | 0.3% | 57 | 1.1% | 298 | 0.5% | 96 | 1.3% | 517 | 0.6% |
| Real Estate, Rental & Leasing (53) | 59 | 6.3% | 1,248 | 10.7% | 332 | 6.3% | 2,859 | 4.6% | 478 | 6.2% | 3,593 | 4.0% |
| Professional, Scientific & Tech Services (54) | 99 | 10.7% | 612 | 5.2% | 614 | 11.6% | 3,685 | 5.9% | 803 | 10.4% | 4,897 | 5.5% |
| Legal Services | 31 | 3.3% | 142 | 1.2% | 199 | 3.7% | 1,041 | 1.7% | 221 | 2.9% | 1,106 | 1.2% |



Source: This infographic contains data provided by Esri-Data Axle (2025), Esri (2025). Data note: Not all NAICS subcategories for a 2 digit major category are being shown.

Business Summary Report (NAICS)

408 Depot St. #150, Asheville, NC 28801
 408 Depot St, Asheville, North Carolina, 28801
 Rings: 1, 3, 5 mile radii



| by NAICS Codes | 1 mile | | | | 3 miles | | | | 5 miles | | | |
|---|------------|---------------|---------------|---------------|--------------|---------------|---------------|---------------|--------------|---------------|---------------|---------------|
| | Businesses | | Employees | | Businesses | | Employees | | Businesses | | Employees | |
| | Number | % | Number | % | Number | % | Number | % | Number | % | Number | % |
| Management of Companies (55) | 4 | 0.4% | 22 | 0.2% | 20 | 0.4% | 111 | 0.2% | 30 | 0.4% | 145 | 0.2% |
| Administrative, Support & Waste Mgmt (56) | 29 | 3.1% | 164 | 1.4% | 161 | 3.0% | 1,236 | 2.0% | 249 | 3.2% | 1,854 | 2.1% |
| Educational Services (61) | 18 | 1.9% | 566 | 4.8% | 120 | 2.3% | 2,349 | 3.8% | 184 | 2.4% | 3,780 | 4.2% |
| Health Care & Social Assistance (62) | 199 | 21.4% | 4,599 | 39.4% | 735 | 13.8% | 17,656 | 28.3% | 975 | 12.7% | 23,333 | 26.0% |
| Ambulatory Health Care | 140 | 15.1% | 2,119 | 18.2% | 499 | 9.4% | 7,625 | 12.2% | 674 | 8.8% | 10,430 | 11.6% |
| Hospital | 15 | 1.6% | 1,932 | 16.6% | 47 | 0.9% | 7,562 | 12.1% | 62 | 0.8% | 9,226 | 10.3% |
| Nursing/Residential Care | 2 | 0.2% | 30 | 0.3% | 25 | 0.5% | 537 | 0.9% | 36 | 0.5% | 977 | 1.1% |
| Social Assistance | 42 | 4.5% | 517 | 4.4% | 164 | 3.1% | 1,932 | 3.1% | 203 | 2.6% | 2,699 | 3.0% |
| Arts, Entertainment & Recreation (71) | 26 | 2.8% | 119 | 1.0% | 146 | 2.8% | 2,132 | 3.4% | 207 | 2.7% | 3,485 | 3.9% |
| Accommodation & Food Services (72) | 79 | 8.5% | 903 | 7.7% | 519 | 9.8% | 8,660 | 13.9% | 708 | 9.2% | 12,338 | 13.8% |
| Accommodation | 9 | 1.0% | 166 | 1.4% | 97 | 1.8% | 2,197 | 3.5% | 132 | 1.7% | 3,204 | 3.6% |
| Food & Drinking Places | 69 | 7.4% | 737 | 6.3% | 421 | 7.9% | 6,463 | 10.4% | 575 | 7.5% | 9,134 | 10.2% |
| Other Services Except Public Admin (81) | 118 | 12.7% | 696 | 6.0% | 694 | 13.1% | 3,463 | 5.5% | 1,000 | 13.0% | 4,839 | 5.4% |
| Repair & Maintenance | 14 | 1.5% | 70 | 0.6% | 88 | 1.7% | 409 | 0.7% | 155 | 2.0% | 700 | 0.8% |
| Auto Repair & Maintenance | 9 | 1.0% | 55 | 0.5% | 61 | 1.1% | 288 | 0.5% | 112 | 1.5% | 524 | 0.6% |
| Personal & Laundry Service | 32 | 3.4% | 123 | 1.1% | 245 | 4.6% | 1,091 | 1.8% | 351 | 4.6% | 1,523 | 1.7% |
| Civic and Other Orgs | 71 | 7.6% | 504 | 4.3% | 362 | 6.8% | 1,963 | 3.1% | 495 | 6.4% | 2,616 | 2.9% |
| Public Administration (92) | 21 | 2.3% | 791 | 6.8% | 147 | 2.8% | 5,150 | 8.3% | 191 | 2.5% | 5,833 | 6.5% |
| Unclassified Establishments (99) | 60 | 6.5% | 1 | 0.0% | 326 | 6.1% | 40 | 0.1% | 468 | 6.1% | 63 | 0.1% |
| Total (11-99) | 930 | 100.0% | 11,670 | 100.0% | 5,314 | 100.0% | 62,388 | 100.0% | 7,681 | 100.0% | 89,742 | 100.0% |



Source: This infographic contains data provided by Esri-Data Axle (2025), Esri (2025). Data note: Not all NAICS subcategories for a 2 digit major category are being shown.

Business Summary Report (SIC)

408 Depot St. #150, Asheville, NC 28801
 408 Depot St, Asheville, North Carolina, 28801
 Rings: 1, 3, 5 mile radii



| Data for all businesses in area | 1 mile | 3 miles | 5 miles |
|--------------------------------------|--------|---------|---------|
| Total Businesses | 930 | 5,314 | 7,681 |
| Total Employees | 11,670 | 62,388 | 89,742 |
| Total Population | 8,632 | 54,747 | 108,843 |
| Employee/Population Ratio (per 100) | 135.2 | 114.0 | 82.5 |

| by SIC Codes | Businesses | | Employees | | Businesses | | Employees | | Businesses | | Employees | |
|------------------------------|------------|-------|-----------|-------|------------|-------|-----------|-------|------------|-------|-----------|-------|
| | Number | % | Number | % | Number | % | Number | % | Number | % | Number | % |
| Agriculture & Mining (01-14) | 13 | 1.4% | 74 | 0.6% | 77 | 1.4% | 393 | 0.6% | 162 | 2.1% | 925 | 1.0% |
| Construction (15-17) | 40 | 4.3% | 239 | 2.0% | 181 | 3.4% | 1,812 | 2.9% | 342 | 4.5% | 3,410 | 3.8% |
| Manufacturing (20-39) | 28 | 3.0% | 393 | 3.4% | 145 | 2.7% | 2,184 | 3.5% | 217 | 2.8% | 3,759 | 4.2% |
| Transportation (40-47) | 13 | 1.4% | 104 | 0.9% | 80 | 1.5% | 728 | 1.2% | 147 | 1.9% | 1,266 | 1.4% |
| Communication (48) | 4 | 0.4% | 63 | 0.5% | 38 | 0.7% | 339 | 0.5% | 60 | 0.8% | 753 | 0.8% |
| Utility (49) | 2 | 0.2% | 57 | 0.5% | 9 | 0.2% | 114 | 0.2% | 17 | 0.2% | 516 | 0.6% |
| Wholesale Trade (50-51) | 18 | 1.9% | 202 | 1.7% | 104 | 2.0% | 1,017 | 1.6% | 168 | 2.2% | 1,856 | 2.1% |
| Retail Trade Summary (52-59) | 139 | 14.9% | 1,332 | 11.4% | 1,069 | 20.1% | 13,227 | 21.2% | 1,600 | 20.8% | 20,565 | 22.9% |
| Home Improvement | 7 | 0.8% | 212 | 1.8% | 31 | 0.6% | 635 | 1.0% | 54 | 0.7% | 1,060 | 1.2% |
| General Merchandise Stores | 0 | 0.0% | 1 | 0.0% | 28 | 0.5% | 1,260 | 2.0% | 43 | 0.6% | 1,816 | 2.0% |
| Food Stores | 15 | 1.6% | 181 | 1.6% | 106 | 2.0% | 1,422 | 2.3% | 162 | 2.1% | 2,593 | 2.9% |
| Auto Dealers & Gas Stations | 8 | 0.9% | 26 | 0.2% | 58 | 1.1% | 448 | 0.7% | 113 | 1.5% | 1,149 | 1.3% |
| Apparel & Accessory Stores | 6 | 0.7% | 24 | 0.2% | 94 | 1.8% | 935 | 1.5% | 128 | 1.7% | 1,179 | 1.3% |
| Furniture & Home Furnishings | 5 | 0.5% | 61 | 0.5% | 61 | 1.1% | 526 | 0.8% | 103 | 1.3% | 759 | 0.8% |
| Eating & Drinking Places | 66 | 7.1% | 713 | 6.1% | 406 | 7.6% | 6,281 | 10.1% | 555 | 7.2% | 8,888 | 9.9% |
| Miscellaneous Retail | 32 | 3.4% | 113 | 1.0% | 286 | 5.4% | 1,720 | 2.8% | 442 | 5.8% | 3,121 | 3.5% |

Source: This infographic contains data provided by Esri-Data Axle (2025), Esri (2025).

Business Summary Report (SIC)

408 Depot St. #150, Asheville, NC 28801
 408 Depot St, Asheville, North Carolina, 28801
 Rings: 1, 3, 5 mile radii



| by SIC Codes | 1 mile | | | | 3 miles | | | | 5 miles | | | |
|---|------------|--------|-----------|--------|------------|--------|-----------|--------|------------|--------|-----------|--------|
| | Businesses | | Employees | | Businesses | | Employees | | Businesses | | Employees | |
| | Number | % | Number | % | Number | % | Number | % | Number | % | Number | % |
| Finance, Insurance, Real Estate (60-67) | 93 | 10.0% | 1,439 | 12.3% | 561 | 10.6% | 4,446 | 7.1% | 797 | 10.4% | 5,847 | 6.5% |
| Banks, Savings & Lending | 12 | 1.3% | 85 | 0.7% | 83 | 1.6% | 711 | 1.1% | 123 | 1.6% | 1,070 | 1.2% |
| Securities Brokers | 15 | 1.6% | 57 | 0.5% | 96 | 1.8% | 457 | 0.7% | 121 | 1.6% | 545 | 0.6% |
| Insurance Carriers & Agents | 5 | 0.5% | 30 | 0.3% | 57 | 1.1% | 298 | 0.5% | 95 | 1.2% | 514 | 0.6% |
| Real Estate, Investment Offices | 61 | 6.6% | 1,266 | 10.8% | 325 | 6.1% | 2,979 | 4.8% | 457 | 6.0% | 3,719 | 4.1% |
| Services Summary (70-89) | 500 | 53.8% | 6,987 | 59.9% | 2,576 | 48.5% | 33,006 | 52.9% | 3,512 | 45.7% | 45,016 | 50.2% |
| Hotels & Lodging | 9 | 1.0% | 166 | 1.4% | 97 | 1.8% | 2,197 | 3.5% | 132 | 1.7% | 3,204 | 3.6% |
| Automotive Services | 10 | 1.1% | 67 | 0.6% | 79 | 1.5% | 361 | 0.6% | 145 | 1.9% | 642 | 0.7% |
| Movies & Amusements | 25 | 2.7% | 133 | 1.1% | 153 | 2.9% | 881 | 1.4% | 223 | 2.9% | 1,366 | 1.5% |
| Health Services | 157 | 16.9% | 4,085 | 35.0% | 549 | 10.3% | 15,600 | 25.0% | 742 | 9.7% | 20,100 | 22.4% |
| Legal Services | 31 | 3.3% | 139 | 1.2% | 192 | 3.6% | 1,015 | 1.6% | 214 | 2.8% | 1,080 | 1.2% |
| Education Inst. & Libraries | 15 | 1.6% | 550 | 4.7% | 96 | 1.8% | 2,372 | 3.8% | 144 | 1.9% | 3,760 | 4.2% |
| Other Services | 252 | 27.1% | 1,846 | 15.8% | 1,410 | 26.5% | 10,580 | 17.0% | 1,913 | 24.9% | 14,864 | 16.6% |
| Government (91-97) | 21 | 2.3% | 780 | 6.7% | 144 | 2.7% | 5,068 | 8.1% | 188 | 2.5% | 5,751 | 6.4% |
| Unclassified Establishments (99) | 60 | 6.5% | 2 | 0.0% | 329 | 6.2% | 54 | 0.1% | 471 | 6.1% | 77 | 0.1% |
| Totals (01-99) | 930 | 100.0% | 11,670 | 100.0% | 5,314 | 100.0% | 62,388 | 100.0% | 7,681 | 100.0% | 89,742 | 100.0% |



Source: This infographic contains data provided by Esri-Data Axle (2025), Esri (2025).

Key Facts

408 Depot St. #150, Asheville, NC 28801
Ring: 5 mile radius

KEY FACTS

108,843

Population



2.1

Average Household Size



40.6

Median Age

\$69,584

Median Household Income

EDUCATION



6.0%

No High School Diploma



19.4%

High School Graduate



21.0%

Some College/
Associate's Degree



53.7%

Bachelor's/Grad/
Prof Degree

BUSINESS



7,681

Total Businesses



89,742

Total Employees

EMPLOYMENT



65.7%

White Collar



15.1%

Blue Collar



19.2%

Services



6.2%

Unemployment Rate

INCOME



\$69,584

Median Household Income



\$46,516

Per Capita Income



\$118,323

Median Net Worth

2025 Households by income (Esri)

The largest group: \$50,000 - \$74,999 (16.8%)

The smallest group: \$25,000 - \$34,999 (7.3%)

| Indicator ▲ | Value | Diff | | |
|-----------------------|-------|-------|--|--|
| <\$15,000 | 10.7% | +2.3% | | |
| \$15,000 - \$24,999 | 7.6% | +0.6% | | |
| \$25,000 - \$34,999 | 7.3% | +0.7% | | |
| \$35,000 - \$49,999 | 11.0% | +0.5% | | |
| \$50,000 - \$74,999 | 16.8% | -0.1% | | |
| \$75,000 - \$99,999 | 11.8% | -1.4% | | |
| \$100,000 - \$149,999 | 13.9% | -1.9% | | |
| \$150,000 - \$199,999 | 10.2% | -0.2% | | |
| \$200,000+ | 10.8% | -0.4% | | |

Bars show deviation from Buncombe County

Demographic and Income Profile

408 Depot St. #150, Asheville, NC 28801
 408 Depot St, Asheville, North Carolina, 28801
 Ring: 5 mile radius



| Summary | Census 2020 | 2025 | 2030 |
|-------------------------------|-------------|---------|---------|
| Total Population | 103,091 | 108,843 | 112,747 |
| Total Households | 46,134 | 48,782 | 50,669 |
| Family Households | 23,513 | 24,000 | 24,633 |
| Average Household Size | 2.14 | 2.15 | 2.14 |
| Owner Occupied Housing Units | 24,473 | 25,688 | 26,504 |
| Renter Occupied Housing Units | 21,661 | 23,094 | 24,165 |
| Median Age | 39.4 | 40.6 | 42.0 |

| Trends 2025 - 2030 | Area | State | National |
|------------------------------|------|-------|----------|
| Population | 0.7% | 0.8% | 0.4% |
| Households | 0.8% | 1.1% | 0.6% |
| Family Population | 0.5% | 0.9% | 0.5% |
| Owner Occupied Housing Units | 0.6% | 1.2% | 0.0% |
| Median Household Income | 2.4% | 2.6% | 2.5% |

| Population by Age | Census 2020 | | 2025 | | 2030 | |
|-------------------|-------------|---------|--------|---------|--------|---------|
| | Number | Percent | Number | Percent | Number | Percent |
| 0-4 | 4,771 | 4.6% | 4,800 | 4.4% | 4,807 | 4.3% |
| 5-9 | 4,973 | 4.8% | 5,157 | 4.7% | 4,876 | 4.3% |
| 10-14 | 5,135 | 5.0% | 5,030 | 4.6% | 5,139 | 4.6% |
| 15-19 | 5,732 | 5.6% | 6,125 | 5.6% | 5,942 | 5.3% |
| 20-24 | 6,726 | 6.5% | 7,021 | 6.5% | 7,485 | 6.6% |
| 25-29 | 8,397 | 8.2% | 7,465 | 6.9% | 7,832 | 7.0% |
| 30-34 | 8,750 | 8.5% | 9,004 | 8.3% | 7,737 | 6.9% |
| 35-39 | 7,971 | 7.7% | 8,909 | 8.2% | 9,074 | 8.1% |
| 40-44 | 7,338 | 7.1% | 8,039 | 7.4% | 8,819 | 7.8% |
| 45-49 | 6,359 | 6.2% | 7,362 | 6.8% | 7,866 | 7.0% |
| 50-54 | 5,775 | 5.6% | 6,334 | 5.8% | 7,101 | 6.3% |
| 55-59 | 6,057 | 5.9% | 5,857 | 5.4% | 6,297 | 5.6% |
| 60-64 | 6,297 | 6.1% | 6,005 | 5.5% | 5,829 | 5.2% |
| 65-69 | 6,292 | 6.1% | 6,290 | 5.8% | 6,105 | 5.4% |
| 70-74 | 5,336 | 5.2% | 5,880 | 5.4% | 5,942 | 5.3% |
| 75-79 | 3,311 | 3.2% | 4,698 | 4.3% | 5,221 | 4.6% |
| 80-84 | 1,907 | 1.9% | 2,688 | 2.5% | 3,801 | 3.4% |
| Age 85+ | 1,966 | 1.9% | 2,179 | 2.0% | 2,874 | 2.5% |

| Households by Income | 2025 | | 2030 | |
|--------------------------|-----------|---------|-----------|---------|
| | Number | Percent | Number | Percent |
| <\$10,000 | 3,138 | 6.4% | 2,988 | 5.9% |
| \$10,000-14,999 | 2,101 | 4.3% | 1,885 | 3.7% |
| \$15,000-19,999 | 1,937 | 4.0% | 1,612 | 3.2% |
| \$20,000-24,999 | 1,761 | 3.6% | 1,453 | 2.9% |
| \$25,000-29,999 | 1,589 | 3.3% | 1,251 | 2.5% |
| \$30,000-34,999 | 1,962 | 4.0% | 1,781 | 3.5% |
| \$35,000-39,999 | 2,424 | 5.0% | 2,120 | 4.2% |
| \$40,000-44,999 | 1,580 | 3.2% | 1,501 | 3.0% |
| \$45,000-49,999 | 1,338 | 2.7% | 1,281 | 2.5% |
| \$50,000-59,999 | 2,962 | 6.1% | 2,872 | 5.7% |
| \$60,000-74,999 | 5,239 | 10.7% | 5,501 | 10.9% |
| \$75,000-99,999 | 5,753 | 11.8% | 6,115 | 12.1% |
| \$100,000-124,999 | 3,694 | 7.6% | 3,997 | 7.9% |
| \$125,000-149,999 | 3,073 | 6.3% | 3,567 | 7.0% |
| \$150,000-199,999 | 4,977 | 10.2% | 6,042 | 11.9% |
| \$200,000-249,999 | 1,882 | 3.9% | 2,418 | 4.8% |
| \$250,000-299,999 | 1,148 | 2.4% | 1,546 | 3.0% |
| \$300,000-399,999 | 964 | 2.0% | 1,373 | 2.7% |
| \$400,000-499,999 | 387 | 0.8% | 280 | 0.6% |
| \$500,000+ | 873 | 1.8% | 1,085 | 2.1% |
| Median Household Income | \$69,584 | - | \$78,530 | - |
| Average Household Income | \$103,430 | - | \$115,058 | - |
| Per Capita Income | \$46,516 | - | \$51,848 | - |

| Race and Ethnicity | Census 2020 | | 2025 | | 2030 | |
|---------------------|-------------|---------|--------|---------|--------|---------|
| | Number | Percent | Number | Percent | Number | Percent |
| White Alone | 78,604 | 76.3% | 82,407 | 75.7% | 83,842 | 74.4% |
| Black Alone | 9,827 | 9.5% | 9,993 | 9.2% | 10,543 | 9.3% |
| American Indian | 476 | 0.5% | 494 | 0.5% | 528 | 0.5% |
| Asian Alone | 1,331 | 1.3% | 1,474 | 1.4% | 1,642 | 1.5% |
| Pacific Islander | 323 | 0.3% | 389 | 0.4% | 445 | 0.4% |
| Some Other Race | 4,903 | 4.8% | 5,555 | 5.1% | 6,295 | 5.6% |
| Two or More Races | 7,627 | 7.4% | 8,531 | 7.8% | 9,452 | 8.4% |
| Hispanic (Any Race) | 9,230 | 8.9% | 10,733 | 9.9% | 12,106 | 10.7% |

Key Indicators for 2025



Trends: 2025 - 2030 Annual Rate

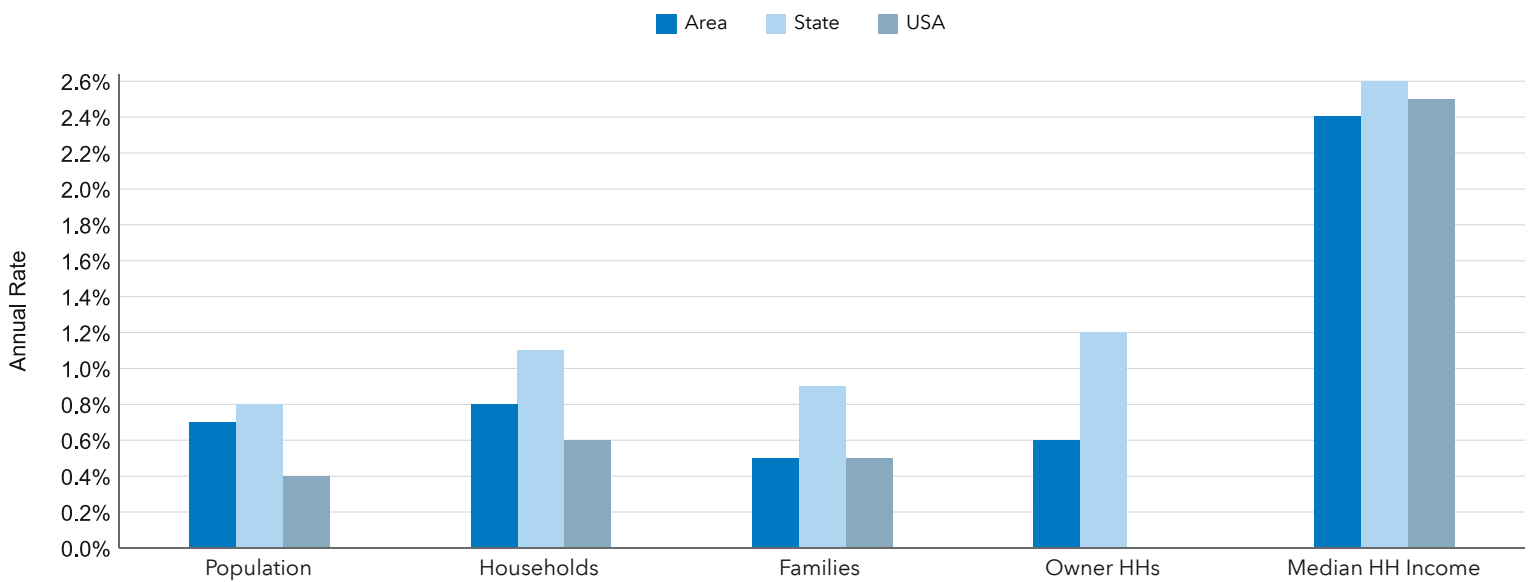

Population by Age

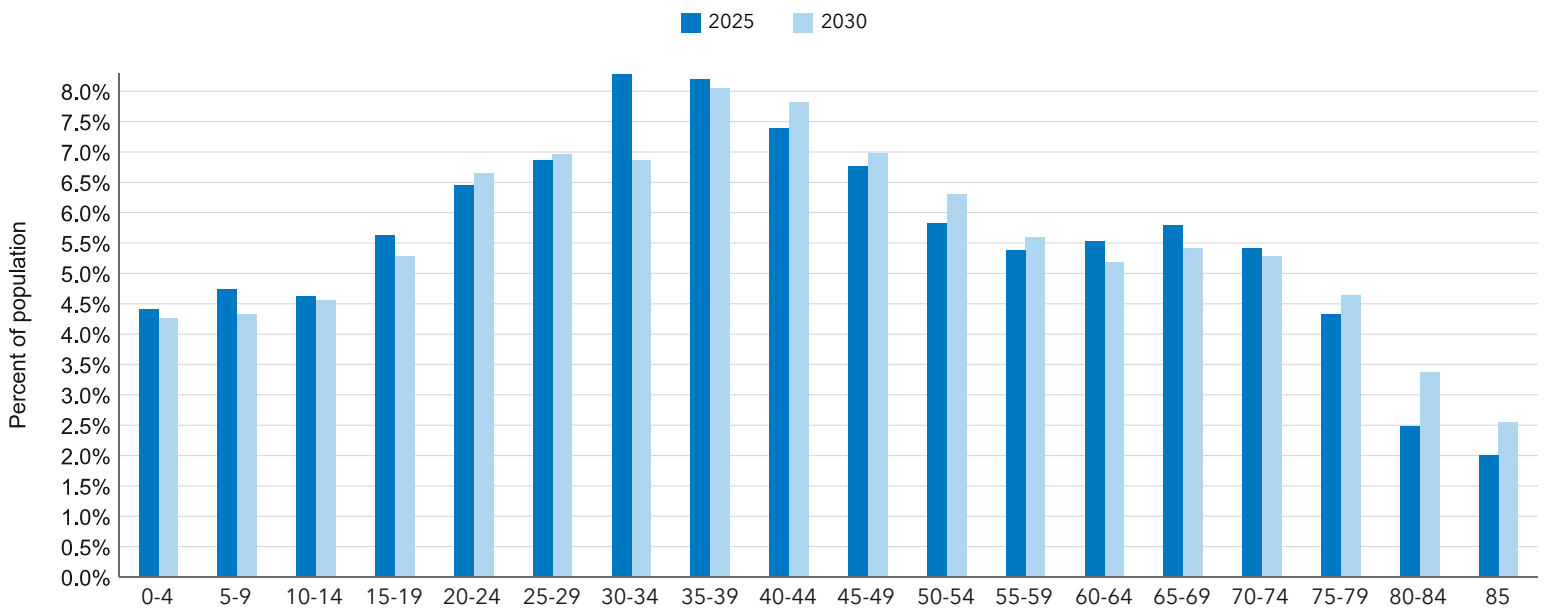

Key Indicators for 2025

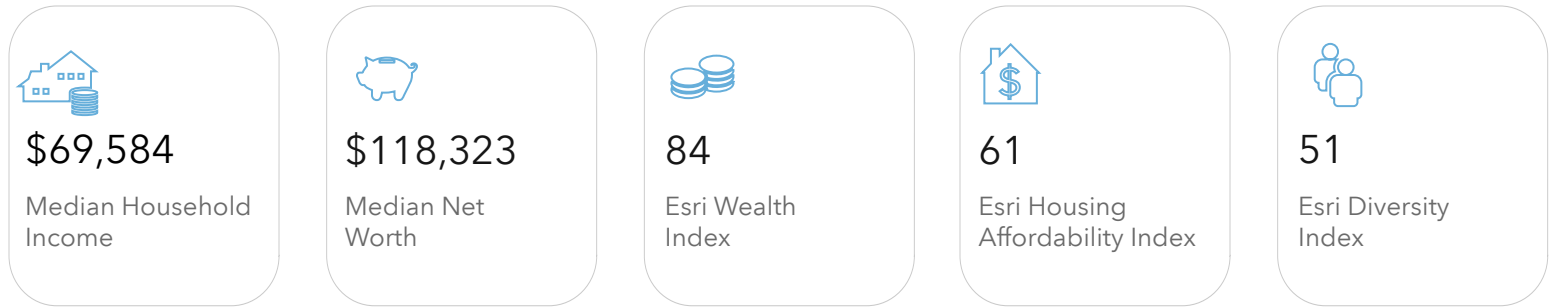

Households by Income for 2025

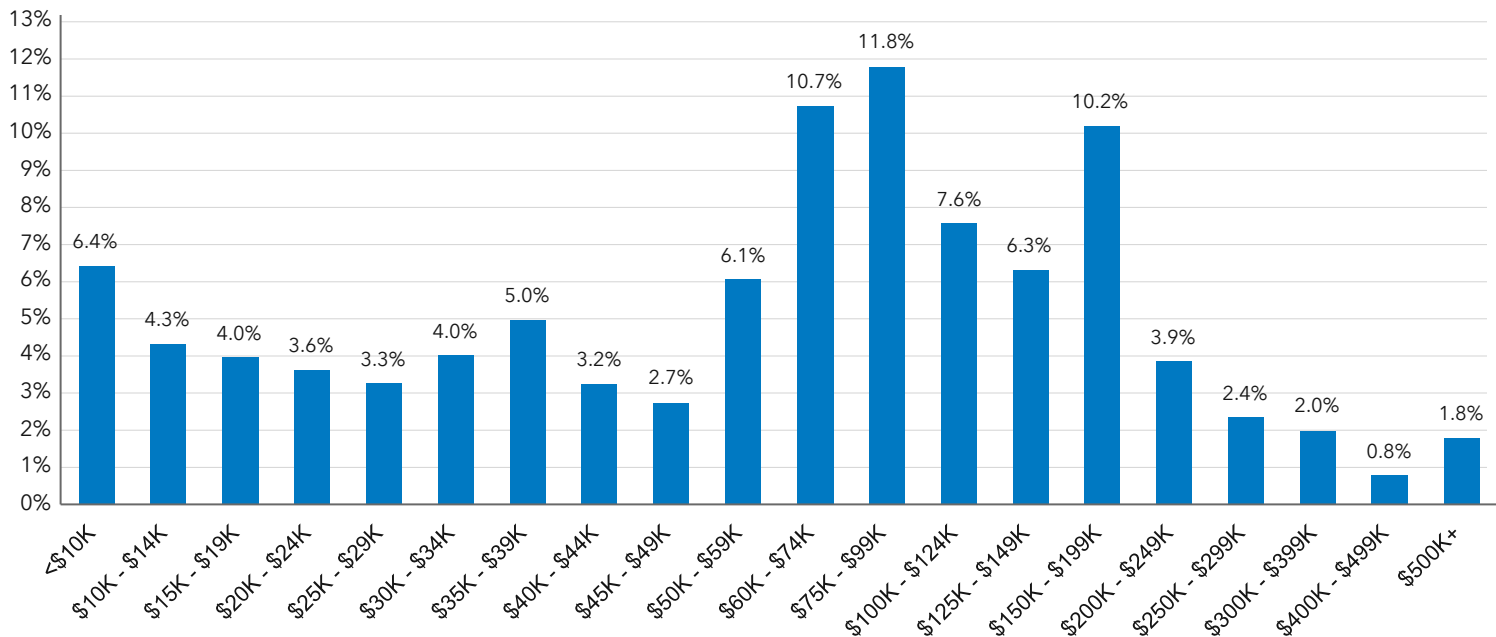

Population by Race

