



savills

3381 STEELES AVE E

17,602 SF

OFFICE SUBLEASE | MARKHAM, ON



PROPERTY DETAILS



Sublease Space SF

17,602 + 1,541 SHARED



Asking Rent

TO BE NEGOTIATED



Additional Rent PSF

\$18.91



Term

JULY 30, 2029



Occupancy

IMMEDIATE

IN THE HEART OF STEELES TECHNOLOGY CAMPUS

1.3 MILLION SQUARE FEET OF OFFICE & MIXED USE DEVELOPMENT LANDS



[Click here to view all](#)

**SUITE
PHOTOS**

KEY HIGHLIGHTS

Premises are built-out with 17 offices, 4 conference rooms, 2 meeting rooms, 93 workstations, copy room, kitchenette, storage room and private washrooms.

Bright space with floor to ceiling windows providing incredible views.

Immediate access to Hwy 404 via Steeles Avenue East and convenient TTC bus routes and nearby GO Transit.

CAMPUS BOASTS STATE-OF-THE-ART TECHNOLOGICAL ADVANCEMENTS AND ABUNDANT QUALITY AMENITIES.

3381 STEELES AVENUE EAST SERVICES TENANTS WITH RESTAURANTS, FITNESS ROOM, CAR SERVICES AND SPORTS/ RECREATION.

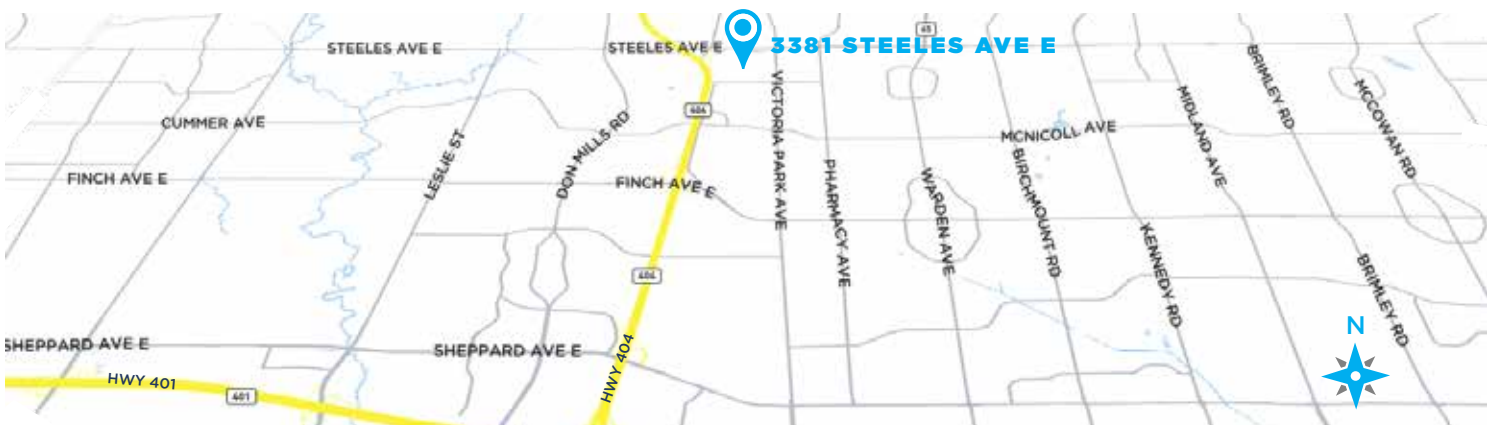



PRIVATE OFFICE



MEETING ROOM

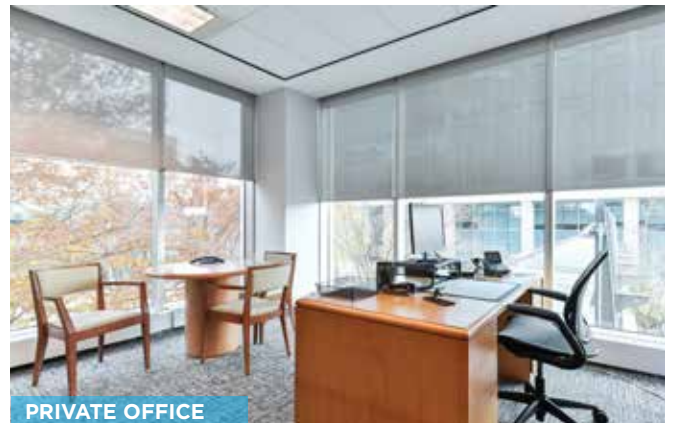

PRIVATE OFFICE



OPEN WORKSPACE



BOARDROOM



OPEN WORKSPACE



PRIVATE OFFICE

FLOOR PLAN

Full Floor Space

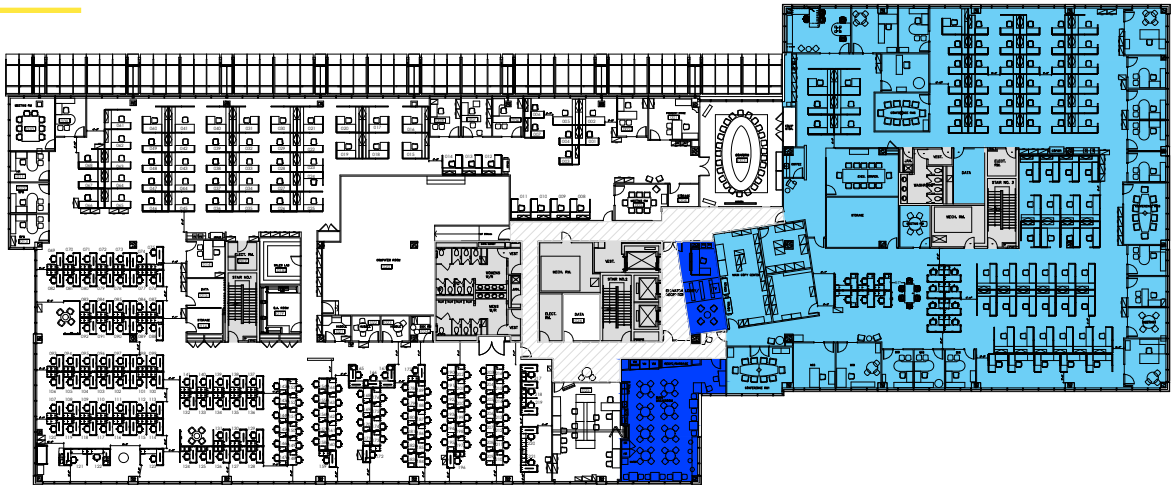

Sublease & Shared Space

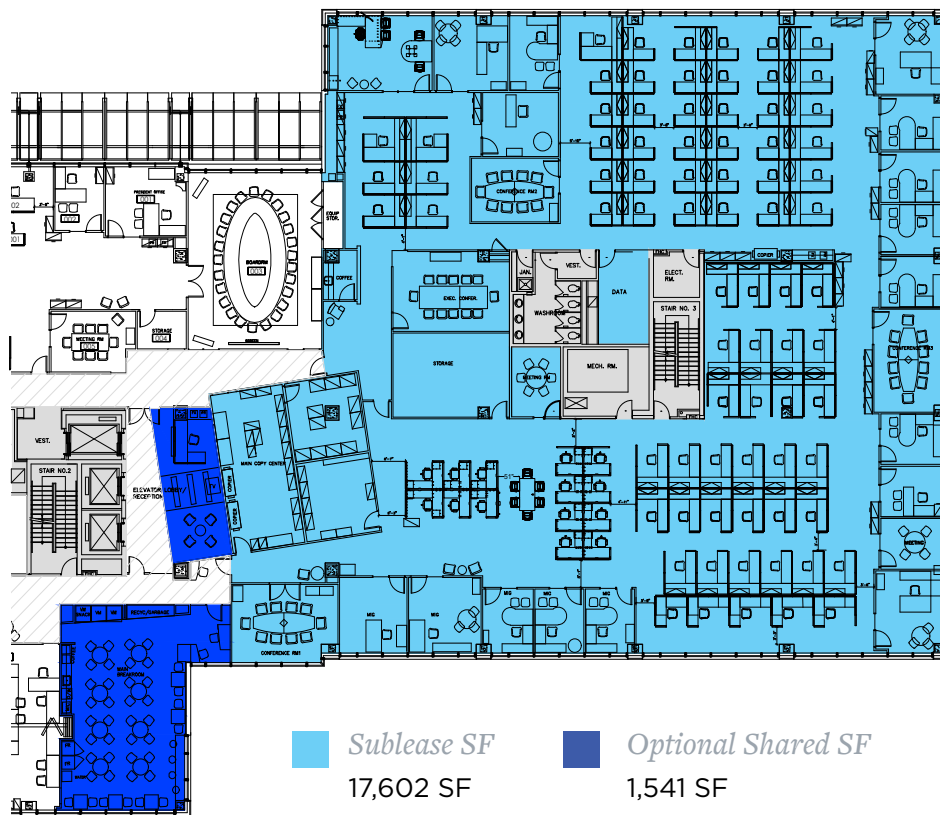

■ Sublease SF
17,602 SF

■ Optional Shared SF
1,541 SF

All measurements are approximate.



STAN KRAWITZ
Broker of Record
+1 647 946 6700
skrawitz@savills.ca

PAUL KAY
Sales Representative
+1 647 946 6702
pkay@savills.ca

GRAHAM BOOTH
Sales Representative
+1 647 946 6689
gbooth@savills.ca

SAVILLS INC., BROKERAGE | 181 BAY STREET, SUITE 2810 | TORONTO, ON M5J 2T3 | T: +1 416 480 0745

*This disclaimer shall apply to Savills Inc. The information set out herein (the "Information") has not been verified by Savills, and Savills does not represent, warrant or guarantee the accuracy, correctness and completeness of the Information. Savills does not accept or assume any responsibility or liability, direct or consequential, for the Information or the recipient's reliance upon the Information. The recipient of the Information should take such steps as the recipient may deem necessary to verify the Information prior to placing any reliance upon the Information. The Information may change and any property described in the Information may be withdrawn from the market at any time without notice or obligation to the recipient from Savills. *Sales Representative **Broker*