

**9389 DOWDY DRIVE
SAN DIEGO, CA 92126**

**\$1.75/SF GROSS
FIRST YEAR PROMO RATE!**

**AVAILABLE FOR LEASE:
MIRAMAR DISTRIBUTION
±5,095 SF**



JEFF SALLEN
VICE PRESIDENT/PARTNER
LIC. #01799957
619.559.5300
JSALLEN@VOITCO.COM

DAVID SANTOS
SENIOR ASSOCIATE
LIC. #02136273
714.673.0277
DSANTOS@VOITCO.COM

Voit
REAL ESTATE SERVICES

PROPERTY HIGHLIGHTS

- » Central Miramar location
- » Dock high loading
- » Approximately 18' warehouse clearance
- » Fully sprinklered
- » Shower in Restroom
- » Easily accessible from I-15, CA-805 & Miramar Road
- » New vinyl flooring & paint throughout existing offices
- » New LED lighting throughout offices & warehouse
- » Move-In ready condition

AVAILABILITY

Suite	Square Feet	Loading	Build-Out	Rate	Available
F	5,095 SF	One (1) Dock	10%	\$1.85/SF Industrial Gross	Immediately



SUITE F FLOOR PLAN

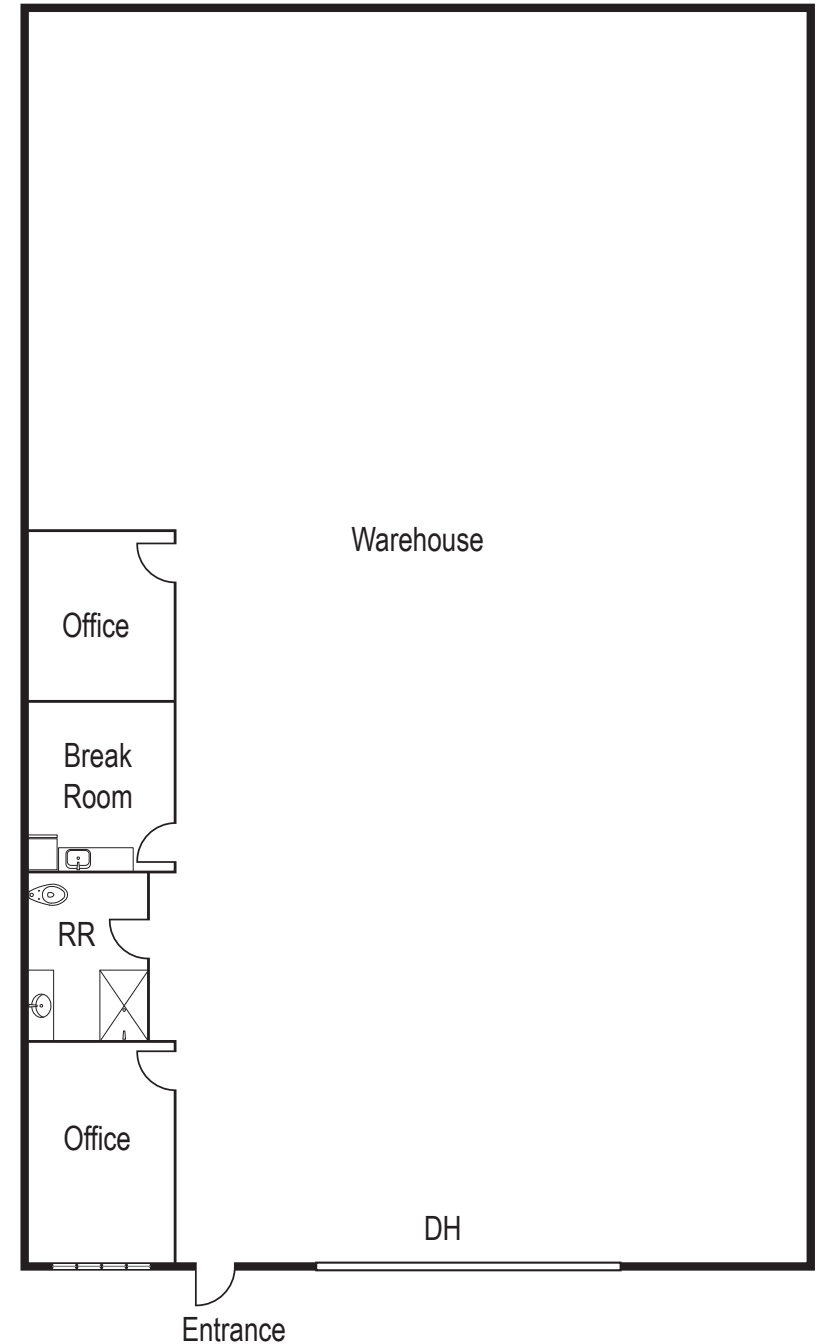

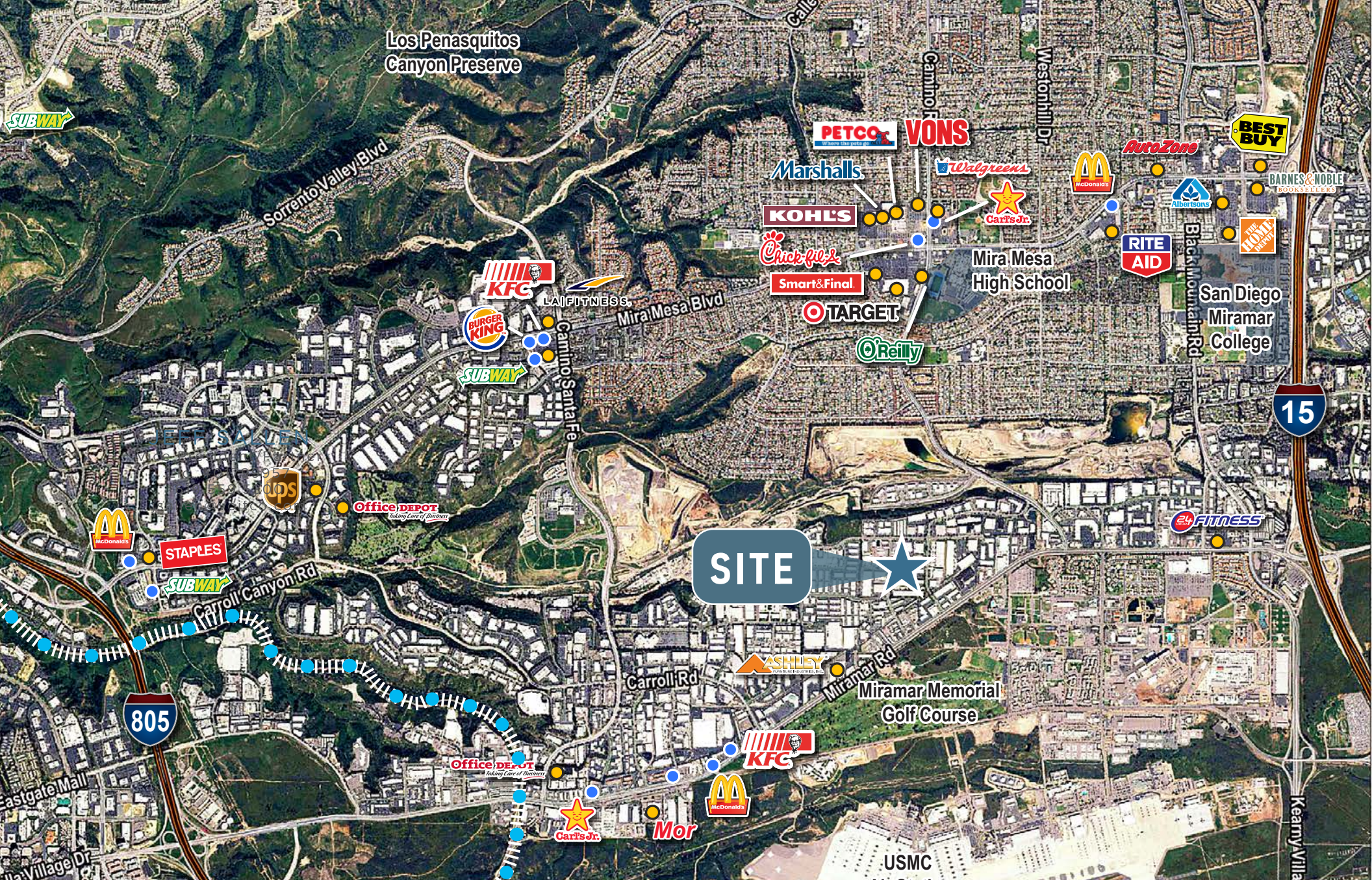

JEFF SALLEN
 VICE PRESIDENT/PARTNER
 LIC. #01799957
 619.559.5300
 JSALLEN@VOITCO.COM

DAVID SANTOS
 SENIOR ASSOCIATE
 LIC. #02136273
 714.673.0277
 DSANTOS@VOITCO.COM

4180 La Jolla Village Drive, Suite 100, La Jolla, CA 92037
 • 858.453.0505 • Lic.#01991785

www.voidco.com

Licensed as a Real Estate Salesperson by the DRE. The information contained herein has been obtained from sources we deem reliable. While we have no reason to doubt its accuracy, we do not guarantee it. ©2026 Voit Real Estate Services, Inc. All Rights Reserved.

Voit
 REAL ESTATE SERVICES