

Development Lots

2310 Lexington Road
Nicholasville, Kentucky 40356

Property Highlights

- +/- 1 - 15 AC development lots available
- Direct frontage on Lexington Road (US 27) across from Connemara Golf Course
- Strategically located on the primary thoroughfare between Lexington and Nicholasville
- The US 27 corridor is experiencing a tremendous amount of recent and proposed new commercial and residential developments
- Close proximity to major retailers and commercial centers including Walmart and Brannon Crossing
- High average daily traffic count of +/-35,153 VPD
- Positioned in an area of significant commercial and residential development
- Zoned B-2, Highway Commercial
- Ideal for retail stores, banks, restaurants, car washes, gas stations, auto repair and more

Offering Summary

| | |
|--------------------|-------------------------|
| Sale Price: | \$650,000 / acre |
| Lot Size: | 1 - 15 Acres |
| Zoning: | B-2, Highway Commercial |

For More Information

Al Isaac

President

O: 859 422 4400

alisaac@naiisaac.com | KY #223721

Zach Smith, CCIM

Senior Associate

O: 859 224 2000

zachsmith@naiisaac.com

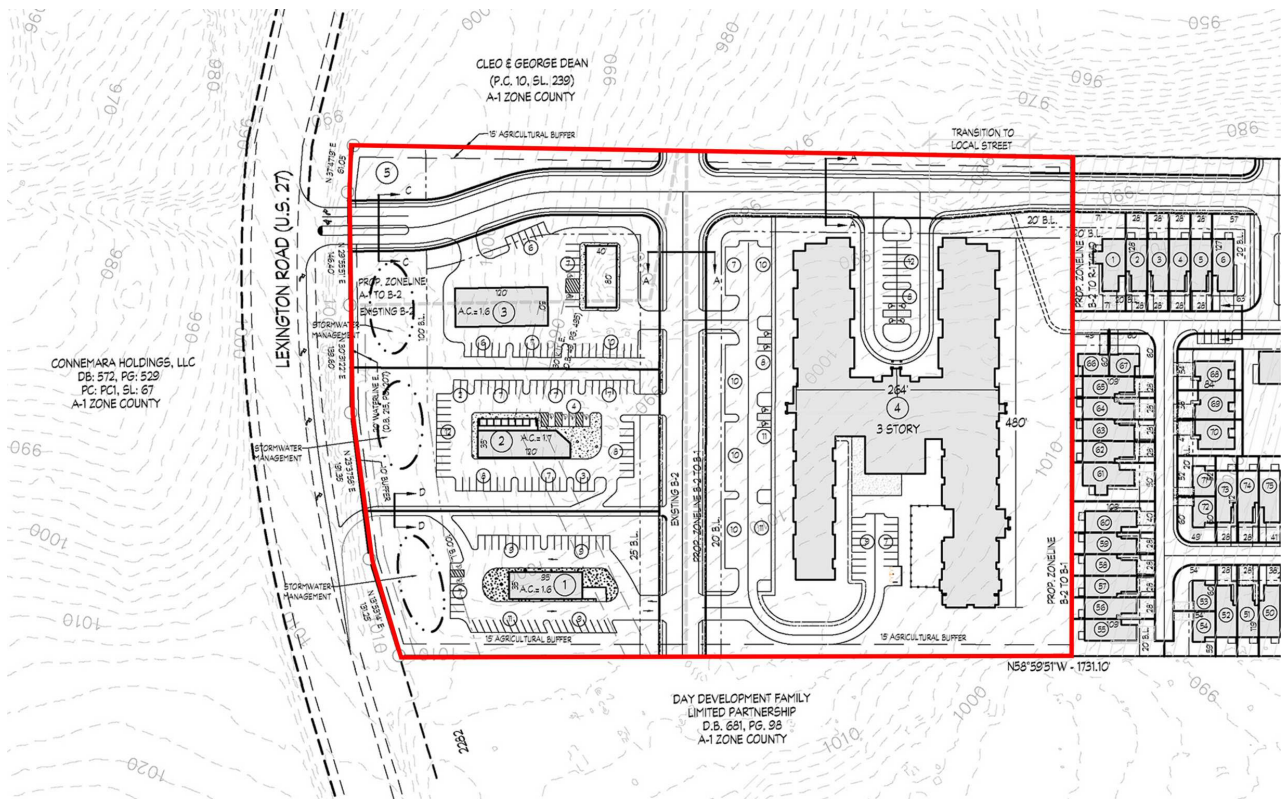
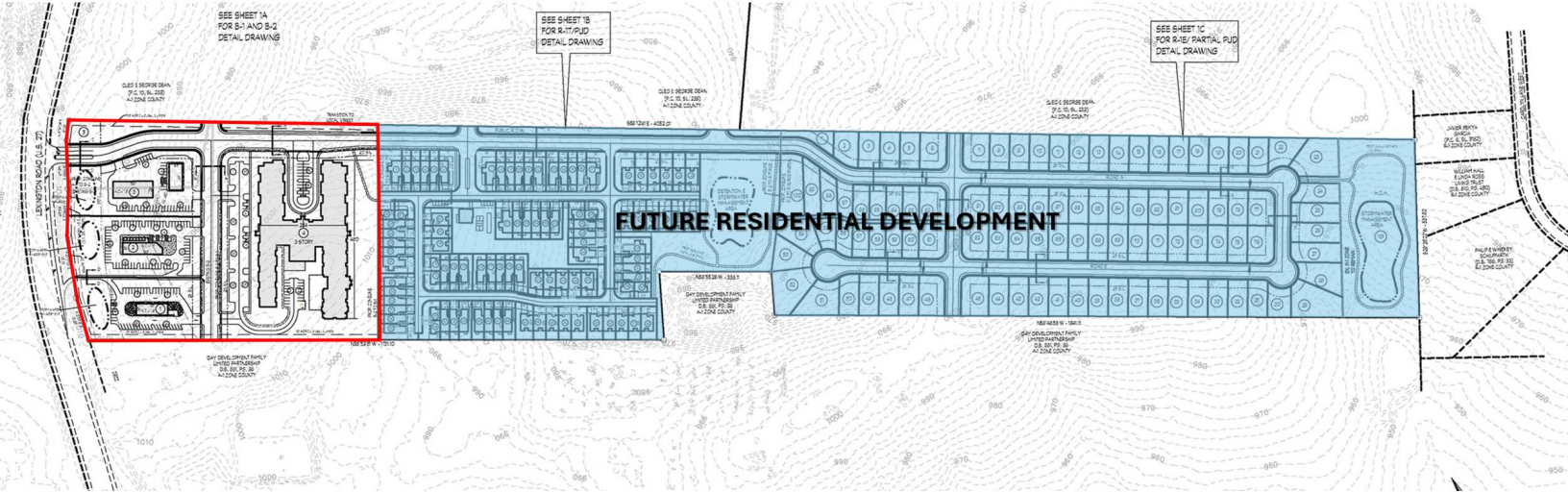

NO WARRANTY OR REPRESENTATION, EXPRESS OR IMPLIED, IS MADE AS TO THE ACCURACY OF THE INFORMATION CONTAINED HEREIN, AND THE SAME IS SUBMITTED SUBJECT TO ERRORS, OMISSIONS, CHANGE OF PRICE, RENTAL OR OTHER CONDITIONS, PRIOR SALE, LEASE OR FINANCING, OR WITHDRAWAL WITHOUT NOTICE, AND OF ANY SPECIAL LISTING CONDITIONS IMPOSED BY OUR PRINCIPALS NO WARRANTIES OR REPRESENTATIONS ARE MADE AS TO THE CONDITION OF THE PROPERTY OR ANY HAZARDS CONTAINED THEREIN ARE ANY TO BE IMPLIED.

771 Corporate Drive, Suite 500
Lexington, KY 40503
859 224 2000 tel
naiisaac.com



The image is an aerial photograph of a large tract of land, outlined in red. A major road runs vertically through the center of the tract. To the left of the road, a green line labeled 'Sewer Line' runs parallel to it, with several manholes marked with orange circles and numbered 1-147 through 1-201. To the right of the road, an orange line labeled 'Water Line' runs parallel to it, with manholes marked with orange circles and numbered 1-202 through 1-206. The land is divided into numerous lots, many of which are numbered. The area to the left of the road appears to be a golf course or park area. The area to the right of the road contains several buildings, including a large white multi-story building, and some residential-style houses. The overall terrain is green and appears to be a mix of developed and undeveloped land.

Connemara



THE ALLEN CO. INC.
Serving Kentucky since 1939

Altech

JOHN CLAY AutoMotive

Stokley's MARINE

POWERS TRANSMISSIONS
COMPLETE CAR CARE

DON FRANKLIN MITSUBISHI

double kwik

Wawa

Red Trifield
PACIFIC

Cannemara
Where the greens are always ailing

35,153 VPD

Borders Fencing, LLC

Rodgers Floor Covering

Storage Sense

CARSTAR
Auto Body Repair Experts

MY 3 SONS MOVING
We help you move your way

DERBY INN & SUITES

bp

TOYOTA
On Nicholasville

NICHOLASVILLE CDJR

McLANE

Future Residential Development





NO WARRANTY OR REPRESENTATION, EXPRESS OR IMPLIED, IS MADE AS TO THE ACCURACY OF THE INFORMATION CONTAINED HEREIN, AND THE SAME IS SUBMITTED SUBJECT TO ERRORS, OMISSIONS, CHANGE OF PRICE, RENTAL OR OTHER CONDITIONS, PRIOR SALE, LEASE OR FINANCING, OR WITHDRAWAL WITHOUT NOTICE, AND OF ANY SPECIAL LISTING CONDITIONS IMPOSED BY OUR PRINCIPALS NO WARRANTIES OR REPRESENTATIONS ARE MADE AS TO THE CONDITION OF THE PROPERTY OR ANY HAZARDS CONTAINED THEREIN ARE ANY TO BE IMPLIED.

771 Corporate Drive, Suite 500
 Lexington, KY 40503
 859 224 2000 tel
naiisaac.com

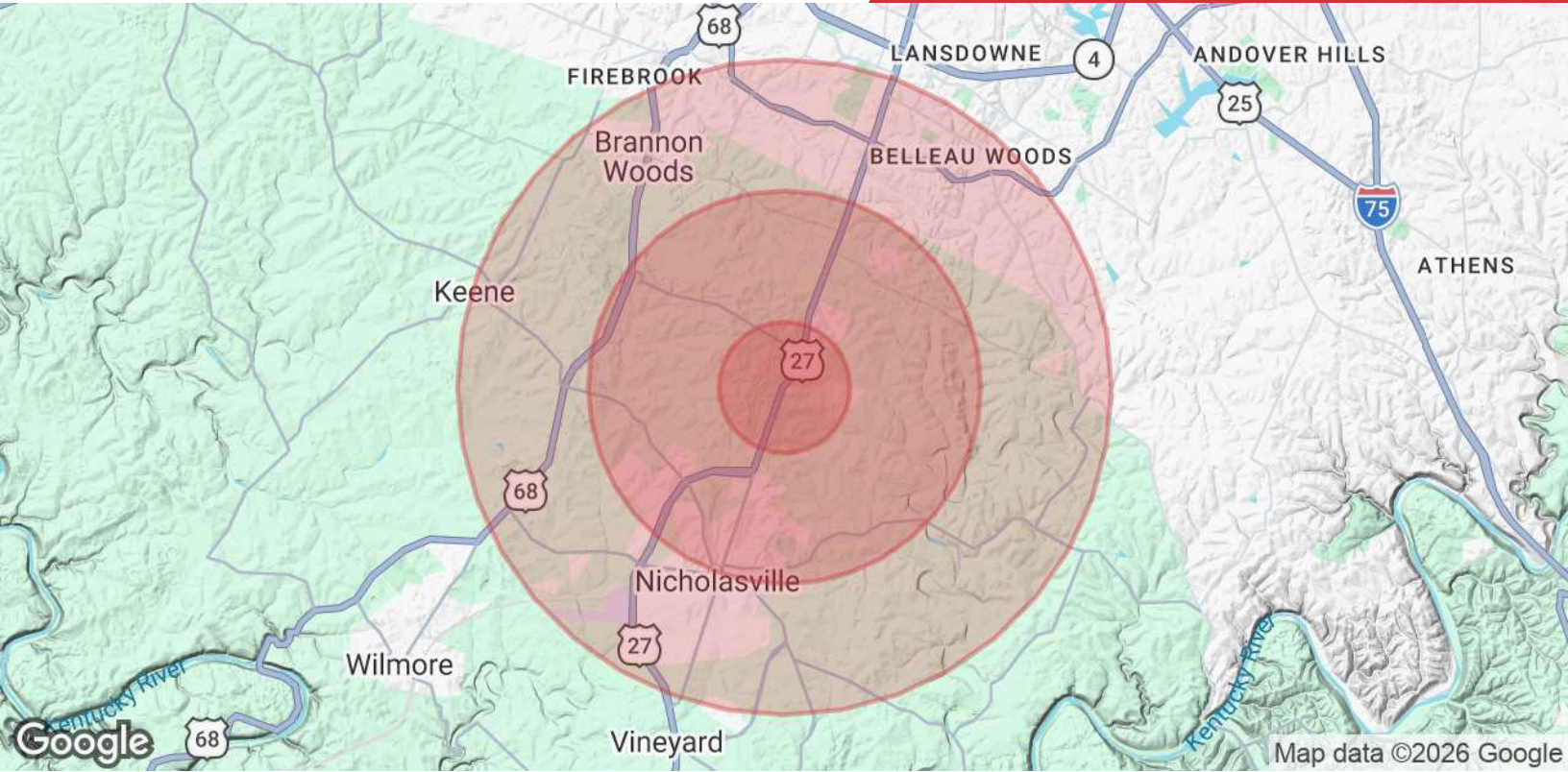

| | 1 Mile | 3 Miles | 5 Miles |
|--------------------------------|-----------|-----------|-----------|
| Population | | | |
| Total Population | 539 | 18,279 | 89,904 |
| Average Age | 44 | 39 | 40 |
| Average Age (Male) | 42 | 37 | 38 |
| Average Age (Female) | 46 | 40 | 41 |
| Households & Income | | | |
| Total Households | 191 | 6,837 | 35,671 |
| # of Persons per HH | 2.8 | 2.7 | 2.5 |
| Average HH Income | \$125,630 | \$92,280 | \$107,239 |
| Average House Value | \$459,120 | \$288,505 | \$315,798 |

Demographics data derived from STDB 2025