

RETAIL COMMERCIAL SHOWROOM FOR LEASE OR SALE

1258 Saviers Road
Oxnard, CA 93033



FREESTANDING • PARKING IN REAR

HIGHLIGHTS

- ▶ 17,500 SF Freestanding Building
- ▶ Fenced Rear Parking/Loading
- ▶ 140 Foot Frontage on Major Street
- ▶ Street Parking Allowed
- ▶ Just South of Oxnard Blvd & Wooley Rd (Hwy 1)
- ▶ Rear Entry/Loading Door Ground Level

FOR LEASE

- ▶ 17,500 SF @ \$1.10 psf Including NNN

FOR SALE

- ▶ ~~\$3,495,000 (\$199.71 PSF)~~
\$3,150,000.00 / \$180.00 PSF
Seller may carry for qualified buyer

| DEMOGRAPHICS 2024 | 1-Mile | 3-Miles | 5-Miles |
|-------------------|--------|---------|---------|
| Total Population | 28,148 | 193,241 | 233,904 |
| Employees | 10,147 | 46,044 | 69,033 |

Traffic Count: Saviers Rd @ Wolff St: 30,100 CPD
S. Oxnard Blvd @ E. Wooley Rd: 19,344 CPD

For further information contact:

BRUCE MILTON
805.626.1281
bmilton@lee-re.com
Lic # 01945652



REAR PARKING LOT



Lee & Associates®-LA North/Ventura, Inc. • ID #01191898
A Member of the Lee & Associates Group of Companies
2775 N. Ventura Rd., Suite 201, Oxnard, CA 93036
P 805.626.1200 F 805.413.7000 www.lee-associates.com

No warranty or representation is made to the accuracy of the foregoing information. Terms of sale or lease and availability are subject to change or withdrawal without notice.

RETAIL COMMERCIAL SHOWROOM FOR LEASE OR SALE

1258 Saviers Road
Oxnard, CA 93033

SITE PLAN

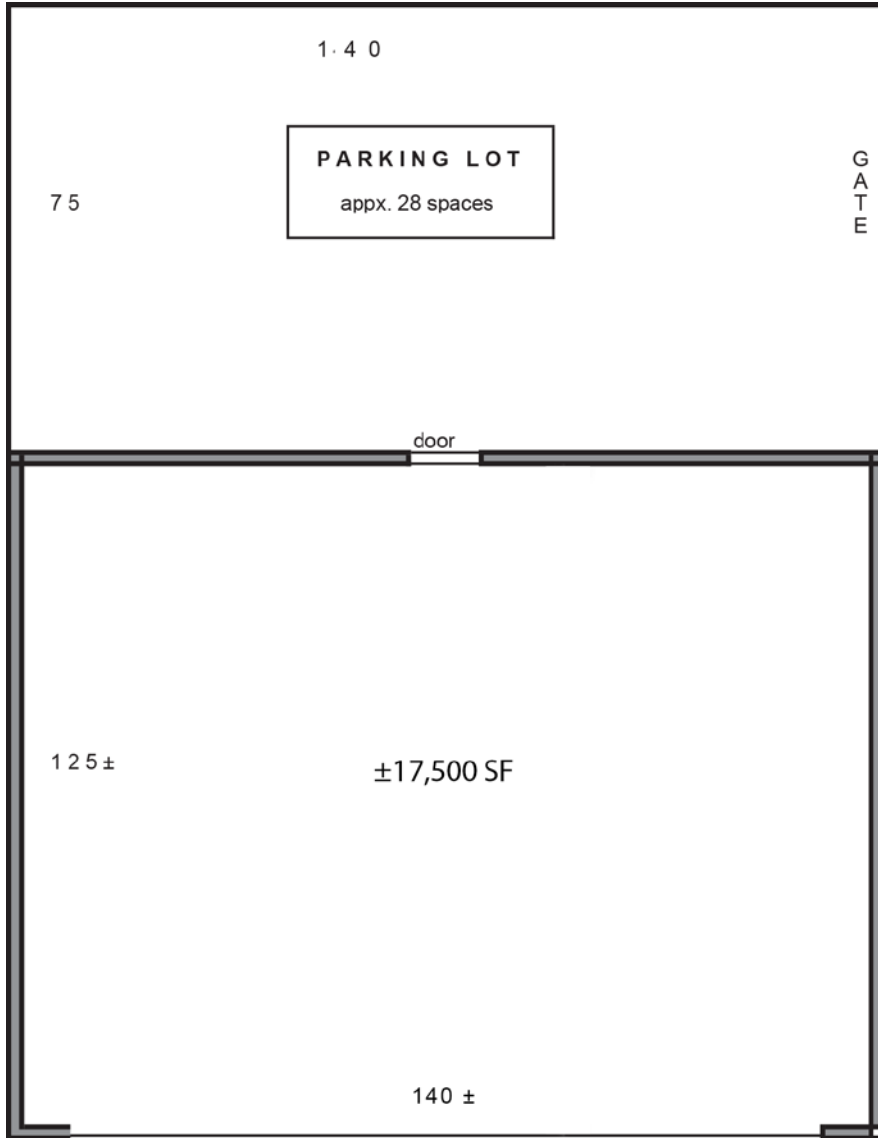

S A V I E R S R O A D



For further information contact:

BRUCE MILTON
805.626.1281
bmilton@lee-re.com
Lic # 01945652



