

Land For Sale

Northwest Corner of Cinnamon Hill Lane
Columbia, Missouri 65201
Parcel ID: 1740400050080101, Lot 201



For Sale: Build to Suit



Property Highlights:

- Size: 0.63+/- Acres, 27,442.+/- SF
- Build to Suit; Up to 4,500 SF building with 2 levels
- Ideal for office, retail, or restaurant (no drive through)
- Less than 3 miles from the University of Missouri-Columbia
- Nearby businesses include Break Time Convenience Store, Champs Chicken, Delia's Mexican Grill, Regal Cinemas, Holiday Inn Express & Suites, and Taco Bell

Opes Commercial Real Estate
Office: (816) 384-2900
1804 Swift St. Ste. 101 North Kansas City, MO 64116

For More Information:
Nate Prather | Office: (816) 268-4483
ntprather@opescre.com

Land For Sale

Northwest Corner of Cinnamon Hill Lane
Columbia, Missouri 65201
Parcel ID: 1740400050080101, Lot 201

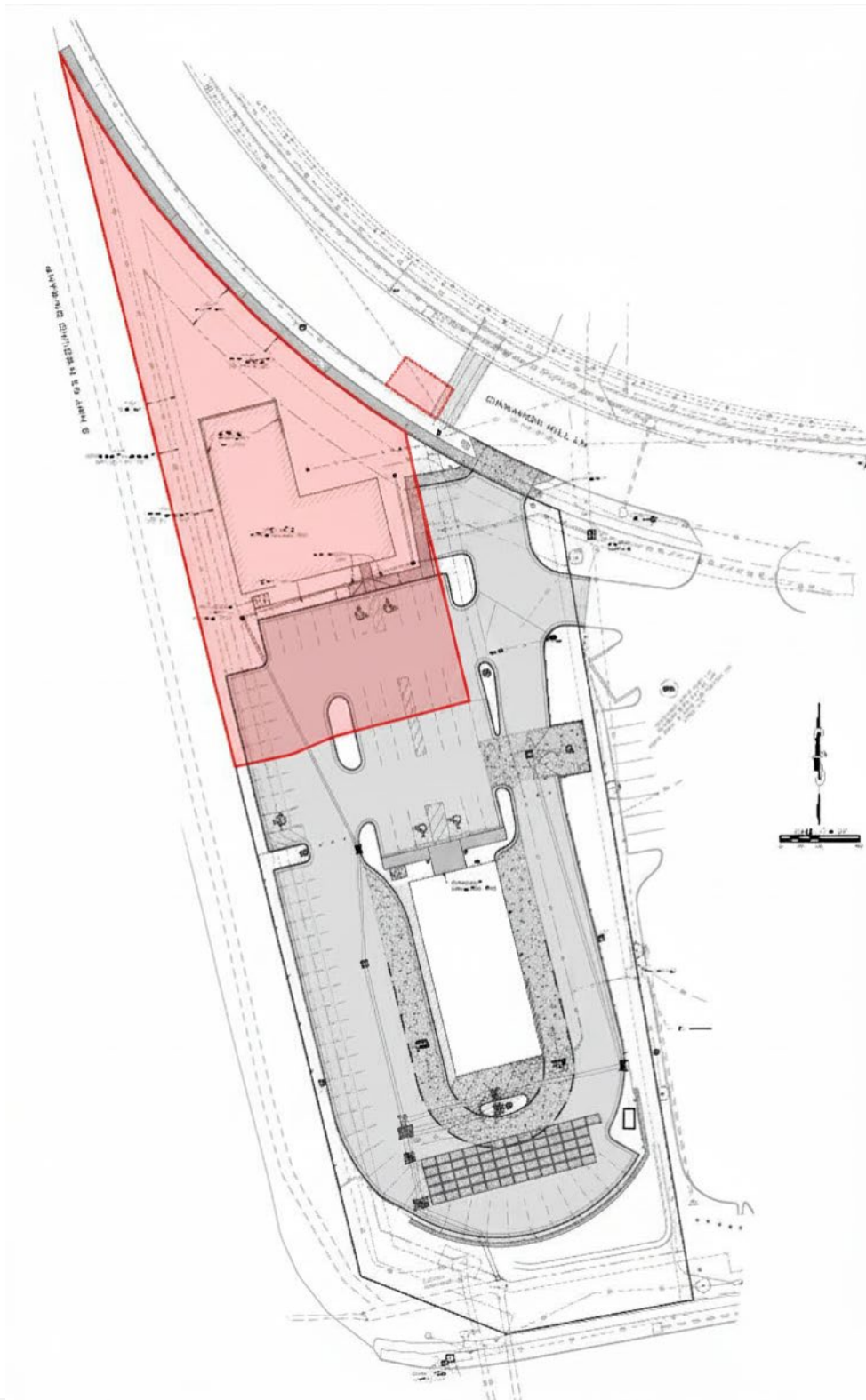

Opes Commercial Real Estate
Office: (816) 384-2900
1804 Swift St. Ste. 101 North Kansas City, MO 64116

For More Information:
Nate Prather | Office: (816) 268-4483
nprather@opescre.com

Land For Sale

Northwest Corner of Cinnamon Hill Lane
Columbia, Missouri 65201
Parcel ID: 1740400050080101, Lot 201



Opes Commercial Real Estate
Office: (816) 384-2900
1804 Swift St. Ste. 101 North Kansas City, MO 64116

For More Information:
Nate Prather | Office: (816) 268-4483
ntprather@opescre.com

Land For Sale

Northwest Corner of Cinnamon Hill Lane
Columbia, Missouri 65201
Parcel ID: 1740400050080101, Lot 201

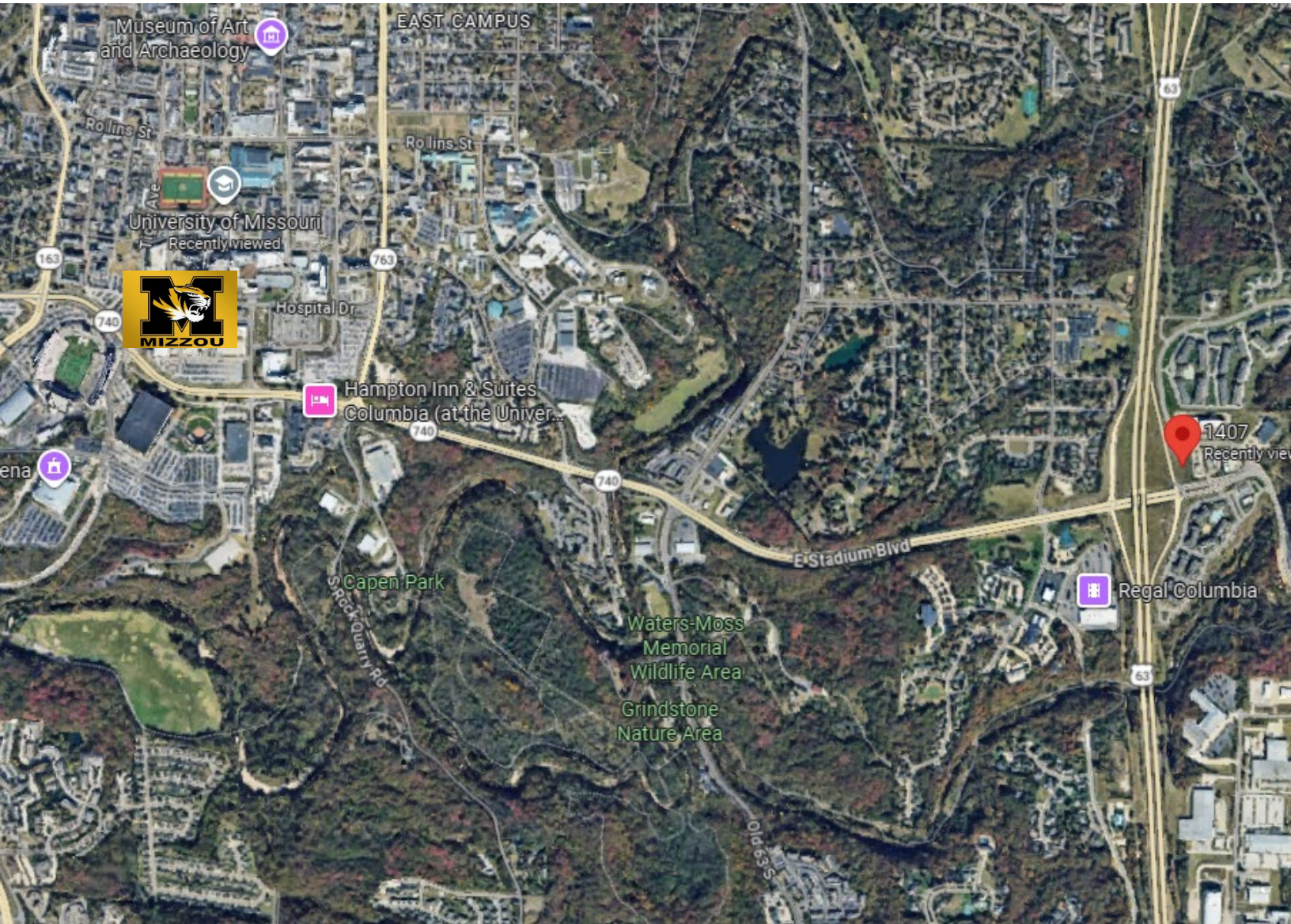

Opes Commercial Real Estate
Office: (816) 384-2900
1804 Swift St. Ste. 101 North Kansas City, MO 64116

For More Information:
Nate Prather | Office: (816) 268-4483
ntprather@opescre.com

Land For Sale

Northwest Corner of Cinnamon Hill Lane
Columbia, Missouri 65201
Parcel ID: 1740400050080101, Lot 201

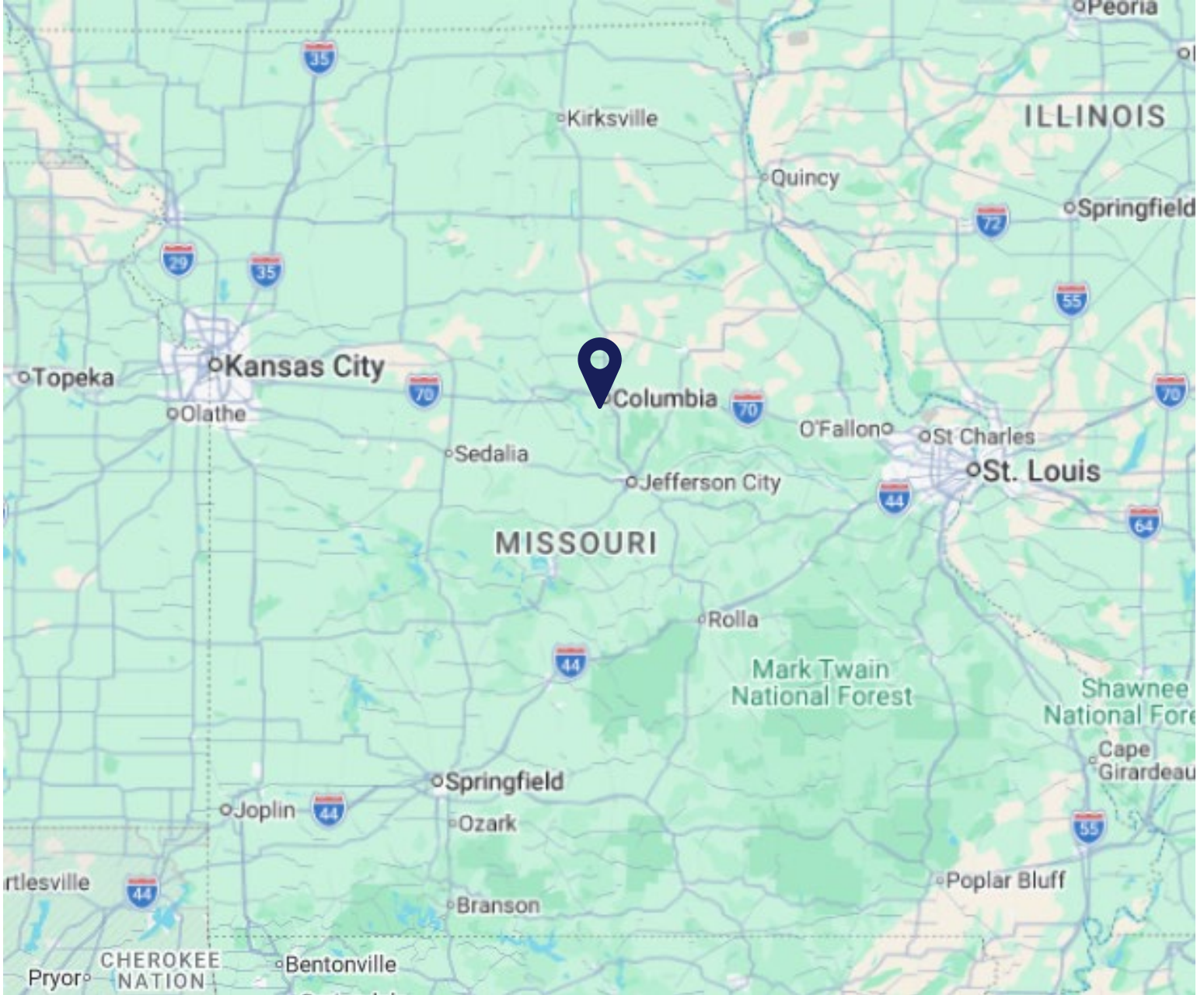

Disclaimer: Information is believed to be accurate but is not guaranteed. Opes Commercial Real Estate makes no representations or warranties as to its accuracy or completeness.

Opes Commercial Real Estate

Office: (816) 384-2900
1804 Swift St. Ste. 101 North Kansas City, MO 64116

For More Information:

Nate Prather | Office: (816) 268-4483
ntprather@opescre.com