

1205 Karl Court Unit: 111
Wauconda, IL

ENTRE
Commercial Realty LLC

For Lease

AVAILABLE: 1,500 SF

AVAILABLE SIZE:	1,500 SF
OFFICE SIZE:	± 200 SF
PARKING:	2 SPACES PER 1,000 SF
CEILING HEIGHT:	16'
POWER:	200 AMPS
LOADING:	1 DRIVE-IN DORR (10X10)
SPRINKLERED:	YES
ZONING:	I-1 (LIGHT INDUSTRIAL)

LEASE RATE: \$12.00 MG PSF



Presented By:

➤ **Mike Deserto**
224-588-3026
mdeserto@entreccommercial.com

➤ **Cory Kay**
224-532-2497
ckay@entreccommercial.com

➤ **Elisabeth Lazzara**
847-310-4209
elazzara@entreccommercial.com

 entreccommercial.com

The information contained herein is from sources deemed reliable but is submitted subject to errors, omissions and to change of price or terms without notice.

Facility Overview

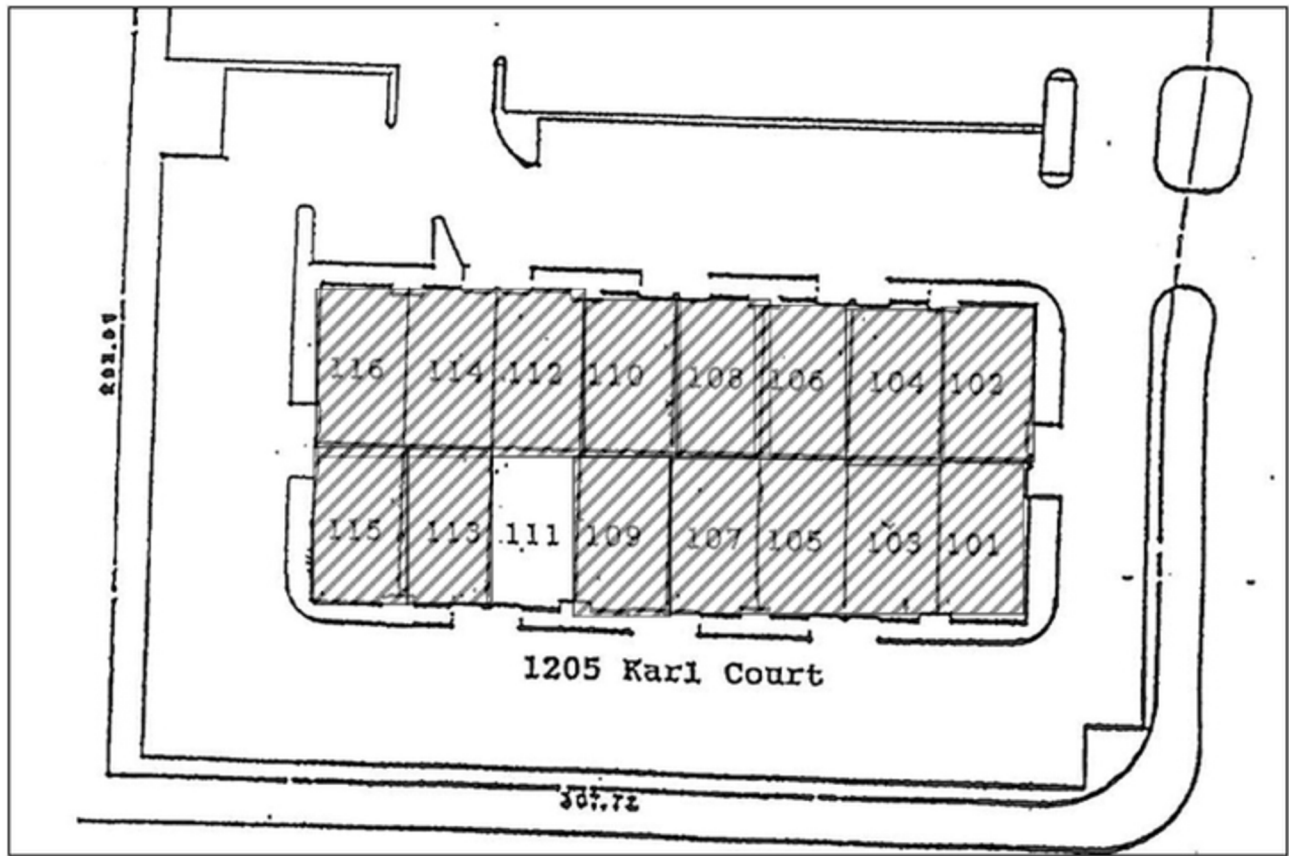

ENTRE
Commercial Realty LLC

Mike Deserto

224-588-3026

mdeserto@entrecommercial.com

Cory Kay

224-532-2497

ckay@entrecommercial.com

Elisabeth Lazzara

847-310-4209

elazzara@entrecommercial.com

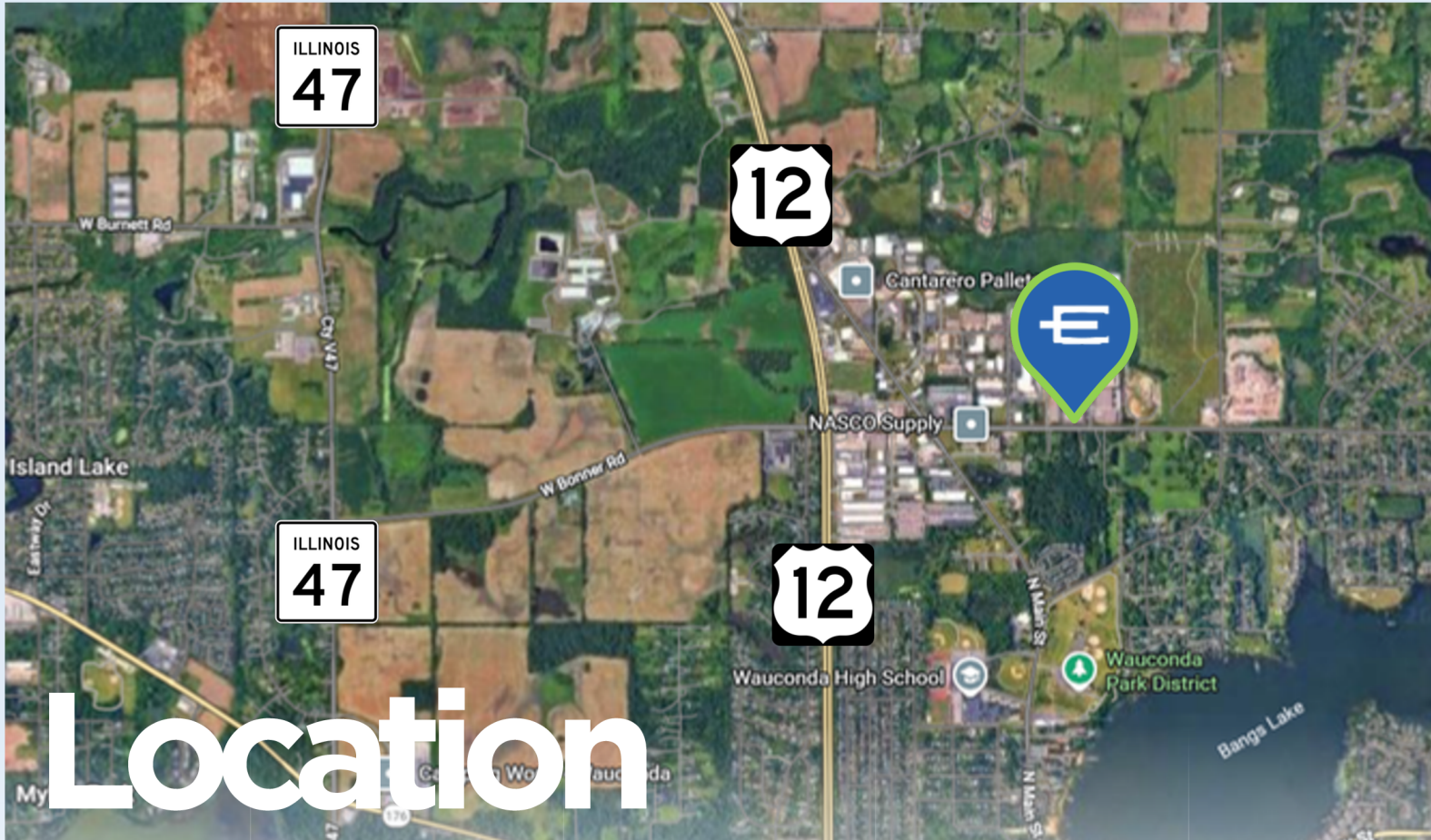

Location

1205 Karl Court Unit: 111 Wauconda, IL



Lake County

Positioned between Chicago and Milwaukee, Lake County offers prime access to major transportation routes, a strong talent pool, and a thriving mix of corporate, industrial, and research-driven industries. With modern infrastructure, welcoming communities, and room for business growth, the region supports innovation, productivity, and sustained economic success.

- Low Lake County Taxes
- Convenient Access to U.S. Hwy 12
- Strong Labor Pool

