



 FLOORSPACE

# Manulife Place

1095 W Pender Street

// FOR SUBLEASE

# 1095 W Pender Street

Located at 1095 West Pender Street, Manulife Place offers a professional office environment with modern common areas, on-site amenities, and strong transit connectivity. Tenants benefit from efficient floor plates, secure access, underground parking, and proximity to Downtown's leading dining, retail, and service offerings, supporting both daily operations and long-term workplace needs.

Unit 430

Availability 30 Days' Notice

Basic Rent Contact Listing Agent

Additional Rent \$28.57 PSFPA (2026 est.)

Expiry October 2029

Furniture Negotiable

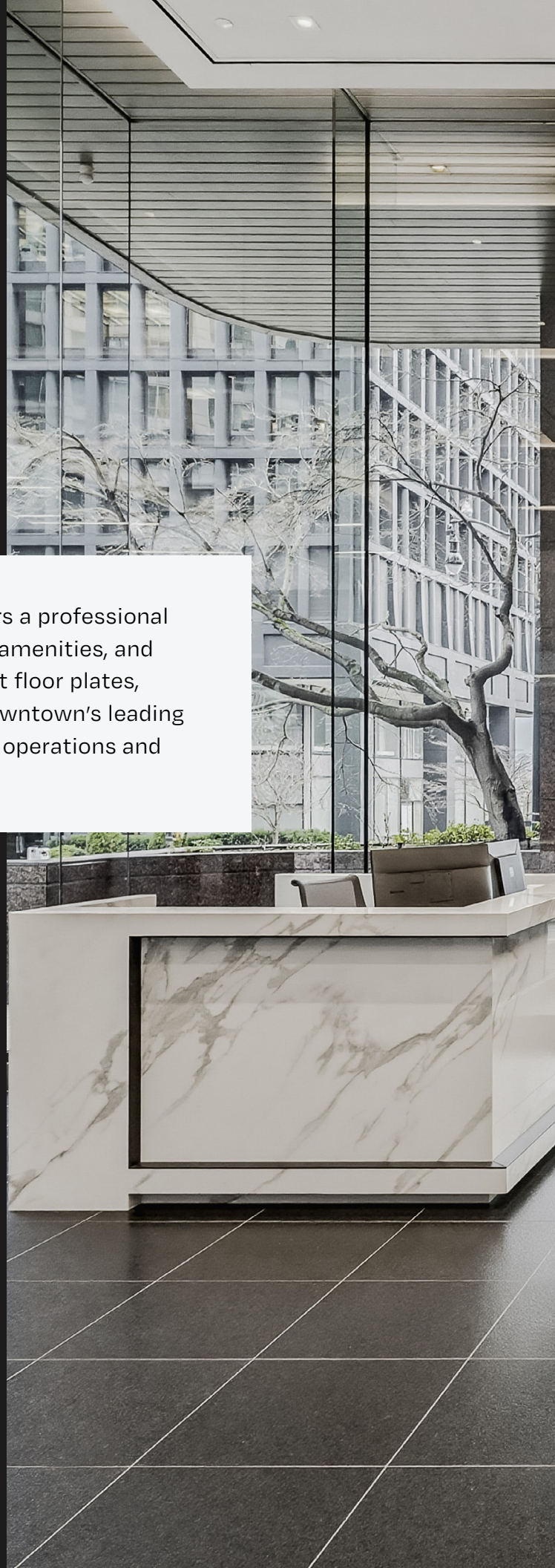

# FLOOR PLAN

## UNIT 430

2,592 SF (APPROX.)

Efficient, move-in ready office with a smart mix of private offices and collaborative space. The layout includes four private offices, a 6-person meeting room, a 10-person boardroom, a small breakout room, and open workstation seating for 12 employees.

A welcoming entry with elevator exposure, dedicated copy area, lunch/kitchen space, and ample storage support day-to-day operations. This unit is well suited for professional services, tech, or creative firms seeking a functional, balanced workspace with generous meeting space and a practical mix of private and open areas.

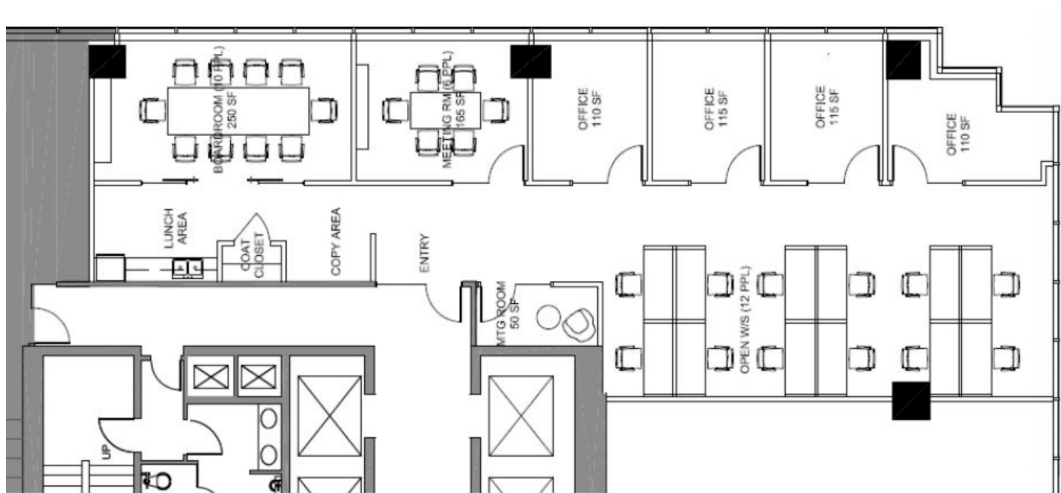

# Efficient, Move-In Ready Office

- Four private offices
- 6-person meeting room
- 10-person boardroom
- Breakout room and open work area for 12
- Kitchen and lunch area
- Dedicated copy and storage space
- Prominent elevator exposure
- Move-in ready condition
- Furniture potentially available



## LARGE BOARDROOM



## KITCHENETTE



## BUILDING AMENITIES

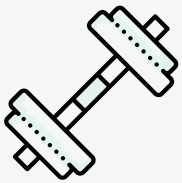

//  
Fitness facilities



//  
Shared tenant  
meeting room



//  
Showers & change  
rooms



//  
24-hour security



//  
Bike Storage



//  
Underground  
parking

# NEIGHBOURHOOD

Located in the vibrant downtown district, the building offers easy access to top dining, shopping, and entertainment options. With excellent public transportation links and nearby highways, commuting is convenient. Enjoy the dynamic city atmosphere and stunning mountain views, making this the perfect location for both work and leisure.

- |                             |                              |
|-----------------------------|------------------------------|
| 1. Joe Fortes               | 11. Breka Bakery & Cafe      |
| 2. Per Se Social Corner     | 12. Mott 32 Vancouver        |
| 3. 49th Parallel Cafe       | 13. Kobe Japanese Stakehouse |
| 4. Carlino Restaurant       | 14. JOEY Bentall One         |
| 5. Hello Nori               | 15. Notch8 Restaurant & Bar  |
| 6. Tableau Bar Bistro       | 16. Thierry Alberni          |
| 7. Black + Blue             | 17. Alouette Bistro          |
| 8. Coast                    | 18. Dahlia                   |
| 9. The Keg Steakhouse + Bar | 19. CF Pacific Centre        |
| 10. Cactus Club Cafe        | 20. Heritage Asian Eatery    |

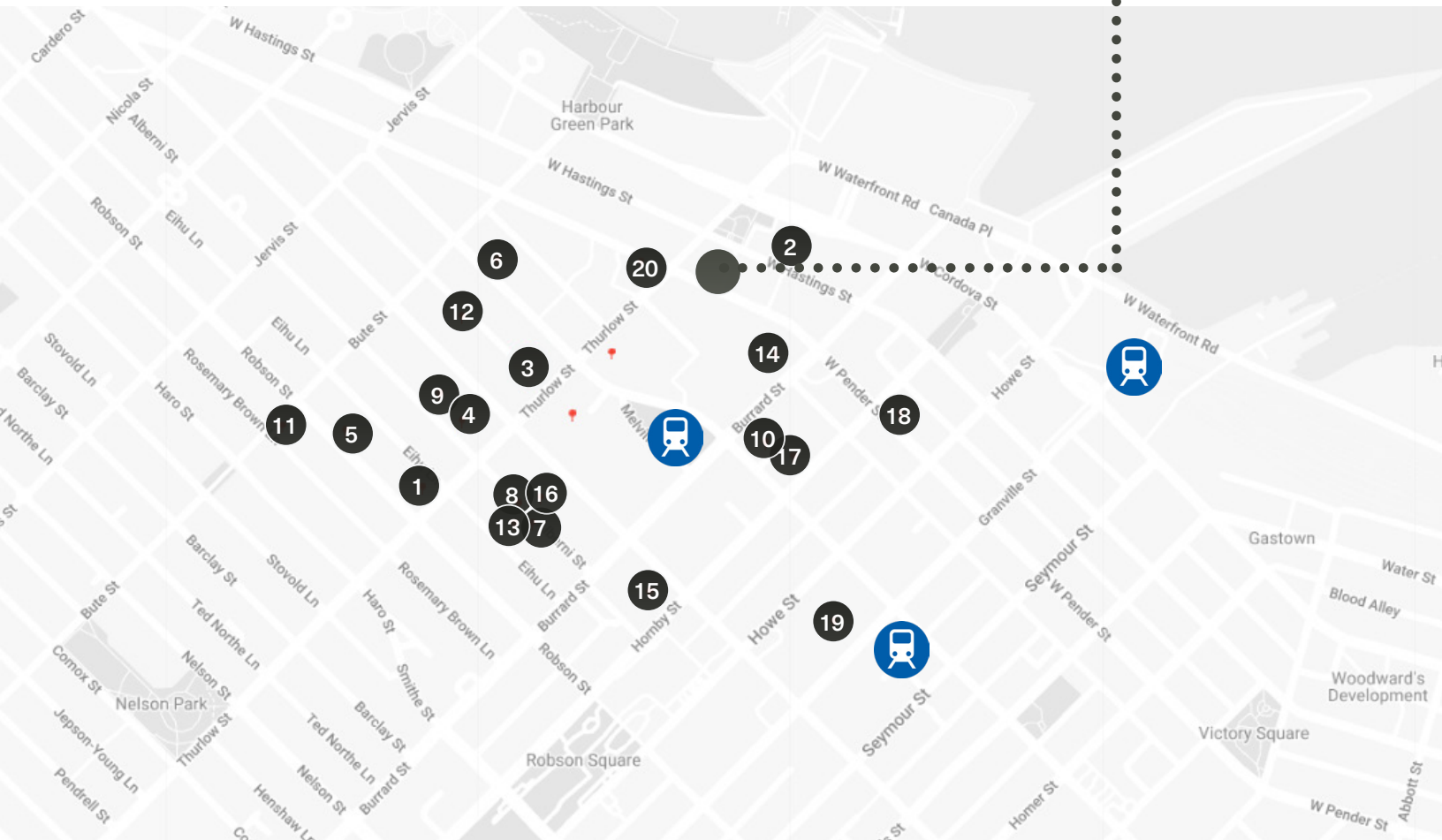



For more information, please contact:



Willow King

Personal Real Estate Corporation

**ASSOCIATE VICE PRESIDENT**

+1 604 210 2150

[willow@floorspace.ca](mailto:willow@floorspace.ca)

---

**FLOORSPACE**

Suite 520 - 900 West Hastings

Vancouver, BC Canada

V6E 1E5

[floorspace.ca](http://floorspace.ca)

This document has been prepared by Floorspace Commercial Inc. for advertising and general information only. All information contained herein is from sources we deem reliable, and we have no reason to doubt its accuracy; however, no guarantee or responsibility is assumed thereof, and it shall not form any part of future contracts. Property information is submitted subject to errors and omissions and all information should be carefully verified. Any interested party should undertake their own inquiries as to the accuracy of the information. All measurements quoted herein are approximate. This publication is the copyrighted property of Floorspace Commercial Inc. and/or its licensor(s). Copyright © 2026 Floorspace Commercial Inc.

