

The Crossing at Meadowood Square

Join the New Panera Bread, Trek Bicycles, Ski Pro, FedEx and Many More!

6407 S. Virginia Street, Reno, NV 89511
Space Available 3,200 SF ±



- Rare opportunity to locate at one of the busiest intersections in Reno
- Excellent Visibility and Signage at Signalized Intersection
- 46,500 ADT on Surface Roads
- 116,000 Average Daily Traffic Count Hwy 395/580



2020	10 Min	20 Min	30 Min
Population	100,453	421,641	550,882
Household	40,689	154,197	200,164
Average HH Income	\$83,699	\$83,985	\$85,121
Daytime Population	137,910	403,348	513,407

*Source ESRI



775.831.1100
 info@kcorporation.com
 TheCrossingReno.com

Watch a 2 minute informative video about The Crossing at <https://tinyurl.com/2pnhpxuw>

The Crossing at Meadowood Square

Locate across from Whole Foods and Home Depot at a very busy signalized intersection at the highway exit

6407 S. Virginia Street, Reno, NV 89511
Space Available 3,200 SF ±

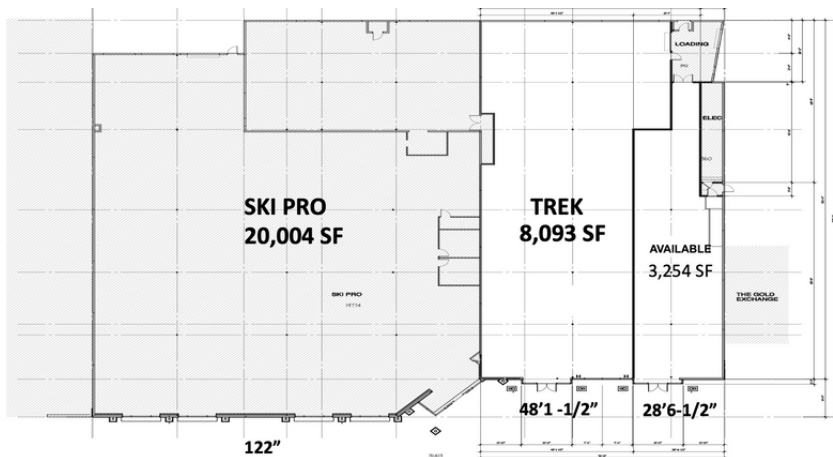
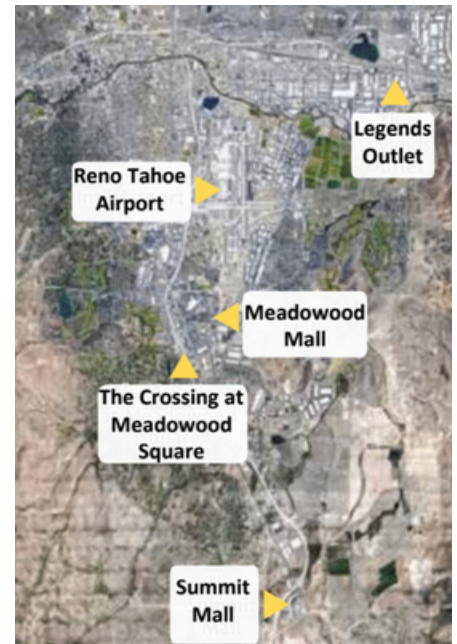

S. Virginia St. & Neil Road

- Centrally located in Reno's Meadowood Mall Submarket Retail hub close to Meadowood Mall, Northern Nevada's only Class A Simon Mall
- Prime 3,254 square foot space located next to the soon to open Trek Bicycle flagship store and in close proximity to the new Panera Bread Restaurant
- Landlord upgrading facade throughout the center



775.831.1100
 info@kcorporation.com
 TheCrossingReno.com

