

MISSION VIEJO COMMERCE PARK

23362 Madero, Suite K
Mission Viejo, CA

1,210 Square Feet

\$1.75 SF/MO

Triple Net

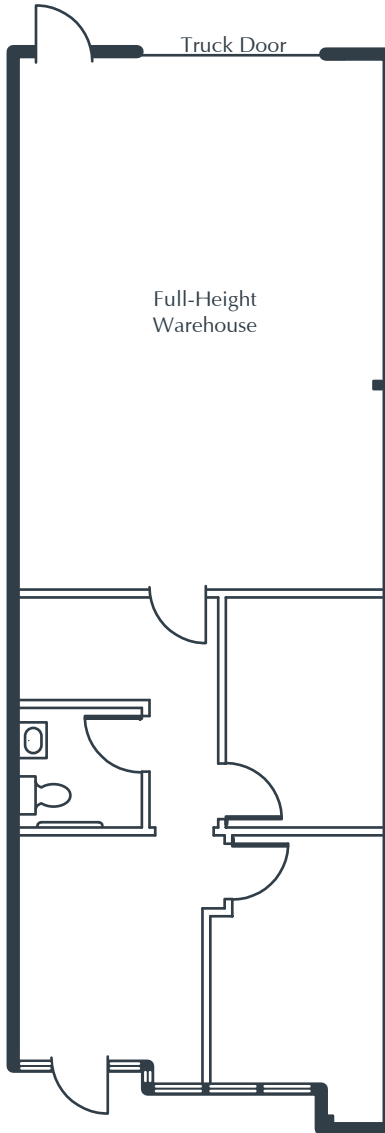

NOTES

Reception

Window Office

Interior Office

Restroom

Ground-Level Truck Door

Approximately 522 sq. ft. of Full-Height Warehouse

Part of a Professionally Managed Business Park

Created by Olen Commercial Realty Corp., 2022.
Information is not to be published or copied without
written approval. Square footage and floor plans are
estimates and should be separately verified. All rates,
terms, floor plans, and building facts are subject to
change without notice.

ea 07.01.2026

ELLYSSA DERRY

Senior Leasing Director

949.719.7204

ederry@olen.com



Seven Corporate Plaza

Newport Beach, CA

949.644.6536

www.olen.com