

**FOR  
LEASE**

**RETAIL FOR LEASE**

**1740 E. MEATS AVE., ORANGE, CA 92865**



## THE OPPORTUNITY

Availability: ± 562 RSF

Asking Rate: Negotiable

- Features:
- Move-in ready
  - Brand new improvements
  - Pylon & building signage
  - Large open space
  - (1) ADA Restroom

Traffic ± 15,000 Average CPD

Counts: • Convenient freeway access - 55, 91, 5, 22

Location: NNN = \$0.67/sf



**CHANTEL AGUILAR**  
SENIOR VICE PRESIDENT  
(562) 447-0665  
[CHANTEL@ASHWILLASSOCIATES.COM](mailto:CHANTEL@ASHWILLASSOCIATES.COM)  
CORP DRE#01291393/LIC.#01972085

**Ashwill  
Associates**  
COMMERCIAL REAL ESTATE

**FOR  
LEASE**

# RETAIL FOR LEASE

1740 E. MEATS AVE., ORANGE, CA 92865



INTERIOR VIEWS



CHANTEL AGUILAR  
SENIOR VICE PRESIDENT  
(562) 447-0665  
CHANTEL@ASHWILLASSOCIATES.COM  
CORP DRE#01291393/LIC.#01972085

**Ashwill  
Associates**  
COMMERCIAL REAL ESTATE

**FOR  
LEASE**

# FLOOR PLAN

1740 E. MEATS AVE., ORANGE, CA 92865

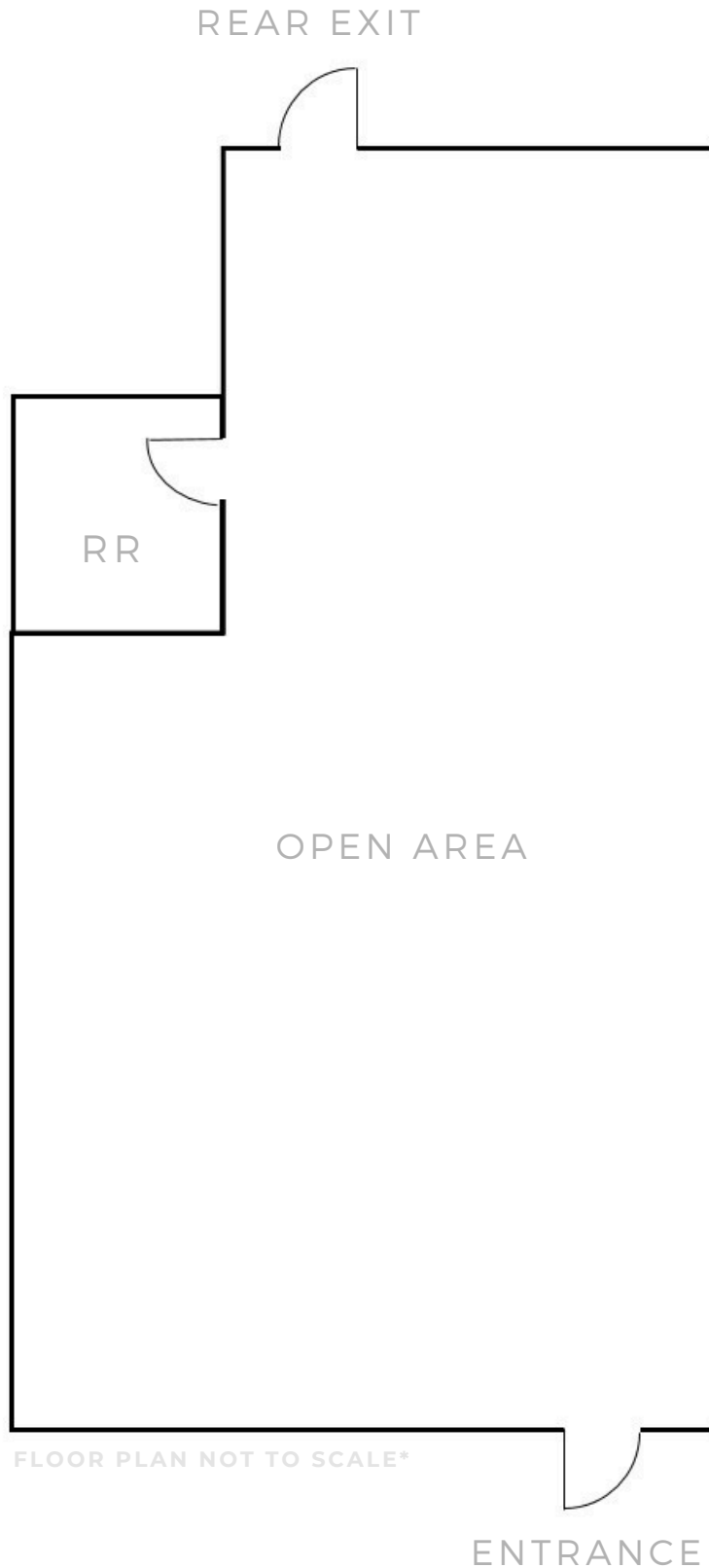

CHANTEL AGUILAR  
SENIOR VICE PRESIDENT  
(562) 447-0665  
[CHANTEL@ASHWILLASSOCIATES.COM](mailto:CHANTEL@ASHWILLASSOCIATES.COM)  
CORP DRE#01291393/LIC.#01972085

**Ashwill  
Associates**  
COMMERCIAL REAL ESTATE

**FOR  
LEASE**

# TRAFFIC COUNTS

1740 E. MEATS AVE., ORANGE, CA 92865

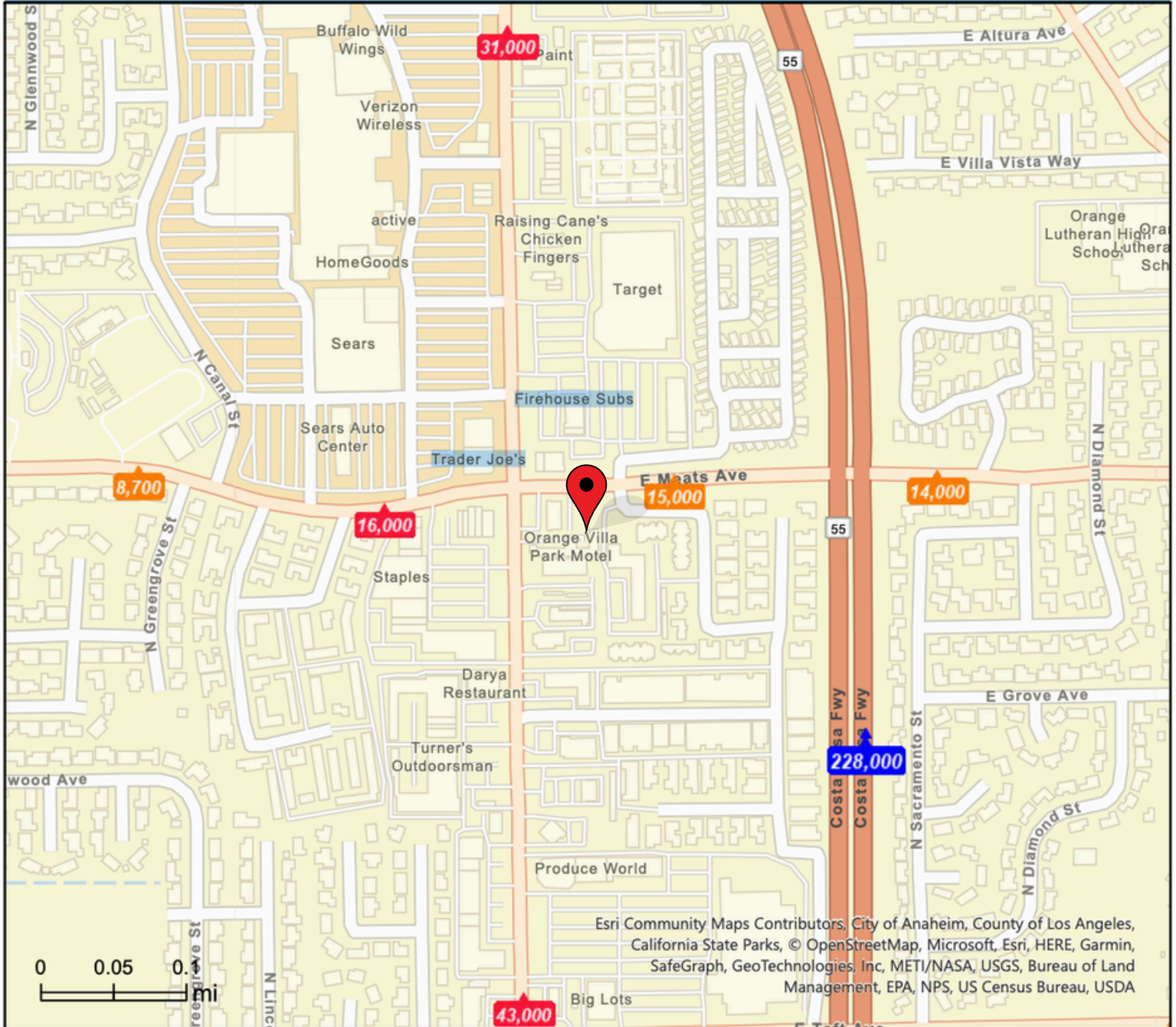

CHANTEL AGUILAR  
SENIOR VICE PRESIDENT  
(562) 447-0665  
[CHANTEL@ASHWILLASSOCIATES.COM](mailto:CHANTEL@ASHWILLASSOCIATES.COM)  
CORP DRE#01291393/LIC.#01972085

**Ashwill  
Associates**  
COMMERCIAL REAL ESTATE