

1231 SHIELDS ROAD  
KERNERSVILLE, NC 27284



1231 SHIELDS ROAD  
SUITE 04

14,946 SF

AVAILABLE: IMMEDIATELY

34% OFFICE

CLEAR HEIGHT: 17'

REAR LOAD  
2 DOCK HIGH  
1 RAMP

POWER: 200 AMPS

SPRINKLERS: YES



JASON SCHNITTGER  
210.836.6633  
JSCHNITTGER@STREAMREALTY.COM

PARKER BYRD  
336.344.8067  
PARKER.BYRD@STREAMREALTY.COM





**JASON SCHNITTGER**  
210.836.6633  
JSCHNITTGER@STREAMREALTY.COM

**PARKER BYRD**  
336.344.8067  
PARKER.BYRD@STREAMREALTY.COM



SUITE 04

14,946 RSF

AVAILABLE: IMMEDIATELY

± 34.0% OFFICE

CLEAR HEIGHT: 17'

REAR LOAD  
2 DOCK HIGH  
1 RAMP

POWER: 200 AMPS

SPRINKLERS: YES

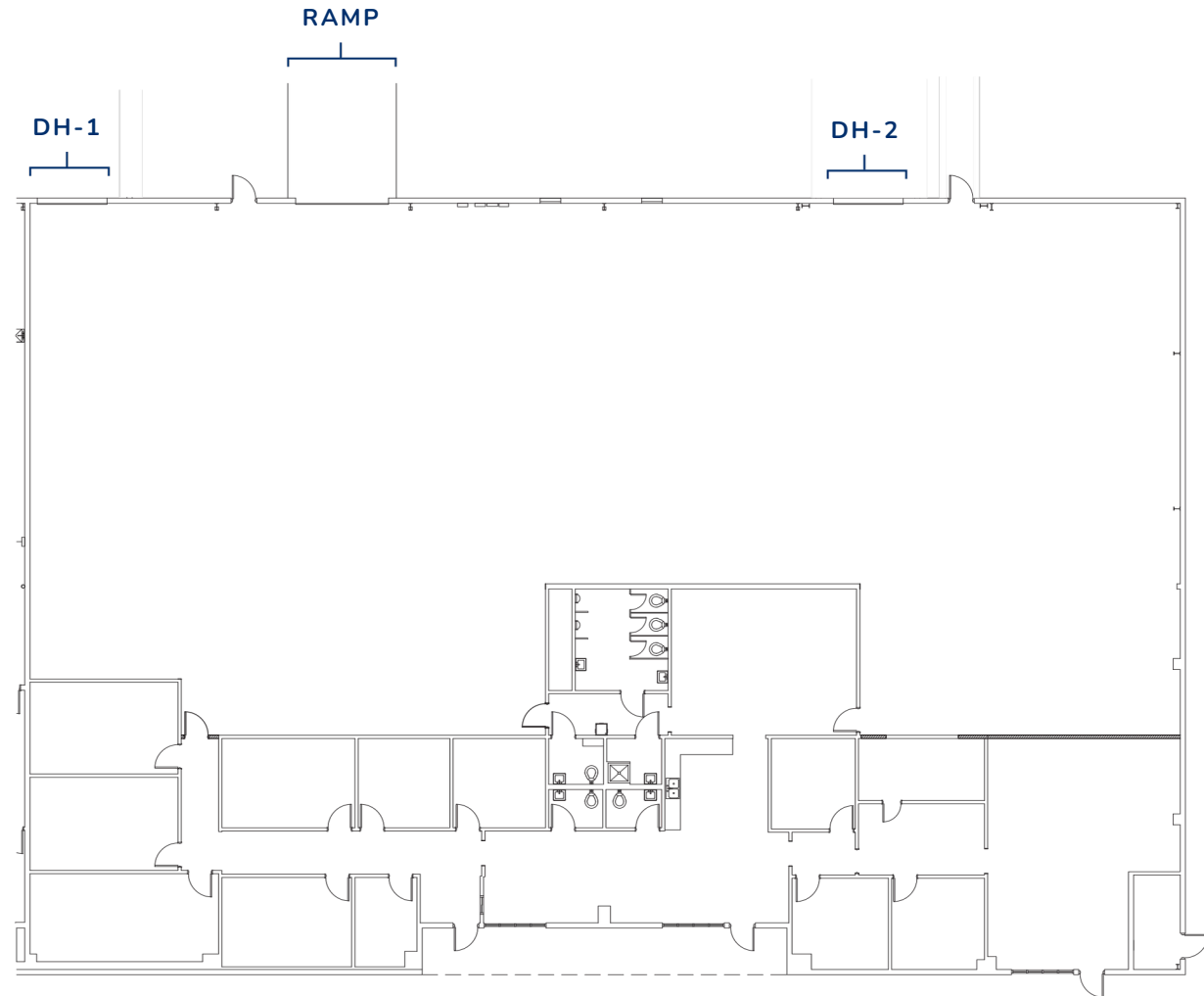



**JASON SCHNITTGER**  
210.836.6633  
JSCHNITTGER@STREAMREALTY.COM

**PARKER BYRD**  
336.344.8067  
PARKER.BYRD@STREAMREALTY.COM





# Proximity Map

24 MILES  
Greensboro

5 MILES  
Winston-Salem

82 MILES  
Charlotte

