

INLAND WETLANDS SUBMISSION SUBDIVISION

OF

441 OPENING HILL ROAD TO LOTS 1-6

PROPOSED SIX LOT RESIDENTIAL SUBDIVISION

441 OPENING HILL ROAD • MADISON, CONNECTICUT

OCTOBER 31, 2025

APPLICANT:

THOMAS W. & RICHARD A. GERE

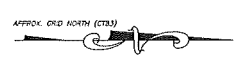
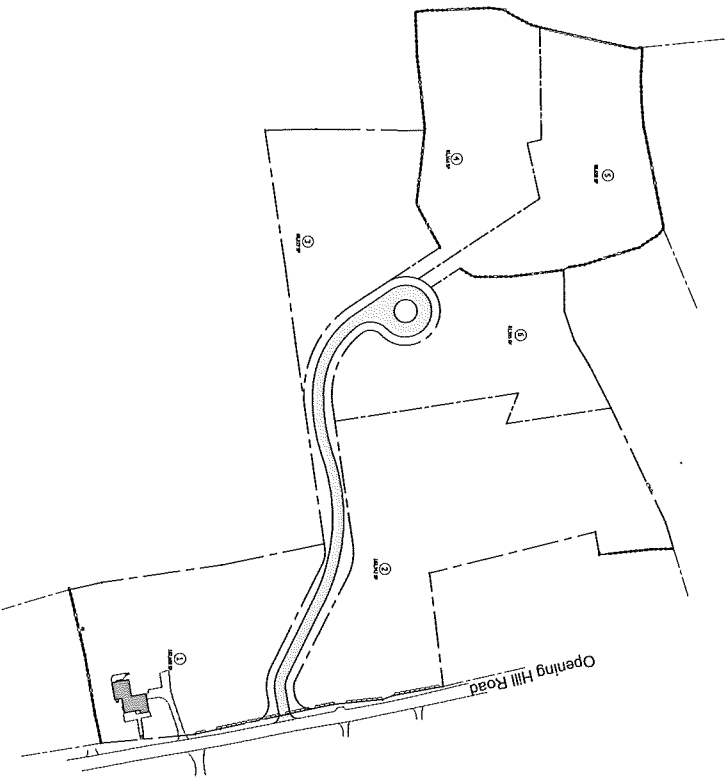

441 Opening Hill Road
Madison, Connecticut

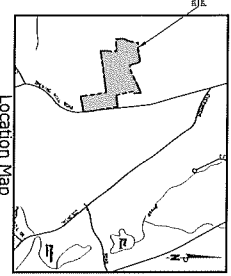

SHEET INDEX	
SHEET NO.	SHEET TITLE
1 OF 11	COVER SHEET
2 OF 11	EXISTING CONDITIONS PLAN
3 OF 11	RECORD RE-SUBDIVISION PLAN
4 OF 11	SITE PLAN
5 OF 11	OVERALL CONSTRUCTION PLAN
6 OF 11	EROSION & SEDIMENT CONTROL PLAN
7 OF 11	EROSION & SEDIMENT CONTROL - DETAIL SHEET
8 OF 11	DATA SHEET - TEST PIT DATA
9 OF 11	ROADWAY PLAN & PROFILE
10 OF 11	DETAILS SHEET
11 OF 11	SEPTIC DETAILS SHEET

Subject Parcel Information

OWNER: THOMAS W & RICHARD A GERE
 OWNER ADDRESS: 40 NORTH CHALSWORTH AVE
 MAILING ADDRESS: CHALSWORTH, NY 10516
 TITLE: UNDIVIDED INTEREST
 FIELD: UNDIVIDED INTEREST
 FLOOD ZONE: FLOOD ZONE X (FLOOD HAZARD # 3000/CH01)
 ZONING DISTRICT: S1A
 ZONING DISTRICT: S1A

Legend

	WETLAND
	SHRUBLAND
	FOREST
	WATER
	ROAD
	BUILDING
	UTILITY
	EROSION CONTROL
	SEDIMENT CONTROL
	DATA SHEET
	ROADWAY
	DETAILS SHEET
	SEPTIC

Cover Sheet
 Of
 441 Opening Hill Road
 Madison, Connecticut
 Prepared For:
 Rick & Tom Gere
 October 31, 2025

DRAWING SCALE: 1" = 100'

David L. Fedus, P.E.
 200 Mt. Pleasant Road, Suite 200
 Cheshire, CT 06110

FEDUS ENGINEERING, LLC
 National Address: 70 Lake Street North, Cheshire, CT 06115
 Office: (860) 252-7700 Fax: (860) 254-1644
 SHEET NO. 1 of 11 JOB NO. 2025-01 DRAWN BY: CFC

