

**Property Location:**

65 Henry Law Av

**Commercial Property Record Card - Dover, New Hampshire**

**Parcel ID:** 20026-000000

**Map Block No.** 20-26-0-0

**Class:** C

**Use:**

303

**Card 1 of 1**

Current Owner
Shaw Robert B F Jr 31 George St Dover Nh 03820

Previous Owner History		
Name	Deed	Date
Shaw Robert B	1164/93	

Miscellaneous	
<b>Deed Info:</b>	3828/1-04/21/2010
<b>Zoning:</b>	CBD-G
<b>Neighborhood:</b>	303
<b>Units:</b>	3
<b>Street/Road:</b>	Public

Assessment Information	
<b>Assessed Value:</b>	*
<b>Inc:</b>	578,000 <b>Prior</b>
<b>Land:</b>	113,600 113,600
<b>Bldg:</b>	430,400 430,400
<b>Total:</b>	544,000 544,000
<b>Assessed Information:</b>	
<b>Value:</b>	544,000
<b>Effective DOV:</b>	4/1/2025
<b>Value Flag:</b>	COST VALUE

Notes
River Bend Variety Estimate 3 Apts Up

Entrance Information					
Date	Time	ID	Actv	Entrance Code	Source
10/07/1991		NP		Entry Gained	
01/20/2006	C	TC		Est-See Note	Other
03/07/2024	CFR	RD		Ext. Insp.	

Sales History				
Book/Page	Date	Price	Type	Validity
3828/1 1164/93	04/15/2010		2	38

Permit Information				
Date	Permit #	Price	Purpose	% Comp.
09/15/2005	5-421	2,700	Add Wdk	100 0

Land Information				
Type	Size	Grade	Influence Factor 1, 2 and %	Value
Primary	A	0.07	0	113,590
Residual	A	0	0	
<b>Total Acres for this Parcel</b>		0.07	<b>Total Land Value</b>	113,600



Inspection witness by: \_\_\_\_\_

**Property Location:**

65 Henry Law Av

**Commercial Property Record Card - Dover, New Hampshire**

Parcel ID: 20026-000000

Map Block No. 20-26-0-0

Class: C

Use:

303

Card 1 of 1

Exterior/Interior Information																
Sec	Levels	Size	Perimeter	Use Type	Height	Exterior Walls	Construction Type	Finish	Partitions	Heating	A/C	Plumbing	Physical Condition	Functional Utility	%Good Override	Unadjusted RCNLD
1	B1-B	1x1680	200	Multi-Use Storage	8	Frame	Wood Joist	100	Normal			Normal	Normal	Fair	0%	75,690
1	01-01	1x903	113	Restaurant	8	Frame	Wood Joist	100	Normal	Hot Air	Central	Normal	Normal	Normal	0%	121,740
1	01-01	1x777	106	Apartment	8	Frame	Wood Joist	100	Normal	Hot Air		Normal	Normal	Normal	0%	69,700
1	02-02	1x1408	184	Apartment	8	Frame	Wood Joist	100	Normal	Hot Air		Normal	Normal	Normal	0%	117,440
1	A1-A	1x777	116	Multi-Use Storage	7	Frame	Wood Joist	100	Normal			Normal	Normal	Fair	0%	13,950
0	-	0x0	0		0			0							0%	0
0	-	0x0	0		0			0							0%	0
0	-	0x0	0		0			0							0%	0

Building Information	
<b>Building No:</b>	1
<b>Year Built:</b>	1875
<b>No of Units:</b>	1
<b>Structure Type:</b>	Mixed Res/Comm
<b>Grade:</b>	C+
<b>Identical Units:</b>	1
<b>Efficiencies:</b>	0
<b>1 Bedroom Apts:</b>	3
<b>2 Bedroom Apts:</b>	0
<b>3 Bedroom Apts:</b>	0
<b>Covered Park:</b>	0
<b>Uncovered Park:</b>	0
<b>Notes:</b>	3338 Sf Gla

Building Summary	
<b>Total Unadjusted RCN:</b>	694,060
<b>Average Percent Good:</b>	.57
<b>Total Unadj. RCNLD:</b>	398,520
<b>Grade Factor:</b>	1.08
<b>No of Identical Units:</b>	1
<b>Economic Cond Factor:</b>	1.00
<b>RCNLD:</b>	430,400
Income Approach Summary	
<b>Net Rentable Area:</b>	5,157

Out Building Information									
StructureCode	+/-	Width	Lgth/ SqFt	Ident. Units	Gr	Physical Condition	Functional Utility	Percent Good	RCNLD
		0	0	0				0 0%	0
		0	0	0				0 0%	0
		0	0	0				0 0%	0
		0	0	0				0 0%	0
		0	0	0				0 0%	0
		0	0	0				0 0%	0

Other Improvements		
Description	+/-	RCNLD
		0

Building Other Information					
Line	StructureCode	+/-	Measure 1	Measure 2	IdenticalUnits
2	Cooler Chiller		10	1	8
2	Wood Deck		27	1	10
4	Wood Deck		12	1	8
0			0	0	0
0			0	0	0
0			0	0	0
0			0	0	0
0			0	0	0
0			0	0	0
Total Other Features					14,250

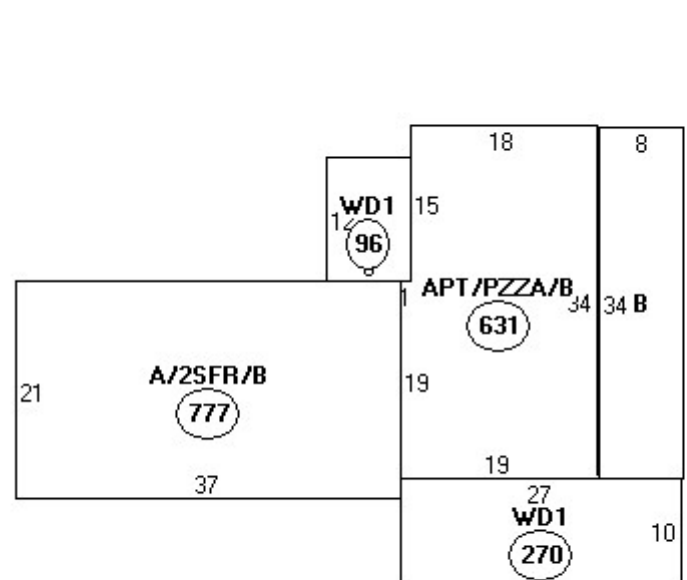

- Descriptor/Area
- A: APT/PZZA/B  
631 sqft
  - B: PIZZA/B  
272 sqft
  - C: WD1  
270 sqft
  - D: A/2SFR/B  
777 sqft
  - E: WD1  
96 sqft