

# ±19,842 SF OF RETAIL SPACES AVAILABLE

200 MESNAGER ST | LOS ANGELES, CA 90012

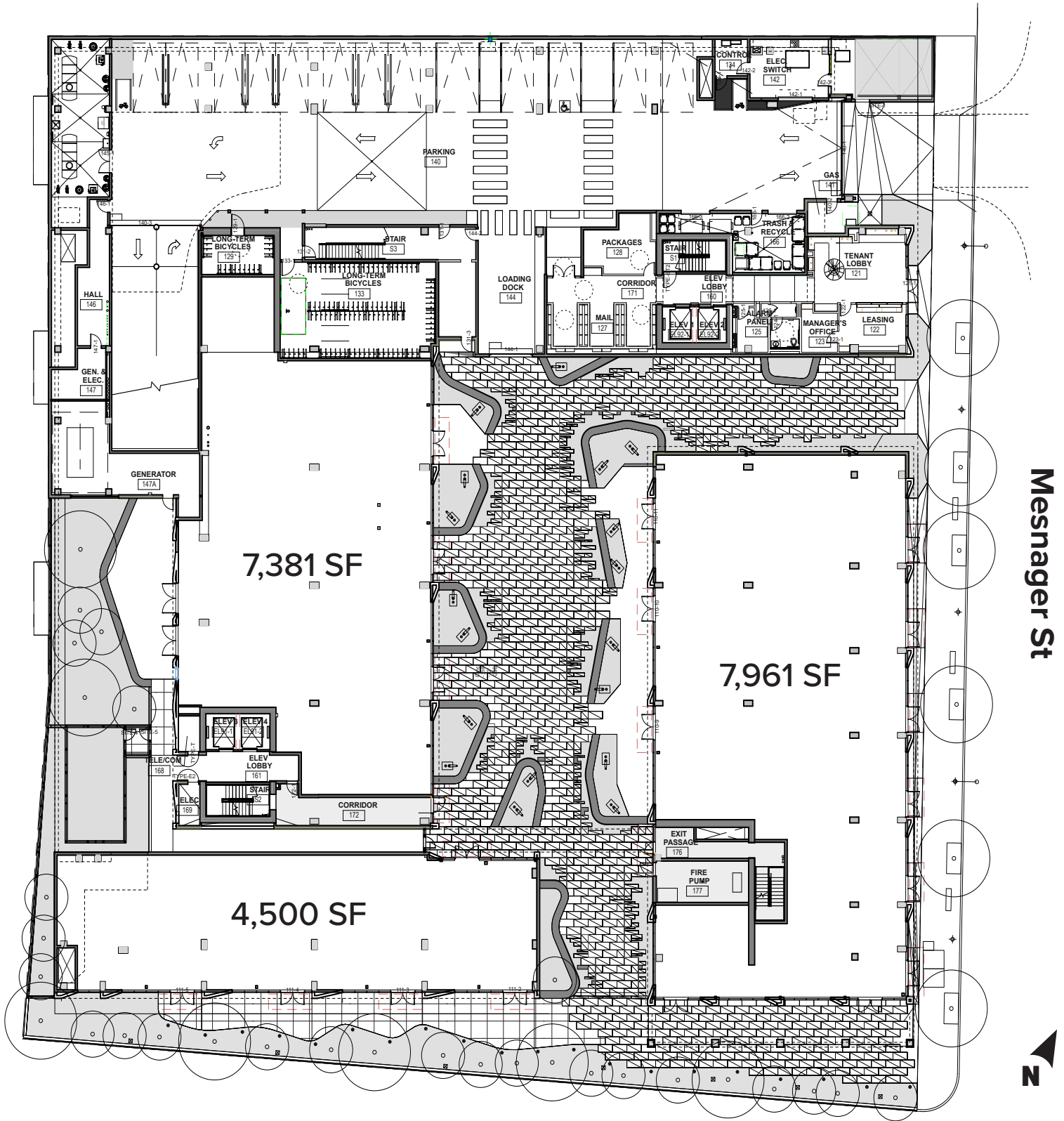

Mesnager St



NOTE: Drawing not to scale. All measurements and sizes are approximate. Lessee to Verify

FOR MORE INFORMATION, PLEASE CONTACT

**EVAN JURGENSEN**

Senior Vice President | LIC NO 01967347

e [ejurgensen@lee-associates.com](mailto:ejurgensen@lee-associates.com)  
o 323.922.3733

**JACK R. CLINE, JR.**

President | LIC NO 00854279

e [jcline@lee-associates.com](mailto:jcline@lee-associates.com)  
c 213.590.3512



Lee & Associates® Los Angeles, Inc.  
CORP ID 02174865

1201 North Main Street,  
Los Angeles, California 90012



[LEE-ASSOCIATES.COM/DOWNTOWNLA](http://LEE-ASSOCIATES.COM/DOWNTOWNLA)

The information supplied herein is deemed to be reliable, however, it is provided without any representations, warranty or guarantee, expressed or implied. Buyer/Tenant to verify all and to conduct independent investigation and verification of all material information, including, but not limited to environmental, survey, and zoning. Consult your attorney, accountant, or other professional advisor.