



# CUSTOM SPEC SUITES AVAILABLE FOR LEASE

UNDER NEW OWNERSHIP & MANAGEMENT BY  
TOP HEALTHCARE REAL ESTATE OWNER

**1800 & 1900 Hollister Drive**  
Libertyville, Illinois 60048

One Oakbrook Terrace  
Suite 400  
Oakbrook Terrace, Illinois 60181  
+1 630 932 1234

[hiffman.com](http://hiffman.com)

## PROPERTY HIGHLIGHTS

Two building Medical Office Campus with Class A Space available for lease. Located within close proximity to Advocate Condell Medical Center and top retail destinations, such as Hawthorn Mall and Mellody Farm.



COMPLETELY NEW  
RENOVATED COMMON  
AREAS & TENANT  
AMENITIES



SYNERGISTIC MIX OF MEDICAL  
CO-TENANTS PRIMARY CARE,  
NEUROLOGY, PULMONOLOGY, ENT,  
OPHTHALMOLOGY, PEDIATRICS

## Contact

Sarah Walker  
+1 630 389 8911  
[swalker@hiffman.com](mailto:swalker@hiffman.com)

Jason Wurtz  
+1 630 693 0692  
[jwurtz@hiffman.com](mailto:jwurtz@hiffman.com)



COVERED PARKING



UNDER NEW OWNERSHIP  
& MANAGEMENT



CLOSE PROXIMITY TO  
ADVOCATE CONDELL  
MEDICAL CENTER



OFFICE VIEWS OF  
FOREST PRESERVE &  
WALKING TRAILS

NO WARRANTY OR REPRESENTATION, EXPRESS OR IMPLIED, IS MADE AS TO THE ACCURACY OF THE INFORMATION CONTAINED HEREIN, AND THE SAME IS SUBMITTED SUBJECT TO ERRORS, OMISSIONS, CHANGE OF PRICE, RENTAL OR OTHER CONDITIONS, PRIOR SALE, LEASE OR FINANCING, OR WITHDRAWAL WITHOUT NOTICE, AND OF ANY SPECIAL LISTING CONDITIONS IMPOSED BY OUR PRINCIPALS NO WARRANTIES OR REPRESENTATIONS ARE MADE AS TO THE CONDITION OF THE PROPERTY OR ANY HAZARDS CONTAINED THEREIN ARE ANY TO BE IMPLIED.

# 1800 HOLLISTER



## SPACE AVAILABLE

### GROUND FLOOR

Suite G10 1,788 - 4,982 SF

Suite G18 3,194 - 4,982 SF

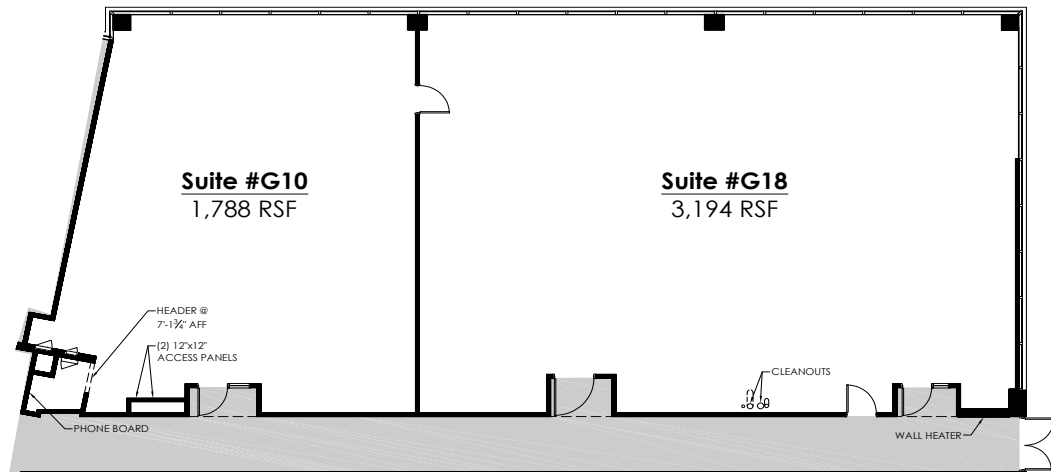

# 1900 HOLLISTER

## AVAILABLE SUITES

Suite 120	1,429 SF
Suite 330 - Suite 350	2,618 - 5,815 SF
Suite 380	2,048 SF
Suite 390	3,197 - 5,815 SF

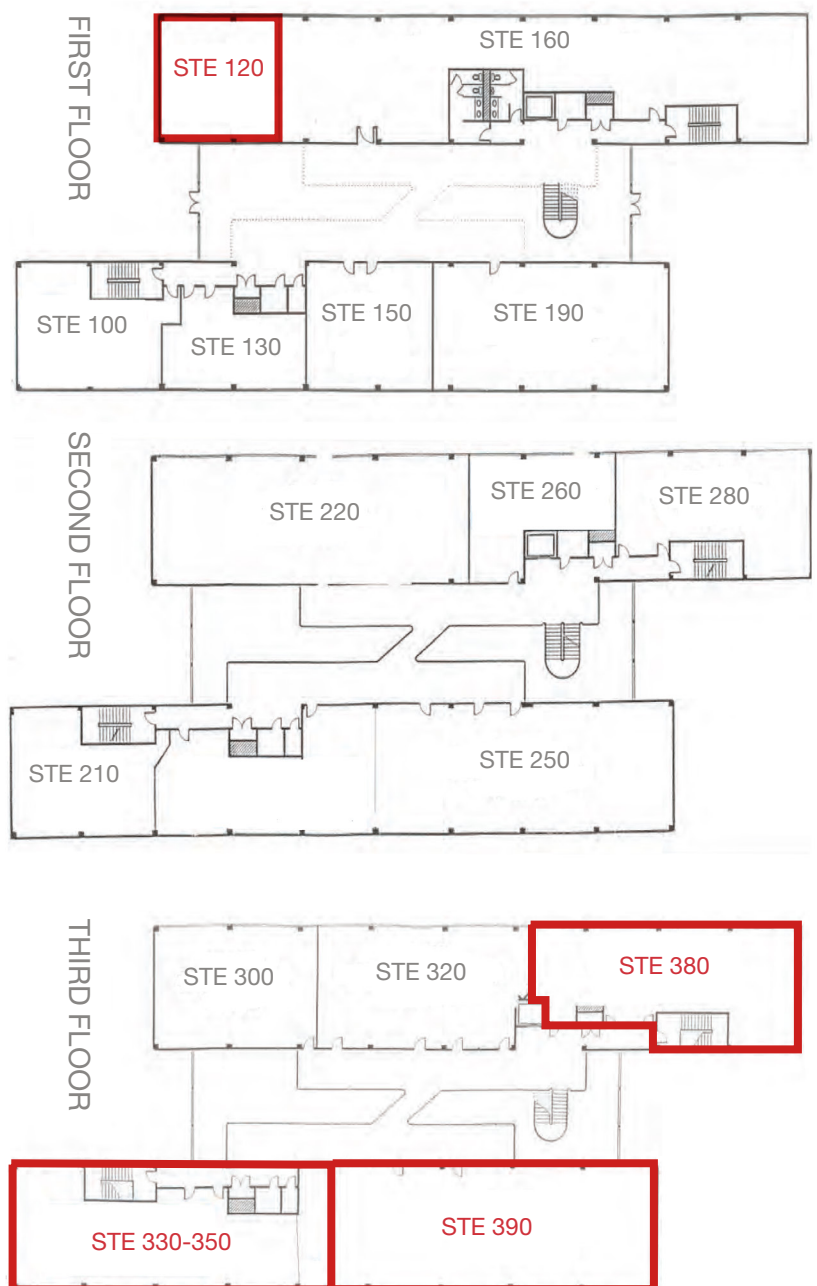



## Contact

Sarah Walker  
 +1 630 389 8911  
 swalker@hiffman.com

Jason Wurtz  
 +1 630 693 0692  
 jwurtz@hiffman.com

**NAI**Hiffman

One Oakbrook Terrace  
 Suite 400  
 Oakbrook Terrace, Illinois 60181  
 +1 630 932 1234

[hiffman.com](http://hiffman.com)