

# For Sale or Lease

Industrial / Flex



2205 HASKELL STREET  
LAWRENCE, KS, 66046



This food-grade production facility is available for sale or lease. Conveniently situated just north of 23rd and Haskell, it offers quick access to K-10 Highway. The property features 3-phase power / 200-amp electrical service, a dock door, secure access, dedicated office space, and employee parking.

## PROPERTY DETAILS

- Year Built: 1951 / 2013 • Zoning: IG
- Lot Size: 30,749 SF
- Building Size: 7,788 SF
- Available Space: 7,788 SF
- Sale Price: \$895,000
- Lease Rate: \$8/SF, NNN (\$5,192/month)



✉ [kirsten@foundationscommercial.com](mailto:kirsten@foundationscommercial.com)

**Kirsten Flory** ☎ **785-766-6568**

✉ [ryan@foundationscommercial.com](mailto:ryan@foundationscommercial.com)

**Ryan Rains** ☎ **606-344-2658**

This document has been prepared by Foundations Commercial for advertising and general information only. Foundations Commercial makes no guarantees, representations, or warranties of any kind, expressed or implied, regarding the information including, but not limited to, warranties of content, accuracy and reliability. Any interested party should undertake their own inquiries as to the accuracy of the information. Foundations Commercial excludes unequivocally all inferred or implied terms, conditions and warranties arising out of this document and excludes all liability for loss and damages arising there from. This communication is not intended to cause or induce of any existing listing agreement.

# For Sale or Lease

Industrial / Flex



2205 HASKELL STREET  
LAWRENCE, KS, 66046



## AREA DEMOGRAPHICS

CATEGORY	3 miles	5 miles	10 miles	CATEGORY	3 miles	5 miles	10 miles
2020 Population	54,250	88,231	110,770	Median Age	29.7	32	33.1
2024 Population	57,277	91,304	114,965	Average Household Income	\$69,423	\$82,644	\$89,175
2029 Population Projection	58,968	93,624	117,965	Median Home Value	\$238,601	\$277,819	\$300,367
Annual Growth 2024-2029	0.6%	0.5%	0.5%	Consumer Spending	\$584M	\$1.1B	\$1.4B

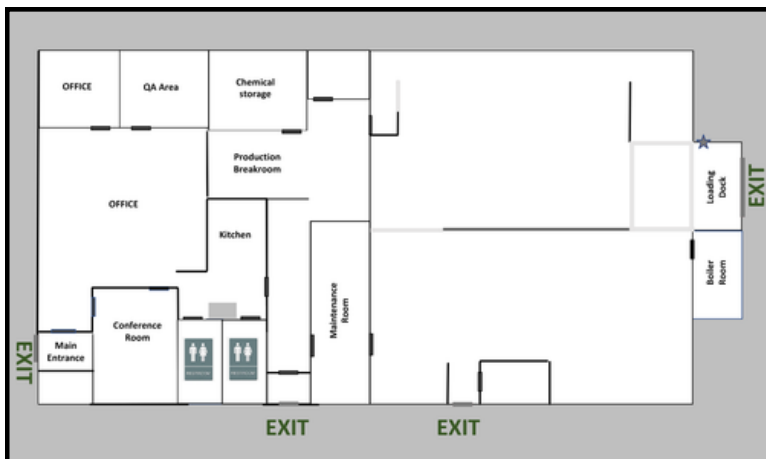

✉ [kirsten@foundationscommercial.com](mailto:kirsten@foundationscommercial.com)

**Kirsten Flory** 📞 785-766-6568

✉ [ryan@foundationscommercial.com](mailto:ryan@foundationscommercial.com)

**Ryan Rains** 📞 606-344-2658

This document has been prepared by Foundations Commercial for advertising and general information only. Foundations Commercial makes no guarantees, representations, or warranties of any kind, expressed or implied, regarding the information including, but not limited to, warranties of content, accuracy and reliability. Any interested party should undertake their own inquiries as to the accuracy of the information. Foundations Commercial excludes unequivocally all inferred or implied terms, conditions and warranties arising out of this document and excludes all liability for loss and damages arising there from. This communication is not intended to cause or induce of any existing listing agreement.

# For Sale or Lease

Industrial / Flex



2205 HASKELL STREET  
LAWRENCE, KS, 66046



2205 Haskell St.

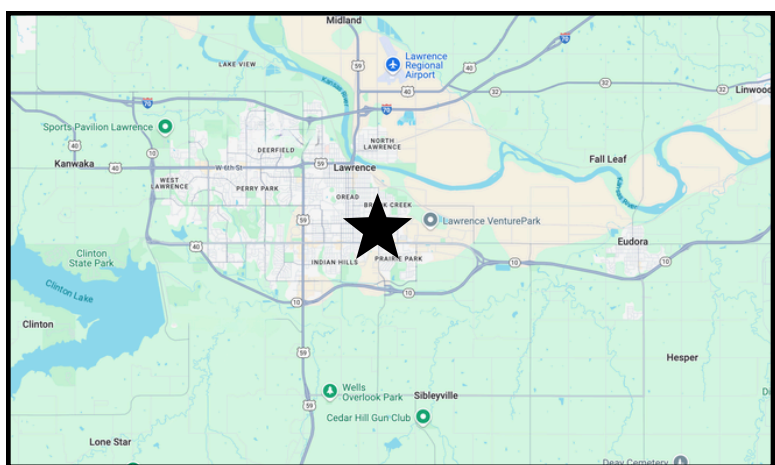

✉ [kirsten@foundationscommercial.com](mailto:kirsten@foundationscommercial.com)

✉ [ryan@foundationscommercial.com](mailto:ryan@foundationscommercial.com)

**Kirsten Flory** ☎ **785-766-6568**

**Ryan Rains** ☎ **606-344-2658**

This document has been prepared by Foundations Commercial for advertising and general information only. Foundations Commercial makes no guarantees, representations, or warranties of any kind, expressed or implied, regarding the information including, but not limited to, warranties of content, accuracy and reliability. Any interested party should undertake their own inquiries as to the accuracy of the information. Foundations Commercial excludes unequivocally all inferred or implied terms, conditions and warranties arising out of this document and excludes all liability for loss and damages arising there from. This communication is not intended to cause or induce of any existing listing agreement.