

1664 Ashley Avenue

Larchwood, IA 51241

Lease Rate	\$10.00/SF GROSS PLUS UTILITIES
Building SF	6,566 SF

PROPERTY HIGHLIGHTS

- Food production facility for lease
- Walk in cooler and freezer space
- Commercial kitchen
- Access to adjacent dock for loading and unloading
- West lot included in rent
- Well suited for food production or distribution
- Existing equipment available for use
- Trash provided by Landlord

LOCATION DESCRIPTION

The property sits north of 170th Street on the east side of Ashley Avenue, approximately 8 miles southwest of downtown Larchwood and about 15 miles southeast of Sioux Falls, South Dakota.



TROY FAWCETT, CCIM, SIOR
Partner, Principal Broker
tfawcett@naisiouxfalls.com
605.321.2199



SAM FAWCETT
Broker Associate
sfawcett@naisiouxfalls.com
605.321.2191

2500 W. 49th St. Suite 100
Sioux Falls, SD 57105
605.357.7100
naisiouxfalls.com

PHOTOS

1664 ASHLEY AVENUE
Larchwood, IA 51241

FOR LEASE
Industrial Property



FLOOR PLAN

1664 ASHLEY AVENUE
Larchwood, IA 51241

FOR LEASE

Industrial Property



PARCEL

1664 ASHLEY AVENUE
Larchwood, IA 51241

FOR LEASE

Industrial Property



LOCATION MAP

1664 ASHLEY AVENUE
Larchwood, IA 51241

FOR LEASE

Industrial Property

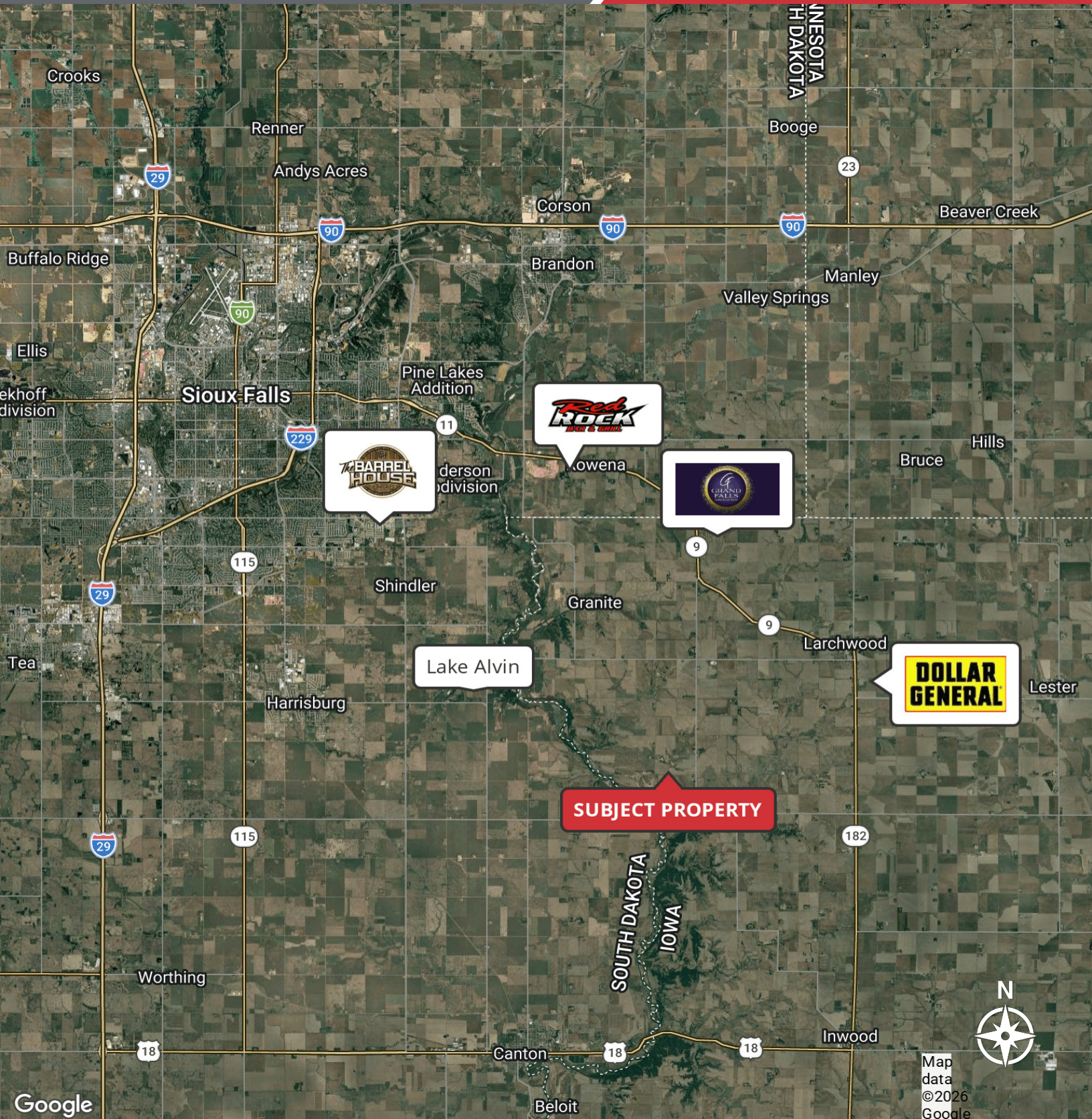

Map data
©2026
Google

