

FOR LEASE

6850 NEW KAPITTEL
SHAFTER, CA

FOR LEASE

6850 NEW KAPITTEL CT.

- Exceptional visibility from Highway 99, located off the Hwy 99 and Lerdo Highway interchange
- State-of-the-art concrete tilt-up building built in 2016

PROPERTY FEATURES

Total Available:	±75,656 SF
Office:	±6,215 SF
Lot Size:	±4.7 Acres*
Clear Height:	28'
Loading:	(9) 9' x 10' Dock Doors (2) 14' x 14' Grade-Level Doors
Power:	400Amps, 120/208V, 3Ph, 4W
APN:	091-300-11-00-3
Zoning:	Industrial Airport Approach City of Shafter
Asking Rent:	85¢ psf/month, NNN



*Additional 4.05 Net Acres available for lease

FOR LEASE

6850 NEW KAPITTEL CT.



FLOOR PLAN

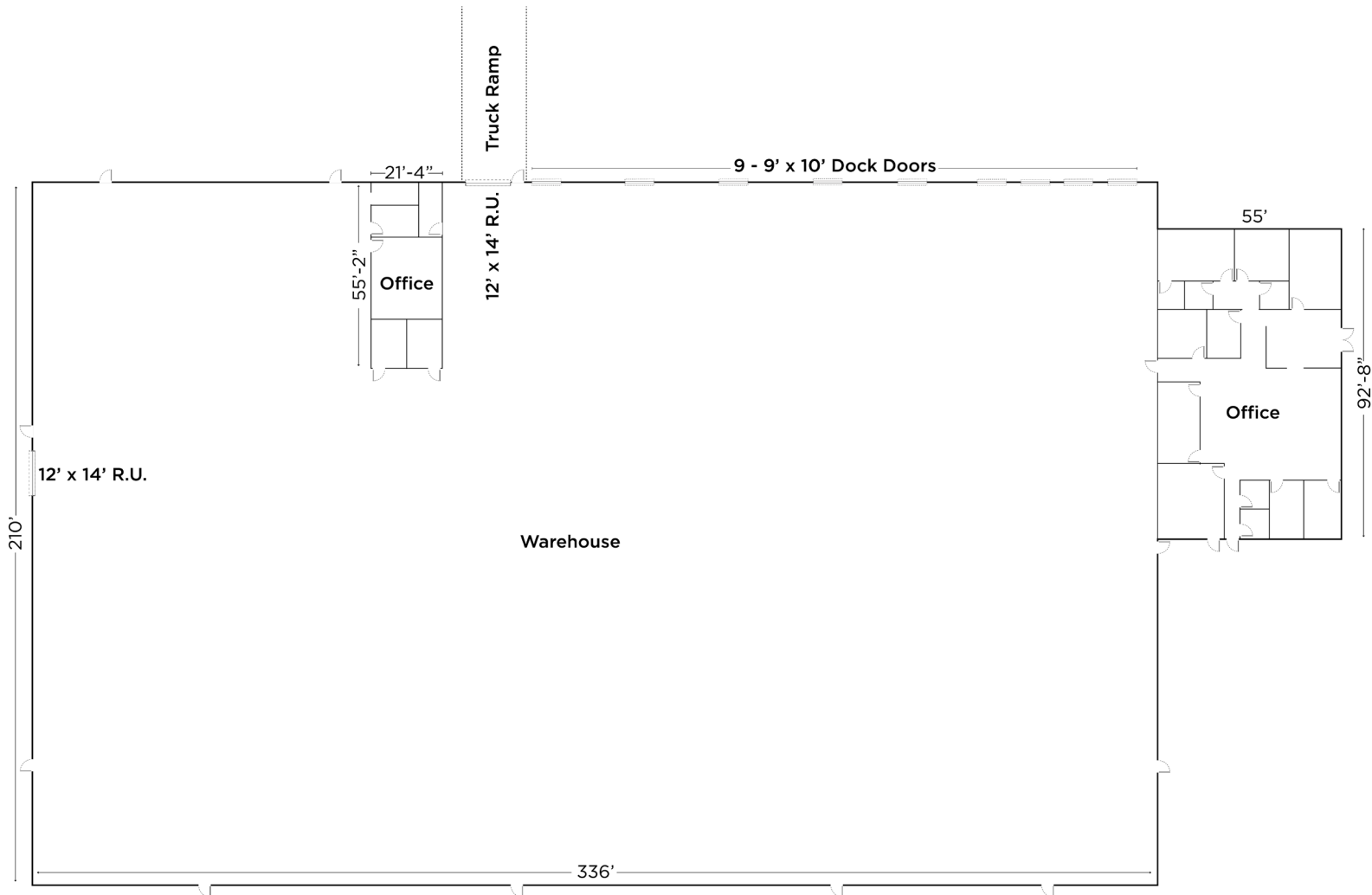

FOR LEASE

6850 NEW KAPITTEL CT.



AERIAL



Leased to
Custom Truck One Source

±4.05 Net Acres
*Additional Land Available
For Lease*

FOR LEASE

6850 NEW KAPITTEL CT.



LOCATION MAP





Light's Camera Action Cinema

For more information, please contact:

Wayne Kress, SIOR

Executive Director
wayne.kress@cushwake.com
+1 661 706 5692
Lic. #00834680

Coby Vance

Senior Director
coby.vance@cushwake.com
+1 661 203 4400
Lic. #01449929

Scott Reynolds

Director
scott.reynolds@cushwake.com
+1 661 330 7616
Lic. #01382493

5060 California Ave., Suite 1000
Bakersfield, CA 93309
PH: +1 661 327 2263
FX: +1 661 633 3801
cushmanwakefield.com

©2025 Cushman & Wakefield. All rights reserved. The information contained in this communication is strictly confidential. This information has been obtained from sources believed to be reliable but has not been verified. NO WARRANTY OR REPRESENTATION, EXPRESS OR IMPLIED, IS MADE AS TO THE CONDITION OF THE PROPERTY (OR PROPERTIES) REFERENCED HEREIN OR AS TO THE ACCURACY OR COMPLETENESS OF THE INFORMATION CONTAINED HEREIN, AND SAME IS SUBMITTED SUBJECT TO ERRORS, OMISSIONS, CHANGE OF PRICE, RENTAL OR OTHER CONDITIONS, WITHDRAWAL WITHOUT NOTICE, AND TO ANY SPECIAL LISTING CONDITIONS IMPOSED BY THE PROPERTY OWNER(S). ANY PROJECTIONS, OPINIONS OR ESTIMATES ARE SUBJECT TO UNCERTAINTY AND DO NOT SIGNIFY CURRENT OR FUTURE PROPERTY PERFORMANCE.

