



CLARION PARTNERS

For Lease



Lear 390 Industrial Center
6650 Echo Avenue, Suites A & B
Reno, NV 89506

±195,000 SF divisible to ±97,500 SF



BUILDING HIGHLIGHTS

- Lease rate negotiable
- Suite A: Available 1/1/2027 (sublease)
- Suite B: Available 6/1/2026 (direct)
- Suite A: ±8,173 SF office
- Suite B: ±2,812 SF office
- 14 dock-high doors with levelers in each suite
- 1 grade-level doors (12' x 14') in each suite
- Cross dock
- 30' clear height
- Suite A Power: 400 amps, 277/480V, 3-phase
- Suite B Power: 800 amps, 277/480V, 3-phase
- ESFR sprinkler rating
- 50' x 50' columns
- T-5 high bay lighting with occupancy sensors
- Cambridge direct fired warehouse heating units





CLARION PARTNERS

Lear 390 Industrial Center

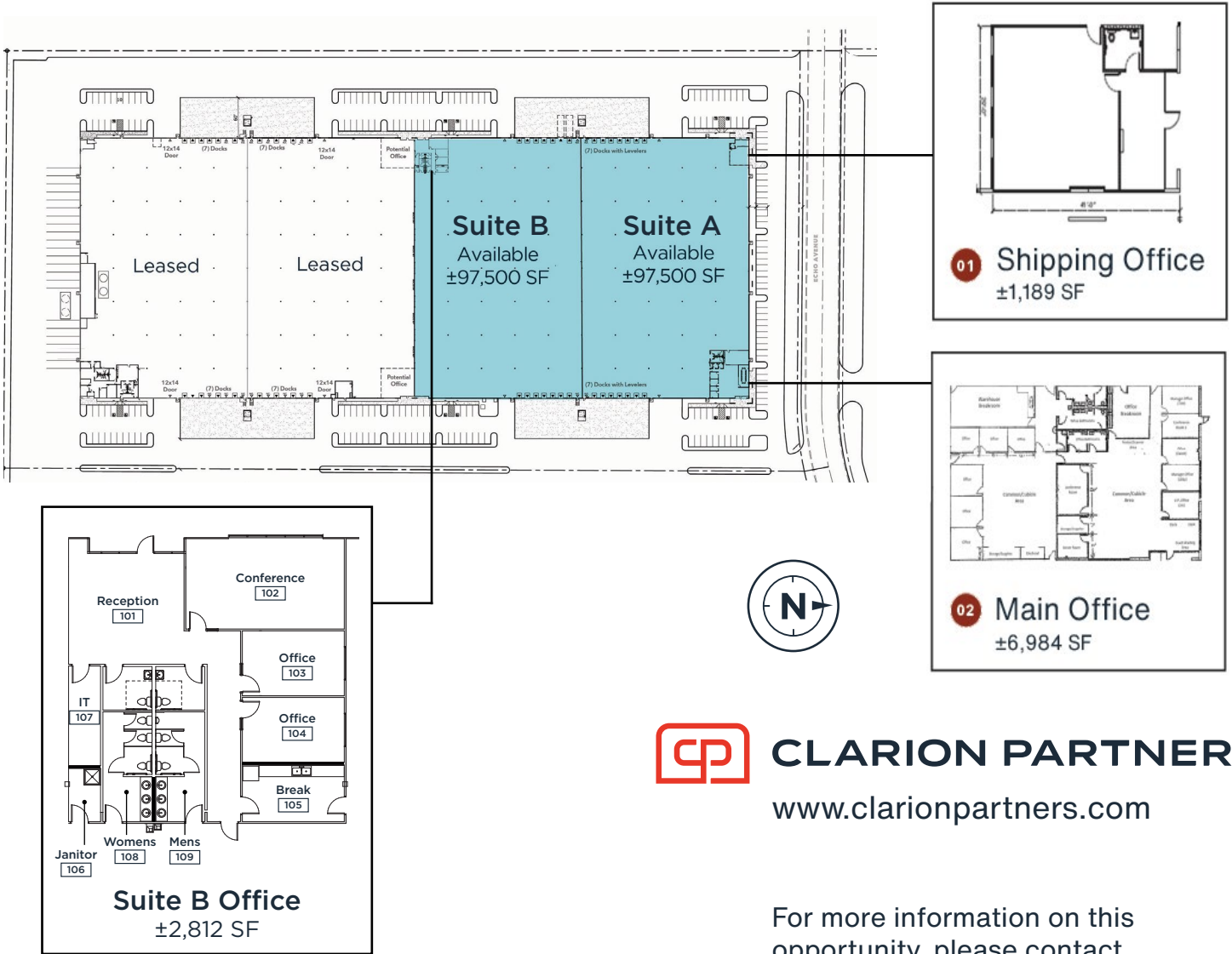

CLARION PARTNERS

www.clarionpartners.com

For more information on this opportunity, please contact.

ADDITIONAL BUILDING HIGHLIGHTS

- Built in 2008
- Trailer storage available with the project
- Situated within the 1.4M SF Lear Industrial Center in close proximity to US-395 & ±11 mi from I-80



Mike Nevis, SIOR, CCIM
 Vice Chairman
 775.232.6119
 mike.nevis@cushwake.com
 Lic #: S.0061758

Emily Jaenson
 Associate
 847.630.4739
 emily.jaenson@cushwake.com
 Lic #: S.0203962

©2026 Cushman & Wakefield. All rights reserved. The information contained in this communication is strictly confidential. This information has been obtained from sources believed to be reliable but has not been verified. NO WARRANTY OR REPRESENTATION, EXPRESS OR IMPLIED, IS MADE AS TO THE CONDITION OF THE PROPERTY (OR PROPERTIES) REFERENCED HEREIN OR AS TO THE ACCURACY OR COMPLETENESS OF THE INFORMATION CONTAINED HEREIN, AND SAME IS SUBMITTED SUBJECT TO ERRORS, OMISSIONS, CHANGE OF PRICE, RENTAL OR OTHER CONDITIONS, WITHDRAWAL WITHOUT NOTICE, AND TO ANY SPECIAL LISTING CONDITIONS IMPOSED BY THE PROPERTY OWNER(S). ANY PROJECTIONS, OPINIONS OR ESTIMATES ARE SUBJECT TO UNCERTAINTY AND DO NOT SIGNIFY CURRENT OR FUTURE PROPERTY PERFORMANCE. COE-PM-West-04.7.2026