



FOR LEASE

921/923 Newhall Street
Costa Mesa, CA

5,800 SF Industrial Unit

SITE HIGHLIGHTS:

- Premier Westside Costa Mesa Location
- Business Park Environment
- Retail and Restaurant Amenities Nearby
- Professional Local Property Management
- Zoning: MG - General Industrial

UNIT FEATURES:

- End Unit
- Window Lined Storefront
- Office Areas w/ HVAC System, Upgraded LED Lights & LVP Flooring
- Two Private Restrooms
- Warehouse SF: ±4,320
- ±16' Clear
- LED Lights
- Skylights Providing Natural Light
- 200 Amps, 120/208V, 3-Phase Electrical Service
- Two 10' x 12' Grade-Level Warehouse Doors

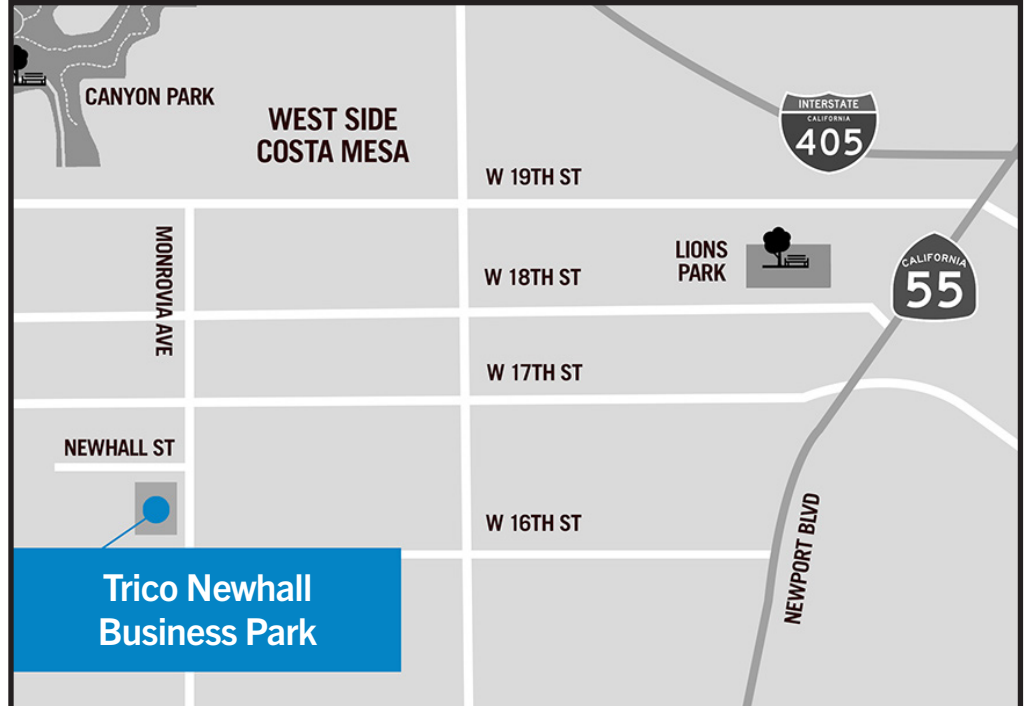

FOR FURTHER DETAILS:

PARKER ROBERTS
parker@tricoREALTY.com
License #01994597

This information has been furnished from sources which we deem reliable; however, we do not guarantee its accuracy and assume no liability. Do not rely on any of the information contained herein without verifying it yourself directly with the listing broker or owner.

Trico Realty, Inc.
License #00342120

3100-A Pullman Street
Costa Mesa, CA 92626

714-751-4420
TricoRealty.com



FOR LEASE

921/923 Newhall Street
Costa Mesa, CA

5,800 SF Industrial Unit

Unit Features

Power: 200A | 120/208

Clearance Height: 16'

Ground Level Doors: Two 10'x12'

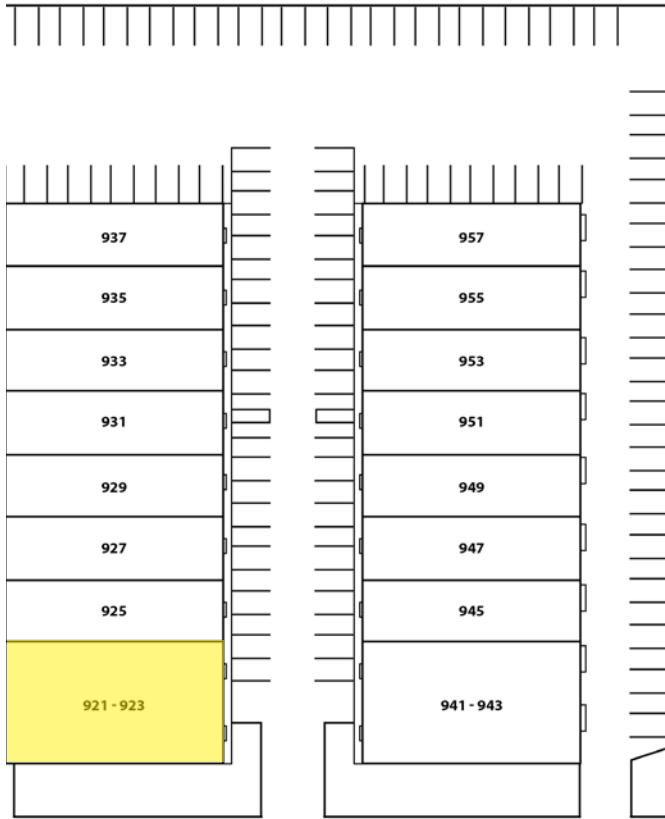

NEWHALL STREET

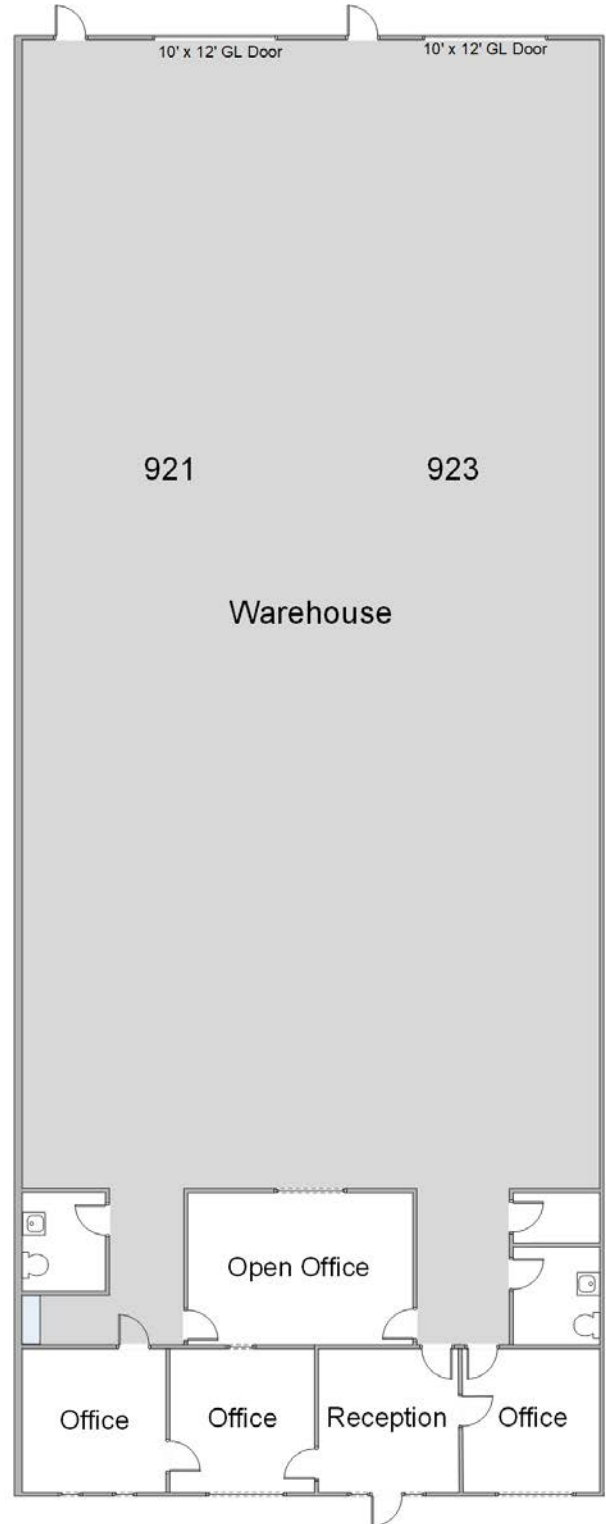

*Floorplans Not to Scale