

# INDUSTRIAL MAINTENANCE BUILDING | TRUCK PARKING FOR LEASE

95-135 HERMIT SMITH ROAD  
APOPKA, FL 32703



**SITE TO BE STABILIZED**

## PROPERTY HIGHLIGHTS

### 135 HERMIT SMITH ROAD

**Building Size:** 9,000± SF

**Doors:** Three (3) large oversized drive in doors

**Land Size:** 12.27 Acres

**Clear Height:** 18'

**Ideal Use:** Equipment rental, truck and fleet maintenance, heavy equipment, construction materials, etc.

### LEASE RATES:

CALL BROKER FOR INFO

**Monthly Approximate Op Ex:** \$11,431.42/mth  
*Plus 3% Management Fee*

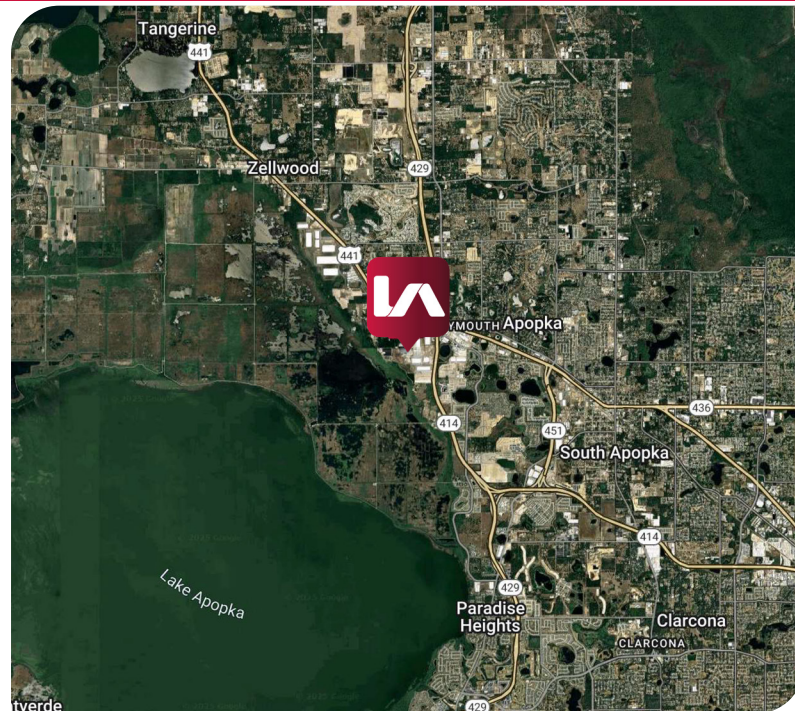

### Leasing Contacts:

Christopher "CJ" Griffith, SIOR  
Vice President  
cgriffith@lee-associates.com  
D 321.281.8508

Ryan Griffith  
Senior Vice President/Principal  
rgriffith@lee-associates.com  
D 321.281.8512

# CONCEPTUAL PLAN

INDUSTRIAL BUILDING & TRUCK PARKING  
95-135 HERMIT SMITH ROAD  
APOPKA, FL 32703



12.27 Acres

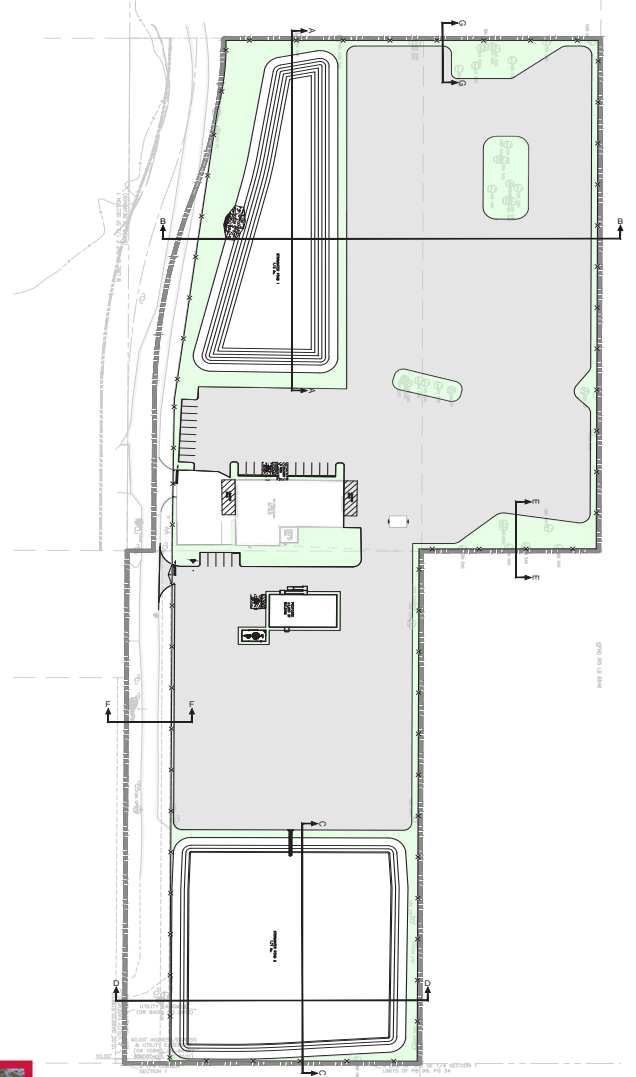

All information furnished regarding property for sale, rental or financing is from sources deemed reliable, but no warranty or representation is made to the accuracy thereof and same is submitted to errors, omissions, change of price, rental or other conditions prior to sale, lease or financing or withdrawal without notice. No liability of any kind is to be imposed on the broker herein.