

WAREHOUSE FOR SUBLEASE

3216 SPOTTSWOOD ST

Raleigh, North Carolina 27615

LEE & ASSOCIATES
COMMERCIAL REAL ESTATE SERVICES
RALEIGH • DURHAM • WILMINGTON



14,600 square feet of warehouse space available for sublease in Lincoln Park North Business Center.

The space features two drive-in doors and one dock high door. With a clear height of approximately 25', the suite is well-suited for a variety of industrial or distribution uses.

PROPERTY HIGHLIGHTS

- » Suite 110: 14,600 SF of warehouse for sublease
- » (2) 12' x 14' Drive-in doors
- » (1) 8' x 10' Dock high door
- » (2) Restrooms
- » ±25' clear height
- » Lease term ends 12/31/2028
- » Lease Rate: \$10.35 SF/yr
- » TICAM (est.) \$2.89 SF/yr

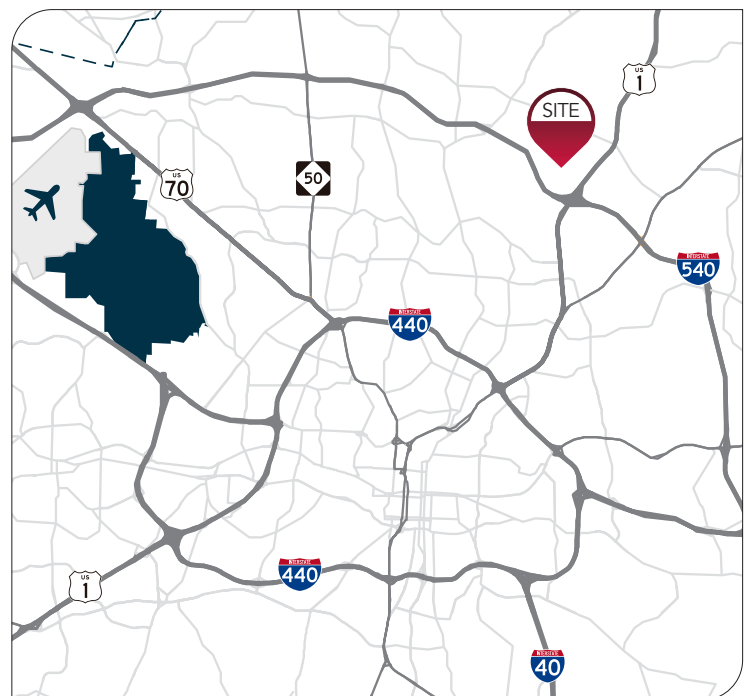

WAREHOUSE FOR SUBLEASE

3216 SPOTTSWOOD ST

Raleigh, North Carolina 27615



COMMERCIAL REAL ESTATE SERVICES
RALEIGH • DURHAM • WILMINGTON

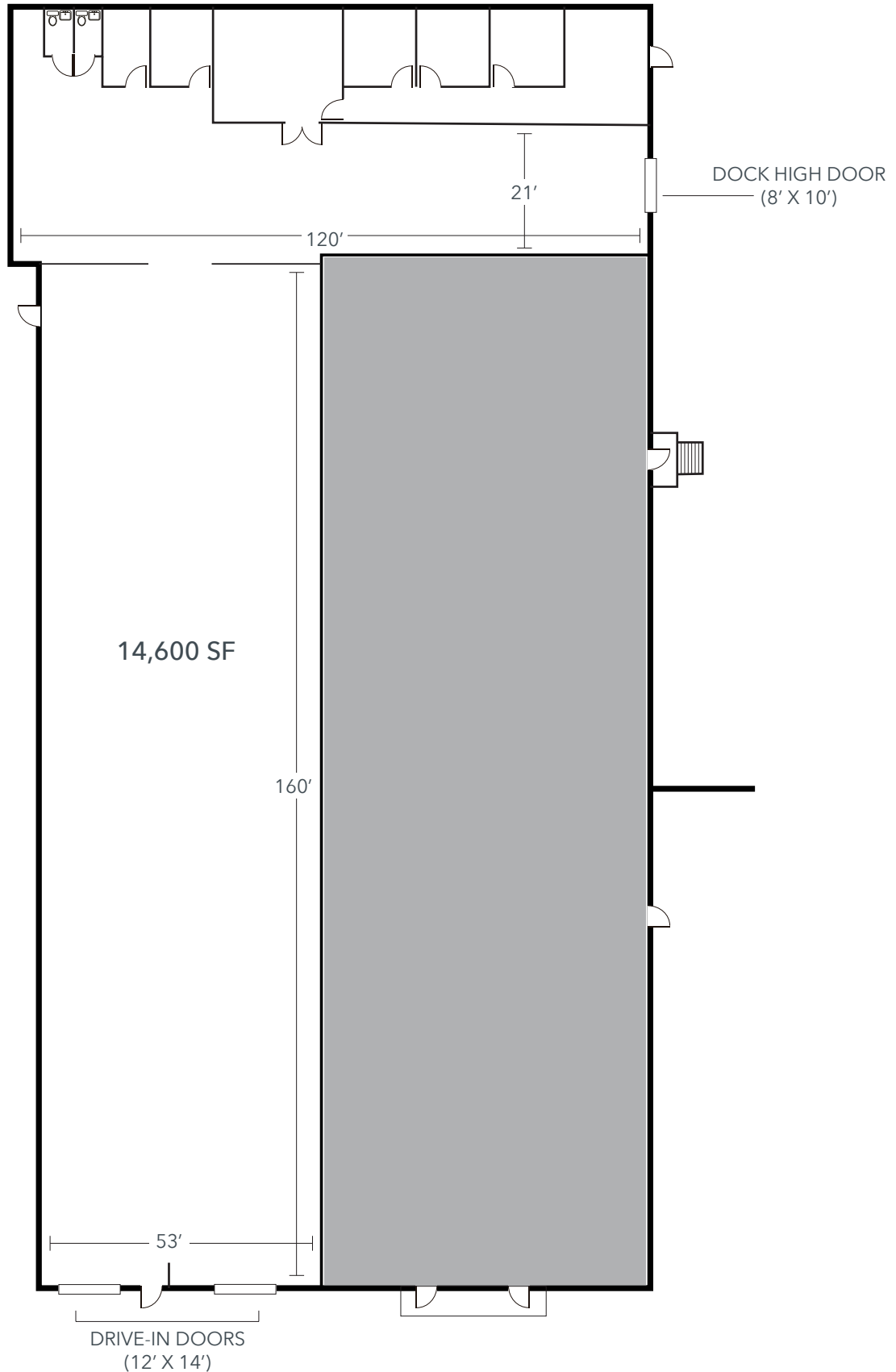

WAREHOUSE FOR SUBLEASE

3216 SPOTTSWOOD ST

Raleigh, North Carolina 27615



COMMERCIAL REAL ESTATE SERVICES
RALEIGH • DURHAM • WILMINGTON

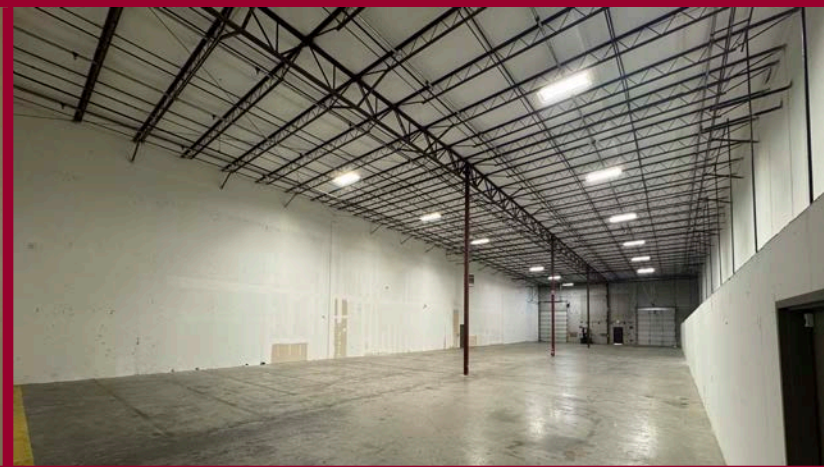
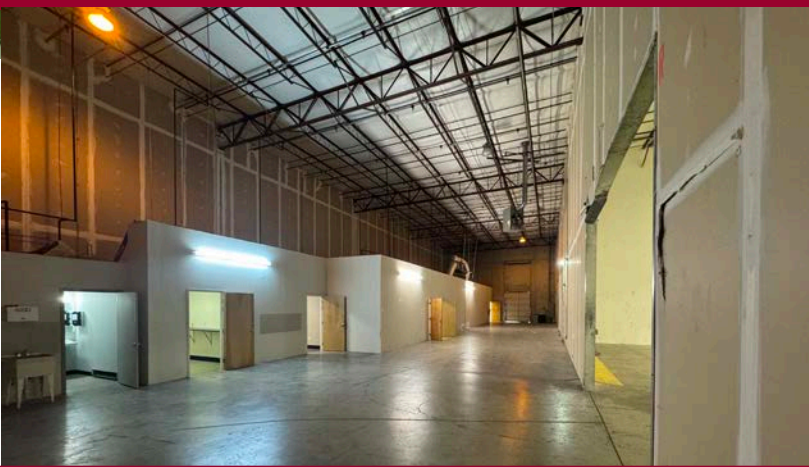

WAREHOUSE FOR SUBLEASE

3216 SPOTTSWOOD ST

Raleigh, North Carolina 27615



COMMERCIAL REAL ESTATE SERVICES
RALEIGH • DURHAM • WILMINGTON

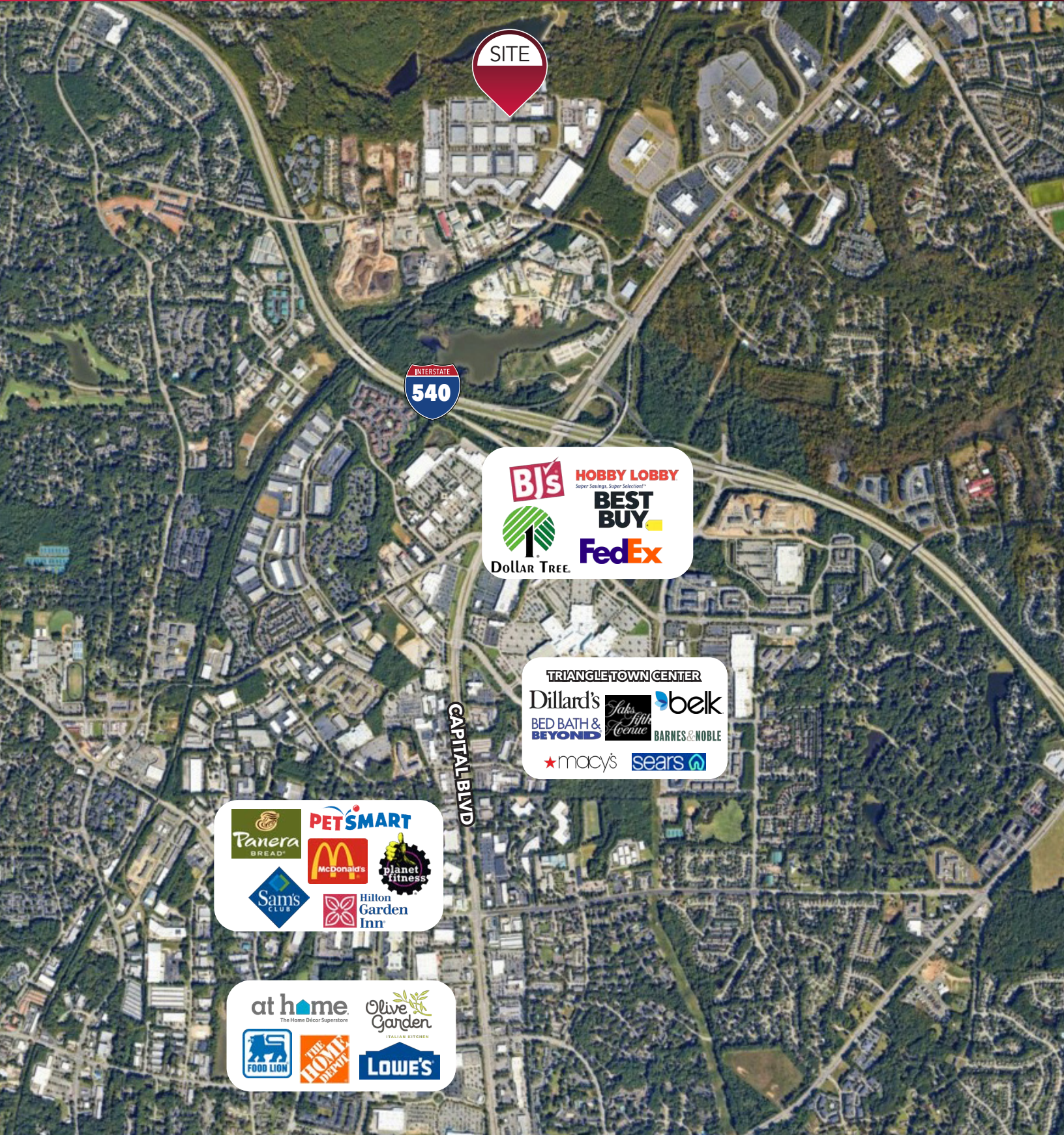

RYAN LAWLER
Senior Director
rlawler@lee-associates.com
O: 919.576.2511
C: 949.291.3896

WILL JUDY
Broker
wjudy@lee-associates.com
O: 919.576.2513
C: 919.606.1956

 **LEE &
ASSOCIATES**
COMMERCIAL REAL ESTATE SERVICES
RALEIGH • DURHAM • WILMINGTON

All information furnished regarding property for sale, rental or financing is from sources deemed reliable, but no warranty or representation is made to the accuracy thereof and same is submitted to errors, omissions, change of price, rental or other conditions prior to sale, lease or financing or withdrawal without notice. No liability of any kind is to be imposed on the broker herein.