

215 WICKSTEED AVE & 50 BETH NEALSON DR

TORONTO (LEASIDE), ON

FOR LEASE UP TO 166,378 SQ. FT. INDUSTRIAL FACILITY -
VARIOUS DEMISED OPTIONS AVAILABLE



PROPERTY DETAILS

Address 215 Wicksteed Ave & 50 Beth Neelson Dr

Location Eglinton Ave E & Brentcliffe Rd

Size Approx. 166,378 Sq. Ft.

Clear Height 11 Ft. 5 In. - 28 Ft. 5 In.

Shipping 17 Truck Level Doors
2 Drive-In Doors (Interior)

Zoning E 1.0

Power 215 Wicksteed Ave - 1,200 Amps | 600 Volts
50 Beth Neelson Dr - 800 Amps | 600 Volts

Occupancy 215 Wicksteed Ave - September 2026
50 Beth Neelson Dr - Immediate

TMI (2026) \$3.13 per Sq. Ft. Estimate

PROPERTY HIGHLIGHTS



Excellent
Clear Height



Close to Downtown
& DVP



Amenity
Rich Area



PROPERTY DETAILS

Address	50 Beth Neelson Dr
Location	Overlea Blvd & Thorncliffe Park Dr
Size	Approx. 57,714 Sq. Ft.
Clear Height	28 Ft. 8 In.
Shipping	5 Truck Level Doors
Zoning	E 1.0
Power	800 Amps 600 Volts
Occupancy	Immediate
TMI (2026)	\$3.13 per Sq. Ft. Estimate

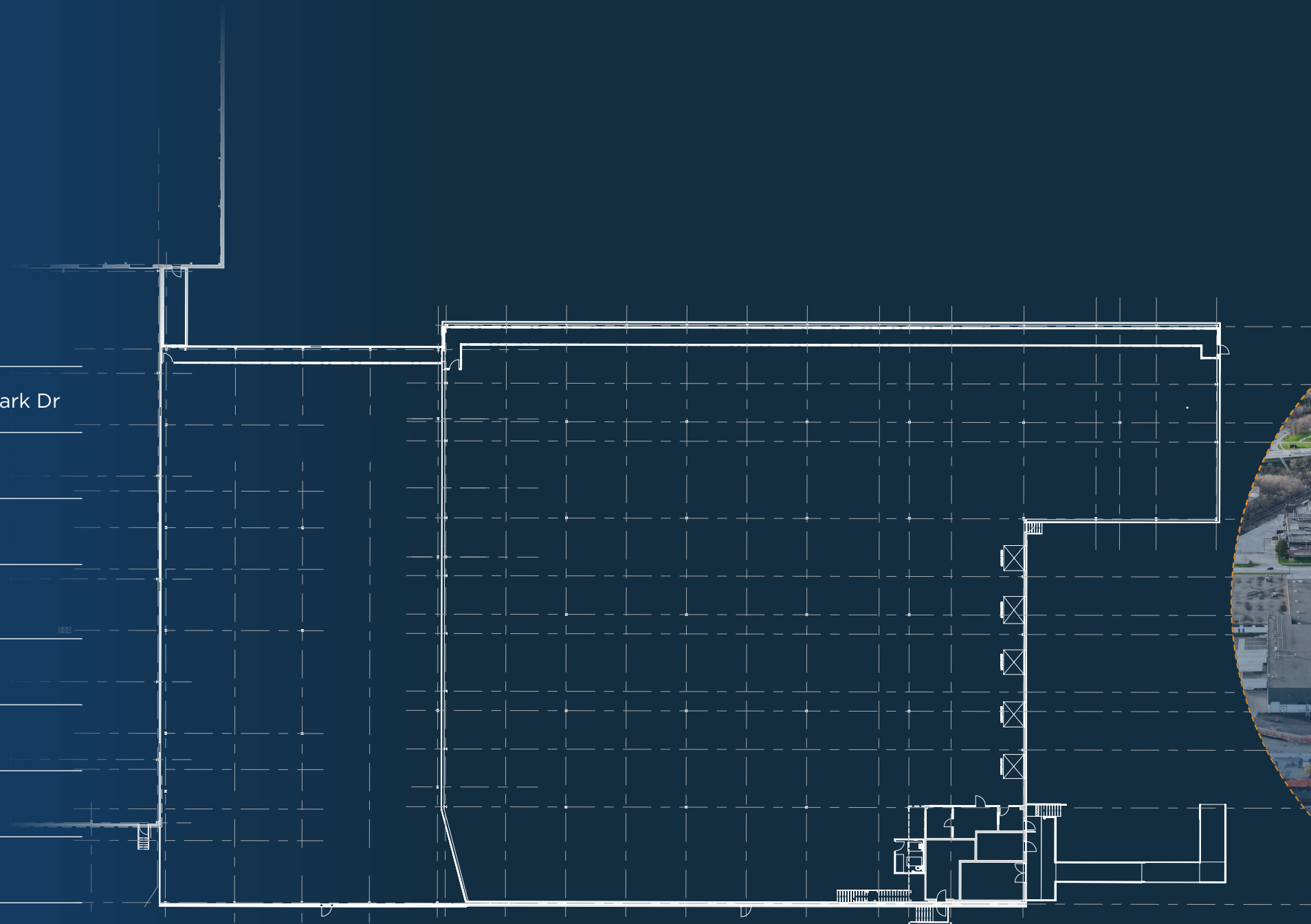

ASSET OVERVIEW

Size	Net Rental Rate	Clear Height	Shipping
Full Building Approx. 166,378 Sq. Ft.	\$14.95 net per Sq. Ft.	11' 5" - 28' 5"	22 TL, 2 DI
Yellow, Green & Red (215 Wicksteed Ave) Approx. 108,664 Sq. Ft.	\$15.25 net per Sq. Ft.	11' 5" - 28' 5"	17 TL, 2 DI
Green & Yellow Approx. 77,321 Sq. Ft.	\$15.75 net per Sq. Ft.	11' 5" - 23' 6"	8 TL, 1 DI
Red Approx. 31,343 Sq. Ft.	\$16.00 net per Sq. Ft.	28' 5"	7 TL, 1 DI
Purple (50 Beth Neilson Dr) Approx. 57,714 Sq. Ft.	\$16.00 net per Sq. Ft.	28' 8"	5 TL

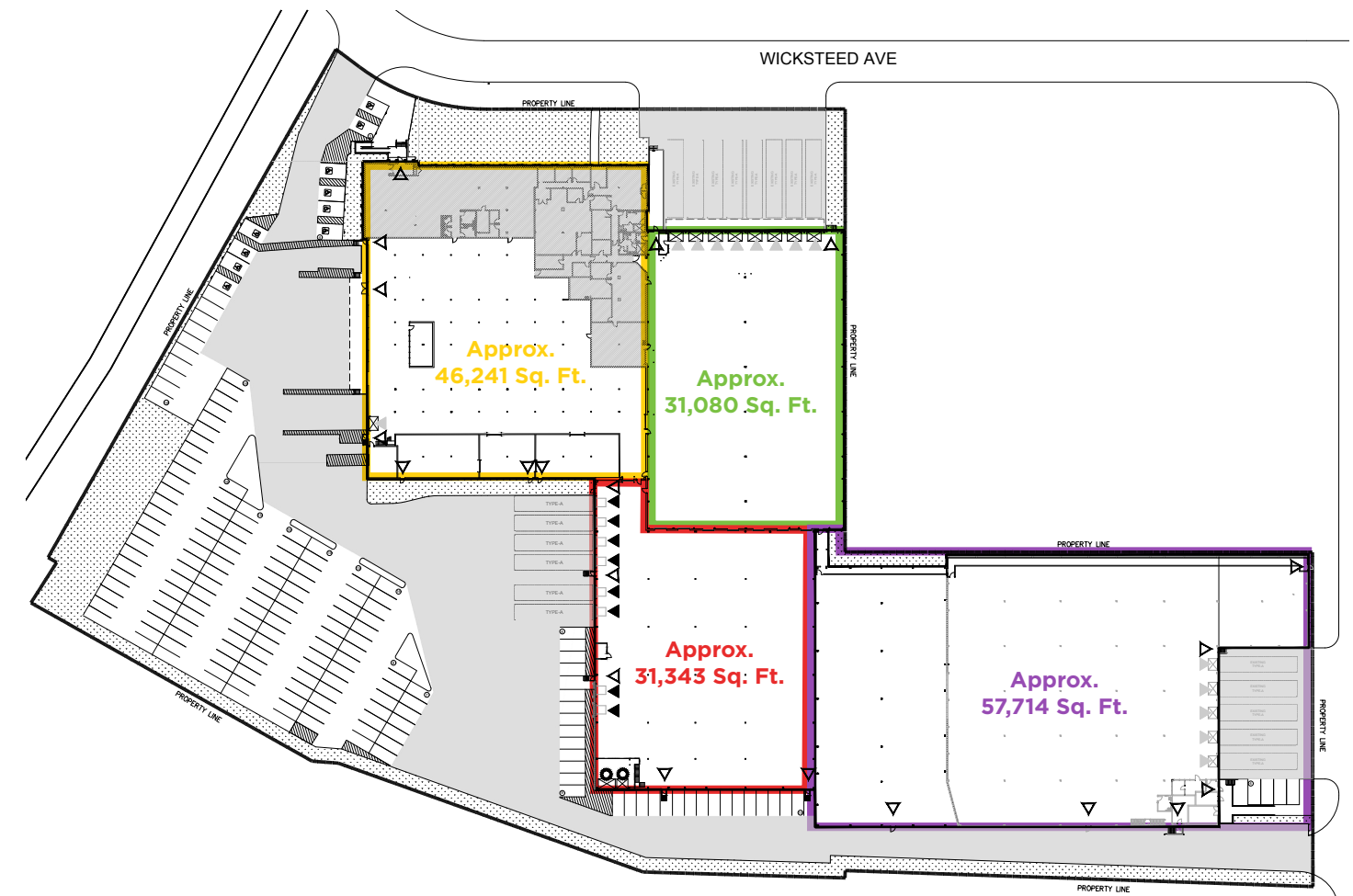

ZONING DETAILS

Permitted Uses

(1)USE - E ZONE
IN THE E ZONE, THE FOLLOWING USES ARE PERMITTED:

AMBULANCE DEPOT
ANIMAL SHELTER
ARTIST STUDIO
AUTOMATED BANKING MACHINE
BINDERY
BUILDING SUPPLY YARDS
CARPENTER'S SHOP
COLD STORAGE
CONTRACTOR'S ESTABLISHMENT
CUSTOM WORKSHOP
DRY CLEANING OR LAUNDRY PLANT
FINANCIAL INSTITUTION
FIRE HALL
INDUSTRIAL SALES AND SERVICE USE
KENNEL
LABORATORY
ALL MANUFACTURING USES EXCEPT:
1) ABATTOIR, SLAUGHTERHOUSE OR RENDERING OF ANIMALS FACTORY;
2) AMMUNITION, FIREARMS OR FIREWORKS FACTORY;
3) ASPHALT PLANT;
4) CEMENT PLANT, OR CONCRETE BATCHING PLANT;
5) CRUDE PETROLEUM OIL OR COAL REFINERY;
6) EXPLOSIVES FACTORY;
7) INDUSTRIAL GAS MANUFACTURING;
8) LARGE SCALE SMELTING OR FOUNDRY OPERATIONS FOR THE PRIMARY PROCESSING OF METALS;
9) PESTICIDE OR FERTILIZER MANUFACTURING;
10) PETROCHEMICAL MANUFACTURING;
11) PRIMARY PROCESSING OF GYPSUM;
12) PRIMARY PROCESSING OF LIMESTONE;
13) PRIMARY PROCESSING OF OIL-BASED PAINTS, OIL-BASED COATINGS OR ADHESIVES;
14) PULP MILL, USING PULPWOOD OR OTHER VEGETABLE FIBRES;
15) RESIN, NATURAL OR SYNTHETIC RUBBER MANUFACTURING;
16) TANNERY
OFFICE
PARK
PERFORMING ARTS STUDIO
PET SERVICES
POLICE STATION
PRINTING ESTABLISHMENT
PRODUCTION STUDIO
PUBLIC WORKS YARD
SERVICE SHOP
SOFTWARE DEVELOPMENT AND PROCESSING
WAREHOUSE
WHOLESALE USE [BY-LAW: OMB PL130592]

(1)USE WITH CONDITIONS - E ZONE
BODY RUB SERVICE (32)
COGENERATION ENERGY (26)
CREMATORIUM (33)
DRIVE THROUGH FACILITY (5,21)
EATING ESTABLISHMENT (1,19,30)
MARIJUANA PRODUCTION FACILITY (2)
METAL FACTORY INVOLVING FORGING AND STAMPING (25)
OPEN STORAGE (10)
OUTDOOR PATIO (9)
PUBLIC UTILITY (27,29)
RECOVERY FACILITY (8)
RECREATION USE (7)
RENEWABLE ENERGY (26)
RETAIL SERVICE (3)
RETAIL STORE (4,30)
SHIPPING TERMINAL (11)
TAKE-OUT EATING ESTABLISHMENT (1,30)
TRANSPORTATION USE (28)
VEHICLE DEPOT (6)
VEHICLE FUEL STATION (16,30)
VEHICLE REPAIR SHOP (23)
VEHICLE SERVICE SHOP (17,31)
VEHICLE WASHING ESTABLISHMENT (18) [BY-LAW: 0403-2014] [BY-LAW: 1124-2018] [BY-LAW: 1198-2019]



PROPERTY PHOTOS



215 Wicksteed Ave



215 Wicksteed Ave

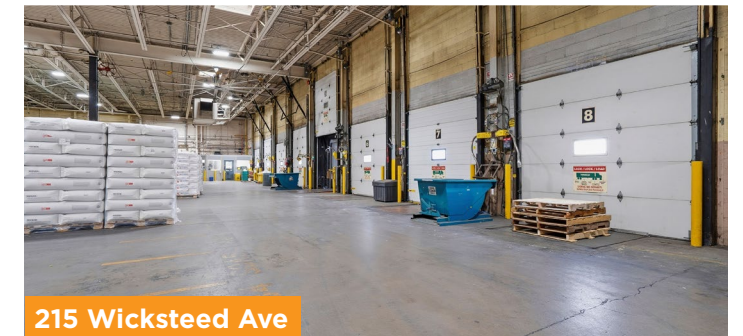

215 Wicksteed Ave



215 Wicksteed Ave

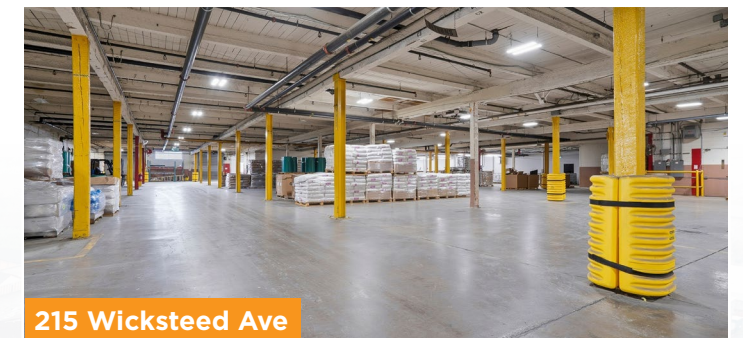

215 Wicksteed Ave



50 Beth Neilson Dr

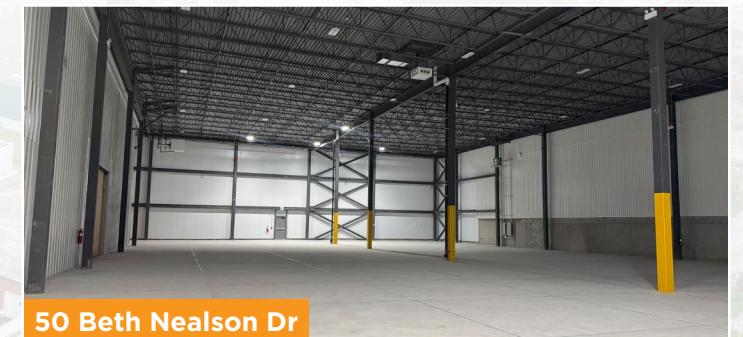

50 Beth Neilson Dr

LOCAL DEMOGRAPHICS

- 215 WICKSTEED AVE & 50 BETH NEALSON DR
- EAST YORK



POPULATION (EST. 2025)

5 KM
656,544



AVG HOUSEHOLD INCOME (EST.2025)

5 KM
\$163,873



LABOUR FORCE (EST. 2025)

5 KM
69.5%



MEDIAN AGE (EST. 2025)

5 KM
37.8 YEARS

▲ SOURCE: SITEWISE, 2026

DRIVE TIMES

 **DON VALLEY PARKWAY**
4 MIN • 2.6 KM

 **HIGHWAY 401**
12 MIN • 7.7 KM

 **HIGHWAY 407**
15 MIN • 17.2 KM

 **DOWNTOWN TORONTO**
15 MIN • 11.6 KM

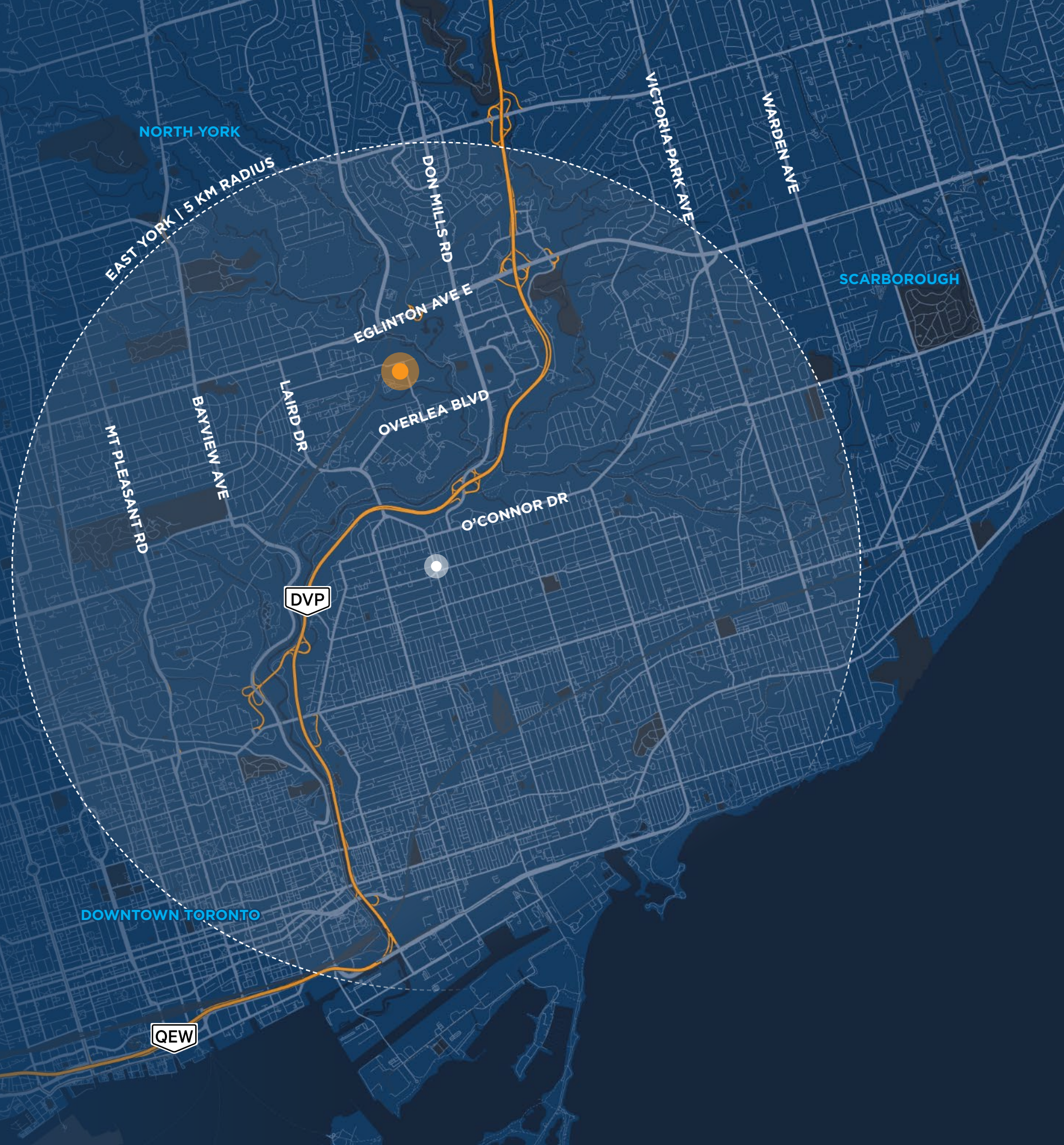

LOCATION & AMENITIES

TRANSIT ROUTES

— EGLINTON LRT

— 88A LEASIDE

— 56A LEASIDE

— FUTURE ONTARIO LINE

 EGLINTON CROSSTOWN STATION

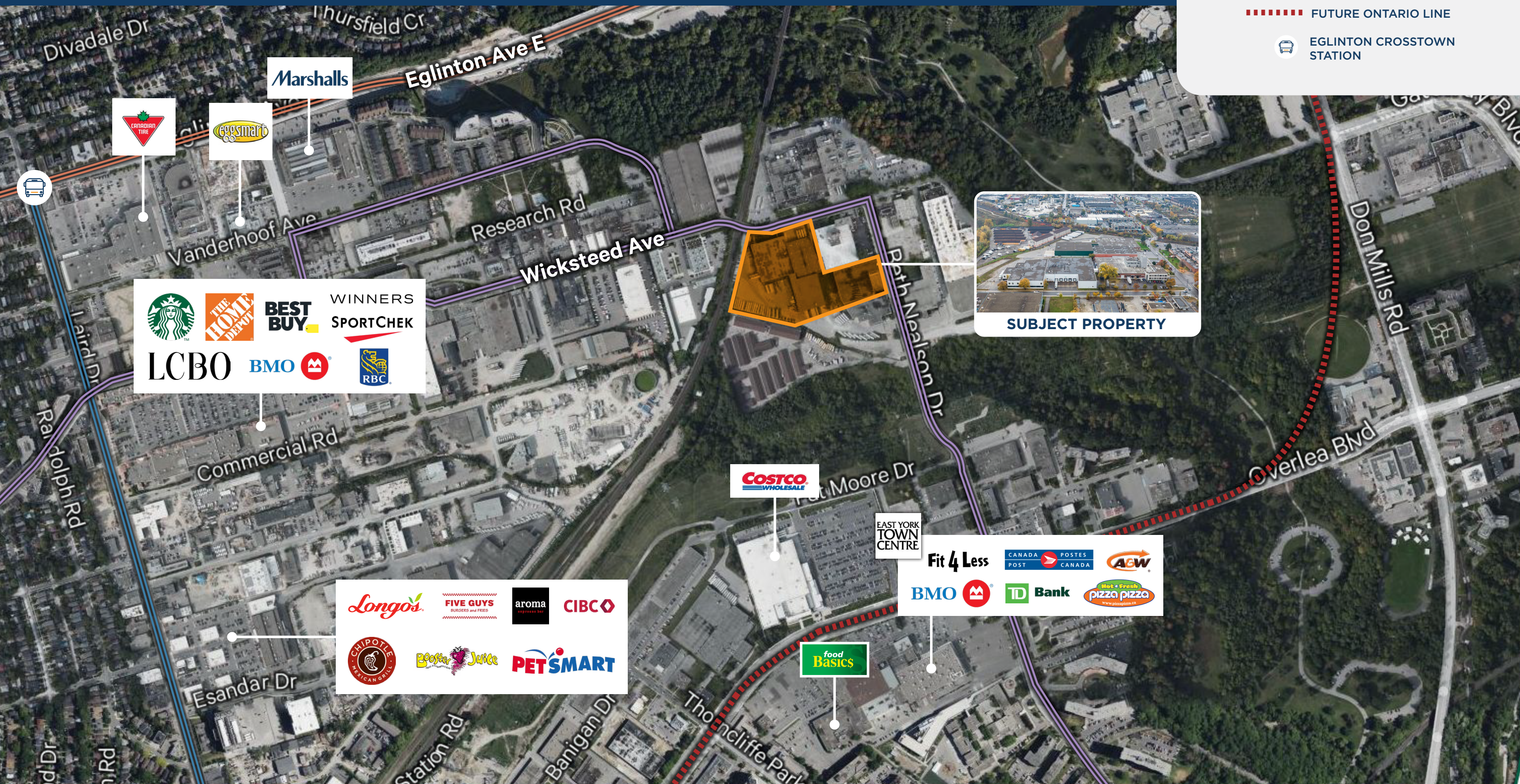

Canadian Tire
eggsmart
Marshalls

Starbucks **THE HOME DEPOT** **BEST BUY** **WINNERS** **SPORTCHEK**
LCBO **BMO** **RBC**

Longo's **FIVE GUYS** **aroma** **CIBC**
CHIPOTLE MEXICAN GRILL **Booster Juice** **PET SMART**

COSTCO WHOLESALE

EAST YORK TOWN CENTRE

Fit 4 Less **CANADA POST** **POSTES CANADA** **AEW**
BMO **TD Bank** **Hot & Fresh pizza pizza**

food Basics

215 WICKSTEED AVE & 50 BETH NEALSON DR

LEASIDE, TORONTO, ON



Pure Industrial is one of Canada's leading providers of industrial real estate. With offices in Toronto, Montreal, Quebec City, and Vancouver and top tier properties across the country, we believe in the power of vision and the strength of partnership.

We're not just providing industrial real estate; we are laying the foundation for your business to thrive and are committed to being your partner in growth. We offer a portfolio of more than 42M square feet of prime locations across Canada, ranging from small warehouses to large industrial developments, and diligently serve more than 1,400 customers every day.

Our dedicated, customer-focused team is here to build lasting relationships, deliver highly responsive, personalized service, and keep your supply chain seamless, from the first mile to the last.

pureindustrial.ca

CBRE

Rob Ironside*

Senior Vice President
+1 416 495 6260
robert.ironside@cbre.com

Carol Trattner, MBA**

Senior Vice President
+1 416 495 6253
carol.trattner@cbre.com

Kate Camenzuli*

Vice President
+1 416 815 2380
kate.camenzuli@cbre.com

**Broker *Sales Representative | All Outlines Are Approximate

CBRE Limited, Brokerage | 2005 Sheppard Ave E., Suite 800, Toronto ON M2J 5B4

This disclaimer shall apply to CBRE Limited, Real Estate Brokerage, and to all other divisions of the Corporation; to include all employees and independent contractors ("CBRE"). The information set out herein, including, without limitation, any projections, images, opinions, assumptions and estimates obtained from third parties (the "Information") has not been verified by CBRE, and CBRE does not represent, warrant or guarantee the accuracy, correctness and completeness of the Information. CBRE does not accept or assume any responsibility or liability, direct or consequential, for the Information or the recipient's reliance upon the Information. The recipient of the Information should take such steps as the recipient may deem necessary to verify the Information prior to placing any reliance upon the Information. The Information may change and any property described in the Information may be withdrawn from the market at any time without notice or obligation to the recipient from CBRE. CBRE and the CBRE logo are the service marks of CBRE Limited and/or its affiliated or related companies in other countries. All other marks displayed on this document are the property of their respective owners. All Rights Reserved. Mapping Sources: Canadian Mapping Services canadamapping@cbre.com; MapPoint, DMTI Spatial, EnviroNics Analytics, Microsoft Bing, Google Earth