

BUILDING 4



BUILDING 4

Total Available SF: 36,225

Loading Dock: 1

Overhead Doors: 1

Man Doors: 2

Restroom: 1

Office: 1

New LED Motion Detector Lights

Ceiling Height: 20' against walls. 24' center.

Covered Loading Dock

Exterior Loading Dock

BUILDING #4

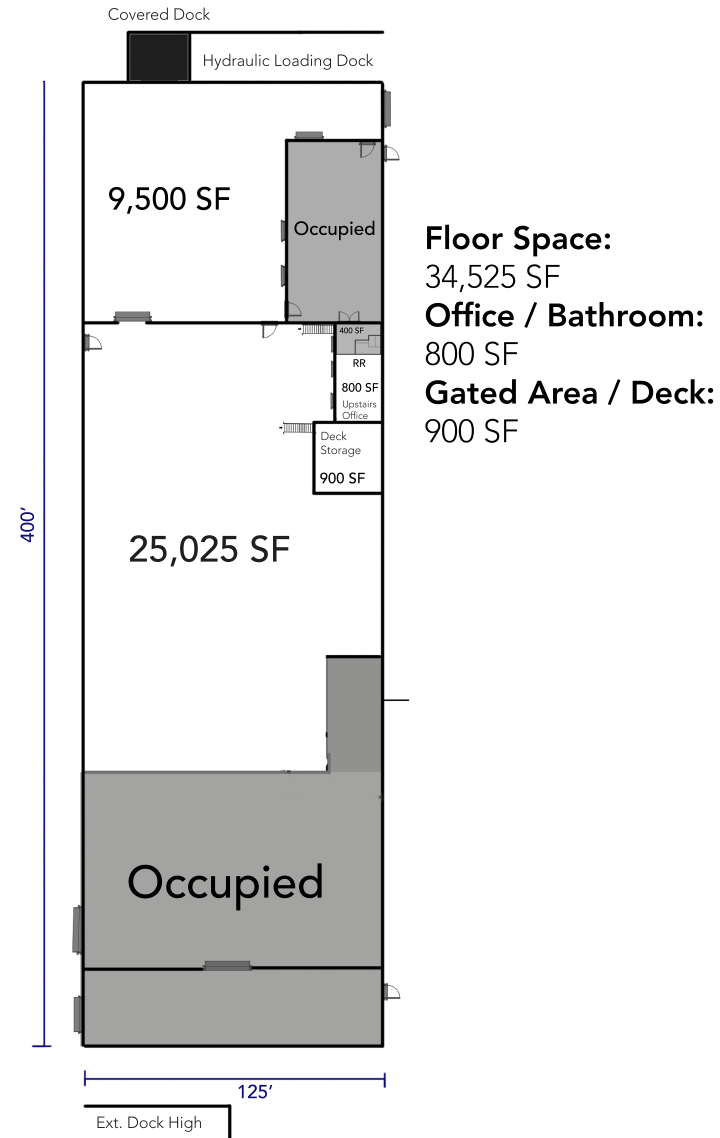

- Fully functioning HVAC
- 3 Phase Power
- Equipped for manufacturing



