

# Stadium District Commercial Space

**FOR LEASE**

**164 S WASHINGTON ST – SEATTLE, WA 98104**



- › Lower level
- › Recently renovated
- › Located across from Occidental Park in Pioneer Square
- › Short walk to Seahawks stadium
- › 10,000 sf
- › Currently operating as a nightclub
- › \$15/sf NNN

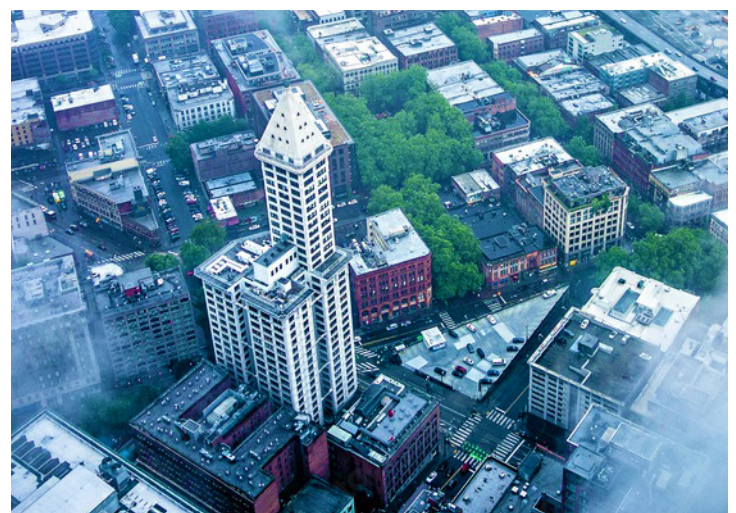

**Allegra Properties**  
DEVELOPMENT • MANAGEMENT • INVESTMENT

**Allegra Properties**  
88 Lenora St  
Seattle, WA 98121  
[www.allegraproperties.com](http://www.allegraproperties.com)

**Contact:**  
**Boris Castellanos**  
206.812.7812  
[boris@allegraproperties.com](mailto:boris@allegraproperties.com)

The information regarding this offering has been obtained from sources deemed reliable, but such information has not been verified and no express representation is made, nor is any to be implied as to the accuracy thereof. It is submitted subject to errors, omissions, change of price, rental or other conditions, prior sale, lease or financing, or withdrawal without notice.

FOR LEASE

164 S WASHINGTON ST – SEATTLE, WA 98104

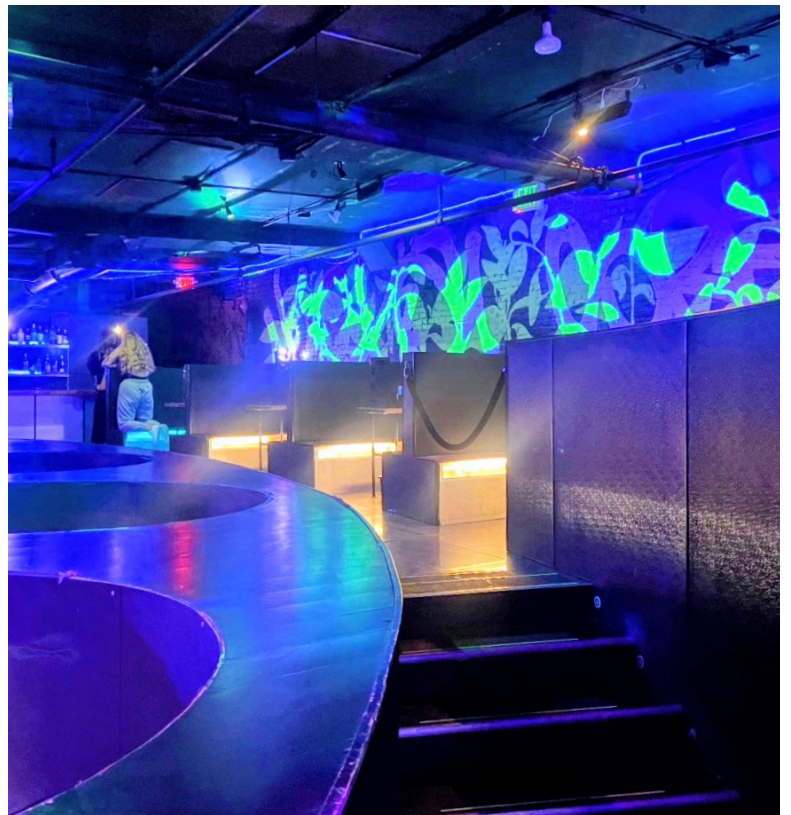

AllegraProperties

Allegra Properties  
88 Lenora St | Seattle WA 98121  
www.allegraproperties.com

contact: Boris Castellanos  
206.812.7812  
boris@allegraproperties.com

**FOR LEASE**

**164 S WASHINGTON ST – SEATTLE, WA 98104**

- › Lower level
- › 10,000 sf
- › \$15/sf NNN
- › Currently operating as a nightclub
- › Short walk to Seahawks stadium
- › Located across from Occidental Park in Pioneer Square

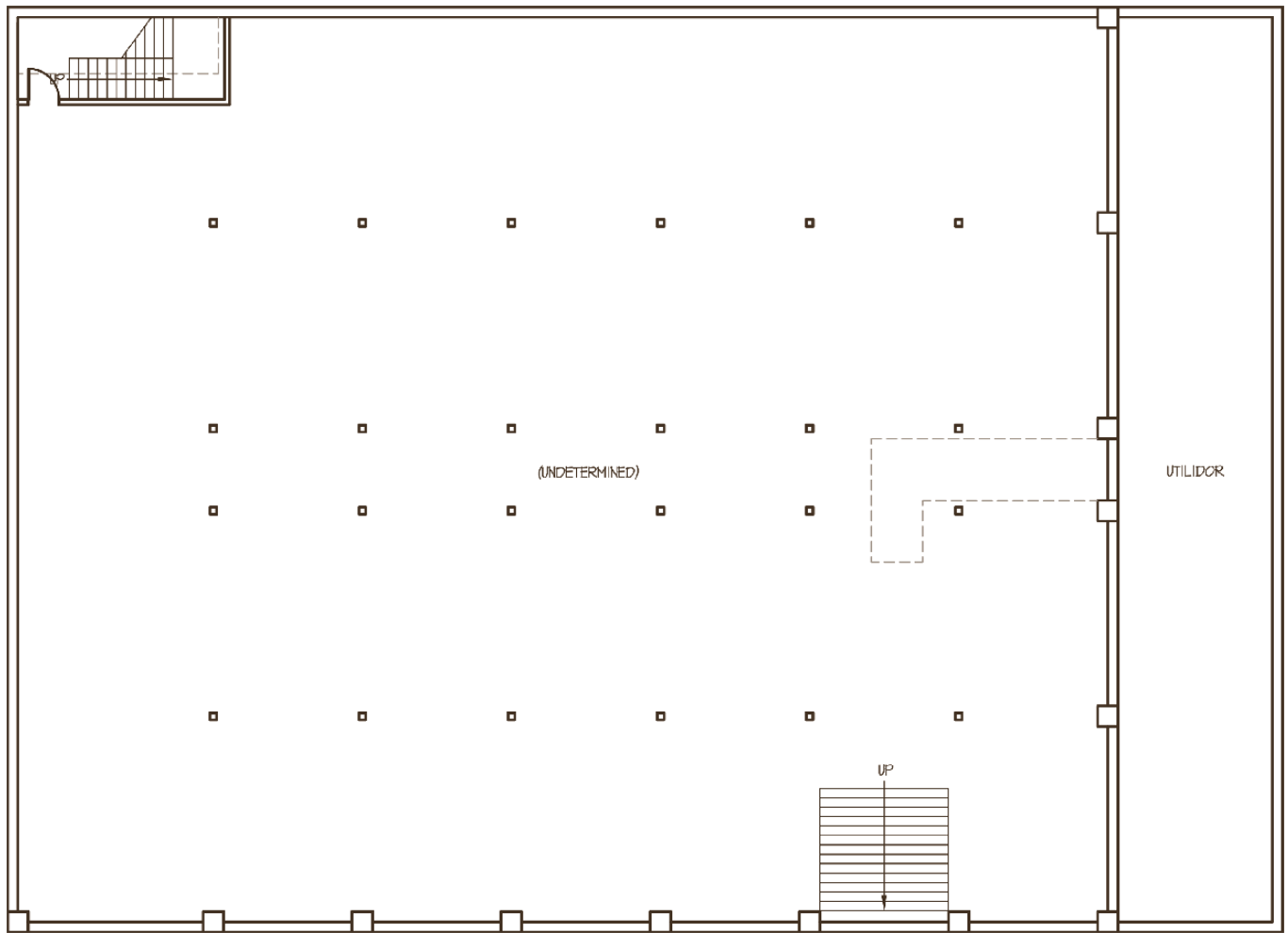

← **South Washington Street** →

**Allegra Properties**

Allegra Properties  
88 Lenora St | Seattle WA 98121  
www.allegraproperties.com

contact: Boris Castellanos  
206.812.7812  
boris@allegraproperties.com

# PIONEER SQUARE: SEATTLE'S ORIGINAL NEIGHBORHOOD

Pioneer Square exudes century-old charm in its late-1800s Romanesque Revival buildings and cobblestone streets. Tourists can delve into that history on a guided Beneath the Streets tour of underground passageways or learn about Seattle's roots at the Klondike Gold Rush National Historical Park. Art galleries, coffee shops and trendy bars fill the heart of Pioneer Square and it is home to Seattle's oldest skyscraper, The Smith Tower, once the tallest building west of the Mississippi. The pedestrian-only Occidental Park is home to myriad art galleries, daily food trucks for office workers and residents to enjoy, and a plaza with bistro tables and bocce courts. And of course Pioneer Square is the gateway to Seattle's major sports stadiums, Lumen Field and T-Mobile Park, home to the Seahawks, Sounders, Mariners, and Seattle's sports faithful. Not to mention, it is also the most transit-friendly neighborhood in the northwest, with easy access to Ballard, the University District, Fremont, and even Tacoma and Everett by bus, link-light rail, or Sounder trains.



## DEMOGRAPHICS

	1 Mile	3 Mile	5 Mile
Population	44,521	240,564	479,827
Households	26,695	137,287	240,833
Average Household Income	\$92,450	\$130,809	\$133,518

## NEIGHBORHOOD KEY

- Apartments & Condos
- Hotels

