

FOR LEASE

5000 PLEASANTON AVE

PLEASANTON, CA 94566

*Modern, Well-Appointed Medical /
Office Suites For Lease in Downtown
Pleasanton with Easy Access to Major
Transportation Routes*



KIDDER.COM

EXCLUSIVELY LEASED BY

5000 PLEASANTON AVENUE

AMADOR DENTAL &
ORTHODONTIC
GREAT WESTERN
TRANSPORTATION
CENTER FOR AUTISM
& RELATED DISORDERS

COMPASS
JumpstartMD
STOPWARE

km Kidder
Mathews

5000 PLEASANTON AVE

PREMIER OFFICES AND CLASS "A" INTERIOR

The property's strategic location provides easy access to major transportation routes and is within close proximity to a range of dining, shopping, and leisure options.

AVAILABLE FOR LEASE

ADDRESS	5000 Pleasanton Avenue Pleasanton, CA 94566
PARCEL NUMBER	094-0157-026-00
TOTAL GLA	±22,649 SF
TOTAL LAND AREA	±39,504 SF/0.91 AC
BUILT	1999
PARKING	Surface and Underground
PARKING RATIO	3.65/1,000 SF
MARKET	East Bay/Oakland
SUBMARKET	Pleasanton
COUNTY	Alameda

1 MIN

WALK TO ACE TRAIN

2 MIN

DRIVE TO I-680

KIDDER MATHEWS



FIRST FLOOR PLAN

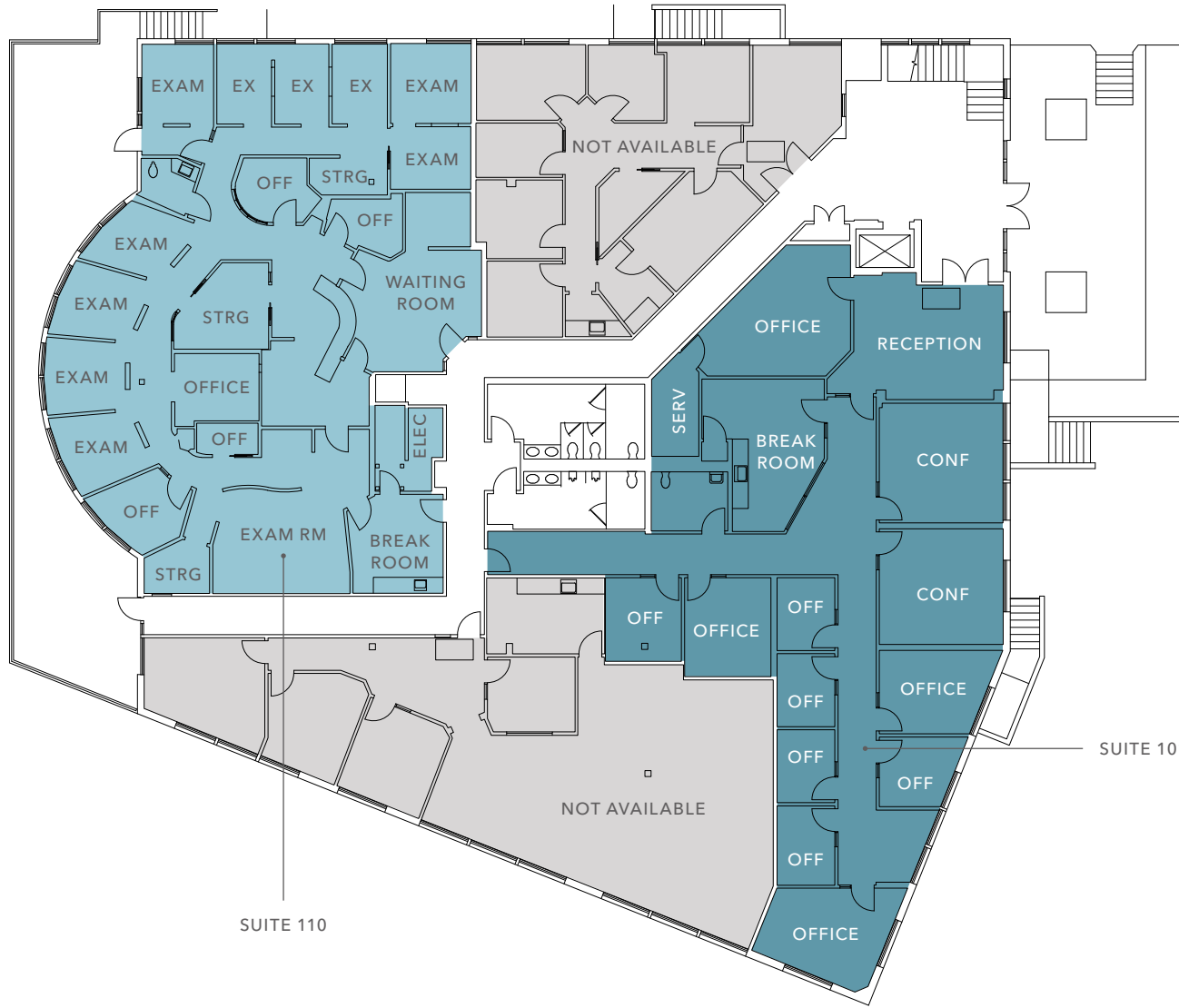

±4,351 SF

SUITE 101

±4,378 SF

SUITE 110

CONTACT

BROKERS FOR RATES

FLOOR PLAN NOT TO SCALE

SECOND FLOOR PLAN



±1,678 SF

SUITE 210

CONTACT

BROKERS FOR RATES

NOW

AVAILABLE

FLOOR PLAN NOT TO SCALE



BART STATION
West Dublin/Pleasanton

BART STATION
East Dublin/Pleasanton

ROSE PAVILION SHOPPING MALL

STONERIDGE SHOPPING MALL

COURTYARD
BY MARSHALL

HYATT
house

PLEASANTON

AMADOR CENTER SHOPPING MALL

FOOTHILL HIGH SCHOOL

KEN MERCER SPORTS PARK

HARVEST PARK MIDDLE SCHOOL

PLEASANTON GATEWAY SHOPPING CENTER

--	--	--

5000 PLEASANTON AVE

ACE TRAIN STATION





COMPASS



Exclusively listed by

IAN THOMAS

Kidder Mathews

925.905.1105

ian.thomas@kidder.com

LIC N° 01279455

TYLER BROWN

Compass Real Estate

925.575.1847

tbrown@compass.com

LIC N° 01457051

[KIDDER.COM](https://www.kidder.com)

[COMPASS-CRE.COM/](https://www.compass-cre.com/)

This information supplied herein is from sources we deem reliable. It is provided without any representation, warranty, or guarantee, expressed or implied as to its accuracy. Prospective Buyer or Tenant should conduct an independent investigation and verification of all matters deemed to be material, including, but not limited to, statements of income and expenses. Consult your attorney, accountant, or other professional advisor. All Kidder Mathews designs are the sole property of Kidder Mathews. Branded materials and layouts are not authorized for use by any other firm or person.