

FOR LEASE

INDUSTRIAL SPACE FOR LEASE

42065 ZEVO DR, SUITE B4 TEMECULA, CA

Property Features

Suite B4 | ±3,157 SF Industrial space

One grade level loading door

18' Clear height

200 amps 120/208 3 phase (confirm)

Distributed power through out

Fire sprinklers

Racking available

Reception area, one private office, break area and restroom

Located in the heart of Temecula with easy access to the I-15 freeway

±3,157 SF

SUITE B4

\$4,104

GROSS LEASE RATE (\$/MO)

FOR MORE INFORMATION,
PLEASE CONTACT

MATT CALVET

858.442.2072

matt.calvet@kidder.com

LIC N° 01949267

KIDDER.COM

This information supplied herein is from sources we deem reliable. It is provided without any representation, warranty, or guarantee, expressed or implied as to its accuracy. Prospective Buyer or Tenant should conduct an independent investigation and verification of all matters deemed to be material, including, but not limited to, statements of income and expenses. Consult your attorney, accountant, or other professional advisor.

**km Kidder
Mathews**

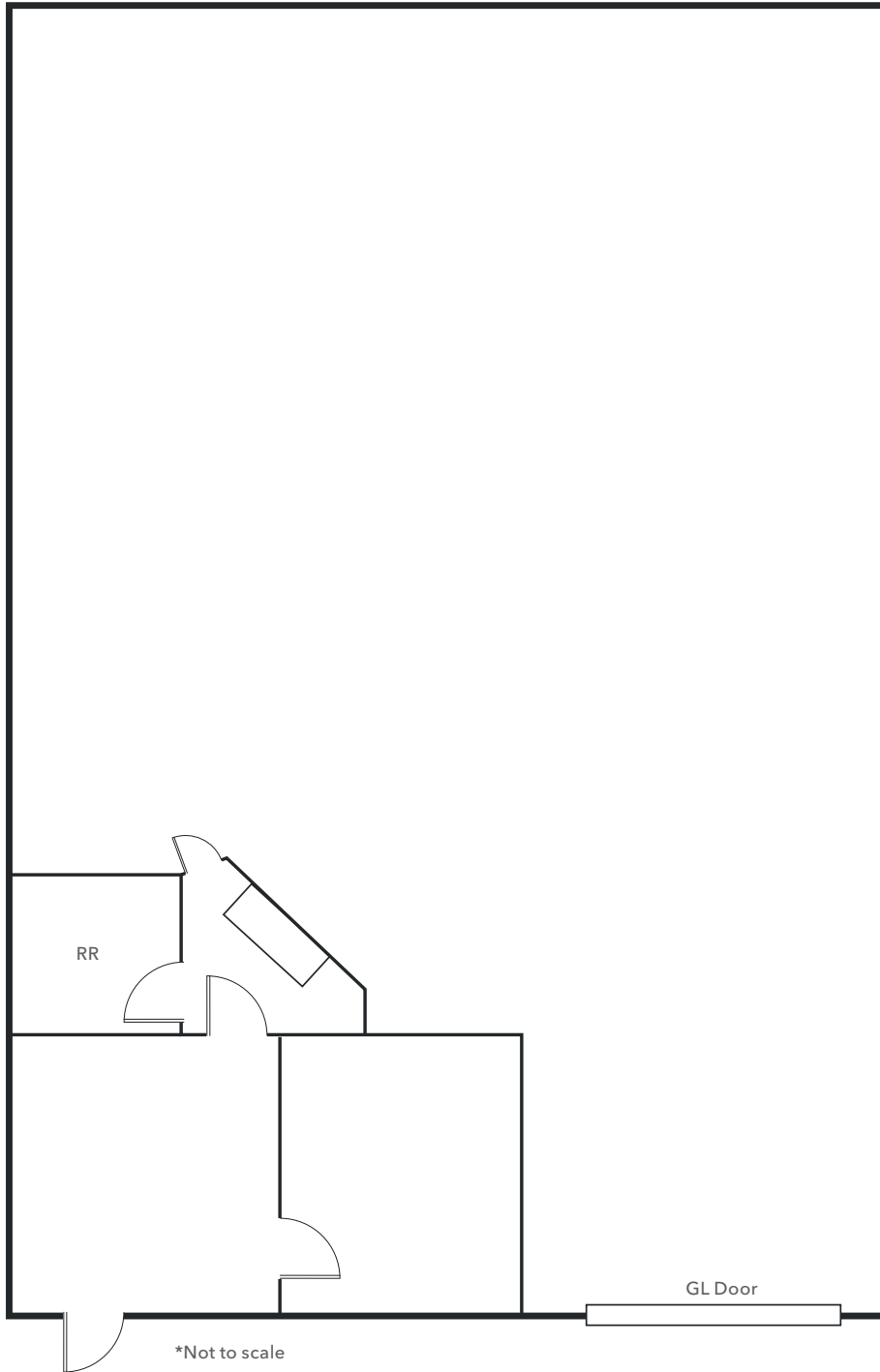

±3,157 SF

SUITE B4 AVAILABLE

18'

CLEAR HEIGHT

1 (12' X 12')

GRADE-LEVEL DOORS

\$4,104

GROSS LEASE RATE (\$/MO)

\$1.30

GROSS LEASE (\$/SF/GROSS)

NOW

DATE AVAILABLE

MATT CALVET 858.442.2072 | matt.calvet@kidder.com | LIC N° 01949267

KIDDER.COM

This information supplied herein is from sources we deem reliable. It is provided without any representation, warranty, or guarantee, expressed or implied as to its accuracy. Prospective Buyer or Tenant should conduct an independent investigation and verification of all matters deemed to be material, including, but not limited to, statements of income and expenses. Consult your attorney, accountant, or other professional advisor.



