

Mercury Logistics Center

+/- 300,017 SF Available for Lease

14205 Mercury Dr
Laredo, TX 78045
www.cbre.com/sanantonio

Industrial Warehouse in Laredo, TX





Mercury Logistics Center

Property Overview

Mercury Logistics Center is a ±300,017 SF Class A industrial warehouse building located in North Laredo Industrial Park. The building will have paved and fenced truck courts that are secured with guard shacks, and roughly ±3,206 SF of speculative office with flexible layout. The property has prime IH-35 frontage/visibility and is located 10 miles from the World Trade Bridge.

Property Highlights

- + Within North Laredo Industrial Park
- + Located within Webb County in Laredo, TX
- + Prime I-35 Frontage
- + 10 miles from the World Trade Bridge
- + 20.27 AC Total Site Area
- + Secured/fenced truck court

300K

+/- Total SF Available

32'

Clear Height

2024

Year Built

Property Details

Mercury Logistics Center

Building Features

- + Available SF: ±300,017
- + Office SF: ±3,206 SF
- + Shipping Office: ±534 SF
- + Clear Height: 32'
- + Typ. Column Spacing: 50' x 50'
- + Speed Bays: 60'
- + Truck Court Length: 135'
- + Trailer Parking: 130 Truck Stalls
- + Auto Parking: 82 Parking Spaces
- + Dock High Doors: 89 (Total)
 - 76 w/ Mechanical EOD Levelers
 - 13 w/ Pit Levelers
- + Ramped Doors: 2
- + ESFR Sprinklers
- + Guard Shacks: 2
- + Power: 277/480V, 3-Phase, 2,500 Amps Service
- + Floor Slab: 7" thick, 4,000 PSI
- + Contact Broker for Pricing

Office Layout

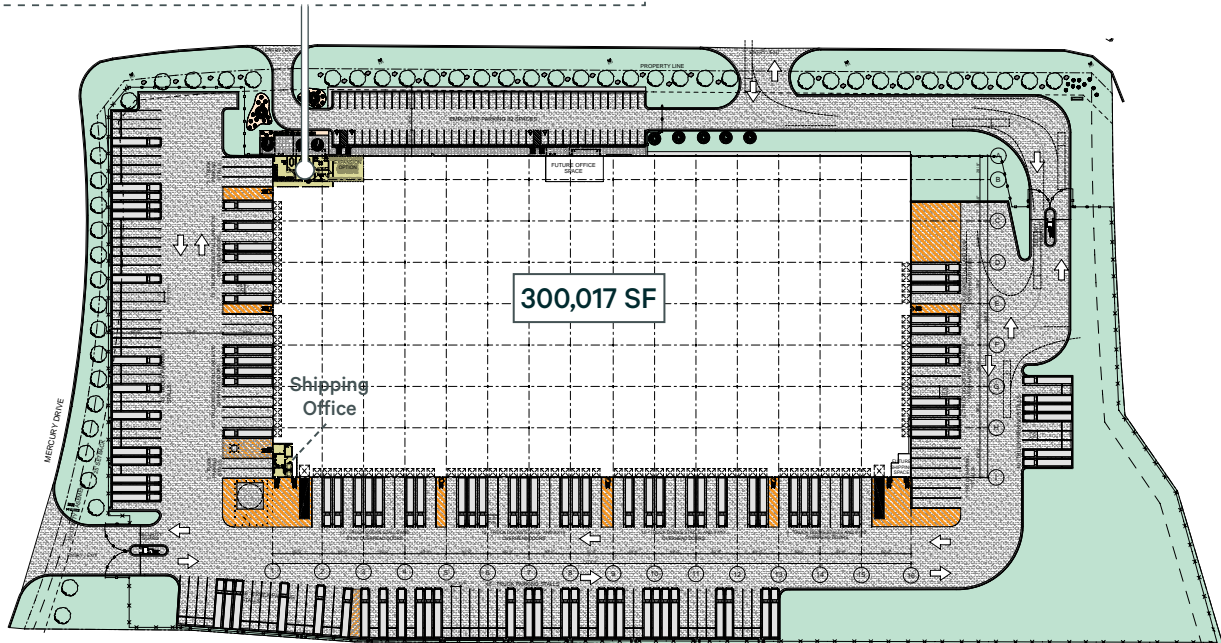
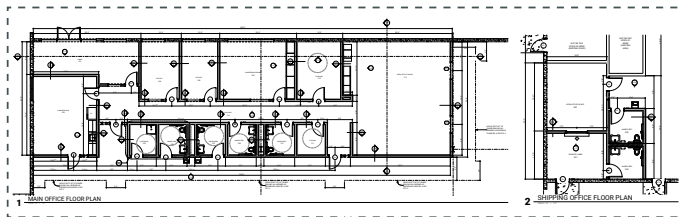

Building Photos

Exterior



Building Photos

Interior

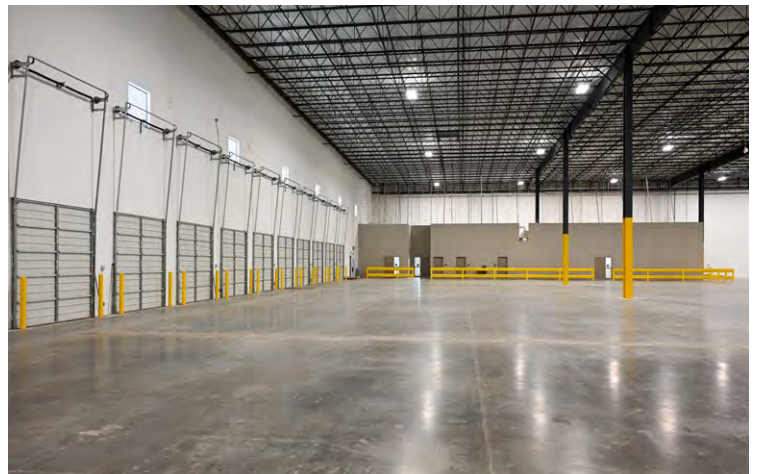
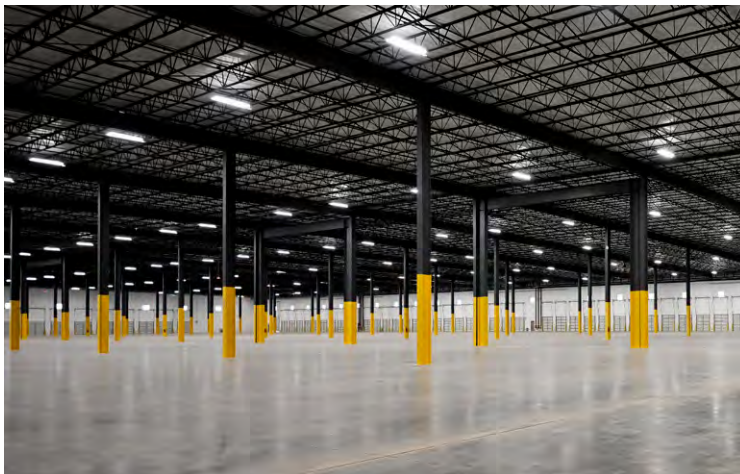
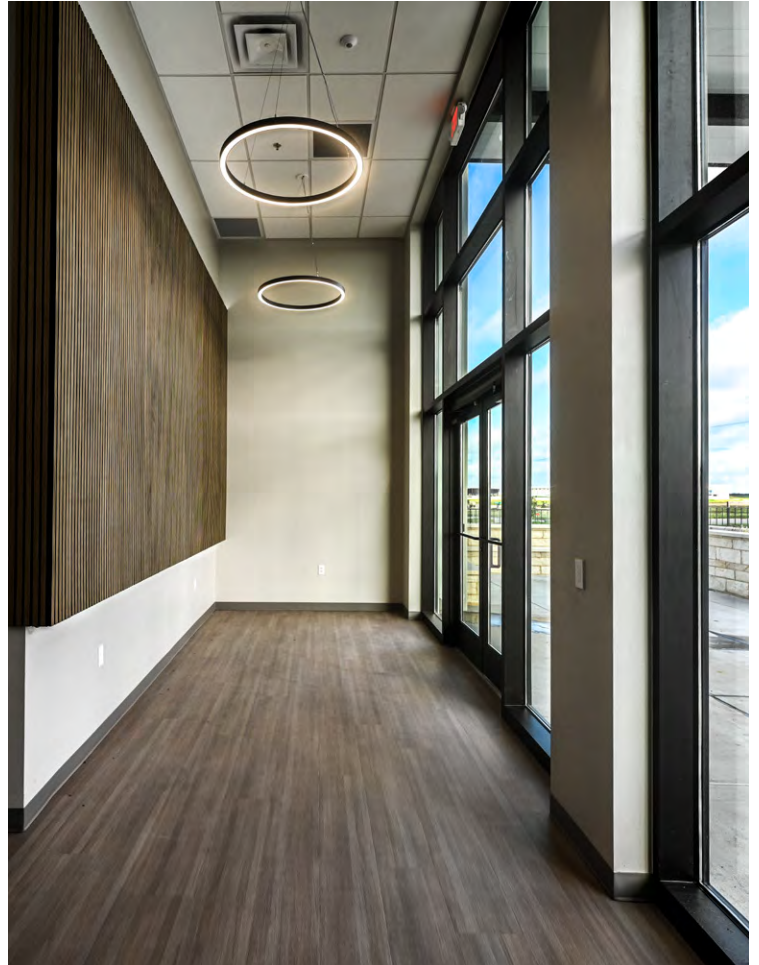

Property Location

Mercury Logistics Center

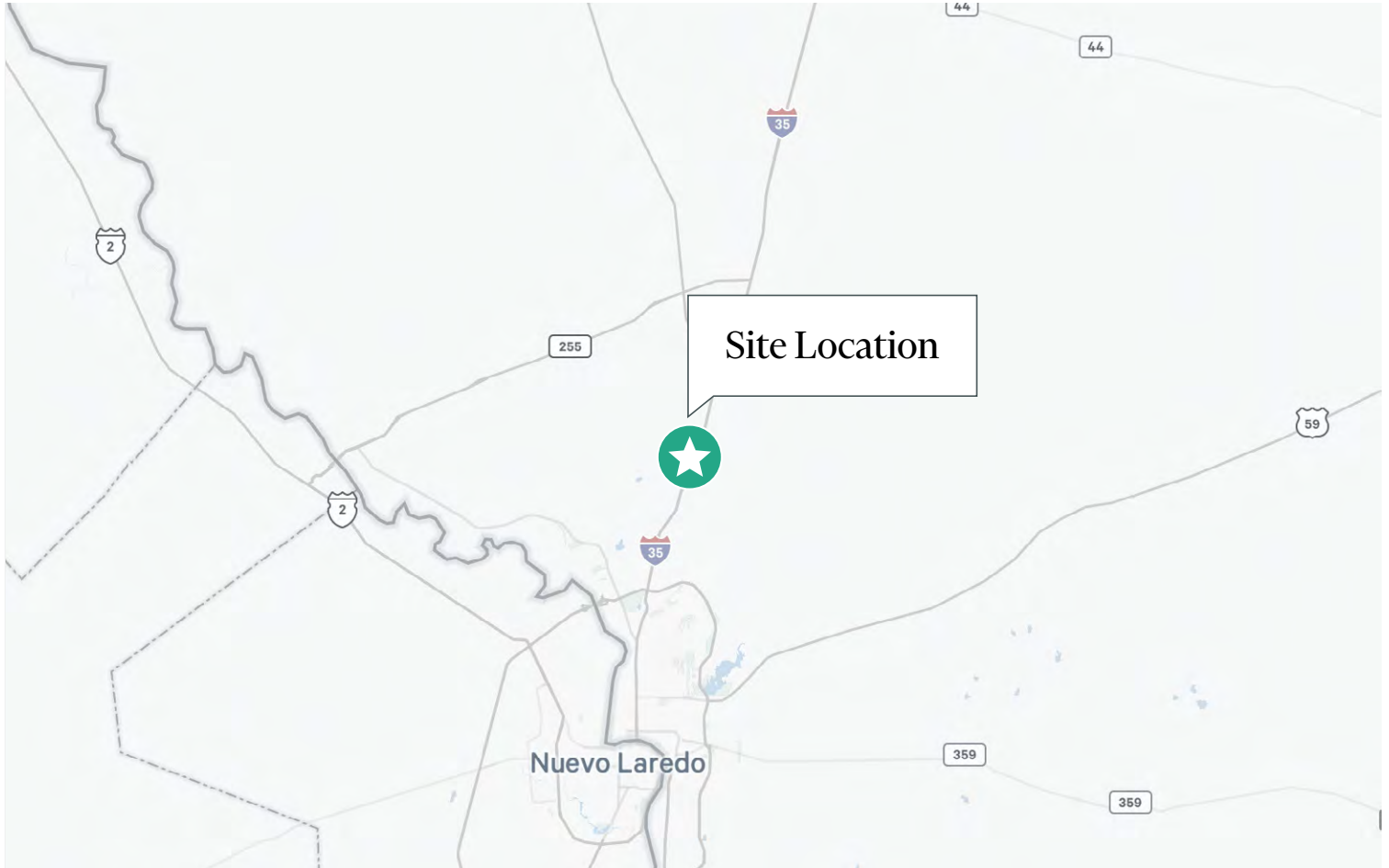

Contact Us

Joshua Aguilar, SIOR
Executive Vice President
+1 210 253 6049
joshua.aguilar@cbre.com

Rob Burlingame, SIOR, CCIM
Executive Vice President
+1 210 507 1123
rob.burlingame@cbre.com

Brad O'Neill
Vice President
+1 210 253 6070
brad.oneill@cbre.com

© 2025 CBRE, Inc. All rights reserved. This information has been obtained from sources believed reliable, but has not been verified for accuracy or completeness. You should conduct a careful, independent investigation of the property and verify all information. Any reliance on this information is solely at your own risk. CBRE and the CBRE logo are service marks of CBRE, Inc. All other marks displayed on this document are the property of their respective owners, and the use of such logos does not imply any affiliation with or endorsement of CBRE. Photos herein are the property of their respective owners. Use of these images without the express written consent of the owner is prohibited.



Information About Brokerage Services

Texas law requires all real estate license holders to give the following information about brokerage services to prospective buyers, tenants, sellers and landlords.

11-2-2015



TYPES OF REAL ESTATE LICENSE HOLDERS:

- A **BROKER** is responsible for all brokerage activities, including acts performed by sales agents sponsored by the broker.
- A **SALES AGENT** must be sponsored by a broker and works with clients on behalf of the broker.

A BROKER'S MINIMUM DUTIES REQUIRED BY LAW (A client is the person or party that the broker represents):

- Put the interests of the client above all others, including the broker's own interests;
- Inform the client of any material information about the property or transaction received by the broker;
- Answer the client's questions and present any offer to or counter-offer from the client; and
- Treat all parties to a real estate transaction honestly and fairly.

A LICENSE HOLDER CAN REPRESENT A PARTY IN A REAL ESTATE TRANSACTION:

AS AGENT FOR OWNER (SELLER/LANDLORD): The broker becomes the property owner's agent through an agreement with the owner, usually in a written listing to sell or property management agreement. An owner's agent must perform the broker's minimum duties above and must inform the owner of any material information about the property or transaction known by the agent, including information disclosed to the agent or subagent by the buyer or buyer's agent.

AS AGENT FOR BUYER/TENANT: The broker becomes the buyer/tenant's agent by agreeing to represent the buyer, usually through a written representation agreement. A buyer's agent must perform the broker's minimum duties above and must inform the buyer of any material information about the property or transaction known by the agent, including information disclosed to the agent by the seller or seller's agent.

AS AGENT FOR BOTH - INTERMEDIARY: To act as an intermediary between the parties the broker must first obtain the written agreement of *each party* to the transaction. The written agreement must state who will pay the broker and, in conspicuous bold or underlined print, set forth the broker's obligations as an intermediary. A broker who acts as an intermediary:

- Must treat all parties to the transaction impartially and fairly;
- May, with the parties' written consent, appoint a different license holder associated with the broker to each party (owner and buyer) to communicate with, provide opinions and advice to, and carry out the instructions of each party to the transaction.
- Must not, unless specifically authorized in writing to do so by the party, disclose:
 - that the owner will accept a price less than the written asking price;
 - that the buyer/tenant will pay a price greater than the price submitted in a written offer; and
 - any confidential information or any other information that a party specifically instructs the broker in writing not to disclose, unless required to do so by law.

AS SUBAGENT: A license holder acts as a subagent when aiding a buyer in a transaction without an agreement to represent the buyer. A subagent can assist the buyer but does not represent the buyer and must place the interests of the owner first.

TO AVOID DISPUTES, ALL AGREEMENTS BETWEEN YOU AND A BROKER SHOULD BE IN WRITING AND CLEARLY ESTABLISH:

- The broker's duties and responsibilities to you, and your obligations under the representation agreement.
- Who will pay the broker for services provided to you, when payment will be made and how the payment will be calculated.

LICENSE HOLDER CONTACT INFORMATION: This notice is being provided for information purposes. It does not create an obligation for you to use the broker's services. Please acknowledge receipt of this notice below and retain a copy for your records.

<u>CBRE, Inc.</u> Licensed Broker /Broker Firm Name or Primary Assumed Business Name	<u>299995</u> License No.	<u>texaslicensing@cbre.com</u> Email	<u>+1 210 225 1000</u> Phone
<u>Jeremy McGown</u> Designated Broker of Firm	<u>620535</u> License No.	<u>jeremy.mcgown@cbre.com</u> Email	<u>+1 214 979 6100</u> Phone
<u>John Moake</u> Licensed Supervisor of Sales Agent/ Associate	<u>540146</u> License No.	<u>john.moake@cbre.com</u> Email	<u>+1 210 841 3217</u> Phone
<u>Joshua Aguilar, SIOR</u> Sales Agent/Associate's Name	<u>560703</u> License No.	<u>joshua.aguilar@cbre.com</u> Email	<u>+1 210 253 6049</u> Phone

Buyer/Tenant/Seller/Landlord Initials

Date

