



**FOR SALE**

**3803 OCEANIC DRIVE,  
SUITE 201  
OCEANSIDE, CA**



**±6,073 SF INDUSTRIAL CONDO  
LOCATED IN  
THE OCEANIC BUSINESS PARK**

# PROPERTY HIGHLIGHTS

- » ±6,073 SF industrial suite
- » Reception, private offices, breakroom, two (2) restrooms, warehouse, and two (2) grade level roll-up doors
- » Clear Height: 20' minimum
- » Power: 600 Amps, 120/208 V
- » Parking: 16 unreserved spaces
- » Great corner location with good visibility
- » Quick access to Oceanside Blvd and I-5
- » Close to commuter rail line, retail, and hotel services
- » Sale Price: \$2,186,280 (\$360/SF)

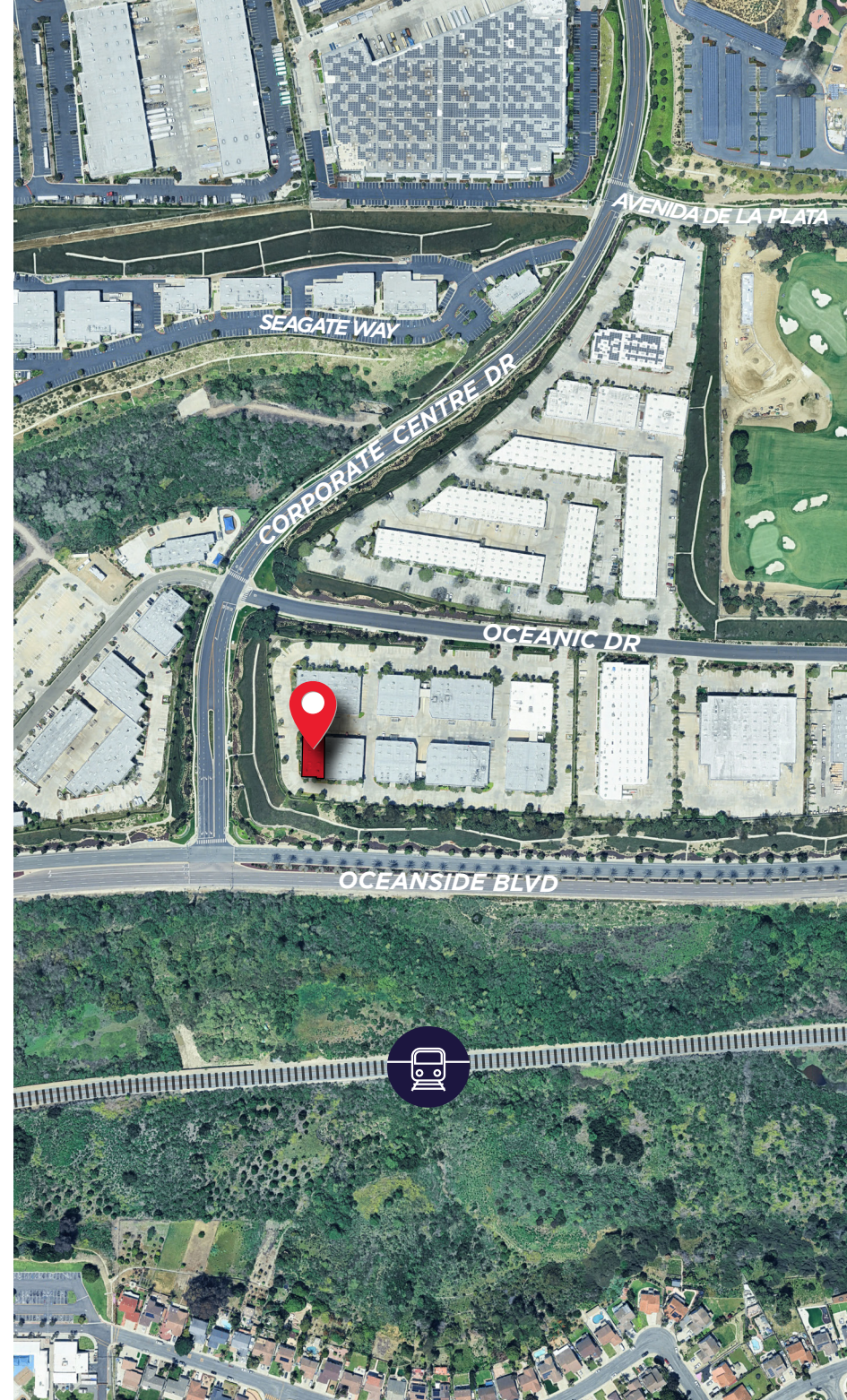

# FLOOR PLAN

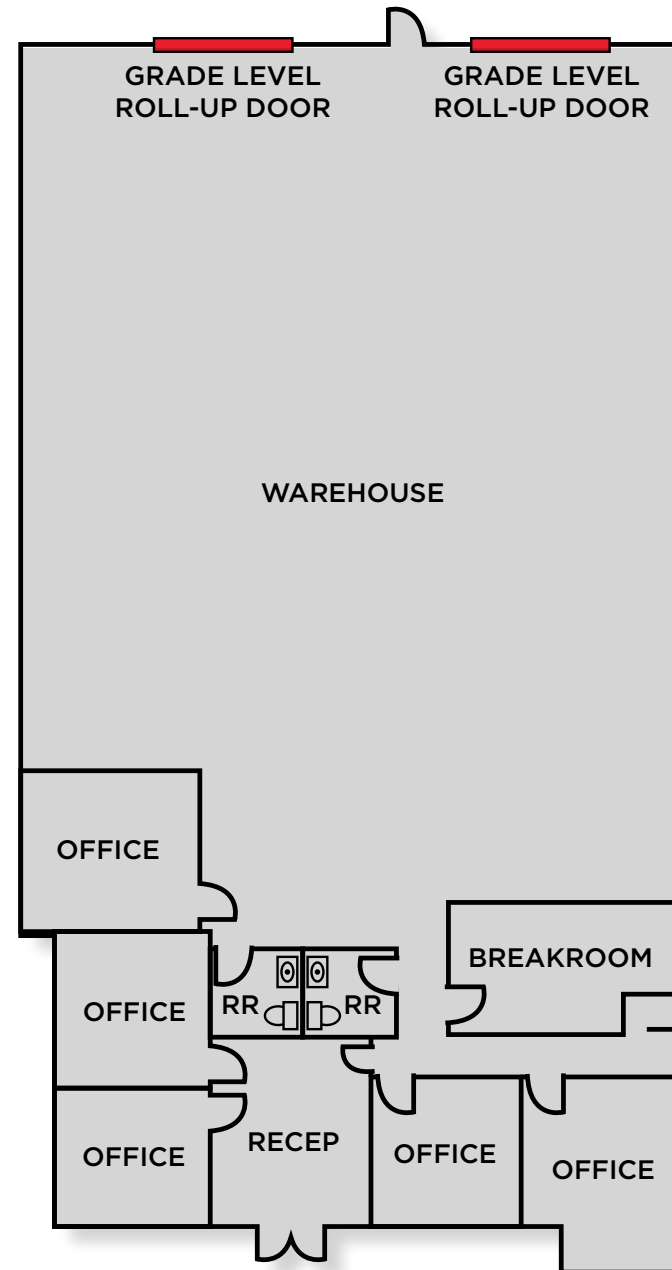

# DRIVE TIMES



8  
MINUTES



10  
MINUTES



10  
MINUTES

THE SHOPPES  
AT CARLSBAD

10  
MINUTES



PALOMAR  
AIRPORT

20  
MINUTES



25  
MINUTES



SAN DIEGO  
INTERNATIONAL

45  
MINUTES



55  
MINUTES

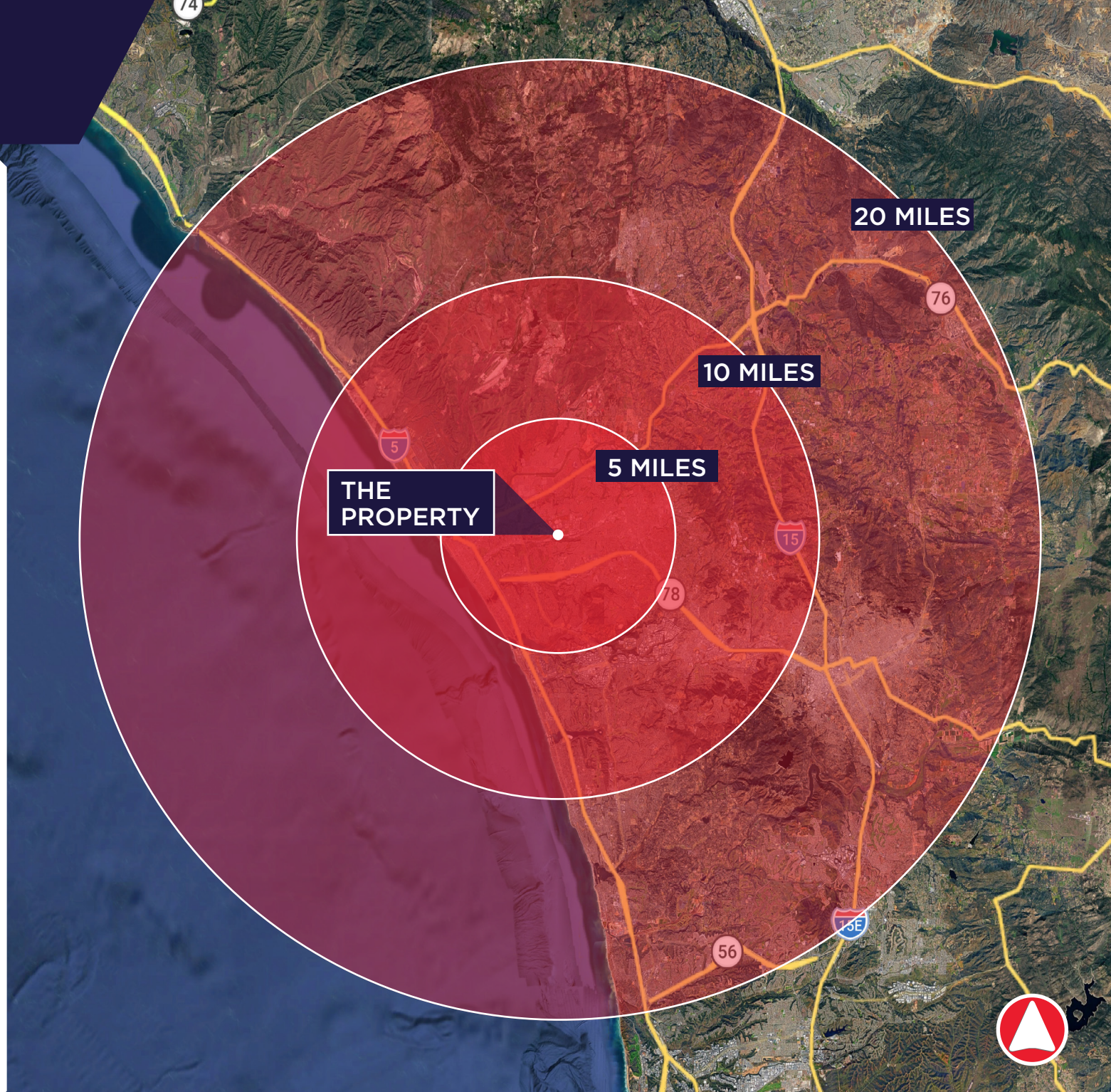



**FOR MORE INFORMATION, CONTACT:**

**Joe Crotty**

Senior Director  
+1 760 473 1811  
joe.crotty@cushwake.com  
Lic. No. 01369821

**Carson Odabashian**

Senior Associate  
+1 760 431 3836  
carson.odabashian@cushwake.com  
Lic. No. 02207230

**Conor Boyle**

Senior Director  
+1 760 458 5739  
conor.boyle@cushwake.com  
Lic. No. 01813305

©2026 Cushman & Wakefield. All rights reserved. The information contained in this communication is strictly confidential. This information has been obtained from sources believed to be reliable but has not been verified. NO WARRANTY OR REPRESENTATION, EXPRESS OR IMPLIED, IS MADE AS TO THE CONDITION OF THE PROPERTY (OR PROPERTIES) REFERENCED HEREIN OR AS TO THE ACCURACY OR COMPLETENESS OF THE INFORMATION CONTAINED HEREIN, AND SAME IS SUBMITTED SUBJECT TO ERRORS, OMISSIONS, CHANGE OF PRICE, RENTAL OR OTHER CONDITIONS, WITHDRAWAL WITHOUT NOTICE, AND TO ANY SPECIAL LISTING CONDITIONS IMPOSED BY THE PROPERTY OWNER(S). ANY PROJECTIONS, OPINIONS OR ESTIMATES ARE SUBJECT TO UNCERTAINTY AND DO NOT SIGNIFY CURRENT OR FUTURE PROPERTY PERFORMANCE.

