

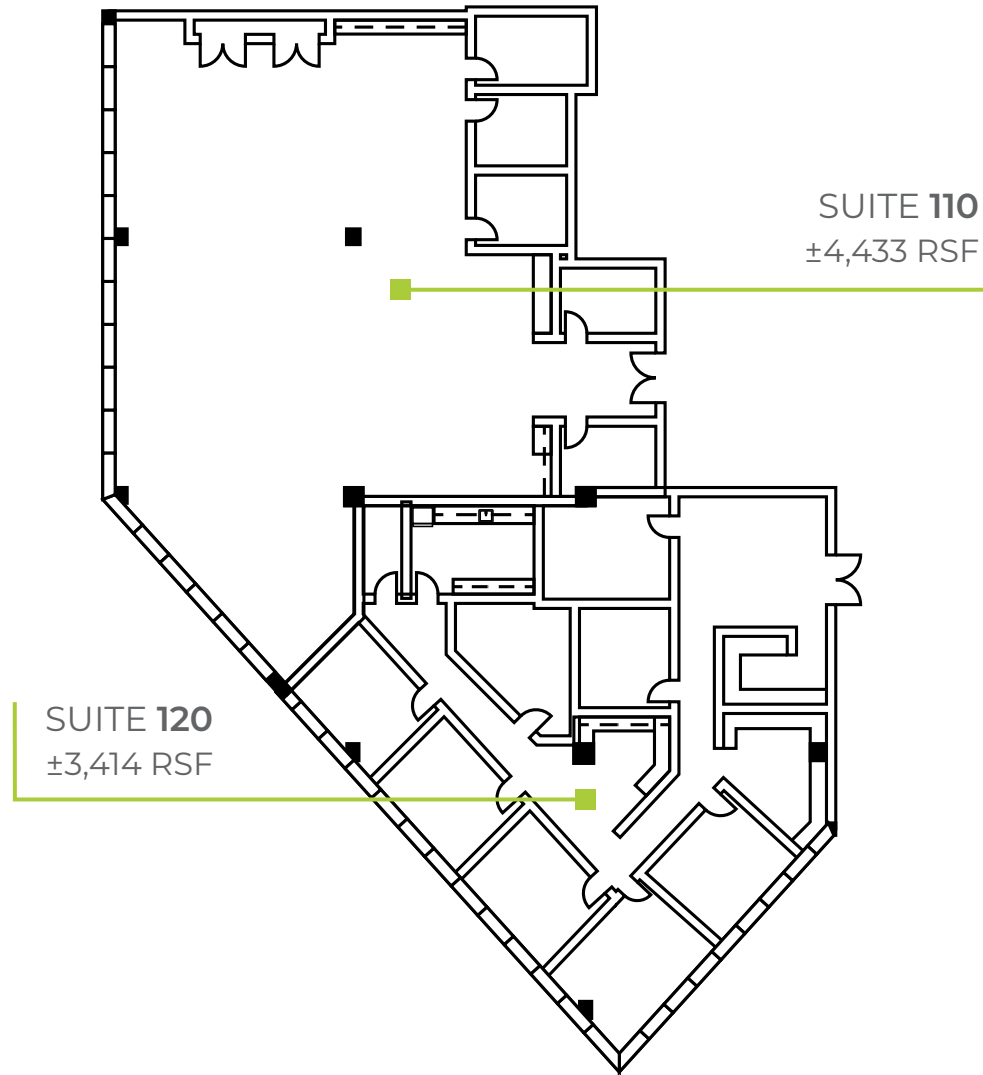

±7,622 RSF
CONTIGUOUS
110/120



PHIL BREIDENBACH, SIOR
Senior Executive Vice President
DIR +1 602 222 5073
phil.breidenbach@colliers.com

MATT BANISZEWSKI
Vice President
DIR +1 602 222 5176
matt.baniszewski@colliers.com

COLLIERS
2390 E Camelback Rd, Ste 100
Phoenix, Arizona 85016
colliers.com/arizona



This email has been prepared by Colliers for advertising and general information only. Colliers makes no guarantees, representations or warranties of any kind, expressed or implied, regarding the information including, but not limited to, warranties of content, accuracy and reliability. Any interested party should undertake their own inquiries as to the accuracy of the information. Colliers excludes unequivocally all inferred or implied terms, conditions and warranties arising out of this document and excludes all liability for loss and damages arising there from. This publication is the copyrighted property of Colliers and/or its licensor(s). © 2025. All rights reserved. This communication is not intended to cause or induce breach of an existing listing agreement. Colliers International AZ, LLC.

BiltmoreCenterPhx.com

BLDG 2390 | 1ST FLOOR | SUITE 110/120