

FOR LEASE

Owned and Operated by



2102 ALTON PARKWAY, #A

Irvine, CA 92606

±31,235 SF



LOREM IPSUM

Office Space	±5,000 Square Feet
Location	Access to 55 & 405 Fwys
POL	90,251 SF Building
Lot Detail	High Identity Street Frontage
Power	400 amps, 277/480 (verify)
Sprinkler	Fully Sprinklered 0.45/3,000
Bldg. Detail	3 Dock High Loading Doors 24'-27' Warehouse Clearance Bay Spacing 56' X 40'

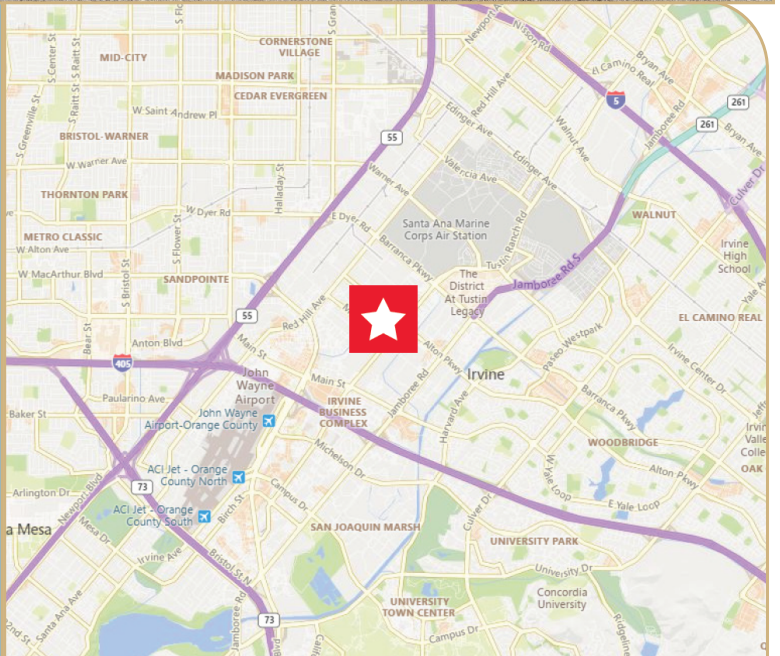

LEASING INFO & CONTACT

Kyle McGillen | Lic # 01959388
Andrew Ryan | Lic # 02218585

(949) 930-9229 / kyle.mcgillen@cushwake.com
(949) 336-3484 / andrew.ryan@cushwake.com



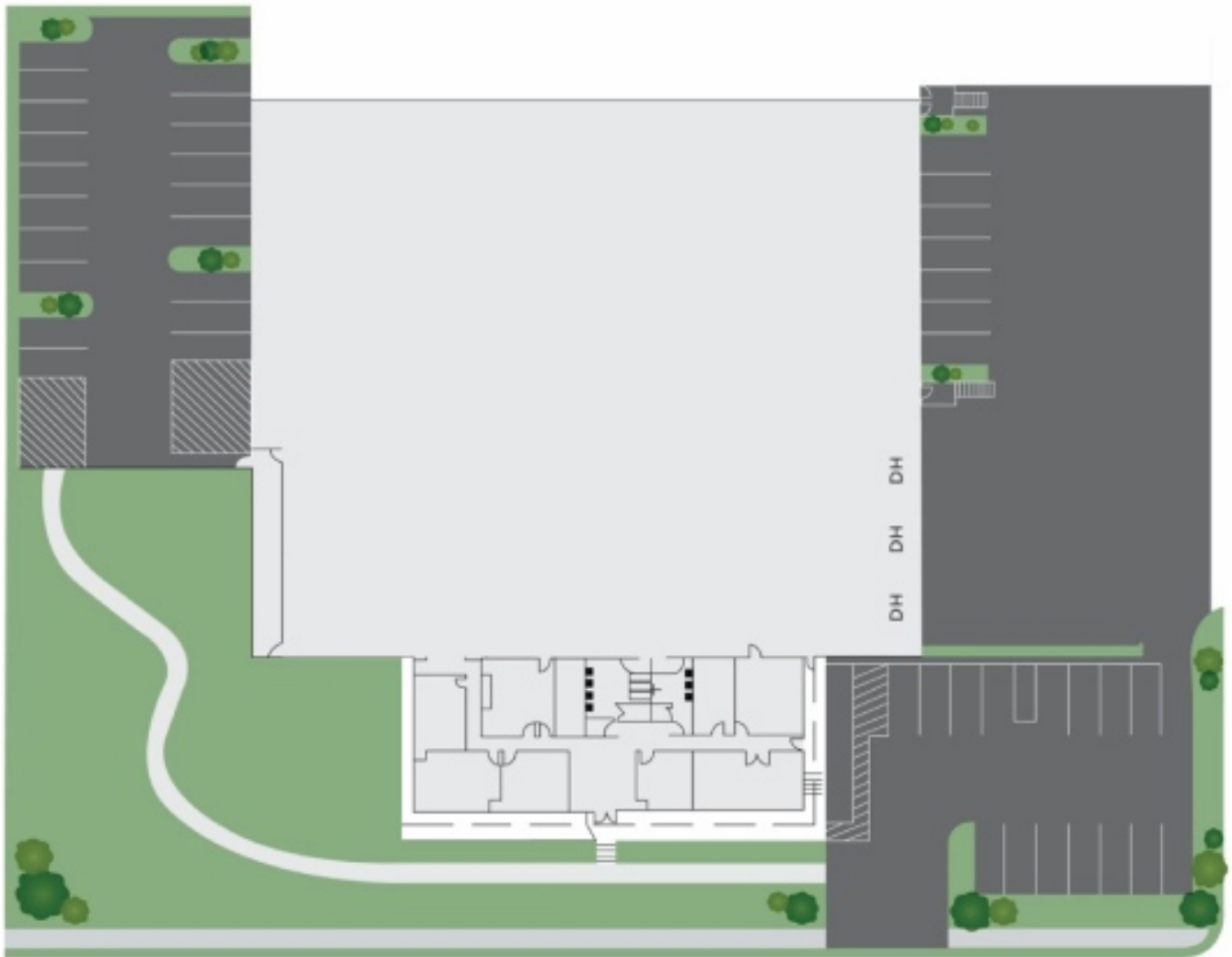

ALTON PARKWAY