

**ONLY FOR IVF SPECIALISTS**

IVF LAB, CLINICAL,  
AND SURGERY CENTER AVAILABLE

IVF SPECIALISTS MAY JOIN PRACTICE OR  
SHARE THE SPACE

<b>Rate</b>	Negotiable
<b>Availability</b>	Full Time or Part-Time



- Gorgeous Clinical, Lab, and Surgery Center Space
- Perfect for New or Established Doctors
- Multiple Recovery Beds Available
- Like-New Equipment Available
- Modern Surgery Center - QUAD A Accreditation
- Valet Parking for Visitors
- Walking Distance to Plenty Century City Restaurants

*Pasadena Location is Also Available for Clinical Work  
at 10 Congress St., Pasadena, CA 91105*



**Jeff Lipson**  
310.202.9008 x 113  
[jlipson@wilshireag.com](mailto:jlipson@wilshireag.com)  
DRE# 01196852



**Kiersten Echon**  
310.202.9008 x 136  
[kiersten@wilshireag.com](mailto:kiersten@wilshireag.com)  
DRE# 02339219

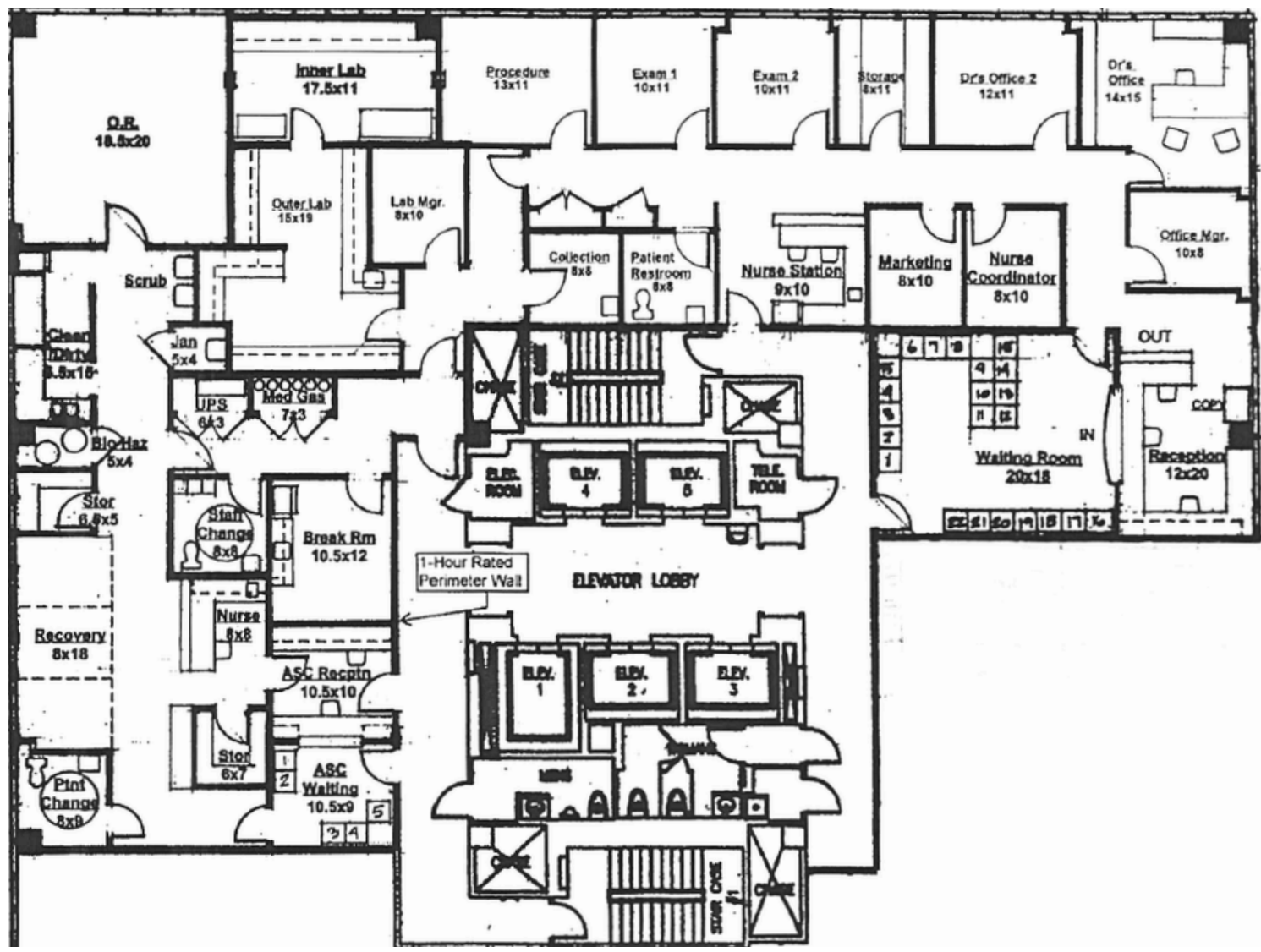

**Jeff Lipson**  
 310.202.9008 x 113  
[jlipson@wilshireag.com](mailto:jlipson@wilshireag.com)  
 DRE# 01196852



**Kiersten Echon**  
 310.202.9008 x 136  
[kiersten@wilshireag.com](mailto:kiersten@wilshireag.com)  
 DRE# 02339219

The information furnished regarding rent roll, income, expenses, layouts, measurements and similar data has been submitted to us by others and thus we cannot make any representation as to its accuracy. The information furnished regarding property for sale, rental or financing is submitted subject to errors, omissions, change of price or other conditions, prior sale lease, or withdrawal without notice.

- Easy Access to the 210 & 134 Freeways
- Walking Distance from the Filmore Gold Line Station
- Free Parking Available to Physicians and Staff in the Huntington Hospital Parking Structure

Contact Broker for Details  
on Congress St. Location



**Jeff Lipson**  
310.202.9008 x 113  
[jlipson@wilshireag.com](mailto:jlipson@wilshireag.com)  
DRE# 01196852



**Kiersten Echon**  
310.202.9008 x 136  
[kiersten@wilshireag.com](mailto:kiersten@wilshireag.com)  
DRE# 02339219